

# FOUNTAINÉ PAJOT ELBA 45

Yara (2025)

Catamaran Fountaine Pajot Elba 45 Yara, built in 2025 is anchored in the **Mallorca, Can Pastilla, Balearic Islands, Spain**. It has **3 + 1 cabins**, can accommodate **6 + 2 + 1 people** and has **3 toilets**. Bed linen and kitchen equipment are included in the price.

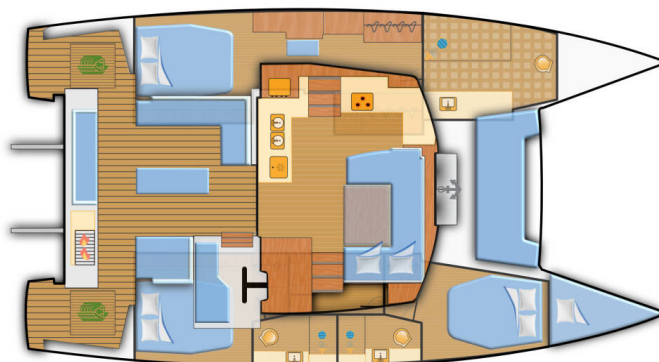

## YACHT SPECIFICATIONS

Yacht Base

**Mallorca, Can Pastilla, Spain**

Yacht ID

**9721**

Brands

**Fountaine Pajot**

Yacht name

**Yara**

Production year

**2025**

Length

**44 ft**

Cabins

**3 + 1**

Berths

**6 + 2 + 1**

Max Persons

**9**

WC

**3**

Engine

**2 x 60 HP**

Fuel tank

**470 l**



**WEBSITE**

[www.plujeme.cz](http://www.plujeme.cz)



**PHONE**

+420 720 755 085



**MOBILE**

+420 777 170 276



**E-MAIL**

[info@plujeme.cz](mailto:info@plujeme.cz)



**PLUJEME RÁDI S.R.O.**

Dlouhá 730/35, 11000 Praha 1 – Staré Město, Czech Republic

## STANDARD YACHT EQUIPMENT

Comfort	<b>Cockpit cushions, Sundeck cushions</b>
Deck	<b>Anchor light, Bimini top, Boat hook, Bosun's chair (Safe seat) (boatswain's chair), Cockpit grill, Cockpit table, Cockpit/stern, outside shower, Deck brush, Dinghy, Electric anchor windlass, Fenders, Gangway, Hydraulic lifting swimming platform, Jerry cans for diesel, Main anchor, Main Deck Compass, Mooring ropes , Spare anchor (Reserve, Auxiliary anchor), Sprayhood, Spring line, Swimming ladder, Teak cockpit</b>
Entertainment	<b>Mask and snorkel, Outdoor speakers, Radio CD mp3 player, Wi-Fi Internet</b>
Galley	<b>Hot water, Kitchen utensils (Galley equipment, cutlery), Oven, Pressurized water system, Refrigerator, Sink, Stove</b>
Interior	<b>Clock, Electric fans, Safe</b>
Navigation	<b>AIS, Autopilot, Binoculars, Depthsounder, GPS, GPS chart plotter - cockpit, Hand bearing compass, LED Navigation lights, Navigation (Nautical) charts and nautical guide , Navigation/position Lights, Radar, Triangles, Wind instrument/Anemometer, Windex</b>
Safety	<b>Black Water Tank, Emergency tiller, Guard rail, VHF radio</b>
Sails	<b>Electric winch, Halyard winches, Lazy bag, Lazy jacks, Winch</b>
Yacht electrics	<b>12V Socket, 220V socket, Air Conditioning, Battery charger , Bilge pump - Electric, Converter 230V/12V, Generator, Heating, Shore connection 220 V, Shore power cable, Solar panels, USB sockets, Watermaker - desalinator</b>



**WEBSITE**

[www.plujeme.cz](http://www.plujeme.cz)



**PHONE**

+420 720 755 085



**MOBILE**

+420 777 170 276



**E-MAIL**

[info@plujeme.cz](mailto:info@plujeme.cz)



**PLUJEME RÁDI S.R.O.**

Dlouhá 730/35, 11000 Praha 1 – Staré Město, Czech Republic

## SERVICES

SELECTED SERVICES	OBLIGATORY	PAYMENT TYPE	PRICE
<b>Base package</b> (Payable at the base) <b>Season: 2025.</b> Cleaning, bed linen, towel set (1x small, 1x large), flushing set, WiFi, gas, dinghy & outboard engine	Yes	per booking	<b>500,00 €</b>
<b>Early Check in</b> (Payable at the base) <b>Season: 2025.</b> at 12:00h (only on request); Payable in cash at the base	No	per booking	<b>150,00 €</b>
<b>Hostess</b> (Payable at the base) <b>Season: 2025.</b> Free food, own cabin	No	per week	<b>1.400,00 €</b>
<b>Pet on board</b> (Payable at the base) <b>Season: 2025.</b> on request only; Payable in cash at the base	No	per booking	<b>140,00 €</b>
<b>Skipper</b> (Payable at the base) <b>Season: 2025.</b> Free food, own skipper cabin	No	per week	<b>1.750,00 €</b>

**WEBSITE**[www.plujeme.cz](http://www.plujeme.cz)**E-MAIL**[info@plujeme.cz](mailto:info@plujeme.cz)**PHONE**

+420 720 755 085

**MOBILE**

+420 777 170 276

**PLUJEME RÁDI S.R.O.**

Dlouhá 730/35, 11000 Praha 1 – Staré Město, Czech Republic

## ADDITIONAL EXTRAS

EXTRA	OBLIGATORY	PAYMENT TYPE	PRICE
<b>Beach towel</b> (Payable at the base) <b>Season: 2025.</b> Payable at the base	No	per person	<b>20,00 €</b>
<b>Snorkeling equipment</b> (Payable at the base) <b>Season: 2025.</b> diving mask and snorkel - Payable at the base	No	per set	<b>35,00 €</b>
<b>Stand up paddle (SUP)</b> (Payable at the base) <b>Season: 2025.</b> Payable in cash at the base 50% second week - Payable at the base	No	per week	<b>100,00 €</b>



#### WEBSITE

[www.plujeme.cz](http://www.plujeme.cz)



#### E-MAIL

[info@plujeme.cz](mailto:info@plujeme.cz)



#### PHONE

+420 720 755 085



#### MOBILE

+420 777 170 276



#### PLUJEME RÁDI S.R.O.

Dlouhá 730/35, 11000 Praha 1 – Staré Město, Czech Republic

## PRICE AND AVAILABILITY

01.01. - 06.06.2025

NOT AVAILABLE

07.06. - 14.06.2025

**9.520 €** 11.200 €

14.06. - 21.06.2025

**9.520 €** 11.200 €

21.06. - 28.06.2025

**9.520 €** 11.200 €

28.06. - 05.07.2025

**11.433 €** 13.450 €



**WEBSITE**

[www.plujeme.cz](http://www.plujeme.cz)



**E-MAIL**

[info@plujeme.cz](mailto:info@plujeme.cz)



**PHONE**

+420 720 755 085



**MOBILE**

+420 777 170 276



**PLUJEME RÁDI S.R.O.**

Dlouhá 730/35, 11000 Praha 1 – Staré Město, Czech Republic

## PRICE AND AVAILABILITY

05.07. - 12.07.2025 <b>11.433 €</b> 13.450 €	12.07. - 19.07.2025 <b>11.433 €</b> 13.450 €	19.07. - 26.07.2025 <b>11.433 €</b> 13.450 €	26.07. - 02.08.2025 <b>11.433 €</b> 13.450 €
02.08. - 09.08.2025 <b>11.433 €</b> 13.450 €	09.08. - 16.08.2025 <b>11.433 €</b> 13.450 €	16.08. - 23.08.2025 <b>11.433 €</b> 13.450 €	23.08. - 30.08.2025 <b>11.433 €</b> 13.450 €
30.08. - 06.09.2025 <b>10.370 €</b> 12.200 €	06.09. - 13.09.2025 <b>10.370 €</b> 12.200 €	13.09. - 20.09.2025 <b>9.520 €</b> 11.200 €	20.09. - 27.09.2025 <b>9.520 €</b> 11.200 €
27.09. - 04.10.2025 <b>8.033 €</b> 9.450 €	04.10. - 11.10.2025 <b>8.033 €</b> 9.450 €	11.10. - 18.10.2025 <b>5.313 €</b> 6.250 €	18.10. - 25.10.2025 <b>5.313 €</b> 6.250 €
25.10. - 01.11.2025 <b>5.313 €</b> 6.250 €	01.11. - 08.11.2025 <b>5.313 €</b> 6.250 €	09.11. - 27.03.2026 NOT AVAILABLE	



**WEBSITE**  
[www.plujeme.cz](http://www.plujeme.cz)



**E-MAIL**  
[info@plujeme.cz](mailto:info@plujeme.cz)



**PHONE**  
+420 720 755 085



**MOBILE**  
+420 777 170 276



**PLUJEME RÁDI S.R.O.**  
Dlouhá 730/35, 11000 Praha 1 – Staré Město, Czech Republic