

BALI 4.3 MY

Sierra (2020)

Power catamaran Bali 4.3 MY Sierra, built in **2020** is anchored in the **Sukosan, D-Marin Dalmacija Marina, Zadar region, Croatia**. It has **4 + 1 cabins**, can accommodate **8 + 1 + 1 people** and has **4 toilets**. Bed linen and kitchen equipment are included in the price.

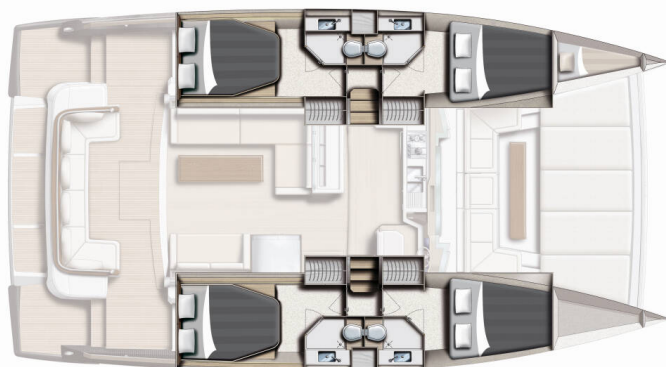

YACHT SPECIFICATIONS

Yacht Base

**Sukosan, D-Marin Dalmacija Marina,
Croatia**

Yacht ID

9704

Brands

Catana

Yacht name

Sierra

Production year

2020

Length

42 ft

Cabins

4 + 1

Berths

8 + 1 + 1

Max Persons

12

WC

4

Engine

2 x 250 HP

Fuel tank

800 l



WEBSITE

www.plujeme.cz



PHONE

+420 720 755 085



MOBILE

+420 777 170 276



E-MAIL

info@plujeme.cz



PLUJEME RÁDI S.R.O.

Dlouhá 730/35, 11000 Praha 1 – Staré Město, Czech Republic

STANDARD YACHT EQUIPMENT

Comfort	Blankets, Cockpit cushions, Pillows, Sun mattresses
Deck	Anchor, Bathing platform, Bimini top, Cockpit table, Cockpit/stern, outside shower, Dinghy with outboard engine, Electric anchor windlass, Floating rope, Grill/Barbecue/Plancha, Main anchor, Swimming ladder
Entertainment	Radio CD player
Galley	Freezer, Gas cookers, Hot water, Kitchen utensils (Galley equipment, cutlery), Oven, Refrigerator, Sink
Interior	Electric fans in cabins
Navigation	Autopilot, Compass, Echosounder/Depthsounder, GPS chart plotter, GPS chart plotter - cockpit, Speedometer (Speed log)
Safety	Distress flare box, Fire extinguisher , First aid kit , Life belts (Safety harness), Life buoy + Flashing light, Life jackets, Liferaft , Sos Dan Buoy, VHF radio
Yacht electrics	12V Socket, Air Conditioning, Battery charger , Generator, Inverter, Service batteries, Shore power cable, Solar panels, Start battery



WEBSITE

www.plujeme.cz



PHONE

+420 720 755 085



MOBILE

+420 777 170 276



E-MAIL

info@plujeme.cz



PLUJEME RÁDI S.R.O.

Dlouhá 730/35, 11000 Praha 1 – Staré Město, Czech Republic

SERVICES

SELECTED SERVICES	OBLIGATORY	PAYMENT TYPE	PRICE
Charter pack (Payable at the base) Season: 2025. includes final cleaning, bedlinen, towels - 1 set/person, cooking gas	Yes	per booking	470,00 €
Comfort Pack (Payable at the base) Season: 2025. includes outboard 2,5 HP, WiFi routers	No	per week	105,00 €
Early Check in (Payable at the base) Season: 2025. Saturdays between 13hr - 14hr. Early check in can be confirmed only on embarkation day in the charter base.	No	per booking	250,00 €
Flexible booking (Payable now) Season: 2025. allows you to cancel or rebook your charter up to 30 days before the embarkation for no specific reason. You can reschedule your holiday at no cost for unlimited number of times or use a credit note if you are uncertain of new charter dates. With our FLEX PLAN your rebooking costs are completely eliminated while cancellation costs with refund option are reduced to a minimum (15% of the charter fee, min 350 EUR). Extra bonus: free cancellation and FULL REFUND granted in case of closed state borders within 7 days before the embarkation. Notes: FLEX PLAN costs 7% of the final charter price, can be added to booking up to 72hr after booking confirmation and is not available for bookings confirmed within 30 days before the embarkation.	No	per booking	0,00 €
Hostess (Payable now) Season: 2025.	No	per day + food	220,00 €
Late check out (Payable at the base) Season: 2025. Saturdays till 10hr Late check-out can be confirmed only on Friday before the embarkation day.	No	per booking	350,00 €
Provisioning (Payable now) Season: 2025. upon request + price of groceries, to be done online	No	per booking	0,00 €



WEBSITE
www.plujeme.cz



PHONE
+420 720 755 085



MOBILE
+420 777 170 276



E-MAIL
info@plujeme.cz



PLUJEME RÁDI S.R.O.
Dlouhá 730/35, 11000 Praha 1 – Staré Město, Czech Republic

ADDITIONAL EXTRAS

EXTRA	OBLIGATORY	PAYMENT TYPE	PRICE
Beach towel (Payable at the base) Season: 2025. Payable at the base	No	per piece	8,00 €
Extra bedlinen (Payable at the base) Season: 2025. Payable at the base	No	per set	15,00 €
Railing net (Safety net) (Payable at the base) Season: 2025. Rental without mounting - Payable at the base	No	per booking	20,00 €
Stand up paddle (SUP) (Payable at the base) Season: 2025. Payable at the base	No	per week	120,00 €
Towels (Payable at the base) Season: 2025. 2 psc/set (1 x 50x100cm + 1 x 70x140cm) - Payable at the base	No	per set	8,00 €
Wi-Fi Internet (Payable at the base) Season: 2025. Payable at the base	No	per week	25,00 €

**WEBSITE**www.plujeme.cz**E-MAIL**info@plujeme.cz**PHONE**

+420 720 755 085

**MOBILE**

+420 777 170 276

**PLUJEME RÁDI S.R.O.**

Dlouhá 730/35, 11000 Praha 1 – Staré Město, Czech Republic

PRICE AND AVAILABILITY

01.01. - 04.04.2025 NOT AVAILABLE	05.04. - 12.04.2025 4.933 € 6.240 €	12.04. - 19.04.2025 5.012 € 6.340 €	19.04. - 26.04.2025 5.723 € 7.240 €
26.04. - 03.05.2025 5.802 € 7.340 €	03.05. - 10.05.2025 5.960 € 7.540 €	10.05. - 17.05.2025 6.703 € 8.480 €	17.05. - 24.05.2025 6.941 € 8.780 €
24.05. - 31.05.2025 7.652 € 9.680 €	31.05. - 07.06.2025 7.968 € 10.080 €	07.06. - 14.06.2025 9.628 € 12.180 €	14.06. - 21.06.2025 10.103 € 12.780 €
21.06. - 28.06.2025 11.130 € 14.080 €	28.06. - 05.07.2025 11.415 € 14.440 €		



WEBSITE

www.plujeme.cz



E-MAIL

info@plujeme.cz



PHONE

+420 720 755 085



MOBILE

+420 777 170 276



PLUJEME RÁDI S.R.O.

Dlouhá 730/35, 11000 Praha 1 – Staré Město, Czech Republic

PRICE AND AVAILABILITY

05.07. - 12.07.2025 11.573 € 14.640 €	12.07. - 19.07.2025 12.047 € 15.240 €	19.07. - 26.07.2025 12.047 € 15.240 €	26.07. - 02.08.2025 NOT AVAILABLE
02.08. - 09.08.2025 12.047 € 15.240 €	09.08. - 16.08.2025 11.415 € 14.440 €	16.08. - 23.08.2025 11.178 € 14.140 €	23.08. - 30.08.2025 10.419 € 13.180 €
30.08. - 06.09.2025 8.759 € 11.080 €	06.09. - 13.09.2025 8.284 € 10.480 €	13.09. - 20.09.2025 7.731 € 9.780 €	20.09. - 27.09.2025 6.862 € 8.680 €
27.09. - 04.10.2025 6.387 € 8.080 €	04.10. - 11.10.2025 4.949 € 6.260 €	11.10. - 18.10.2025 4.933 € 6.240 €	18.10. - 25.10.2025 4.854 € 6.140 €
25.10. - 01.11.2025 4.775 € 6.040 €	01.11. - 08.11.2025 4.775 € 6.040 €	08.11. - 15.11.2025 4.775 € 6.040 €	15.11. - 22.11.2025 4.775 € 6.040 €
22.11. - 29.11.2025 4.775 € 6.040 €	29.11. - 06.12.2025 5.134 € 6.040 €	06.12. - 13.12.2025 5.134 € 6.040 €	13.12. - 20.12.2025 5.134 € 6.040 €
20.12. - 27.12.2025 5.134 € 6.040 €			



WEBSITE

www.plujeme.cz



E-MAIL

info@plujeme.cz



PHONE

+420 720 755 085



MOBILE

+420 777 170 276



PLUJEME RÁDI S.R.O.

Dlouhá 730/35, 11000 Praha 1 – Staré Město, Czech Republic