

# HANSE 548

Stargazing (2020)

Sailing yacht Hanse 548 Stargazing, built in 2020 is anchored in the **Sukosan, D-Marin Dalmacija Marina, Zadar region, Croatia**. It has **5 + 1 cabins**, can accommodate **10 + 2 + 1 people** and has **3 toilets**. Bed linen and kitchen equipment are included in the price.

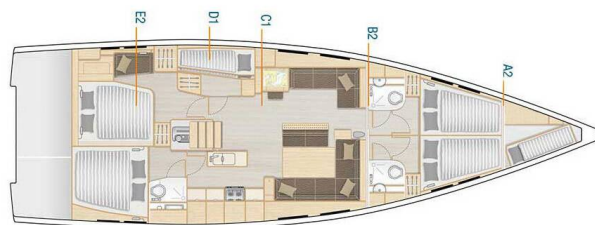

## YACHT SPECIFICATIONS

Yacht Base

**Sukosan, D-Marin Dalmacija Marina,  
Croatia**

Yacht ID

**9700**

Brands

**Hanse Yachts**

Yacht name

**Stargazing**

Production year

**2020**

Length

**53 ft**

Cabins

**5 + 1**

Berths

**10 + 2 + 1**

Max Persons

**12**

WC

**3**

Engine

**1 x 110 HP**

Fuel tank

**520 l**



**WEBSITE**

[www.plujeme.cz](http://www.plujeme.cz)



**PHONE**

+420 720 755 085



**MOBILE**

+420 777 170 276



**E-MAIL**

[info@plujeme.cz](mailto:info@plujeme.cz)



**PLUJEME RÁDI S.R.O.**

Dlouhá 730/35, 11000 Praha 1 – Staré Město, Czech Republic

## STANDARD YACHT EQUIPMENT

Comfort	<b>Bed linen, Cockpit seat cushions with backrest, Sundeck cushions</b>
Deck	<b>Bathing platform, Bimini top, Cockpit table, Dinghy, Sprayhood, Teak cockpit</b>
Entertainment	<b>Outdoor speakers, Radio CD player, TV</b>
Galley	<b>Freezer, Hot water, Kitchen utensils (Galley equipment, cutlery), Oven, Refrigerator, Stove</b>
Navigation	<b>Autopilot, Bow thruster, GPS chart plotter - cockpit, Navigation (Nautical) charts and nautical guide , Radar, Tridata</b>
Safety	<b>VHF radio</b>
Sails	<b>Electric halyard winch, Electric primary winch</b>
Yacht electrics	<b>Air Conditioning, Battery charger , Generator, Heating, Inverter, Solar panels</b>



**WEBSITE**

[www.plujeme.cz](http://www.plujeme.cz)



**E-MAIL**

[info@plujeme.cz](mailto:info@plujeme.cz)



**PHONE**

+420 720 755 085



**MOBILE**

+420 777 170 276



**PLUJEME RÁDI S.R.O.**

Dlouhá 730/35, 11000 Praha 1 – Staré Město, Czech Republic

## SERVICES

SELECTED SERVICES	OBLIGATORY	PAYMENT TYPE	PRICE
<b>Charter pack</b> (Payable at the base) <b>Season: 2025.</b> includes final cleaning, bedlinen, towels - 1 set/person, cooking gas	Yes	per booking	<b>380,00 €</b>
<b>Comfort Pack</b> (Payable at the base) <b>Season: 2025.</b> includes outboard 2,5 HP, WiFi routers	No	per week	<b>105,00 €</b>
<b>Early Check in</b> (Payable at the base) <b>Season: 2025.</b> Saturdays between 13hr - 14hr. Early check in can be confirmed only on embarkation day in the charter base.	No	per booking	<b>250,00 €</b>
<b>Flexible booking</b> (Payable now) <b>Season: 2025.</b> allows you to cancel or rebook your charter up to 30 days before the embarkation for no specific reason. You can reschedule your holiday at no cost for unlimited number of times or use a credit note if you are uncertain of new charter dates. With our FLEX PLAN your rebooking costs are completely eliminated while cancellation costs with refund option are reduced to a minimum (15% of the charter fee, min 350 EUR). Extra bonus: free cancellation and FULL REFUND granted in case of closed state borders within 7 days before the embarkation. Notes: FLEX PLAN costs 7% of the final charter price, can be added to booking up to 72hr after booking confirmation and is not available for bookings confirmed within 30 days before the embarkation.	No	per booking	<b>0,00 €</b>
<b>Hostess</b> (Payable now) <b>Season: 2025.</b>	No	per day + food	<b>220,00 €</b>
<b>Late check out</b> (Payable at the base) <b>Season: 2025.</b> Saturdays till 10hr Late check-out can be confirmed only on Friday before the embarkation day.	No	per booking	<b>350,00 €</b>
<b>One way fee</b> (Payable at the base) <b>Season: 2025.</b> Suk - Ši / Ši - Suk On request only. One-way conditions: one way fee + skippers daily fee + berth charges in port of embarkation/disembarkation	No	per booking	<b>250,00 €</b>
<b>One way fee</b> (Payable at the base) <b>Season: 2025.</b> Suk - Kas / Kas - Suk On request only. One-way conditions: one way fee + skippers daily fee + berth charges in port of embarkation/disembarkation; check-out on Friday until 12:00 in Kaštela	No	per booking	<b>490,00 €</b>

<b>One way fee</b> (Payable at the base)	No	per booking	<b>490,00 €</b>
<b>Season: 2025.</b> Suk - Seg / Seg - Suk On request only. One-way conditions: one way fee + skippers daily fee + berth charges in port of embarkation/disembarkation			
<b>Provisioning</b> (Payable now)	No	per booking	<b>0,00 €</b>
<b>Season: 2025.</b> upon request + price of groceries, to be done online			
<b>Skipper</b> (Payable now)	No	per day + food	<b>240,00 €</b>
<b>Season: 2025.</b>			



**WEBSITE**

[www.plujeme.cz](http://www.plujeme.cz)



**E-MAIL**

[info@plujeme.cz](mailto:info@plujeme.cz)



**PHONE**

+420 720 755 085



**MOBILE**

+420 777 170 276



**PLUJEME RÁDI S.R.O.**

Dlouhá 730/35, 11000 Praha 1 – Staré Město, Czech Republic

## ADDITIONAL EXTRAS

EXTRA	OBLIGATORY	PAYMENT TYPE	PRICE
<b>Beach towel</b> (Payable at the base) <b>Season: 2025.</b> Payable at the base	No	per piece	<b>8,00 €</b>
<b>Extra bedlinen</b> (Payable at the base) <b>Season: 2025.</b> Payable at the base	No	per set	<b>15,00 €</b>
<b>Outboard engine 2,5 HP</b> (Payable at the base) <b>Season: 2025.</b> Payable at the base	No	per week	<b>100,00 €</b>
<b>Outboard engine 5 HP</b> (Payable at the base) <b>Season: 2025.</b> on request - Payable at the base	No	per week	<b>150,00 €</b>
<b>Railing net (Safety net)</b> (Payable at the base) <b>Season: 2025.</b> Rental without mounting - Payable at the base	No	per booking	<b>20,00 €</b>
<b>Snorkeling equipment</b> (Payable at the base) <b>Season: 2025.</b> Payable at the base	No	per week	<b>10,00 €</b>
<b>Stand up paddle (SUP)</b> (Payable at the base) <b>Season: 2025.</b> Payable at the base	No	per week	<b>120,00 €</b>
<b>Towels</b> (Payable at the base) <b>Season: 2025.</b> 2 psc/set (1 x 50x100cm + 1 x 70x140cm) - Payable at the base	No	per set	<b>8,00 €</b>
<b>Wi-Fi Internet</b> (Payable at the base) <b>Season: 2025.</b> Payable at the base	No	per week	<b>25,00 €</b>



**WEBSITE**

[www.plujeme.cz](http://www.plujeme.cz)



**E-MAIL**

[info@plujeme.cz](mailto:info@plujeme.cz)



**PHONE**

+420 720 755 085



**MOBILE**

+420 777 170 276



**PLUJEME RÁDI S.R.O.**

Dlouhá 730/35, 11000 Praha 1 – Staré Město, Czech Republic

## PRICE AND AVAILABILITY

05.04. - 12.04.2025 ON OPTION	12.04. - 19.04.2025 ON OPTION	19.04. - 26.04.2025 ON OPTION	26.04. - 03.05.2025 ON OPTION
03.05. - 10.05.2025 ON OPTION	10.05. - 17.05.2025 ON OPTION	17.05. - 24.05.2025 ON OPTION	24.05. - 31.05.2025 ON OPTION
31.05. - 07.06.2025 ON OPTION	07.06. - 14.06.2025 ON OPTION	14.06. - 21.06.2025 ON OPTION	21.06. - 28.06.2025 ON OPTION
28.06. - 05.07.2025 6.544 € 8.180 €	05.07. - 12.07.2025 6.672 € 8.340 €	12.07. - 19.07.2025 6.672 € 8.340 €	19.07. - 26.07.2025 6.672 € 8.340 €
26.07. - 02.08.2025 6.672 € 8.340 €			



### WEBSITE

[www.plujeme.cz](http://www.plujeme.cz)



### E-MAIL

[info@plujeme.cz](mailto:info@plujeme.cz)



### PHONE

+420 720 755 085



### MOBILE

+420 777 170 276



### PLUJEME RÁDI S.R.O.

Dlouhá 730/35, 11000 Praha 1 – Staré Město, Czech Republic

## PRICE AND AVAILABILITY

02.08. - 09.08.2025 <b>6.672 €</b> 8.340 €	09.08. - 16.08.2025 <b>6.672 €</b> 8.340 €	16.08. - 23.08.2025 <b>6.112 €</b> 7.640 €	23.08. - 30.08.2025 <b>5.872 €</b> 7.340 €
30.08. - 06.09.2025 <b>5.712 €</b> 7.140 €	06.09. - 13.09.2025 NOT AVAILABLE	13.09. - 20.09.2025 <b>4.944 €</b> 6.180 €	20.09. - 27.09.2025 <b>4.144 €</b> 5.180 €
27.09. - 04.10.2025 <b>3.424 €</b> 4.280 €	04.10. - 11.10.2025 <b>3.024 €</b> 3.780 €	11.10. - 18.10.2025 <b>2.864 €</b> 3.580 €	18.10. - 25.10.2025 <b>2.592 €</b> 3.240 €
25.10. - 01.11.2025 <b>2.432 €</b> 3.040 €	01.11. - 08.11.2025 <b>2.432 €</b> 3.040 €	08.11. - 15.11.2025 <b>2.432 €</b> 3.040 €	15.11. - 22.11.2025 <b>2.432 €</b> 3.040 €
22.11. - 29.11.2025 <b>2.432 €</b> 3.040 €	29.11. - 06.12.2025 <b>2.432 €</b> 3.040 €	06.12. - 13.12.2025 <b>2.432 €</b> 3.040 €	13.12. - 20.12.2025 <b>2.432 €</b> 3.040 €
20.12. - 27.12.2025 <b>2.432 €</b> 3.040 €			



WEBSITE

[www.plujeme.cz](http://www.plujeme.cz)



E-MAIL

[info@plujeme.cz](mailto:info@plujeme.cz)



PHONE

+420 720 755 085



MOBILE

+420 777 170 276



PLUJEME RÁDI S.R.O.

Dlouhá 730/35, 11000 Praha 1 – Staré Město, Czech Republic