

# OCEANIS 46.1

Contessa di Mare (2023)

Sailing yacht **Oceanis 46.1 Contessa di Mare**, built in **2023** is anchored in the **Pula, ACI Marina Pomer, Istra, Croatia**. It has **4 cabins**, can accommodate **8 + 2 people** and has **4 toilets**. Bed linen and kitchen equipment are included in the price.

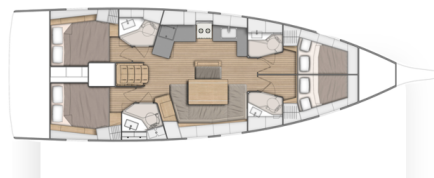

## YACHT SPECIFICATIONS

Yacht Base

**Pula, ACI Marina Pomer, Croatia**

Yacht ID

**9515**

Brands

**Beneteau**

Yacht name

**Contessa di Mare**

Production year

**2023**

Length

**48 ft**

Cabins

**4**

Berths

**8 + 2**

WC

**4**

Engine

**1 x 80 HP**

Fuel tank

**200 l**



**WEBSITE**

[www.plujeme.cz](http://www.plujeme.cz)



**PHONE**

+420 720 755 085



**MOBILE**

+420 777 170 276



**E-MAIL**

[info@plujeme.cz](mailto:info@plujeme.cz)



**PLUJEME RÁDI S.R.O.**

Dlouhá 730/35, 11000 Praha 1 – Staré Město, Czech Republic

## STANDARD YACHT EQUIPMENT

Comfort	<b>Cockpit cushions</b>
Deck	<b>Anchor line, Anchor swivel, Bimini top, Black ball, Black conus, Bosun's chair (Safe seat) (boatswain's chair), Cockpit table with light, Cockpit/stern, outside shower, Dinghy, Dinghy (byboat) pump, Electric anchor windlass, Fenders, Gangway, Hawser, Main anchor, Mooring ropes , Plastic bucket, Repair box for dinghy, Round/globular fender, Spare anchor (Reserve, Auxiliary anchor), Sprayhood, Spring line, Water hose</b>
Entertainment	<b>Outdoor speakers, Radio</b>
Galley	<b>Gas bottles, Hot water, Ice box, Kitchen utensils (Galley equipment, cutlery), Refrigerator</b>
Interior	<b>Barometer, Clock, Lowerable salon table</b>
Navigation	<b>AIS, Autopilot, Bow thruster, Bretonplotter, GPS, GPS chart plotter, Hand bearing compass, Harbour guides, Logge/Lot/Speed/Wind, Navigation (Nautical) charts and nautical guide , Navigation set, Parallel ruler, Radar reflector, Spyglass with bearing compass, Tridata, Windex</b>
Safety	<b>Distress signals, Fire extinguisher , First aid kit , Flashlight, Fog horn, Inflatable life raft, Life belts (Safety harness), Life buoy + Flashing light, Life jackets, Liferaft , Set of tools , VHF radio</b>
Yacht electrics	<b>Battery charger , Heating, Inverter, Shore connection 220 V, USB sockets</b>



**WEBSITE**

[www.plujeme.cz](http://www.plujeme.cz)



**PHONE**

+420 720 755 085



**MOBILE**

+420 777 170 276



**E-MAIL**

[info@plujeme.cz](mailto:info@plujeme.cz)



**PLUJEME RÁDI S.R.O.**

Dlouhá 730/35, 11000 Praha 1 – Staré Město, Czech Republic

## SERVICES

SELECTED SERVICES	OBLIGATORY	PAYMENT TYPE	PRICE
<b>Electric outboard engine</b> (Payable at the base) <b>Season: 2025.</b>	Yes	per booking	<b>0,00 €</b>
<b>Transit log</b> (Payable at the base) <b>Season: 2025.</b> Basic: Cleaning, check-in, diving, check-out, Wi-Fi 125 GB, bedlinen, garbage bags (kitchen & toilet), gas bottles, filled up with drinking water (tanks), fuel for outboard engine, toilet basics (paper/soap), Exclusive SMS warning and forecasts, ACI Pomer berth, Live tracking and route export	Yes	per booking	<b>305,00 €</b>
<b>Deposit insurance</b> (Payable at the base) <b>Season: 2025.</b> + € 250 (deposit)	No	per booking	<b>320,00 €</b>
<b>Early Check in</b> (Payable at the base) <b>Season: 2025.</b> max. 3 yachts	No	per booking	<b>330,00 €</b>
<b>Extra cleaning</b> (Payable at the base) <b>Season: 2025.</b> + change of bed linen, on request	No	per service	<b>213,50 €</b>
<b>Extra fee for Italy</b> (Payable at the base) <b>Season: 2025.</b> Sail to Italy Package Inkl. Flags, sea maps, insurances	No	per week	<b>100,00 €</b>
<b>Hostess</b> (Payable at the base) <b>Season: 2025.</b> Own cabin	No	per day + food	<b>200,00 €</b>
<b>Late return to base</b> (Payable at the base) <b>Season: 2025.</b> +Diver, until 7 pm	No	per booking	<b>200,00 €</b>
<b>Late return to base</b> (Payable at the base) <b>Season: 2025.</b> +Diver, after 7 pm	No	per booking	<b>400,00 €</b>
<b>Parking</b> (Payable at the base) <b>Season: 2025.</b> 1 Car	No	per week	<b>65,00 €</b>
<b>Parking</b> (Payable at the base) <b>Season: 2025.</b> 2 Cars	No	per week	<b>115,00 €</b>
<b>Skipper</b> (Payable at the base) <b>Season: 2025.</b> Own cabin	No	per day + food	<b>200,00 €</b>

<b>Surcharge for missing fuel, + Fuel price</b> (Payable at the base) <b>Season: 2025.</b>	No	per service	<b>50,00 €</b>
<b>Upgrade Permit DELUXE</b> (Payable at the base) <b>Season: 2025.</b> Deluxe: Transit log Basic + Kitchen Basics, parking (max 2 cars), towel set (small+big) for crew, 1x SUP	No	per booking	<b>145,00 €</b>
<b>Upgrade Permit EXCLUSIVE</b> (Payable at the base) <b>Season: 2025.</b> Exclusive: Transit log Basic + Kitchen Basics, parking (max 3 cars), towel set (small+big) for crew, 2x SUP, BBQ - Magma Gasgrill, Wineglasses 6 in a set, Istrian White Wine (2 Bottels), Istrian Native Olive Oil 5*	No	per booking	<b>185,00 €</b>



**WEBSITE**  
www.plujeme.cz



**E-MAIL**  
info@plujeme.cz



**PHONE**  
+420 720 755 085



**PLUJEME RÁDI S.R.O.**  
Dlouhá 730/35, 11000 Praha 1 – Staré Město, Czech Republic



**MOBILE**  
+420 777 170 276

## ADDITIONAL EXTRAS

EXTRA	OBLIGATORY	PAYMENT TYPE	PRICE
<b>Extra bedlinen</b> (Payable at the base) <b>Season: 2025.</b> Payable at the base	No	per set	<b>10,00 €</b>
<b>Gennaker</b> (Payable at the base) <b>Season: 2025.</b> on request - Payable at the base	No	per booking	<b>250,00 €</b>
<b>Grill/Barbecue/Plancha</b> (Payable at the base) <b>Season: 2025.</b> GAS - Payable at the base	No	per week	<b>130,00 €</b>
<b>Stand up paddle (SUP)</b> (Payable at the base) <b>Season: 2025.</b> Payable at the base	No	per week	<b>100,00 €</b>
<b>Towels</b> (Payable at the base) <b>Season: 2025.</b> Payable at the base	No	per set	<b>15,00 €</b>
<b>Towing air tube</b> (Payable at the base) <b>Season: 2025.</b> Payable at the base	No	per week	<b>80,00 €</b>



**WEBSITE**  
www.plujeme.cz



**E-MAIL**  
info@plujeme.cz



**PHONE**  
+420 720 755 085



**MOBILE**  
+420 777 170 276



**PLUJEME RÁDI S.R.O.**  
Dlouhá 730/35, 11000 Praha 1 – Staré Město, Czech Republic

## PRICE AND AVAILABILITY

<b>29.03. - 05.04.2025</b> <b>1.536 €</b> 1.920 €	<b>05.04. - 12.04.2025</b> <b>1.536 €</b> 1.920 €	<b>12.04. - 19.04.2025</b> <b>1.774 €</b> 2.217 €	<b>19.04. - 26.04.2025</b> <b>1.774 €</b> 2.217 €
<b>26.04. - 03.05.2025</b> <b>2.301 €</b> 2.876 €	<b>03.05. - 10.05.2025</b> <b>2.301 €</b> 2.876 €	<b>10.05. - 17.05.2025</b> NOT AVAILABLE	<b>17.05. - 24.05.2025</b> NOT AVAILABLE
<b>24.05. - 31.05.2025</b> NOT AVAILABLE	<b>31.05. - 07.06.2025</b> <b>3.381 €</b> 4.226 €	<b>07.06. - 14.06.2025</b> <b>4.005 €</b> 5.006 €	<b>14.06. - 21.06.2025</b> <b>4.005 €</b> 5.006 €
<b>21.06. - 05.07.2025</b> NOT AVAILABLE	<b>05.07. - 26.07.2025</b> NOT AVAILABLE	<b>26.07. - 02.08.2025</b> <b>4.056 €</b> 5.069 €	<b>02.08. - 09.08.2025</b> <b>4.056 €</b> 5.069 €
<b>09.08. - 16.08.2025</b> NOT AVAILABLE	<b>16.08. - 23.08.2025</b> <b>4.056 €</b> 5.069 €	<b>23.08. - 30.08.2025</b> <b>4.056 €</b> 5.069 €	<b>30.08. - 06.09.2025</b> <b>3.888 €</b> 4.860 €
<b>10.09. - 20.09.2025</b> NOT AVAILABLE	<b>20.09. - 27.09.2025</b> <b>3.162 €</b> 3.953 €	<b>27.09. - 04.10.2025</b> <b>2.678 €</b> 3.348 €	



**WEBSITE**  
[www.plujeme.cz](http://www.plujeme.cz)



**E-MAIL**  
[info@plujeme.cz](mailto:info@plujeme.cz)



**PHONE**  
+420 720 755 085



**PLUJEME RÁDI S.R.O.**  
Dlouhá 730/35, 11000 Praha 1 – Staré Město, Czech Republic



**MOBILE**  
+420 777 170 276

## PRICE AND AVAILABILITY

04.10. - 11.10.2025

NOT AVAILABLE

11.10. - 18.10.2025

**2.203 €** 2.754 €

18.10. - 25.10.2025

**1.536 €** 1.920 €

25.10. - 01.11.2025

**1.536 €** 1.920 €

01.11. - 08.11.2025

**1.536 €** 1.920 €

08.11. - 15.11.2025

**1.536 €** 1.920 €

15.11. - 22.11.2025

**1.536 €** 1.920 €

22.11. - 29.11.2025

**1.536 €** 1.920 €

30.11. - 31.12.2025

NOT AVAILABLE



**WEBSITE**

[www.plujeme.cz](http://www.plujeme.cz)



**E-MAIL**

[info@plujeme.cz](mailto:info@plujeme.cz)



**PHONE**

+420 720 755 085



**MOBILE**

+420 777 170 276



**PLUJEME RÁDI S.R.O.**

Dlouhá 730/35, 11000 Praha 1 – Staré Město, Czech Republic