

FOUNTAIN PAJOT TANNA 47

Prinz Eugen (2025)

Catamaran Fountaine Pajot Tanna 47 Prinz Eugen, built in 2025 is anchored in the Pula, Marina Polesana, Istra, Croatia. It has **5 + 1 cabins**, can accommodate **10 + 1 + 1 people** and has **5 + 1 toilets**. Bed linen and kitchen equipment are included in the price.

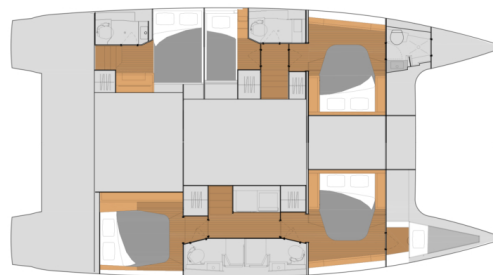

YACHT SPECIFICATIONS

Yacht Base

Pula, Marina Polesana, Croatia

Yacht ID

9460

Brands

Fountaine Pajot

Yacht name

Prinz Eugen

Production year

2025

Length

46 ft

Cabins

5 + 1

Berths

10 + 1 + 1

Max Persons

12

WC

5 + 1

Engine

2 x 60 HP

Fuel tank

940 l



WEBSITE

www.plujeme.cz



PHONE

+420 720 755 085



MOBILE

+420 777 170 276



E-MAIL

info@plujeme.cz



PLUJEME RÁDI S.R.O.

Dlouhá 730/35, 11000 Praha 1 – Staré Město, Czech Republic

STANDARD YACHT EQUIPMENT

Deck	Anchor line, Anchor swivel, Bimini top, Black ball, Black conus, Boat hook, Bosun's chair (Safe seat) (boatswain's chair), Canister for water, Cockpit grill, Cockpit table, Cockpit/stern, outside shower, Davit, Dinghy, Dinghy (byboat) pump, Electric anchor windlass, Fenders, Gangway, Hawser, Impeller, V-belt, oilfilter, Jerry cans for fuel, Main anchor, Mooring ropes , Plastic bucket, Repair box for dinghy, Round/globular fender, Spare anchor (Reserve, Auxiliary anchor), Spotlight / Headlights, Sprayhood, Spring line, Teak cockpit, Water hose
Entertainment	Outdoor speakers, Radio
Galley	Gas bottles, Hot water, Kitchen utensils (Galley equipment, cutlery), Refrigerator
Interior	Barometer, Clock, Electric fans in cabins, Electric toilet, Lowerable salon table
Navigation	AIS, Autopilot, Bretonplotter, GPS chart plotter - cockpit, Hand bearing compass, Harbour guides, Logge/Lot/Speed/Wind, Navigation (Nautical) charts and nautical guide , Parallel ruler, Radar reflector, Spyglass, Tridata, Windex
Safety	Distress signals, Fire extinguisher , First aid kit , Flashlight, Fog horn, Life belts (Safety harness), Life buoy + Flashing light, Life jackets, Liferaft , Set of tools , VHF radio , Wire (shroud) cutter
Sails	Lazy bag, Lazy jacks
Yacht electrics	Air Conditioning, Batteries, Battery charger , Generator, Inverter, Shore connection 220 V, Solar panels, USB sockets



WEBSITE

www.plujeme.cz



PHONE

+420 720 755 085



MOBILE

+420 777 170 276



E-MAIL

info@plujeme.cz



PLUJEME RÁDI S.R.O.

Dlouhá 730/35, 11000 Praha 1 – Staré Město, Czech Republic

SERVICES

SELECTED SERVICES	OBLIGATORY	PAYMENT TYPE	PRICE
Permit (Payable at the base) Season: 2025.	Yes	per booking	395,00 €
WI-FI Internet connection on boat (Payable at the base) Season: 2025. 5 GB, included in price	Yes	per booking	0,00 €
Early boarding/check-in (Payable at the base) Season: 2025. Check-in 1.00 pm – 2.00 pm, max 5 yachts	Yes	per booking	160,00 €
Extra cleaning (Payable at the base) Season: 2025.	Yes	per booking	110,00 €
Hostess (Payable at the base) Season: 2025. + own cabin; external service provider, direct billing	Yes	per day + food	200,00 €
Regatta charge (Payable at the base) Season: 2025. on request	Yes	per booking	0,00 €
Skipper (Payable at the base) Season: 2025. + own cabin; external service provider	Yes	per day + food	200,00 €



WEBSITE
www.plujeme.cz



E-MAIL
info@plujeme.cz



PHONE
+420 720 755 085



PLUJEME RÁDI S.R.O.
Dlouhá 730/35, 11000 Praha 1 – Staré Město, Czech Republic



MOBILE
+420 777 170 276

ADDITIONAL EXTRAS

EXTRA	OBLIGATORY	PAYMENT TYPE	PRICE
Extra bedlinen (Payable at the base) Season: 2025. 1 set/ person is included in the charter price - Payable at the base	Yes	per set	7,00 €
Outboard engine (Payable at the base) Season: 2025. included in price - Payable at the base	Yes	per week	0,00 €
Railing net (Safety net) (Payable at the base) Season: 2025. Payable at the base	Yes	per booking	120,00 €
Stand up paddle (SUP) (Payable at the base) Season: 2025. Payable at the base	Yes	per week	100,00 €
Towels (Payable at the base) Season: 2025. Payable at the base	Yes	per set	7,00 €

**WEBSITE**www.plujeme.cz**E-MAIL**info@plujeme.cz**PHONE**

+420 720 755 085

**MOBILE**

+420 777 170 276

**PLUJEME RÁDI S.R.O.**

Dlouhá 730/35, 11000 Praha 1 – Staré Město, Czech Republic

PRICE AND AVAILABILITY

07.06. - 14.06.2025 ON OPTION	14.06. - 21.06.2025 NOT AVAILABLE	21.06. - 28.06.2025 NOT AVAILABLE	28.06. - 05.07.2025 10.712 € 13.390 €
09.07. - 23.07.2025 NOT AVAILABLE	23.07. - 30.07.2025 NOT AVAILABLE	02.08. - 09.08.2025 12.872 € 16.090 €	09.08. - 16.08.2025 12.872 € 16.090 €
20.08. - 27.08.2025 NOT AVAILABLE	30.08. - 06.09.2025 9.640 € 12.050 €	06.09. - 13.09.2025 9.120 € 11.400 €	13.09. - 20.09.2025 ON OPTION
20.09. - 27.09.2025 5.720 € 7.150 €	27.09. - 11.10.2025 NOT AVAILABLE	11.10. - 18.10.2025 3.160 € 3.950 €	18.10. - 25.10.2025 3.080 € 3.850 €
25.10. - 01.11.2025 3.000 € 3.750 €	01.11. - 08.11.2025 3.000 € 3.750 €	08.11. - 15.11.2025 3.000 € 3.750 €	15.11. - 22.11.2025 3.000 € 3.750 €
23.11. - 31.12.2025 NOT AVAILABLE			



WEBSITE

www.plujeme.cz



E-MAIL

info@plujeme.cz



PHONE

+420 720 755 085



MOBILE

+420 777 170 276



PLUJEME RÁDI S.R.O.

Dlouhá 730/35, 11000 Praha 1 – Staré Město, Czech Republic