

MOTOR YACHT 4.S

MY ANGEL (2022)

Power catamaran Motor Yacht 4.S MY ANGEL, built in 2022 is anchored in the Athens, Alimos marina, Athens area/Saronic/Peloponese, Greece. It has 4 cabins, can accommodate 8 people and has 2 toilets. Bed linen and kitchen equipment are included in the price.

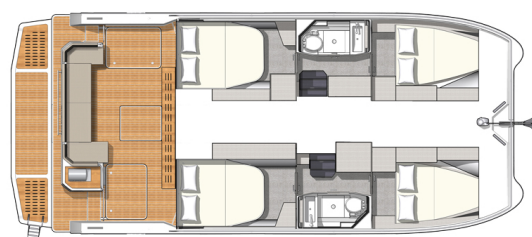

YACHT SPECIFICATIONS

Yacht Base

Athens, Alimos marina, Greece

Yacht ID

9316

Brands

Fountaine Pajot

Yacht name

MY ANGEL

Production year

2022

Length

36 ft

Cabins

4

Berths

8

Max Persons

8

WC

2

Engine

2 x 220 HP

Fuel tank

1200 l



WEBSITE

www.plujeme.cz



PHONE

+420 720 755 085



MOBILE

+420 777 170 276



E-MAIL

info@plujeme.cz



PLUJEME RÁDI S.R.O.

Dlouhá 730/35, 11000 Praha 1 – Staré Město, Czech Republic

STANDARD YACHT EQUIPMENT

Comfort	Sun loungers
Deck	Cockpit/stern, outside shower, Dinghy with outboard engine, Electric anchor windlass, Grill/Barbecue/Plancha, Remote control for anchor winch with chain counter at helm, Sun roof, Swimming ladder
Entertainment	FUSION sound system, LCD TV
Galley	Freezer, Oven, Refrigerator
Interior	Electric fans in cabins, Electric toilet
Navigation	Autopilot, Depthsounder, GPS chart plotter - cockpit, Speedometer (Speed log)
Safety	VHF radio
Yacht electrics	Air Conditioning, Generator, Inverter, Solar panels, USB sockets



WEBSITE

www.plujeme.cz



E-MAIL

info@plujeme.cz



PHONE

+420 720 755 085



MOBILE

+420 777 170 276



PLUJEME RÁDI S.R.O.

Dlouhá 730/35, 11000 Praha 1 – Staré Město, Czech Republic

SERVICES

SELECTED SERVICES	OBLIGATORY	PAYMENT TYPE	PRICE
Final cleaning (Payable now) Season: 2025. included in Essentials pack	Yes	per booking	285,00 €
Handling fees (Payable now) Season: 2025.	Yes	per booking	20,00 €
Starter pack (Payable now) Season: 2025. included in Essentials pack (The pack includes: 1 gallon water (or 4 bottles of 1.5L), 1 bottle of disinfectant, 1 small bottle of washing up liquid, 1 dish cloth, 1 sponge, garbage bags, 1 roll of paper towels, 1 box of matches, 1 roll of toilet paper in each head)	Yes	per booking	30,00 €
Crew change (Payable now) Season: 2025. Any crew change during the charter is subject to € 200.- additional cost. The charge includes administration cost, change of bed linen and towels and one night at DYC ponton (marina fee included only if the same base than start base). It doesn't include cleaning, nor new transit log where applicable.	No	per booking	200,00 €
Early boarding/check-in (Payable now) Season: 2025. EB (boat only) - 13:00h, starting time of boat's delivery // limited number of early boardings on same departure day	No	per booking	300,00 €
Early boarding/check-in (Payable now) Season: 2025. EB + extra fee skipper - 13:00h, starting time of boat's delivery // limited number of early boardings on same departure day	No	per booking	405,00 €
Early boarding/check-in (Payable now) Season: 2025. EB + extra fee Skipper & Hostess - 13:00h, starting time of boat's delivery // limited number of early boardings on same departure day	No	per booking	503,00 €
Extra set of linen (choose how many) (Payable now) Season: 2025. Extra set of linen : 15 € 1 extra set of linen (2 sheets & 2 pillow case) - to be updated manually	No	per booking	15,00 €
Extra set of towels (choose how many) (Payable now) Season: 2025. Extra set of towels: 10 € 1 extra set of towels (1 face & 1 bath towel) - to be updated manually	No	per booking	10,00 €

Full board 1-4 pax (number of guests to update manually) (Payable now) Season: 2025. only available if cook is booked on board as the cook will do the provisioning based on client's preference. Includes breakfast, lunch & dinner + the crew's food. Does not included alcoholic drinks	No	per guest/day	60,00 €
Full board 5-12 pax (number of guests to update manually) (Payable now) Season: 2025. only available if cook is booked on board as the cook will do the provisioning based on client's preference. Includes breakfast, lunch & dinner + the crew's food. Does not included alcoholic drinks	No	per guest/day	55,00 €
Half board 1-4 pax (number of guests to update manually) (Payable now) Season: 2025. only available if cook is booked on board as the cook will do the provisioning based on client's preference. Includes breakfast & lunch OR dinner + the crew's food. Does not included alcoholic drinks	No	per guest/day	50,00 €
Half board 5-12 pax (number of guests to update manually) (Payable now) Season: 2025. only available if cook is booked on board as the cook will do the provisioning based on client's preference. Includes breakfast & lunch OR dinner + the crew's food. Does not included alcoholic drinks	No	per guest/day	45,00 €
Hostess/Cook (Payable now) Season: 2025. + provisioning, a cabin or forepeak to sleep and access to a WC/Shower	No	per night	195,00 €
Regatta surcharge (Payable now) Season: 2025. A special race deposit need to be doubled manually once the regatta surcharge is added.	No	per booking	0,00 €
Skipper (Payable now) Season: 2025. + provisioning, a cabin or forepeak to sleep and access to a WC/Shower	No	per night	210,00 €
Transfer (Payable now) Season: 2025. OW - Athens airport / Base 1 to 3 Pax - For transfers during hours 21:00-06:00h and bank holidays price should be raised by 30€ one-way, or 60€ round trip	No	one-way	65,00 €
Transfer (Payable now) Season: 2025. OW - Athens airport / Base 4 to 8 Pax - For transfers during hours 21:00-06:00h and bank holidays price should be raised by 30€ one-way, or 60€ round trip	No	one-way	123,50 €
Transfer (Payable now) Season: 2025. OW - Athens airport / Base 9 to 17 Pax - For transfers during hours 21:00-06:00h and bank holidays price should be raised by 30€ one-way, or 60€ round trip	No	one-way	156,00 €

WI-FI Internet connection on boat (Payable now)

No

per week

50,00 €

Season: 2025. unlimited data



WEBSITE

www.plujeme.cz



E-MAIL

info@plujeme.cz



PHONE

+420 720 755 085



MOBILE

+420 777 170 276



PLUJEME RÁDI S.R.O.

Dlouhá 730/35, 11000 Praha 1 – Staré Město, Czech Republic

ADDITIONAL EXTRAS

EXTRA	OBLIGATORY	PAYMENT TYPE	PRICE
Outboard engine 8 & 9,8 HP (Payable now) Season: 2025. Subject to Availability ; 8 & 9.8hp. Dinghy not suitable in any case for waterski or wakeboard. Additional security deposit of 500 € - Payable now	No	per day	35,00 €
Stand up paddle (SUP) (Payable now) Season: 2025. Price per day / Additional deposit 100 EUR - Payable now	No	per night	15,00 €



WEBSITE

www.plujeme.cz



E-MAIL

info@plujeme.cz



PHONE

+420 720 755 085



MOBILE

+420 777 170 276



PLUJEME RÁDI S.R.O.

Dlouhá 730/35, 11000 Praha 1 – Staré Město, Czech Republic

PRICE AND AVAILABILITY

23.11. - 30.11.2024 1.910 €	02.12. - 27.02.2025 NOT AVAILABLE	01.03. - 08.03.2025 2.128 € 2.240 €	08.03. - 15.03.2025 2.128 € 2.240 €
15.03. - 22.03.2025 2.128 € 2.240 €	22.03. - 12.04.2025 NOT AVAILABLE	12.04. - 19.04.2025 2.313 € 2.435 €	19.04. - 26.04.2025 NOT AVAILABLE
26.04. - 03.05.2025 3.420 € 3.600 €	03.05. - 10.05.2025 NOT AVAILABLE	10.05. - 17.05.2025 NOT AVAILABLE	17.05. - 24.05.2025 3.781 € 3.980 €
24.05. - 31.05.2025 NOT AVAILABLE	31.05. - 07.06.2025 NOT AVAILABLE	07.06. - 14.06.2025 NOT AVAILABLE	14.06. - 21.06.2025 5.714 € 6.015 €
21.06. - 28.06.2025 5.995 € 6.310 €	28.06. - 05.07.2025 6.180 € 6.505 €		



WEBSITE

www.plujeme.cz



E-MAIL

info@plujeme.cz



PHONE

+420 720 755 085



MOBILE

+420 777 170 276



PLUJEME RÁDI S.R.O.

Dlouhá 730/35, 11000 Praha 1 – Staré Město, Czech Republic

PRICE AND AVAILABILITY

05.07. - 12.07.2025 7.268 € 7.650 €	12.07. - 19.07.2025 7.652 € 8.055 €	19.07. - 26.07.2025 7.652 € 8.055 €	26.07. - 02.08.2025 8.175 € 8.605 €
02.08. - 09.08.2025 8.607 € 9.060 €	09.08. - 16.08.2025 8.607 € 9.060 €	16.08. - 23.08.2025 7.358 € 7.745 €	23.08. - 30.08.2025 6.375 € 6.710 €
30.08. - 06.09.2025 6.375 € 6.710 €	06.09. - 13.09.2025 6.185 € 6.510 €	13.09. - 20.09.2025 6.603 € 6.950 €	20.09. - 27.09.2025 5.990 € 6.305 €
27.09. - 04.10.2025 5.016 € 5.280 €	04.10. - 11.10.2025 4.019 € 4.230 €	11.10. - 18.10.2025 3.762 € 3.960 €	18.10. - 25.10.2025 2.575 € 2.710 €
25.10. - 01.11.2025 2.575 € 2.710 €	01.11. - 08.11.2025 2.128 € 2.240 €	08.11. - 15.11.2025 2.128 € 2.240 €	15.11. - 22.11.2025 2.128 € 2.240 €
22.11. - 29.11.2025 2.128 € 2.240 €	02.12. - 26.02.2026 NOT AVAILABLE		



WEBSITE

www.plujeme.cz



E-MAIL

info@plujeme.cz



PHONE

+420 720 755 085



MOBILE

+420 777 170 276



PLUJEME RÁDI S.R.O.

Dlouhá 730/35, 11000 Praha 1 – Staré Město, Czech Republic