

LAGOON 40

ELANOR (2020)

Catamaran Lagoon 40 ELANOR, built in 2020 is anchored in the **Palma de Mallorca, Marina Naviera Balear, Balearic Islands, Spain**. It has **4 + 2 cabins**, can accommodate **8 + 2 + 2 people** and has **4 toilets**. Bed linen and kitchen equipment are included in the price.

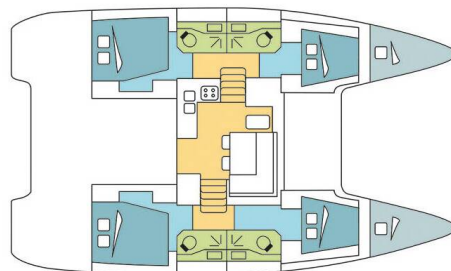

YACHT SPECIFICATIONS

Yacht Base

**Palma de Mallorca, Marina Naviera
Balear, Spain**

Yacht ID

9274

Brands

Lagoon

Yacht name

ELANOR

Production year

2020

Length

39 ft

Cabins

4 + 2

Berths

8 + 2 + 2

Max Persons

12

WC

4

Engine

2 x 45 HP

Fuel tank

400 l



WEBSITE

www.plujeme.cz



PHONE

+420 720 755 085



MOBILE

+420 777 170 276



E-MAIL

info@plujeme.cz



PLUJEME RÁDI S.R.O.

Dlouhá 730/35, 11000 Praha 1 - Staré Město, Czech Republic

STANDARD YACHT EQUIPMENT

Comfort	Cockpit cushions
Deck	Bimini top, Cockpit table, Cockpit/stern, outside shower, Dinghy, Electric anchor windlass, Outboard engine, Swimming ladder
Entertainment	Fusion radio, Outdoor speakers
Galley	Oven, Refrigerator, Stove
Interior	Convertible table, Convertible table in salon, Electric fans in cabins, Electric toilet
Navigation	Autopilot, Depthsounder, GPS chart plotter, Speedometer (Speed log), Wind instrument/Anemometer
Safety	VHF radio
Sails	Electric winch, Lazy bag, Lazy jacks
Yacht electrics	Inverter, Solar panels, USB sockets



WEBSITE

www.plujeme.cz



E-MAIL

info@plujeme.cz



PHONE

+420 720 755 085



MOBILE

+420 777 170 276



PLUJEME RÁDI S.R.O.

Dlouhá 730/35, 11000 Praha 1 – Staré Město, Czech Republic

SERVICES

SELECTED SERVICES	OBLIGATORY	PAYMENT TYPE	PRICE
Essentials pack (Payable now) Season: 2025. INCLUDED: full reduction of security deposit (0 € at base) // starter pack - (1 gallon water or 4 bottles of 1.5L, 1 bottle of disinfectant, 1 small bottle of washing up liquid, 1 dish cloth, 1 sponge, garbage bags, 1 roll of paper towels, 1 box of matches, 1 roll of toilet paper in each head) // final cleaning // 1 set of bed sheets & towels, dinghy, outboard engine & initial supply of fuel, gas and water tanks // DYC assistance guarantee // 1st & last night in the marina /// NOT INCLUDED: refuelling, gas & water consumption at end of charter, taxes if any, handling fees & additional equipment deposit.	Yes	per booking	600,00 €
Handling fees (Payable now) Season: 2025.	Yes	per booking	25,00 €
Cabrera permit (Payable now) Season: 2025. Cabrera National Park, please contact us: clients have to register directly (possible only 3 weeks before requested date), subject to availability.	No	per booking	0,00 €
Crew change (Payable now) Season: 2025. Any crew change during the charter is subject to € 200.- additional cost. The charge includes administration cost, change of bed linen and towels and one night at DYC ponton (marina fee included only if the same base than start base). It doesn't include cleaning, nor new transit log where applicable.	No	per booking	200,00 €
Early boarding/check-in (Payable now) Season: 2025. EB (boat only) - 13:00h, starting time of boat's delivery // limited number of early boardings on same departure day	No	per booking	300,00 €
Early boarding/check-in (Payable now) Season: 2025. EB + extra fee skipper - 13:00h, starting time of boat's delivery // limited number of early boardings on same departure day	No	per booking	430,00 €
Early boarding/check-in (Payable now) Season: 2025. EB + extra fee Skipper & Hostess - 13:00h, starting time of boat's delivery // limited number of early boardings on same departure day	No	per booking	533,00 €

Electric & Water consumption in the Marinas (Payable at the base)	No	per booking	28,00 €
Season: 2025. Electric & Water consumption based on 2 nights on our dock (base will confirm the amount to pay locally depending on nights spent on dock)			
Extra set of linen (choose how many) (Payable now)	No	per booking	15,00 €
Season: 2025. Extra set of linen : 15 € 1 extra set of linen (2 sheets & 2 pillow case) - to be updated manually			
Extra set of towels (choose how many) (Payable now)	No	per booking	10,00 €
Season: 2025. Extra set of towels: 10 € 1 extra set of towels (1 face & 1 bath towel) - to be updated manually			
Final cleaning (Payable now)	No	per booking	285,00 €
Season: 2025. included in Essentials pack			
Full board 1-4 pax (number of guests to update manually) (Payable now)	No	per guest/day	60,00 €
Season: 2025. only available if cook is booked on board as the cook will do the provisioning based on client's preference. Includes breakfast, lunch & dinner + the crew's food. Does not included alcoholic drinks			
Full board 5-12 pax (number of guests to update manually) (Payable now)	No	per guest/day	55,00 €
Season: 2025. only available if cook is booked on board as the cook will do the provisioning based on client's preference. Includes breakfast, lunch & dinner + the crew's food. Does not included alcoholic drinks			
Half board 1-4 pax (number of guests to update manually) (Payable now)	No	per guest/day	50,00 €
Season: 2025. only available if cook is booked on board as the cook will do the provisioning based on client's preference. Includes breakfast & lunch OR dinner + the crew's food. Does not included alcoholic drinks			
Half board 5-12 pax (number of guests to update manually) (Payable now)	No	per guest/day	45,00 €
Season: 2025. only available if cook is booked on board as the cook will do the provisioning based on client's preference. Includes breakfast & lunch OR dinner + the crew's food. Does not included alcoholic drinks			
Hostess/Cook (Payable now)	No	per night	215,00 €
Season: 2025. + provisioning, a cabin or forepeak to sleep and access to a WC/Shower			
Regatta surcharge (Payable now)	No	per booking	0,00 €
Season: 2025. A special race deposit need to be doubled manually once the regatta surcharge is added.			

Skipper (Payable now)	No	per night	270,00 €
Season: 2025. + provisioning, a cabin or forepeak to sleep and access to a WC/Shower			
Starter pack (Payable now)	No	per booking	35,00 €
Season: 2025. included in Essentials pack (The pack includes: 1 gallon water (or 4 bottles of 1.5L), 1 bottle of disinfectant, 1 small bottle of washing up liquid, 1 dish cloth, 1 sponge, garbage bags, 1 roll of paper towels, 1 box of matches, 1 roll of toilet paper in each head			
Transfer (Payable now)	No	round trip	90,00 €
Season: 2025. RT / Airport - Base - Airport Taxi (1-4 pax) Round trip transfer			
Transfer (Payable now)	No	round trip	160,00 €
Season: 2025. RT / Airport - Base - Airport Big Taxi (5-6pax) Round trip transfer			
Transfer (Payable now)	No	round trip	180,00 €
Season: 2025. RT / Airport - Base - Airport Big Taxi (7-8pax) Round trip transfer			
Transfer (Payable now)	No	round trip	220,00 €
Season: 2025. RT / Airport - Base - Airport Mini Bus(9-12pax) Round trip transfer			



WEBSITE

www.plujeme.cz



PHONE

+420 720 755 085



MOBILE

+420 777 170 276



E-MAIL

info@plujeme.cz



PLUJEME RÁDI S.R.O.

Dlouhá 730/35, 11000 Praha 1 – Staré Město, Czech Republic

ADDITIONAL EXTRAS

EXTRA	OBLIGATORY	PAYMENT TYPE	PRICE
Kayak single (Payable now) Season: 2025. Price per day / Additional deposit 100 EUR - Payable now	No	per night	15,00 €
Outboard engine 8 & 9,8 HP (Payable now) Season: 2025. Subject to Availability ; 8/9hp. Dinghy not suitable in any case for waterski or wakeboard. Additional security deposit of 500 € - Payable now	No	per day	35,00 €
Railing net (Safety net) (Payable now) Season: 2025. net is supplied but not installed - Payable now	No	per booking	250,00 €
Stand up paddle (SUP) (Payable now) Season: 2025. Price per day / Additional deposit 100 EUR - Payable now	No	per night	15,00 €

**WEBSITE**www.plujeme.cz**E-MAIL**info@plujeme.cz**PHONE**

+420 720 755 085

**MOBILE**

+420 777 170 276

**PLUJEME RÁDI S.R.O.**

Dlouhá 730/35, 11000 Praha 1 – Staré Město, Czech Republic

PRICE AND AVAILABILITY

23.11. - 30.11.2024 1.140 € 2.005 €	02.12. - 27.02.2025 NOT AVAILABLE	01.03. - 08.03.2025 2.019 € 2.125 €	08.03. - 15.03.2025 2.019 € 2.125 €
15.03. - 22.03.2025 2.019 € 2.125 €	22.03. - 29.03.2025 2.019 € 2.125 €	29.03. - 05.04.2025 2.019 € 2.125 €	05.04. - 12.04.2025 2.195 € 2.310 €
12.04. - 19.04.2025 2.608 € 2.745 €	19.04. - 26.04.2025 2.765 € 2.910 €	26.04. - 03.05.2025 2.625 € 3.070 €	03.05. - 10.05.2025 2.522 € 2.950 €
10.05. - 17.05.2025 3.322 € 3.885 €	17.05. - 24.05.2025 3.433 € 4.015 €	24.05. - 31.05.2025 4.134 € 4.835 €	31.05. - 07.06.2025 5.862 € 6.170 €
07.06. - 14.06.2025 7.082 € 7.455 €	14.06. - 21.06.2025 5.254 € 6.145 €	21.06. - 28.06.2025 5.716 € 6.685 €	28.06. - 05.07.2025 6.472 € 7.570 €



WEBSITE
www.plujeme.cz



E-MAIL
info@plujeme.cz



PHONE
+420 720 755 085



PLUJEME RÁDI S.R.O.
Dlouhá 730/35, 11000 Praha 1 – Staré Město, Czech Republic



MOBILE
+420 777 170 276

PRICE AND AVAILABILITY

05.07. - 12.07.2025 7.079 € 8.280 €	12.07. - 19.07.2025 7.614 € 8.905 €	19.07. - 26.07.2025 8.003 € 9.360 €	26.07. - 02.08.2025 8.003 € 9.360 €
02.08. - 09.08.2025 9.343 € 9.835 €	09.08. - 16.08.2025 9.343 € 9.835 €	16.08. - 23.08.2025 8.892 € 9.360 €	23.08. - 30.08.2025 7.116 € 7.490 €
30.08. - 06.09.2025 6.740 € 7.095 €	06.09. - 13.09.2025 6.085 € 6.405 €	13.09. - 20.09.2025 6.094 € 6.415 €	20.09. - 27.09.2025 5.054 € 5.320 €
27.09. - 11.10.2025 NOT AVAILABLE	11.10. - 18.10.2025 3.026 € 3.185 €	18.10. - 25.10.2025 2.727 € 2.870 €	25.10. - 01.11.2025 2.356 € 2.480 €
02.11. - 31.12.2025 NOT AVAILABLE			



WEBSITE

www.plujeme.cz



E-MAIL

info@plujeme.cz



PHONE

+420 720 755 085



MOBILE

+420 777 170 276



PLUJEME RÁDI S.R.O.

Dlouhá 730/35, 11000 Praha 1 – Staré Město, Czech Republic