

DUFOUR 520 GL

MOBY SICK (2020)

Sailing yacht Dufour 520 GL MOBY SICK, built in 2020 is anchored in the **Martinique, Le Marin, Martinique, Caribbean**. It has **5 cabins**, can accommodate **10 + 2 people** and has **3 toilets**. Bed linen and kitchen equipment are included in the price.

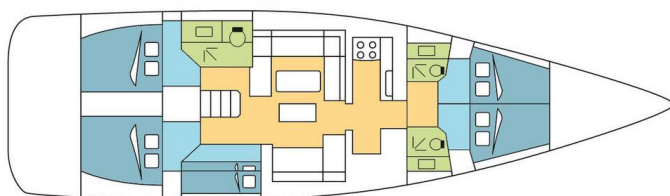

YACHT SPECIFICATIONS

Yacht Base

Martinique, Le Marin, Caribbean

Yacht ID

9249

Brands

Dufour

Yacht name

MOBY SICK

Production year

2020

Length

50 ft

Cabins

5

Berths

10 + 2

Max Persons

12

WC

3

Engine

1 x 110 HP

Fuel tank

440 l



WEBSITE

www.plujeme.cz



PHONE

+420 720 755 085



MOBILE

+420 777 170 276



E-MAIL

info@plujeme.cz



PLUJEME RÁDI S.R.O.

Dlouhá 730/35, 11000 Praha 1 – Staré Město, Czech Republic

STANDARD YACHT EQUIPMENT

Comfort	Cockpit cushions
Deck	Bathing platform, Bimini top, Cockpit table, Cockpit/stern, outside shower, Dinghy, Electric anchor windlass, Outboard engine, Sprayhood, Swimming ladder
Entertainment	Outdoor speakers, Radio
Galley	Refrigerator
Interior	Convertible table, Convertible table in salon, Electric fans in cabins
Navigation	Autopilot, Depthsounder, GPS chart plotter, Wind instrument/Anemometer
Safety	VHF radio
Sails	Lazy bag, Lazy jacks, Self tailing (manual) winch
Yacht electrics	220V socket, Air Conditioning, Generator, Inverter, Watermaker - desalinator, WC pump

**WEBSITE**

www.plujeme.cz

**E-MAIL**

info@plujeme.cz

**PHONE**

+420 720 755 085

**MOBILE**

+420 777 170 276

**PLUJEME RÁDI S.R.O.**

Dlouhá 730/35, 11000 Praha 1 – Staré Město, Czech Republic

SERVICES

SELECTED SERVICES	OBLIGATORY	PAYMENT TYPE	PRICE
Essentials pack (Payable now) Season: 2025 Exotic . INCLUDED: full reduction of security deposit (0 € at base)// starter pack – (1 gallon water or 4 bottles of 1.5L, 1 bottle of disinfectant, 1 small bottle of washing up liquid, 1 dish cloth, 1 sponge, garbage bags, 1 roll of paper towels, 1 box of matches, 1 roll of toilet paper in each head)// final cleaning // 1 set of bed sheets & towels, dinghy, outboard engine & initial supply of fuel, gas and water tanks// DYC assistance guarantee // 1st & last night in the marina /// NOT INCLUDED: refuelling, gas & water consumption at end of charter, taxes if any, handling fees, additional equipment deposit	Yes	per booking	685,00 €
Handling fees (Payable now) Season: 2025 Exotic .	Yes	per booking	35,00 €
Crew change (Payable now) Season: 2025 Exotic . Any crew change during the charter is subject to € 200.- additional cost. The charge includes administration cost, change of bed linen and towels and one night at DYC ponton (marina fee included only if the same base than start base). It doesn't include cleaning, nor new transit log where applicable.	No	per booking	200,00 €
Diving (Payable now) Season: 2025 Exotic . For bareboat charters only Upon request	No	per booking	0,00 €
Early boarding/check-in (Payable now) Season: 2025 Exotic . EB (boat only) - 14:00 h / 2 PM starting time of boat's delivery // limited number of early boardings on same departure day	No	per booking	450,00 €
Early boarding/check-in (Payable now) Season: 2025 Exotic . EB boat + extra fee skipper - 14:00 h / 2 PM starting time of boat's delivery // limited number of early boardings on same departure day	No	per booking	670,00 €
Early boarding/check-in (Payable now) Season: 2025 Exotic . EB + extra fee Skipper & Hostes - 14:00 h / 2 PM starting time of boat's delivery // limited number of early boardings on same departure day	No	per booking	855,00 €

Electric & Water consumption in the Marinas (Payable at the base) Season: 2025 Exotic . Electric & Water consumption based on 2 nights on our dock (base will confirm the amount to pay locally depending on nights spent on dock)	No	per booking	28,00 €
Extra set of linen (choose how many) (Payable now) Season: 2025 Exotic . Extra set of linen : 15 € 1 set of linen (2 sheets & 2 pillow case) - to be updated manually	No	per booking	15,00 €
Extra set of towels (choose how many) (Payable now) Season: 2025 Exotic . Extra set of towels: 10 € 1 set of towels (1 face & 1 bath towel) - to be updated manually	No	per booking	10,00 €
Final cleaning (Payable now) Season: 2025 Exotic . included in Essentials pack	No	per booking	290,00 €
Full board 1-4 pax (number of guests to update manually) (Payable now) Season: 2025 Exotic . only available if cook is booked on board as the cook will do the provisioning based on client's preference. Includes breakfast, lunch & dinner + the crew's food. Does not included alcoholic drinks	No	per guest/day	65,00 €
Full board 5-12 pax (number of guests to update manually) (Payable now) Season: 2025 Exotic . only available if cook is booked on board as the cook will do the provisioning based on client's preference. Includes breakfast, lunch & dinner + the crew's food. Does not included alcoholic drinks	No	per guest/day	60,00 €
Half board 1-4 pax (number of guests to update manually) (Payable now) Season: 2025 Exotic . only available if cook is booked on board as the cook will do the provisioning based on client's preference. Includes breakfast & lunch OR dinner + the crew's food. Does not included alcoholic drinks	No	per guest/day	55,00 €
Half board 5-12 pax (number of guests to update manually) (Payable now) Season: 2025 Exotic . only available if cook is booked on board as the cook will do the provisioning based on client's preference. Includes breakfast & lunch OR dinner + the crew's food. Does not included alcoholic drinks	No	per guest/day	50,00 €
Hostess (Payable now) Season: 2025 Exotic . + provisioning, a cabin or forepeak to sleep and access to a WC/Shower	No	per night	200,00 €
Race pack (Payable now) Season: 2025 Exotic . BVI Spring Regatta, Briefing before the race, preparation and gauging of sails, registration of the yacht (not of the passengers), technical assistance during the race *** technical assistance during the race not valid for RORC Caribbean 600 // A special race deposit need to be doubled manually once the race fee is added.	No	per booking	1.320,00 €

Race pack (Payable now)	No	per booking	1.650,00 €
Season: 2025 Exotic . Antigua, Briefing before the race, preparation and gauging of sails, registration of the yacht (not of the passengers), technical assistance during the race *** technical assistance during the race not valid for RORC Caribbean 600 // A special race deposit need to be doubled manually once the race fee is added.			
Race pack (Payable now)	No	per booking	1.650,00 €
Season: 2025 Exotic . RORC caribbean 600, Briefing before the race, preparation and gauging of sails, registration of the yacht (not of the passengers), technical assistance during the race *** technical assistance during the race not valid for RORC Caribbean 600 // A special race deposit need to be doubled manually once the race fee is added.			
Regatta surcharge (Payable now)	No	per booking	2.300,00 €
Season: 2025 Exotic . valid for ASW regatta only // A special race deposit need to be doubled manually once the regatta surcharge is added.			
Regatta surcharge (Payable now)	No	per booking	0,00 €
Season: 2025 Exotic . all the regattas apart of ASW (different regatta surcharge for ASW) // A special race deposit need to be doubled manually once the regatta surcharge is added.			
Same day briefing (Payable now)	No	per booking	150,00 €
Season: 2025 Exotic . Same day briefing starting between 5 & 5.30pm (departure following morning)			
Skipper (Payable now)	No	per night	260,00 €
Season: 2025 Exotic . + provisioning, a cabin or forepeak to sleep and access to a WC/Shower			
Starter pack (Payable now)	No	per booking	50,00 €
Season: 2025 Exotic . included in Essentials pack (The pack includes: 1 gallon water (or 4 bottles of 1.5L), 1 bottle of disinfectant, 1 small bottle of washing up liquid, 1 dish cloth, 1 sponge, garbage bags, 1 roll of paper towels, 1 box of matches, 1 roll of toilet paper in each head			
Transfer (Payable now)	No	one-way	97,50 €
Season: 2025 Exotic . OW - FDF Airport/Base/Airport one-way 1-4 pax			
Transfer (Payable now)	No	one-way	117,00 €
Season: 2025 Exotic . OW - FDF Airport/Base/Airport one-way 5-6 pax			
Transfer (Payable now)	No	one-way	136,50 €
Season: 2025 Exotic . OW- FDF Airport/Base/Airport one-way 7- 8 pax			

Transfer (Payable now)	No	round trip	195,00 €
Season: 2025 Exotic . RT - FDF Airport/Base/Airport RT 1-4 pax			
Transfer (Payable now)	No	one-way	225,00 €
Season: 2025 Exotic . OW - FDF Airport/Base/Airport one-way 9-12 pax			
Transfer (Payable now)	No	round trip	234,00 €
Season: 2025 Exotic . RT - FDF Airport/Base/Airport RT 5-6 pax			
Transfer (Payable now)	No	one-way	253,50 €
Season: 2025 Exotic . OW - FDF Airport/Base/Airport One-way 13-14 pax			
Transfer (Payable now)	No	round trip	273,00 €
Season: 2025 Exotic . RT - FDF Airport/Base/Airport RT 7-8 pax			
Transfer (Payable now)	No	round trip	450,00 €
Season: 2025 Exotic . RT - FDF Airport/Base/Airport RT 9-12 pax			
Transfer (Payable now)	No	round trip	507,00 €
Season: 2025 Exotic . RT - FDF Airport/Base/Airport RT 13-14 pax			



WEBSITE

www.plujeme.cz



PHONE

+420 720 755 085



MOBILE

+420 777 170 276



E-MAIL

info@plujeme.cz



PLUJEME RÁDI S.R.O.

Dlouhá 730/35, 11000 Praha 1 – Staré Město, Czech Republic

ADDITIONAL EXTRAS

EXTRA	OBLIGATORY	PAYMENT TYPE	PRICE
Fishing equipment (Payable now) Season: 2025 Exotic . Additional deposit 100 EUR (subject to availability) - Payable now	No	per day	15,00 €
Kayak single (Payable now) Season: 2025 Exotic . price per day - Additional deposit 100 EUR - Payable now	No	per night	15,00 €
Kayak tandem (Payable now) Season: 2025 Exotic . price per day - Additional deposit 100 EUR - Payable now	No	per night	15,00 €
Railing net (Safety net) (Payable now) Season: 2025 Exotic . net is supplied but not installed - Payable now	No	per booking	230,00 €
Stand up paddle (SUP) (Payable now) Season: 2025 Exotic . Price per day - Additional deposit 100 EUR - Payable now	No	per night	15,00 €



WEBSITE

www.plujeme.cz



E-MAIL

info@plujeme.cz



PHONE

+420 720 755 085



MOBILE

+420 777 170 276



PLUJEME RÁDI S.R.O.

Dlouhá 730/35, 11000 Praha 1 – Staré Město, Czech Republic

PRICE AND AVAILABILITY

25.01. - 08.02.2025 NOT AVAILABLE	14.02. - 21.02.2025 NOT AVAILABLE	22.02. - 08.03.2025 NOT AVAILABLE	08.03. - 22.03.2025 NOT AVAILABLE
22.03. - 29.03.2025 5.740 €	29.03. - 05.04.2025 446 € 525 €	05.04. - 12.04.2025 4.501 € 5.295 €	13.04. - 26.04.2025 NOT AVAILABLE
26.04. - 03.05.2025 4.140 € 4.870 €	03.05. - 10.05.2025 3.874 € 4.520 €	10.05. - 17.05.2025 3.236 € 3.775 €	17.05. - 24.05.2025 3.094 € 3.610 €
24.05. - 31.05.2025 3.111 € 3.630 €	31.05. - 07.06.2025 3.094 € 3.610 €	07.06. - 14.06.2025 2.850 € 3.325 €	14.06. - 21.06.2025 2.974 € 3.470 €
21.06. - 28.06.2025 3.099 € 3.615 €	28.06. - 05.07.2025 3.099 € 3.615 €	05.07. - 12.07.2025 3.111 € 3.630 €	12.07. - 19.07.2025 3.111 € 3.630 €
19.07. - 26.07.2025 3.103 € 3.620 €	26.07. - 02.08.2025 3.111 € 3.630 €	02.08. - 09.08.2025 3.111 € 3.630 €	09.08. - 16.08.2025 2.490 € 2.905 €
16.08. - 23.08.2025 2.816 € 3.285 €	23.08. - 30.08.2025 2.816 € 3.285 €	30.08. - 06.09.2025 2.816 € 3.285 €	



WEBSITE

www.plujeme.cz



E-MAIL

info@plujeme.cz



PHONE

+420 720 755 085



MOBILE

+420 777 170 276



PLUJEME RÁDI S.R.O.

Dlouhá 730/35, 11000 Praha 1 – Staré Město, Czech Republic

PRICE AND AVAILABILITY

06.09. - 13.09.2025 2.816 € 3.285 €	13.09. - 20.09.2025 2.816 € 3.285 €	20.09. - 27.09.2025 2.816 € 3.285 €	27.09. - 04.10.2025 2.816 € 3.285 €
04.10. - 11.10.2025 2.829 € 3.300 €	11.10. - 18.10.2025 3.135 € 3.300 €	18.10. - 25.10.2025 3.278 € 3.450 €	25.10. - 01.11.2025 3.681 € 3.875 €
01.11. - 08.11.2025 4.375 € 4.605 €	08.11. - 15.11.2025 5.064 € 5.330 €	15.11. - 22.11.2025 5.064 € 5.330 €	22.11. - 29.11.2025 4.688 € 4.935 €
29.11. - 06.12.2025 4.688 € 4.935 €	06.12. - 13.12.2025 4.318 € 4.545 €	13.12. - 20.12.2025 4.318 € 4.545 €	20.12. - 27.12.2025 7.899 € 8.315 €



WEBSITE

www.plujeme.cz



E-MAIL

info@plujeme.cz



PHONE

+420 720 755 085



MOBILE

+420 777 170 276



PLUJEME RÁDI S.R.O.

Dlouhá 730/35, 11000 Praha 1 – Staré Město, Czech Republic