

# DUFOUR 520 GL

CARUSO (2020)

Sailing yacht Dufour 520 GL CARUSO, built in 2020 is anchored in the Cote D'Azur, Port Pin Rolland, Provence-Alpes-Côte d'Azur, France. It has 5 cabins, can accommodate 10 + 2 people and has 3 toilets. Bed linen and kitchen equipment are included in the price.

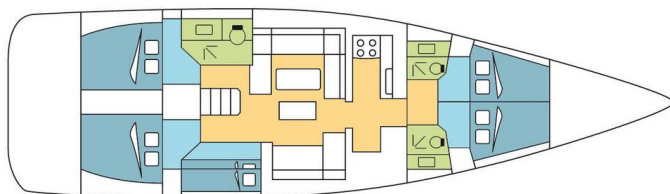

## YACHT SPECIFICATIONS

Yacht Base

**Cote D'Azur, Port Pin Rolland, France**

Yacht ID

**9247**

Brands

**Dufour**

Yacht name

**CARUSO**

Production year

**2020**

Length

**50 ft**

Cabins

**5**

Berths

**10 + 2**

Max Persons

**12**

WC

**3**

Engine

**1 x 75 HP**

Fuel tank

**440 l**



**WEBSITE**

[www.plujeme.cz](http://www.plujeme.cz)



**PHONE**

+420 720 755 085



**MOBILE**

+420 777 170 276



**E-MAIL**

[info@plujeme.cz](mailto:info@plujeme.cz)



**PLUJEME RÁDI S.R.O.**

Dlouhá 730/35, 11000 Praha 1 – Staré Město, Czech Republic

## STANDARD YACHT EQUIPMENT

Comfort	<b>Cockpit cushions</b>
Deck	<b>Bathing platform, Bimini top, Cockpit fridge, Cockpit table, Cockpit/stern, outside shower, Dinghy, Electric anchor windlass, Outboard engine, Sprayhood, Swimming ladder, Teak deck</b>
Entertainment	<b>Outdoor speakers, Radio CD mp3 player</b>
Galley	<b>Kitchen utensils (Galley equipment, cutlery), Oven, Refrigerator, Stove, Wine cellar</b>
Interior	<b>Convertible table, Convertible table in salon</b>
Navigation	<b>Autopilot, GPS chart plotter, Wind/speed/depth instruments</b>
Safety	<b>VHF radio</b>
Sails	<b>Lazy bag, Self tailing (manual) winch</b>
Yacht electrics	<b>220V socket, Inverter, Shore connection 220 V</b>



**WEBSITE**

[www.plujeme.cz](http://www.plujeme.cz)



**PHONE**

+420 720 755 085



**MOBILE**

+420 777 170 276



**E-MAIL**

[info@plujeme.cz](mailto:info@plujeme.cz)



**PLUJEME RÁDI S.R.O.**

Dlouhá 730/35, 11000 Praha 1 – Staré Město, Czech Republic

## SERVICES

SELECTED SERVICES	OBLIGATORY	PAYMENT TYPE	PRICE
<b>Essentials pack</b> (Payable now) <b>Season: 2025.</b> INCLUDED: full reduction of security deposit (0 € at base) // starter pack – (1 gallon water or 4 bottles of 1.5L, 1 bottle of disinfectant, 1 small bottle of washing up liquid, 1 dish cloth, 1 sponge, garbage bags, 1 roll of paper towels, 1 box of matches, 1 roll of toilet paper in each head) // final cleaning // 1 set of bed sheets & towels, dinghy, outboard engine & initial supply of fuel, gas and water tanks // DYC assistance guarantee // 1st & last night in the marina /// NOT INCLUDED: refuelling, gas & water consumption at end of charter, taxes if any, handling fees & additional equipment deposit.	Yes	per booking	<b>605,00 €</b>
<b>Handling fees</b> (Payable now) <b>Season: 2025.</b>	Yes	per booking	<b>25,00 €</b>
<b>Crew change</b> (Payable now) <b>Season: 2025.</b> Any crew change during the charter is subject to € 200.- additional cost. The charge includes administration cost, change of bed linen and towels and one night at DYC ponton (marina fee included only if the same base than start base). It doesn't include cleaning, nor new transit log where applicable.	No	per booking	<b>200,00 €</b>
<b>Early boarding/check-in</b> (Payable now) <b>Season: 2025.</b> EB (boat only) – 13:00h, starting time of boat's delivery // limited number of early boardings on same departure day	No	per booking	<b>300,00 €</b>
<b>Early boarding/check-in</b> (Payable now) <b>Season: 2025.</b> EB + extra fee skipper – 13:00h, starting time of boat's delivery // limited number of early boardings on same departure day	No	per booking	<b>430,00 €</b>
<b>Early boarding/check-in</b> (Payable now) <b>Season: 2025.</b> EB + extra fee Skipper & Hostess – 13:00h, starting time of boat's delivery // limited number of early boardings on same departure day	No	per booking	<b>530,00 €</b>
<b>Electric &amp; Water consumption in the Marinas</b> (Payable at the base) <b>Season: 2025.</b> Electric & Water consumption based on 2 nights on our dock (base will confirm the amount to pay locally depending on nights spent on dock)	No	per booking	<b>28,00 €</b>

<b>Extra set of linen (choose how many)</b> (Payable now)	No	per booking	<b>15,00 €</b>
<b>Season: 2025.</b> Extra set of linen : 15 € 1 extra set of linen (2 sheets & 2 pillow case) - to be updated manually			
<b>Extra set of towels (choose how many)</b> (Payable now)	No	per booking	<b>10,00 €</b>
<b>Season: 2025.</b> Extra set of towels: 10 € 1 extra set of towels (1 face & 1 bath towel) - to be updated manually			
<b>Final cleaning</b> (Payable now)	No	per booking	<b>290,00 €</b>
<b>Season: 2025.</b> included in Essentials pack			
<b>Full board 1-4 pax (number of guests to update manually)</b> (Payable now)	No	per guest/day	<b>60,00 €</b>
<b>Season: 2025.</b> only available if cook is booked on board as the cook will do the provisioning based on client's preference. Includes breakfast, lunch & dinner + the crew's food. Does not included alcoholic drinks			
<b>Full board 5-12 pax (number of guests to update manually)</b> (Payable now)	No	per guest/day	<b>55,00 €</b>
<b>Season: 2025.</b> only available if cook is booked on board as the cook will do the provisioning based on client's preference. Includes breakfast, lunch & dinner + the crew's food. Does not included alcoholic drinks			
<b>Half board 1-4 pax (number of guests to update manually)</b> (Payable now)	No	per guest/day	<b>50,00 €</b>
<b>Season: 2025.</b> only available if cook is booked on board as the cook will do the provisioning based on client's preference. Includes breakfast & lunch OR dinner + the crew's food. Does not included alcoholic drinks			
<b>Half board 5-12 pax (number of guests to update manually)</b> (Payable now)	No	per guest/day	<b>45,00 €</b>
<b>Season: 2025.</b> only available if cook is booked on board as the cook will do the provisioning based on client's preference. Includes breakfast & lunch OR dinner + the crew's food. Does not included alcoholic drinks			
<b>Hostess/Cook</b> (Payable now)	No	per night	<b>200,00 €</b>
<b>Season: 2025.</b> + provisioning, a cabin or forepeak to sleep and access to a WC/Shower			
<b>Regatta surcharge</b> (Payable now)	No	per booking	<b>0,00 €</b>
<b>Season: 2025.</b> A special race deposit need to be doubled manually once the regatta surcharge is added.			
<b>Skipper</b> (Payable now)	No	per night	<b>270,00 €</b>
<b>Season: 2025.</b> + provisioning, a cabin or forepeak to sleep and access to a WC/Shower			

<b>Starter pack</b> (Payable now)	No	per booking	<b>35,00 €</b>
<b>Season: 2025.</b> included in Essentials pack (The pack includes: 1 gallon water (or 4 bottles of 1.5L), 1 bottle of disinfectant, 1 small bottle of washing up liquid, 1 dish cloth, 1 sponge, garbage bags, 1 roll of paper towels, 1 box of matches, 1 roll of toilet paper in each head)			
<b>Transfer</b> (Payable now)	No	one-way	<b>52,00 €</b>
<b>Season: 2025.</b> OW - 1-4pax ,Day rate , Train station SNCF of Toulon from/to Port Pin Rolland base			
<b>Transfer</b> (Payable now)	No	one-way	<b>52,00 €</b>
<b>Season: 2025.</b> OW - 1-4pax ,Day rate , Ferry terminal of Toulon from/to Port Pin Rolland base			
<b>Transfer</b> (Payable now)	No	one-way	<b>65,00 €</b>
<b>Season: 2025.</b> OW - 1-4pax ,Night rate(19:00 – 07:00) Train station SNCF of Toulon from/to Port Pin Rolland			
<b>Transfer</b> (Payable now)	No	one-way	<b>65,00 €</b>
<b>Season: 2025.</b> OW - 1-4pax ,Night rate(19:00-07:00) ,Ferry terminal of Toulon from/to Port Pin Rolland			
<b>Transfer</b> (Payable now)	No	one-way	<b>65,00 €</b>
<b>Season: 2025.</b> OW - 5-7 pax ,Day rate , Train station SNCF of Toulon from/to Port Pin Rolland			
<b>Transfer</b> (Payable now)	No	one-way	<b>65,00 €</b>
<b>Season: 2025.</b> OW - 5-7 pax ,Day rate, Ferry terminal of Toulon from/to Port Pin Rolland base			
<b>Transfer</b> (Payable now)	No	one-way	<b>78,00 €</b>
<b>Season: 2025.</b> OW-5-7pax ,Bank Holidays,Sundays,Night rate(19:00-07:00), Ferry terminal of Toulon from/to Port Pin Rolland base			
<b>Transfer</b> (Payable now)	No	one-way	<b>78,00 €</b>
<b>Season: 2025.</b> OW -5-7pax ,Holidays,Sundays,Night rate(19:00-07:00), Train station SNCF of Toulon from/to Port Pin Rolland			
<b>Transfer</b> (Payable now)	No	one-way	<b>117,00 €</b>
<b>Season: 2025.</b> OW - 1-4pax ,Day rate ,Airport Toulon-Hyères from/to Port Pin Rolland			
<b>Transfer</b> (Payable now)	No	one-way	<b>143,00 €</b>
<b>Season: 2025.</b> OW - 1-4pax ,Night rate(19:00 – 07:00) , Airport Toulon-Hyères from/to Port Pin Rolland base			

**Transfer** (Payable now)

No

one-way

**143,00 €**

**Season: 2025.** OW - 5-7 pax ,Day rate , Airport Toulon-Hyères from/to Port

Pin Rolland

**Transfer** (Payable now)

No

one-way

**169,00 €**

**Season: 2025.** OW -5-7pax,Holidays ,Sundays,Night rate(19:00-07:00),

Airport Toulon-Hyères from/to Port Pin Rolland base



**WEBSITE**

[www.plujeme.cz](http://www.plujeme.cz)



**PHONE**

+420 720 755 085



**MOBILE**

+420 777 170 276



**E-MAIL**

[info@plujeme.cz](mailto:info@plujeme.cz)



**PLUJEME RÁDI S.R.O.**

Dlouhá 730/35, 11000 Praha 1 – Staré Město, Czech Republic

## ADDITIONAL EXTRAS

EXTRA	OBLIGATORY	PAYMENT TYPE	PRICE
<b>Kayak single</b> (Payable now) <b>Season: 2025.</b> Price per day / Additional deposit 100 EUR - Payable now	No	per night	<b>15,00 €</b>
<b>Railing net (Safety net)</b> (Payable now) <b>Season: 2025.</b> net is supplied but not installed - Payable now	No	per booking	<b>230,00 €</b>
<b>Stand up paddle (SUP)</b> (Payable now) <b>Season: 2025.</b> Price per day / Additional deposit 100 EUR - Payable now	No	per night	<b>15,00 €</b>



#### WEBSITE

[www.plujeme.cz](http://www.plujeme.cz)



#### E-MAIL

[info@plujeme.cz](mailto:info@plujeme.cz)



#### PHONE

+420 720 755 085



#### MOBILE

+420 777 170 276



#### PLUJEME RÁDI S.R.O.

Dlouhá 730/35, 11000 Praha 1 – Staré Město, Czech Republic

## PRICE AND AVAILABILITY

21.09. - 28.09.2024 NOT AVAILABLE	28.09. - 10.10.2024 NOT AVAILABLE	12.10. - 19.10.2024 NOT AVAILABLE	19.10. - 26.10.2024 <b>2.992 €</b> 3.740 €
26.10. - 02.11.2024 NOT AVAILABLE	04.11. - 13.11.2024 NOT AVAILABLE	16.11. - 23.11.2024 <b>1.280 €</b> 2.000 €	23.11. - 30.11.2024 <b>1.280 €</b> 2.000 €
02.12. - 27.02.2025 NOT AVAILABLE	01.03. - 08.03.2025 <b>1.890 €</b> 2.100 €	08.03. - 15.03.2025 <b>1.890 €</b> 2.100 €	15.03. - 22.03.2025 <b>1.890 €</b> 2.100 €
22.03. - 29.03.2025 <b>1.890 €</b> 2.100 €	29.03. - 05.04.2025 <b>1.890 €</b> 2.100 €	05.04. - 12.04.2025 <b>2.007 €</b> 2.230 €	12.04. - 19.04.2025 <b>2.259 €</b> 2.510 €
19.04. - 26.04.2025 <b>2.421 €</b> 2.690 €	26.04. - 03.05.2025 <b>3.362 €</b> 3.735 €		



### WEBSITE

[www.plujeme.cz](http://www.plujeme.cz)



### E-MAIL

[info@plujeme.cz](mailto:info@plujeme.cz)



### PHONE

+420 720 755 085



### MOBILE

+420 777 170 276



### PLUJEME RÁDI S.R.O.

Dlouhá 730/35, 11000 Praha 1 – Staré Město, Czech Republic



## PRICE AND AVAILABILITY

03.05. - 10.05.2025 <b>3.510 €</b> 3.900 €	10.05. - 17.05.2025 <b>3.816 €</b> 4.240 €	17.05. - 24.05.2025 <b>4.167 €</b> 4.630 €	24.05. - 31.05.2025 NOT AVAILABLE
31.05. - 07.06.2025 <b>4.217 €</b> 4.685 €	07.06. - 14.06.2025 <b>4.473 €</b> 4.970 €	14.06. - 21.06.2025 NOT AVAILABLE	21.06. - 28.06.2025 <b>4.784 €</b> 5.315 €
28.06. - 05.07.2025 <b>5.031 €</b> 5.590 €	05.07. - 12.07.2025 NOT AVAILABLE	12.07. - 19.07.2025 <b>5.666 €</b> 6.295 €	19.07. - 26.07.2025 <b>5.895 €</b> 6.550 €
26.07. - 02.08.2025 <b>6.165 €</b> 6.850 €	02.08. - 09.08.2025 <b>7.376 €</b> 8.195 €	09.08. - 16.08.2025 <b>7.007 €</b> 7.785 €	16.08. - 23.08.2025 <b>6.701 €</b> 7.445 €
23.08. - 30.08.2025 <b>5.184 €</b> 5.760 €	30.08. - 06.09.2025 <b>4.572 €</b> 5.080 €	06.09. - 13.09.2025 <b>4.149 €</b> 4.610 €	13.09. - 20.09.2025 <b>3.911 €</b> 4.345 €
20.09. - 27.09.2025 <b>3.776 €</b> 4.195 €	27.09. - 04.10.2025 <b>3.600 €</b> 4.000 €	04.10. - 11.10.2025 <b>3.029 €</b> 3.365 €	11.10. - 25.10.2025 NOT AVAILABLE
25.10. - 01.11.2025 <b>2.057 €</b> 2.285 €	01.11. - 08.11.2025 <b>1.890 €</b> 2.100 €	08.11. - 15.11.2025 <b>1.890 €</b> 2.100 €	15.11. - 22.11.2025 <b>1.890 €</b> 2.100 €
22.11. - 29.11.2025 <b>1.890 €</b> 2.100 €	29.11. - 06.12.2025 <b>1.890 €</b> 2.100 €	06.12. - 13.12.2025 <b>1.890 €</b> 2.100 €	13.12. - 20.12.2025 <b>1.890 €</b> 2.100 €
20.12. - 27.12.2025 <b>1.890 €</b> 2.100 €			



WEBSITE  
[www.plujeme.cz](http://www.plujeme.cz)



E-MAIL  
[info@plujeme.cz](mailto:info@plujeme.cz)



PHONE  
+420 720 755 085



MOBILE  
+420 777 170 276



PLUJEME RÁDI S.R.O.  
Dlouhá 730/35, 11000 Praha 1 – Staré Město, Czech Republic