

DUFOUR 520 GL

VANGA (2019)

Sailing yacht Dufour 520 GL VANGA, built in 2019 is anchored in the **Seychelles, Praslin, Mahé, Seychelles**. It has **5 cabins**, can accommodate **10 + 2 people** and has **3 toilets**. Bed linen and kitchen equipment are included in the price.

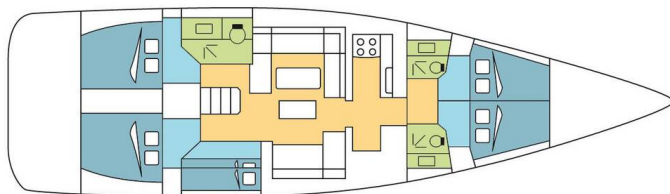

YACHT SPECIFICATIONS

Yacht Base

Seychelles, Praslin, Seychelles

Yacht ID

9217

Brands

Dufour

Yacht name

VANGA

Production year

2019

Length

50 ft

Cabins

5

Berths

10 + 2

Max Persons

10

WC

3

Engine

1 x 110 HP

Fuel tank

440 l



WEBSITE

www.plujeme.cz



PHONE

+420 720 755 085



MOBILE

+420 777 170 276



E-MAIL

info@plujeme.cz



PLUJEME RÁDI S.R.O.

Dlouhá 730/35, 11000 Praha 1 – Staré Město, Czech Republic

STANDARD YACHT EQUIPMENT

Comfort	Cockpit cushions
Deck	Bathing platform, Bimini top, Cockpit table, Cockpit/stern, outside shower, Dinghy, Electric anchor windlass, Outboard engine, Sprayhood, Swimming ladder
Entertainment	Outdoor speakers, Radio CD player
Galley	Hot water, Oven, Refrigerator, Stove, Wine cellar
Interior	Convertible table, Convertible table in salon, Electric fans in cabins
Navigation	Autopilot, Depthsounder, GPS chart plotter, Speedometer (Speed log), Wind instrument/Anemometer
Safety	VHF radio
Sails	Electric winch
Yacht electrics	220V socket, Air Conditioning, Generator, Inverter, Shore connection 220 V, Watermaker - desalinator, WC pump



WEBSITE

www.plujeme.cz



E-MAIL

info@plujeme.cz



PHONE

+420 720 755 085



MOBILE

+420 777 170 276



PLUJEME RÁDI S.R.O.

Dlouhá 730/35, 11000 Praha 1 – Staré Město, Czech Republic

SERVICES

SELECTED SERVICES	OBLIGATORY	PAYMENT TYPE	PRICE
Essentials pack (Payable now) Season: 2026 Exotic. INCLUDED: full reduction of security deposit (0 € at base)// starter pack – (1 gallon water or 4 bottles of 1.5L, 1 bottle of disinfectant, 1 small bottle of washing up liquid, 1 dish cloth, 1 sponge, garbage bags, 1 roll of paper towels, 1 box of matches, 1 roll of toilet paper in each head)// final cleaning // 1 set of bed sheets & towels, dinghy, outboard engine & initial supply of fuel, gas and water tanks// DYC assistance guarantee // 1st & last night in the marina /// NOT INCLUDED: refuelling, gas & water consumption at end of charter, taxes if any, handling fees, additional equipment deposit	Yes	per booking	685,00 €
Handling fees (Payable now) Season: 2026 Exotic.	Yes	per booking	35,00 €
The Tourism Environmental Sustainability Levy (Payable at the base) Season: 2026 Exotic. Compulsory to pay in SCR or equivalent Currency as per daily rate on base. To be paid locally, price is 100 SCR per person per day. NOT be applicable to citizens and residents of Seychelles, children of 12 years and below (visitors), and Dream Yacht crew.	Yes	per guest/day	6,67 €
Deckhand/ Marinero (Payable now) Season: 2026 Exotic. + provisioning	No	per night	130,00 €
Electric & Water consumption in the Marinas (Payable at the base) Season: 2026 Exotic. Electric & Water consumption based on 2 nights on our dock (base will confirm the amount to pay locally depending on nights spent on dock)	No	per booking	28,00 €
Extra set of linen (choose how many) (Payable now) Season: 2026 Exotic. Extra set of linen : 15 € 1 set of linen (2 sheets & 2 pillow case) - to be updated manually	No	per booking	15,00 €
Extra set of towels (choose how many) (Payable now) Season: 2026 Exotic. Extra set of towels: 10 € 1 set of towels (1 face & 1 bath towel) - to be updated manually	No	per booking	10,00 €
Final cleaning (Payable now) Season: 2026 Exotic. included in Essentials pack	No	per booking	290,00 €

Full board 1-4 pax (number of guests to update manually) (Payable now) Season: 2026 Exotic. only available if cook is booked on board as the cook will do the provisioning based on client's preference. Includes breakfast, lunch & dinner + the crew's food. Does not included alcoholic drinks	No	per guest/day	60,00 €
Full board 5-12 pax (number of guests to update manually) (Payable now) Season: 2026 Exotic. only available if cook is booked on board as the cook will do the provisioning based on client's preference. Includes breakfast, lunch & dinner + the crew's food. Does not included alcoholic drinks	No	per guest/day	55,00 €
Half board 1-4 pax (number of guests to update manually) (Payable now) Season: 2026 Exotic. only available if cook is booked on board as the cook will do the provisioning based on client's preference. Includes breakfast & lunch OR dinner + the crew's food. Does not included alcoholic drinks	No	per guest/day	50,00 €
Half board 5-12 pax (number of guests to update manually) (Payable now) Season: 2026 Exotic. only available if cook is booked on board as the cook will do the provisioning based on client's preference. Includes breakfast & lunch OR dinner + the crew's food. Does not included alcoholic drinks	No	per guest/day	45,00 €
Regatta surcharge (Payable now) Season: 2026 Exotic. all the regattas apart of ASW (different regatta surcharge for ASW) // A special race deposit need to be doubled manually once the regatta surcharge is added.	No	per booking	0,00 €
Skipper (Payable now) Season: 2026 Exotic. + provisioning, a cabin or forepeak to sleep and access to a WC/Shower	No	per night	150,00 €
Skipper+Cook (Payable now) Season: 2026 Exotic. (for charters up to max 3 guests, one person works as a skipper and cook)+ provisioning, a cabin or forepeak to sleep and access to a WC/Shower	No	per night	210,00 €
Starter pack (Payable now) Season: 2026 Exotic. included in Essentials pack (The pack includes: 1 gallon water (or 4 bottles of 1.5L), 1 bottle of disinfectant, 1 small bottle of washing up liquid, 1 dish cloth, 1 sponge, garbage bags, 1 roll of paper towels, 1 box of matches, 1 roll of toilet paper in each head	No	per booking	50,00 €
Steward/Cook (Payable now) Season: 2026 Exotic. + provisioning, a cabin or forepeak to sleep and access to a WC/Shower	No	per night	135,00 €
Transfer (Payable now) Season: 2026 Exotic. OW - Jetty Terminal/base 1 to 4 pax	No	one-way	15,00 €

Transfer (Payable now)	No	one-way	20,00 €
Season: 2026 Exotic. OW - Jetty Terminal/base 5 to 8 pax			
Transfer (Payable now)	No	one-way	29,00 €
Season: 2026 Exotic. OW - Jetty Terminal/base 9 to 12 pax			
Transfer (Payable now)	No	round trip	78,00 €
Season: 2026 Exotic. RT - Praslin airport/base/airport 1 to 4 pax			
Transfer (Payable now)	No	round trip	98,00 €
Season: 2026 Exotic. RT - Praslin airport/base/airport 5 to 8 pax			
Transfer (Payable now)	No	round trip	118,00 €
Season: 2026 Exotic. RT - Praslin airport/base/airport 9 to 12 pax			
Transfer (Payable now)	No	round trip	136,00 €
Season: 2026 Exotic. RT - Praslin airport/base/airport 13 to 16 pax			



WEBSITE

www.plujeme.cz



PHONE

+420 720 755 085



MOBILE

+420 777 170 276



E-MAIL

info@plujeme.cz



PLUJEME RÁDI S.R.O.

Dlouhá 730/35, 11000 Praha 1 – Staré Město, Czech Republic

ADDITIONAL EXTRAS

EXTRA	OBLIGATORY	PAYMENT TYPE	PRICE
Fishing equipment (Payable now) Season: 2026 Exotic. Additional deposit 100 EUR (subject to availability) - Payable now	No	per day	15,00 €
Kayak single (Payable now) Season: 2026 Exotic. price per day - Additional deposit 100 EUR - Payable now	No	per night	15,00 €
Kayak tandem (Payable now) Season: 2026 Exotic. price per day - Additional deposit 100 EUR - Payable now	No	per night	15,00 €
Railing net (Safety net) (Payable now) Season: 2026 Exotic. net is supplied but not installed - Payable now	No	per booking	230,00 €
Stand up paddle (SUP) (Payable now) Season: 2026 Exotic. Price per day - Additional deposit 100 EUR - Payable now	No	per night	15,00 €



WEBSITE

www.plujeme.cz



E-MAIL

info@plujeme.cz



PHONE

+420 720 755 085



MOBILE

+420 777 170 276



PLUJEME RÁDI S.R.O.

Dlouhá 730/35, 11000 Praha 1 – Staré Město, Czech Republic

PRICE AND AVAILABILITY

24.11. - 05.12.2024 NOT AVAILABLE	07.12. - 14.12.2024 3.876 € 4.560 €	14.12. - 21.12.2024 3.876 € 4.560 €	21.12. - 28.12.2024 3.944 € 4.640 €
04.01. - 11.01.2025 3.825 € 4.500 €	11.01. - 18.01.2025 3.613 € 4.250 €	18.01. - 25.01.2025 3.613 € 4.250 €	25.01. - 01.02.2025 3.608 € 4.245 €
01.02. - 08.02.2025 4.225 € 4.970 €	08.02. - 15.02.2025 4.225 € 4.970 €	15.02. - 22.02.2025 4.437 € 5.220 €	22.02. - 01.03.2025 4.437 € 5.220 €
01.03. - 08.03.2025 4.437 € 5.220 €	08.03. - 15.03.2025 ON OPTION	15.03. - 22.03.2025 4.416 € 5.195 €	22.03. - 29.03.2025 4.416 € 5.195 €
29.03. - 05.04.2025 NOT AVAILABLE	05.04. - 12.04.2025 4.480 € 5.270 €	12.04. - 19.04.2025 4.480 € 5.270 €	19.04. - 26.04.2025 4.480 € 5.270 €
26.04. - 03.05.2025 4.288 € 5.045 €	03.05. - 10.05.2025 5.580 €	10.05. - 17.05.2025 5.580 €	17.05. - 24.05.2025 5.580 €
24.05. - 31.05.2025 5.035 € 5.300 €	31.05. - 07.06.2025 5.035 € 5.300 €	07.06. - 14.06.2025 5.035 € 5.300 €	14.06. - 21.06.2025 5.035 € 5.300 €
21.06. - 28.06.2025 5.035 € 5.300 €	28.06. - 05.07.2025 5.135 € 5.405 €		



WEBSITE
www.plujeme.cz



E-MAIL
info@plujeme.cz



PHONE
+420 720 755 085



MOBILE
+420 777 170 276



PLUJEME RÁDI S.R.O.
Dlouhá 730/35, 11000 Praha 1 – Staré Město, Czech Republic

PRICE AND AVAILABILITY

05.07. - 12.07.2025 5.230 € 5.505 €	12.07. - 19.07.2025 5.230 € 5.505 €	19.07. - 26.07.2025 5.524 € 5.815 €	26.07. - 02.08.2025 5.819 € 6.125 €
02.08. - 09.08.2025 5.819 € 6.125 €	09.08. - 16.08.2025 5.819 € 6.125 €	16.08. - 23.08.2025 5.296 € 5.575 €	23.08. - 30.08.2025 5.035 € 5.300 €
30.08. - 06.09.2025 5.035 € 5.300 €	06.09. - 13.09.2025 5.035 € 5.300 €	13.09. - 20.09.2025 5.035 € 5.300 €	20.09. - 27.09.2025 5.064 € 5.330 €
27.09. - 04.10.2025 5.086 € 5.354 €	04.10. - 11.10.2025 5.463 € 5.750 €	11.10. - 18.10.2025 5.762 € 6.065 €	18.10. - 25.10.2025 5.762 € 6.065 €
25.10. - 01.11.2025 5.762 € 6.065 €	01.11. - 08.11.2025 5.762 € 6.065 €	08.11. - 15.11.2025 5.762 € 6.065 €	15.11. - 22.11.2025 5.762 € 6.065 €
22.11. - 29.11.2025 5.277 € 5.555 €	29.11. - 06.12.2025 5.035 € 5.300 €	06.12. - 13.12.2025 5.035 € 5.300 €	13.12. - 20.12.2025 5.035 € 5.300 €
20.12. - 27.12.2025 7.116 € 7.490 €			



WEBSITE

www.plujeme.cz



E-MAIL

info@plujeme.cz



PHONE

+420 720 755 085



MOBILE

+420 777 170 276



PLUJEME RÁDI S.R.O.

Dlouhá 730/35, 11000 Praha 1 – Staré Město, Czech Republic