

DUFOUR 520 GL

FREGATE (2018)

Sailing yacht Dufour 520 GL FREGATE, built in 2018 is anchored in the **Dubrovnik, Komolac, ACI Marina Dubrovnik, Dubrovnik region, Croatia**. It has **5 cabins**, can accommodate **10 + 2 people** and has **3 toilets**. Bed linen and kitchen equipment are included in the price.

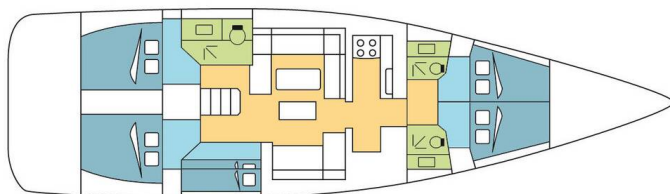
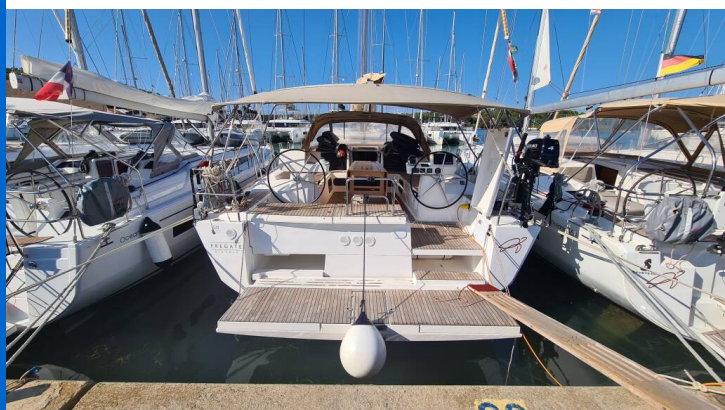

YACHT SPECIFICATIONS

Yacht Base

**Dubrovnik, Komolac, ACI Marina
Dubrovnik, Croatia**

Yacht ID

9023

Brands

Dufour

Yacht name

FREGATE

Production year

2018

Length

50 ft

Cabins

5

Berths

10 + 2

Max Persons

12

WC

3

Engine

1 x 110 HP

Fuel tank

450 l



WEBSITE

www.plujeme.cz



PHONE

+420 720 755 085



MOBILE

+420 777 170 276



E-MAIL

info@plujeme.cz



PLUJEME RÁDI S.R.O.

Dlouhá 730/35, 11000 Praha 1 – Staré Město, Czech Republic

STANDARD YACHT EQUIPMENT

Comfort	Cockpit cushions
Deck	Bathing platform, Bimini top, Cockpit table, Cockpit/stern, outside shower, Dinghy, Electric anchor windlass, Outboard engine, Sprayhood, Swimming ladder
Entertainment	Outdoor speakers, Radio
Galley	Hot water
Interior	Convertible table in salon, Electric fans in cabins, Electric toilet
Navigation	Autopilot, Bow thruster, GPS chart plotter - cockpit, Wind instrument/Anemometer
Safety	VHF radio
Sails	Lazy bag, Lazy jacks, Self tailing (manual) winch
Yacht electrics	220V socket, Inverter



WEBSITE

www.plujeme.cz



E-MAIL

info@plujeme.cz



PHONE

+420 720 755 085



MOBILE

+420 777 170 276



PLUJEME RÁDI S.R.O.

Dlouhá 730/35, 11000 Praha 1 – Staré Město, Czech Republic

SERVICES

SELECTED SERVICES	OBLIGATORY	PAYMENT TYPE	PRICE
Final cleaning (Payable now) Season: 2025. included in Essentials pack	Yes	per booking	290,00 €
Handling fees (Payable now) Season: 2025.	Yes	per booking	20,00 €
Starter pack (Payable now) Season: 2025. included in Essentials pack (The pack includes: 1 gallon water (or 4 bottles of 1.5L), 1 bottle of disinfectant, 1 small bottle of washing up liquid, 1 dish cloth, 1 sponge, garbage bags, 1 roll of paper towels, 1 box of matches, 1 roll of toilet paper in each head)	Yes	per booking	30,00 €
Tourist tax (Payable at the base) Season: 2025. Payment by credit card only, no cash	Yes	per guest/day	1,33 €
Crew change (Payable now) Season: 2025. Any crew change during the charter is subject to € 200.- additional cost. The charge includes administration cost, change of bed linen and towels and one night at DYC ponton (marina fee included only if the same base than start base). It doesn't include cleaning, nor new transit log where applicable.	No	per booking	200,00 €
Early boarding/check-in (Payable now) Season: 2025. EB (boat only) - 13:00h, starting time of boat's delivery // limited number of early boardings on same departure day	No	per booking	300,00 €
Early boarding/check-in (Payable now) Season: 2025. EB + extra fee skipper - 13:00h, starting time of boat's delivery // limited number of early boardings on same departure day	No	per booking	400,00 €
Early boarding/check-in (Payable now) Season: 2025. EB + extra fee Skipper & Hostess - 13:00h, starting time of boat's delivery // limited number of early boardings on same departure day	No	per booking	490,00 €
Electric & Water consumption in the Marinas (Payable at the base) Season: 2025. Electric & Water consumption based on 2 nights on our dock (base will confirm the amount to pay locally depending on nights spent on dock)	No	per booking	28,00 €

Essentials pack (Payable now) Season: 2025. INCLUDED: full reduction of security deposit (0 € at base)// starter pack – (1 gallon water or 4 bottles of 1.5L, 1 bottle of disinfectant, 1 small bottle of washing up liquid, 1 dish cloth, 1 sponge, garbage bags, 1 roll of paper towels, 1 box of matches, 1 roll of toilet paper in each head)// final cleaning // 1 set of bed sheets & towels, dinghy, outboard engine & initial supply of fuel, gas and water tanks // DYC assistance guarantee // 1st & last night in the marina /// NOT INCLUDED: refuelling, gas & water consumption at end of charter, taxes if any, handling fees & additional equipment deposit.	No	per booking	605,00 €
Extra set of linen (choose how many) (Payable now) Season: 2025. Extra set of linen : 15 € 1 extra set of linen (2 sheets & 2 pillow case) - to be updated manually	No	per booking	15,00 €
Extra set of towels (choose how many) (Payable now) Season: 2025. Extra set of towels: 10 € 1 extra set of towels (1 face & 1 bath towel) - to be updated manually	No	per booking	10,00 €
Full board 1-4 pax (number of guests to update manually) (Payable now) Season: 2025. only available if cook is booked on board as the cook will do the provisioning based on client's preference. Includes breakfast, lunch & dinner + the crew's food. Does not included alcoholic drinks	No	per guest/day	60,00 €
Full board 5-12 pax (number of guests to update manually) (Payable now) Season: 2025. only available if cook is booked on board as the cook will do the provisioning based on client's preference. Includes breakfast, lunch & dinner + the crew's food. Does not included alcoholic drinks	No	per guest/day	55,00 €
Half board 1-4 pax (number of guests to update manually) (Payable now) Season: 2025. only available if cook is booked on board as the cook will do the provisioning based on client's preference. Includes breakfast & lunch OR dinner + the crew's food. Does not included alcoholic drinks	No	per guest/day	50,00 €
Half board 5-12 pax (number of guests to update manually) (Payable now) Season: 2025. only available if cook is booked on board as the cook will do the provisioning based on client's preference. Includes breakfast & lunch OR dinner + the crew's food. Does not included alcoholic drinks	No	per guest/day	45,00 €
Hostess/Cook (Payable now) Season: 2025. + provisioning, a cabin or forepeak to sleep and access to a WC/Shower	No	per night	180,00 €
Regatta surcharge (Payable now) Season: 2025. A special race deposit need to be doubled manually once the regatta surcharge is added.	No	per booking	0,00 €

Skipper (Payable now)	No	per night	200,00 €
Season: 2025. + provisioning, a cabin or forepeak to sleep and access to a WC/Shower			
Transfer (Payable now)	No	round trip	128,00 €
Season: 2025. RT - Dubrovnik Airport / Base 1-8 PAX			
WI-FI Internet connection on boat (Payable now)	No	per week	32,00 €
Season: 2025. Unlimited - included in price			



WEBSITE

www.plujeme.cz



E-MAIL

info@plujeme.cz



PHONE

+420 720 755 085



MOBILE

+420 777 170 276



PLUJEME RÁDI S.R.O.

Dlouhá 730/35, 11000 Praha 1 – Staré Město, Czech Republic

ADDITIONAL EXTRAS

EXTRA	OBLIGATORY	PAYMENT TYPE	PRICE
Kayak single (Payable now) Season: 2025. Price per day / Additional deposit 100 EUR - Payable now	No	per night	15,00 €
Kayak single (Payable now) Season: 2025. Price per day / Additional deposit 100 EUR - Payable now	No	per night	15,00 €
Railing net (Safety net) (Payable now) Season: 2025. net is supplied but not installed - Payable now	No	per booking	230,00 €
Stand up paddle (SUP) (Payable now) Season: 2025. Price per day / Additional deposit 100 EUR - Payable now	No	per night	15,00 €

**WEBSITE**www.plujeme.cz**E-MAIL**info@plujeme.cz**PHONE**

+420 720 755 085

**MOBILE**

+420 777 170 276

**PLUJEME RÁDI S.R.O.**

Dlouhá 730/35, 11000 Praha 1 – Staré Město, Czech Republic

PRICE AND AVAILABILITY

01.03. - 08.03.2025 1.373 € 1.525 €	08.03. - 15.03.2025 1.526 € 1.695 €	15.03. - 22.03.2025 1.526 € 1.695 €	22.03. - 29.03.2025 1.526 € 1.695 €
29.03. - 05.04.2025 1.526 € 1.695 €	05.04. - 12.04.2025 1.526 € 1.695 €	12.04. - 19.04.2025 1.566 € 1.740 €	19.04. - 26.04.2025 1.566 € 1.740 €
26.04. - 03.05.2025 NOT AVAILABLE	03.05. - 10.05.2025 NOT AVAILABLE	10.05. - 17.05.2025 2.004 € 2.505 €	17.05. - 31.05.2025 NOT AVAILABLE
31.05. - 07.06.2025 NOT AVAILABLE	07.06. - 14.06.2025 3.060 € 3.825 €	14.06. - 21.06.2025 3.208 € 4.010 €	21.06. - 28.06.2025 NOT AVAILABLE
28.06. - 05.07.2025 3.896 € 4.870 €	05.07. - 12.07.2025 4.040 € 4.725 €	12.07. - 19.07.2025 4.053 € 4.740 €	19.07. - 26.07.2025 4.181 € 4.890 €
26.07. - 02.08.2025 4.356 € 5.095 €	02.08. - 09.08.2025 5.207 € 6.090 €	09.08. - 16.08.2025 5.207 € 6.090 €	16.08. - 23.08.2025 4.219 € 4.935 €
23.08. - 30.08.2025 3.937 € 4.605 €	30.08. - 06.09.2025 NOT AVAILABLE		



WEBSITE

www.plujeme.cz



E-MAIL

info@plujeme.cz



PHONE

+420 720 755 085



MOBILE

+420 777 170 276



PLUJEME RÁDI S.R.O.

Dlouhá 730/35, 11000 Praha 1 – Staré Město, Czech Republic

PRICE AND AVAILABILITY

06.09. - 13.09.2025 3.879 € 4.310 €	13.09. - 20.09.2025 4.185 € 4.650 €	20.09. - 27.09.2025 3.555 € 3.950 €	27.09. - 04.10.2025 3.092 € 3.435 €
04.10. - 11.10.2025 2.178 € 2.420 €	11.10. - 18.10.2025 1.643 € 1.825 €	18.10. - 25.10.2025 1.566 € 1.740 €	25.10. - 01.11.2025 1.526 € 1.695 €
01.11. - 08.11.2025 1.526 € 1.695 €	08.11. - 15.11.2025 1.526 € 1.695 €	15.11. - 22.11.2025 1.526 € 1.695 €	22.11. - 29.11.2025 1.526 € 1.695 €
02.12. - 26.02.2026 NOT AVAILABLE			



WEBSITE

www.plujeme.cz



E-MAIL

info@plujeme.cz



PHONE

+420 720 755 085



MOBILE

+420 777 170 276



PLUJEME RÁDI S.R.O.

Dlouhá 730/35, 11000 Praha 1 – Staré Město, Czech Republic