

# LAGOON 40

Nathalie (2018)

Catamaran Lagoon 40 Nathalie, built in 2018 is anchored in the Trogir, Yachtclub Seget (Marina Baotic), Split region, Croatia. It has 4 + 2 cabins, can accommodate 8 + 2 + 2 people and has 4 toilets. Bed linen and kitchen equipment are included in the price.

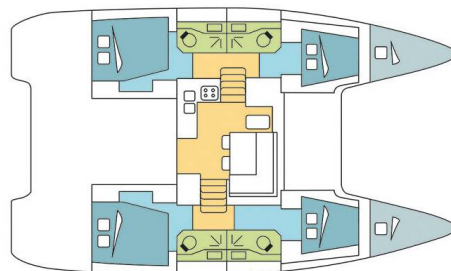

## YACHT SPECIFICATIONS

Yacht Base

**Trogir, Yachtclub Seget (Marina Baotic), Croatia**

Yacht ID

**8994**

Brands

**Lagoon**

Yacht name

**Nathalie**

Production year

**2018**

Length

**39 ft**

Cabins

**4 + 2**

Berths

**8 + 2 + 2**

Max Persons

**12**

WC

**4**

Engine

**2 x 45 HP**

Fuel tank

**400 l**



**WEBSITE**

[www.plujeme.cz](http://www.plujeme.cz)



**PHONE**

+420 720 755 085



**MOBILE**

+420 777 170 276



**E-MAIL**

[info@plujeme.cz](mailto:info@plujeme.cz)



**PLUJEME RÁDI S.R.O.**

Dlouhá 730/35, 11000 Praha 1 - Staré Město, Czech Republic

## STANDARD YACHT EQUIPMENT

Comfort	<b>Cockpit cushions, Sundeck cushions</b>
Deck	<b>Bimini top, Dinghy, Electric anchor windlass, Teak cockpit</b>
Entertainment	<b>CD player, Fusion radio, LCD TV + DVD</b>
Galley	<b>Freezer, Oven, Refrigerator, Stove</b>
Interior	<b>Convertible table, Convertible table in salon, Electric toilet</b>
Navigation	<b>Autopilot, Folding propeller, GPS, GPS chart plotter - cockpit, Wind instrument/Anemometer</b>
Safety	<b>VHF radio</b>
Sails	<b>Lazy jacks</b>
Yacht electrics	<b>Inverter</b>



**WEBSITE**

[www.plujeme.cz](http://www.plujeme.cz)



**E-MAIL**

[info@plujeme.cz](mailto:info@plujeme.cz)



**PHONE**

+420 720 755 085



**MOBILE**

+420 777 170 276



**PLUJEME RÁDI S.R.O.**

Dlouhá 730/35, 11000 Praha 1 – Staré Město, Czech Republic

## SERVICES

SELECTED SERVICES	OBLIGATORY	PAYMENT TYPE	PRICE
<b>Final cleaning</b> (Payable now) <b>Season: 2025.</b> included in Essentials pack	Yes	per booking	<b>285,00 €</b>
<b>Handling fees</b> (Payable now) <b>Season: 2025.</b>	Yes	per booking	<b>20,00 €</b>
<b>Starter pack</b> (Payable now) <b>Season: 2025.</b> included in Essentials pack (The pack includes: 1 gallon water (or 4 bottles of 1.5L), 1 bottle of disinfectant, 1 small bottle of washing up liquid, 1 dish cloth, 1 sponge, garbage bags, 1 roll of paper towels, 1 box of matches, 1 roll of toilet paper in each head)	Yes	per booking	<b>30,00 €</b>
<b>Tourist tax</b> (Payable at the base) <b>Season: 2025.</b> Payment by credit card only, no cash	Yes	per guest/day	<b>1,33 €</b>
<b>Crew change</b> (Payable now) <b>Season: 2025.</b> Any crew change during the charter is subject to € 200.- additional cost. The charge includes administration cost, change of bed linen and towels and one night at DYC ponton (marina fee included only if the same base than start base). It doesn't include cleaning, nor new transit log where applicable.	No	per booking	<b>200,00 €</b>
<b>Early boarding/check-in</b> (Payable now) <b>Season: 2025.</b> EB (boat only) - 13:00h, starting time of boat's delivery // limited number of early boardings on same departure day	No	per booking	<b>300,00 €</b>
<b>Early boarding/check-in</b> (Payable now) <b>Season: 2025.</b> EB + extra fee skipper - 13:00h, starting time of boat's delivery // limited number of early boardings on same departure day	No	per booking	<b>400,00 €</b>
<b>Early boarding/check-in</b> (Payable now) <b>Season: 2025.</b> EB + extra fee Skipper & Hostess - 13:00h, starting time of boat's delivery // limited number of early boardings on same departure day	No	per booking	<b>490,00 €</b>
<b>Electric &amp; Water consumption in the Marinas</b> (Payable at the base) <b>Season: 2025.</b> Electric & Water consumption based on 2 nights on our dock (base will confirm the amount to pay locally depending on nights spent on dock)	No	per booking	<b>28,00 €</b>

<b>Essentials pack</b> (Payable now) <b>Season: 2025.</b> INCLUDED: full reduction of security deposit (0 € at base)// starter pack – (1 gallon water or 4 bottles of 1.5L, 1 bottle of disinfectant, 1 small bottle of washing up liquid, 1 dish cloth, 1 sponge, garbage bags, 1 roll of paper towels, 1 box of matches, 1 roll of toilet paper in each head)// final cleaning // 1 set of bed sheets & towels, dinghy, outboard engine & initial supply of fuel, gas and water tanks // DYC assistance guarantee // 1st & last night in the marina /// NOT INCLUDED: refuelling, gas & water consumption at end of charter, taxes if any, handling fees & additional equipment deposit.	No	per booking	<b>600,00 €</b>
<b>Extra set of linen (choose how many)</b> (Payable now) <b>Season: 2025.</b> Extra set of linen : 15 € 1 extra set of linen (2 sheets & 2 pillow case) - to be updated manually	No	per booking	<b>15,00 €</b>
<b>Extra set of towels (choose how many)</b> (Payable now) <b>Season: 2025.</b> Extra set of towels: 10 € 1 extra set of towels (1 face & 1 bath towel) - to be updated manually	No	per booking	<b>10,00 €</b>
<b>Full board 1-4 pax (number of guests to update manually)</b> (Payable now) <b>Season: 2025.</b> only available if cook is booked on board as the cook will do the provisioning based on client's preference. Includes breakfast, lunch & dinner + the crew's food. Does not included alcoholic drinks	No	per guest/day	<b>60,00 €</b>
<b>Full board 5-12 pax (number of guests to update manually)</b> (Payable now) <b>Season: 2025.</b> only available if cook is booked on board as the cook will do the provisioning based on client's preference. Includes breakfast, lunch & dinner + the crew's food. Does not included alcoholic drinks	No	per guest/day	<b>55,00 €</b>
<b>Half board 1-4 pax (number of guests to update manually)</b> (Payable now) <b>Season: 2025.</b> only available if cook is booked on board as the cook will do the provisioning based on client's preference. Includes breakfast & lunch OR dinner + the crew's food. Does not included alcoholic drinks	No	per guest/day	<b>50,00 €</b>
<b>Half board 5-12 pax (number of guests to update manually)</b> (Payable now) <b>Season: 2025.</b> only available if cook is booked on board as the cook will do the provisioning based on client's preference. Includes breakfast & lunch OR dinner + the crew's food. Does not included alcoholic drinks	No	per guest/day	<b>45,00 €</b>
<b>Hostess/Cook</b> (Payable now) <b>Season: 2025.</b> + provisioning, a cabin or forepeak to sleep and access to a WC/Shower	No	per night	<b>180,00 €</b>
<b>Regatta surcharge</b> (Payable now) <b>Season: 2025.</b> A special race deposit need to be doubled manually once the regatta surcharge is added.	No	per booking	<b>0,00 €</b>

<b>Skipper</b> (Payable now)	No	per night	<b>200,00 €</b>
<b>Season: 2025.</b> + provisioning, a cabin or forepeak to sleep and access to a WC/Shower			
<b>Transfer</b> (Payable now)	No	round trip	<b>82,00 €</b>
<b>Season: 2025.</b> RT - Split Airport / Base 1 - 4 pax			
<b>Transfer</b> (Payable now)	No	round trip	<b>96,00 €</b>
<b>Season: 2025.</b> RT - Split Airport / Base 5 - 8 pax			
<b>WI-FI Internet connection on boat</b> (Payable now)	No	per week	<b>32,00 €</b>
<b>Season: 2025.</b> Unlimited - included in price			



**WEBSITE**

[www.plujeme.cz](http://www.plujeme.cz)



**E-MAIL**

[info@plujeme.cz](mailto:info@plujeme.cz)



**PHONE**

+420 720 755 085



**MOBILE**

+420 777 170 276



**PLUJEME RÁDI S.R.O.**

Dlouhá 730/35, 11000 Praha 1 - Staré Město, Czech Republic

## ADDITIONAL EXTRAS

EXTRA	OBLIGATORY	PAYMENT TYPE	PRICE
<b>Kayak single</b> (Payable now) <b>Season: 2025.</b> Price per day / Additional deposit 100 EUR - Payable now	No	per night	<b>15,00 €</b>
<b>Outboard engine 8 &amp; 9,8 HP</b> (Payable now) <b>Season: 2025.</b> Subject to Availability ; 8/9hp. Dinghy not suitable in any case for waterski or wakeboard. Additional security deposit of 500 € - Payable now	No	per day	<b>35,00 €</b>
<b>Railing net (Safety net)</b> (Payable now) <b>Season: 2025.</b> net is supplied but not installed - Payable now	No	per booking	<b>250,00 €</b>
<b>Stand up paddle (SUP)</b> (Payable now) <b>Season: 2025.</b> Price per day / Additional deposit 100 EUR - Payable now	No	per night	<b>15,00 €</b>

**WEBSITE**[www.plujeme.cz](http://www.plujeme.cz)**E-MAIL**[info@plujeme.cz](mailto:info@plujeme.cz)**PHONE**

+420 720 755 085

**MOBILE**

+420 777 170 276

**PLUJEME RÁDI S.R.O.**

Dlouhá 730/35, 11000 Praha 1 – Staré Město, Czech Republic

## PRICE AND AVAILABILITY

01.03. - 08.03.2025 <b>1.047 €</b> 1.225 €	08.03. - 15.03.2025 <b>1.047 €</b> 1.225 €	15.03. - 22.03.2025 <b>1.047 €</b> 1.225 €	22.03. - 29.03.2025 <b>1.047 €</b> 1.225 €
29.03. - 05.04.2025 <b>1.047 €</b> 1.225 €	05.04. - 12.04.2025 <b>1.047 €</b> 1.225 €	12.04. - 19.04.2025 <b>1.047 €</b> 1.225 €	19.04. - 26.04.2025 <b>1.321 €</b> 1.545 €
26.04. - 03.05.2025 <b>1.595 €</b> 1.865 €	03.05. - 10.05.2025 NOT AVAILABLE	10.05. - 17.05.2025 <b>1.770 €</b> 2.070 €	17.05. - 24.05.2025 NOT AVAILABLE
24.05. - 31.05.2025 NOT AVAILABLE	31.05. - 07.06.2025 ON OPTION	07.06. - 14.06.2025 <b>4.591 €</b> 5.370 €	14.06. - 21.06.2025 <b>4.378 €</b> 5.120 €
21.06. - 28.06.2025 NOT AVAILABLE	28.06. - 05.07.2025 NOT AVAILABLE	05.07. - 12.07.2025 NOT AVAILABLE	12.07. - 19.07.2025 <b>5.710 €</b> 6.010 €
19.07. - 26.07.2025 <b>5.724 €</b> 6.025 €	26.07. - 02.08.2025 <b>5.705 €</b> 6.005 €		



WEBSITE

[www.plujeme.cz](http://www.plujeme.cz)



E-MAIL

[info@plujeme.cz](mailto:info@plujeme.cz)



PHONE

+420 720 755 085



MOBILE

+420 777 170 276



PLUJEME RÁDI S.R.O.

Dlouhá 730/35, 11000 Praha 1 – Staré Město, Czech Republic

## PRICE AND AVAILABILITY

02.08. - 09.08.2025 5.999 € 6.315 €	09.08. - 16.08.2025 5.396 € 5.680 €	16.08. - 30.08.2025 NOT AVAILABLE	30.08. - 06.09.2025 4.052 € 4.265 €
06.09. - 13.09.2025 NOT AVAILABLE	13.09. - 20.09.2025 4.019 € 4.230 €	20.09. - 27.09.2025 3.957 € 4.165 €	27.09. - 04.10.2025 NOT AVAILABLE
04.10. - 11.10.2025 1.815 € 1.910 €	11.10. - 20.10.2025 NOT AVAILABLE	25.10. - 01.11.2025 1.321 € 1.390 €	01.11. - 08.11.2025 1.325 € 1.395 €
08.11. - 15.11.2025 1.325 € 1.395 €	15.11. - 22.11.2025 1.325 € 1.395 €	22.11. - 29.11.2025 1.325 € 1.395 €	02.12. - 30.12.2025 NOT AVAILABLE
31.12. - 31.12.2098 NOT AVAILABLE			



### WEBSITE

[www.plujeme.cz](http://www.plujeme.cz)



### E-MAIL

[info@plujeme.cz](mailto:info@plujeme.cz)



### PHONE

+420 720 755 085



### MOBILE

+420 777 170 276



### PLUJEME RÁDI S.R.O.

Dlouhá 730/35, 11000 Praha 1 – Staré Město, Czech Republic