

LAGOON 50

Skye (2023)

Catamaran **Lagoon 50 Skye**, built in **2023** is anchored in the **BVI, Tortola, Nanny Cay Marina, British Virgin Islands, British Virgin Islands**. It has **6 + 2 cabins**, can accommodate **12 + 2 people** and has **6 toilets**. Bed linen and kitchen equipment are included in the price.

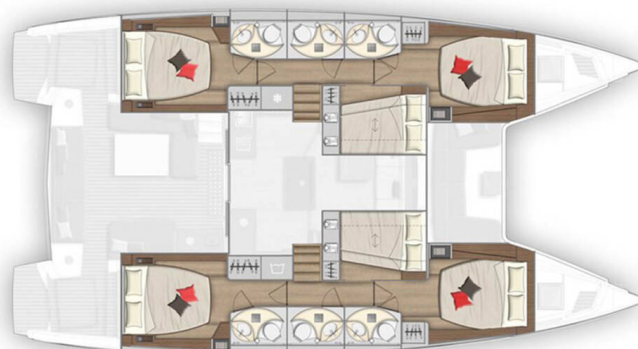

6 cabins 6 Salles de bain / 6 cabins 6 bathrooms

YACHT SPECIFICATIONS

Yacht Base

**BVI, Tortola, Nanny Cay Marina,
British Virgin Islands**

Yacht ID

8900

Brands

Lagoon

Yacht name

Skye

Production year

2023

Length

48 ft

Cabins

6 + 2

Berths

12 + 2

Max Persons

12

WC

6

Engine

2 x 80 HP

Fuel tank

1040 l



WEBSITE

www.plujeme.cz



PHONE

+420 720 755 085



MOBILE

+420 777 170 276



E-MAIL

info@plujeme.cz



PLUJEME RÁDI S.R.O.

Dlouhá 730/35, 11000 Praha 1 - Staré Město, Czech Republic

STANDARD YACHT EQUIPMENT

Comfort	Beach towel, Cockpit cushions, Deck cushions, Outside cushions, Towels
Deck	Anchor with chain, Bilge pump – Mechanic, Bimini top, Camera, Cockpit fridge, Cockpit table, Cockpit/stern, outside shower, Dinghy with outboard engine, Electric anchor windlass, Grill/Barbecue/Plancha, Spring cleats, Swimming ladder, Teak cockpit, Winch handles
Entertainment	FUSION sound system, Indoor speakers, Outdoor speakers, Radio, Stand up paddle (SUP) - FREE, Underwater lights
Galley	Dishwasher, Electrical filter coffee maker, Electrical kettle, Freezer, Ice box, Kitchen utensils (Galley equipment, cutlery), Microwave, Moka pot, Oven, Refrigerator
Interior	Electric fans in cabins, Electric toilet, Lowerable salon table, Upholstery
Navigation	AIS, Autopilot, Compass, GPS chart plotter, Helm station, Speedometer (Speed log), Wind instrument/Anemometer
Safety	Black Water Tank, Extra water tank, VHF radio
Sails	Dacron square top main sail, Electric winch, Lazy bag, Winch
Yacht electrics	Air Conditioning, Batteries, Battery charger , Bilge pump - Electric, DSC station, Generator, Heating, Inverter, Plug 220V, 12 V, Shore connection 220 V, USB sockets, Water heater, Watermaker - desalinator



WEBSITE

www.plujeme.cz



PHONE

+420 720 755 085



MOBILE

+420 777 170 276



E-MAIL

info@plujeme.cz



PLUJEME RÁDI S.R.O.

Dlouhá 730/35, 11000 Praha 1 – Staré Město, Czech Republic

SERVICES

SELECTED SERVICES	OBLIGATORY	PAYMENT TYPE	PRICE
Cruising tax (Payable now) Season: 2024 . BVI: Cruising tax payable in advance: 4 USD per person / day (Price will be adjusted when the option is confirmed)	Yes	per guest/day	3,48 €
Navigare Carefree (Payable now) Season: 2024 . *** To be added upon client's price - OBLIGATORY - CAT from 46 ft - BVI - Includes damage waiver insurance/full coverage* - NEW!, welcome package, final cleaning, bed sheets & towels, dinghy, outboard engine & fuel, propane gas, full water tanks, snorkelling equipment, National parks permits and VISAR . Beach towels are provided 1 per person for the charter. Yacht Fuel is not included - the fuel tank will be full when your charter starts and you are responsible for topping off the fuel tank at the end of your charter. ***** CRUISING TAX is NOT INCLUDED.	Yes	per booking	840,00 €
Navigare Carefree surcharge for two/more weeks (Payable now) Season: 2024 . Damage waiver insurance, bed linen & towels/ obligatory - will only be added to a charter with a duration between 14 and 20 days	Yes	per 2 weeks	170,00 €
Navigare Carefree surcharge for two/more weeks (Payable now) Season: 2024 . Damage waiver insurance, bed linen & towels/ obligatory will only be added to a charter with a duration between 21 and 27 days	Yes	per 3 weeks	320,00 €
Navigare Carefree surcharge for two/more weeks (Payable now) Season: 2024 . Damage waiver insurance, bed linen & towels/ obligatory - will only be added to a charter with a duration of 28+ days	Yes	per 4 weeks and more	470,00 €
Cruising tax (Payable now) Season: 2025 . BVI: Cruising tax payable in advance: 4 USD per person / day (Price will be adjusted when the option is confirmed)	Yes	per guest/day	3,48 €
Navigare Carefree (Payable now) Season: 2025 . *** To be added upon client's price - OBLIGATORY - CAT from 46 ft - BVI - Includes damage waiver insurance/full coverage* - NEW!, welcome package, final cleaning, bed sheets & towels, dinghy, outboard engine & fuel, propane gas, full water tanks, snorkelling equipment, National parks permits and VISAR . Beach towels are provided 1 per person for the charter. Yacht Fuel is not included - the fuel tank will be full when your charter starts and you are responsible for topping off the fuel tank at the end of your charter. ***** CRUISING TAX is NOT INCLUDED.	Yes	per booking	840,00 €

<p>Navigare Carefree surcharge for two/more weeks (Payable now)</p> <p>Season: 2025. Damage waiver insurance, bed linen & towels/ obligatory - will only be added to a charter with a duration between 14 and 20 days</p>	Yes	per 2 weeks	185,00 €
<p>Navigare Carefree surcharge for two/more weeks (Payable now)</p> <p>Season: 2025. Damage waiver insurance, bed linen & towels/ obligatory - will only be added to a charter with a duration between 21 and 27 days</p>	Yes	per 3 weeks	350,00 €
<p>Navigare Carefree surcharge for two/more weeks (Payable now)</p> <p>Season: 2025. Damage waiver insurance, bed linen & towels/ obligatory - will only be added to a charter with a duration of 28+ days</p>	Yes	per 4 weeks and more	515,00 €
<p>APA (Advance Provisioning Allowance) (Payable now)</p> <p>Season: 2024 . The APA amount is used to cover all expenses during the course of the charter such as fuel, food, beverages, mooring fee and other expenses not included in the Charter Fee. The captain of the yacht is responsible for accounting for all APA expenses during the charter, and the breakdown will be presented to the client at the end of the charter. (AVAILABLE ONLY WHEN BOOKED WITH NAVIGARE SKIPPER AND HOSTESS OR COOK)</p>	Yes	per week	4.400,00 €
<p>Checkout Skipper (Payable now)</p> <p>Season: 2024 . A check-out skipper (COS) is a professional captain that boards with you on Day 1, and is dropped off late afternoon the same day. A COS may be requested by you or may be required by Navigare after review of your sailing resume.</p>	Yes	per booking	305,00 €
<p>Cook (Payable now)</p> <p>Season: 2024 . Cook requires own cabin with a toilet and shower + food (not peak cabin). A gratuity of 15-20% of the crew fee is customary for excellent service. Cooking breakfast, lunch, dinners, supply, keeping the kitchen clean (not the rest of the boat, not the cabins). *** NOTE: Cook details will be available 3 days before charter.</p>	Yes	per day + food	220,00 €
<p>Sailing Instructor (Payable now)</p> <p>Season: 2024 . Sailing instructor BVI</p>	Yes	per day + food	350,00 €
<p>Skipper (Payable now)</p> <p>Season: 2024 . Skipper requires standard cabin with access to a toilet and shower + food (not peak skipper cabin). A gratuity of 15-20% of the crew fee is customary for excellent service ***NOTE: Skipper details will be available 3 days before the charter.</p>	Yes	per day + food	270,00 €

Skipper (Payable now) Season: 2024 . Skipper using crew-cabin (peak cabin) with access to a toilet and shower. A gratuity of 15-20% of the crew fee is customary for excellent service ***NOTE: Skipper details will be available 3 days before the charter	Yes	per day + food	315,00 €
Sleep over before check in (Payable now) Season: 2024 . Sleep over on a day before the check-in: Sleep over from 5PM on a day before the check-in date and time stated in the contract: 65% of the daily rate. (Price will be adjusted when the option is confirmed)	Yes	per booking	1.000,00 €
WIFI package (Payable now) Season: 2024 . Unlimited Wifi / BVI / BAH / USVI	Yes	per booking	130,44 €
APA (Advance Provisioning Allowance) (Payable now) Season: 2025 . The APA amount is used to cover all expenses during the course of the charter such as fuel, food, beverages, mooring fee and other expenses not included in the Charter Fee. The captain of the yacht is responsible for accounting for all APA expenses during the charter, and the breakdown will be presented to the client at the end of the charter. (AVAILABLE ONLY WHEN BOOKED WITH NAVIGARE SKIPPER AND HOSTESS OR COOK)	Yes	per week	4.400,00 €
Checkout Skipper (Payable now) Season: 2025 . A check-out skipper (COS) is a professional captain that boards with you on Day 1, and is dropped off late afternoon the same day. A COS may be requested by you or may be required by Navigare after review of your sailing resume.	Yes	per booking	370,00 €
Cook (Payable now) Season: 2025 . Cook requires standard cabin with access to a toilet and shower + food. A gratuity of 15-20% of the crew fee is customary for excellent service. Cooking breakfast, lunch, dinners, and supplies, keeping the kitchen clean (not the rest of the boat, not the cabins). ***NOTE: Cook details will be available 3 days before the charter.	Yes	per day + food	240,00 €
Sailing Instructor (Payable at the base) Season: 2025 . Sailing instructor BVI	Yes	per day + food	350,00 €
Skipper (Payable now) Season: 2025 . Skipper requires standard cabin with access to a toilet and shower + food (not peak skipper cabin). A gratuity of 15-20% of the crew fee is customary for excellent service ***NOTE: Skipper details will be available 3 days before the charter.	Yes	per day + food	295,00 €

Skipper (Payable now)	Yes	per day + food	345,00 €
Season: 2025. Skipper using crew-cabin (peak cabin) with access to a toilet and shower*** Gratuity A gratuity of 15-20% of the crew fee is customary for excellent service ***NOTE: Skipper details will be available 3 days before the charter			
Sleep over before check in (Payable now)	Yes	per booking	1.000,00 €
Season: 2025. Sleep over on a day before the check-in: Sleep over from 5PM on a day before the check-in date and time stated in the contract: 65% of the daily rate. (Price will be adjusted when the option is confirmed)			
WIFI package (Payable now)	Yes	per booking	130,44 €
Season: 2025. Unlimited Wifi / BVI / BAH / CAR			



 **WEBSITE**
www.plujeme.cz

 **E-MAIL**
info@plujeme.cz

 **PHONE**
+420 720 755 085

 **PLUJEME RÁDI S.R.O.**
Dlouhá 730/35, 11000 Praha 1 – Staré Město, Czech Republic

 **MOBILE**
+420 777 170 276

ADDITIONAL EXTRAS

EXTRA	OBLIGATORY	PAYMENT TYPE	PRICE
Railing net (Safety net) (Payable now) Season: 2024 . Railing net - mounting not included. Clients must mount the railing net (safety net) by themselves (On request - LIMITED NUMBER) - Payable now	Yes	per booking	142,00 €
Stand up paddle (SUP) (Payable now) Season: 2024 . Payable now	Yes	per day	20,00 €
Railing net (Safety net) (Payable now) Season: 2025 . mounting not included - Payable now	Yes	per booking	155,00 €
Stand up paddle (SUP) (Payable now) Season: 2025 . Payable now	Yes	per day	20,00 €



WEBSITE
www.plujeme.cz



E-MAIL
info@plujeme.cz



PHONE
+420 720 755 085



PLUJEME RÁDI S.R.O.
Dlouhá 730/35, 11000 Praha 1 – Staré Město, Czech Republic



MOBILE
+420 777 170 276

PRICE AND AVAILABILITY

06.10. - 16.10.2024 NOT AVAILABLE	19.10. - 26.10.2024 6.905 € 12.330 €	02.11. - 12.11.2024 NOT AVAILABLE	14.11. - 19.11.2024 NOT AVAILABLE
22.11. - 03.12.2024 NOT AVAILABLE	07.12. - 14.12.2024 10.038 € 16.730 €	14.12. - 21.12.2024 13.206 € 22.010 €	28.12. - 05.01.2025 NOT AVAILABLE
07.01. - 15.01.2025 NOT AVAILABLE	15.01. - 24.01.2025 NOT AVAILABLE	25.01. - 01.02.2025 13.232 € 16.540 €	01.02. - 12.02.2025 NOT AVAILABLE
15.02. - 22.02.2025 15.997 € 18.820 €	22.02. - 01.03.2025 15.997 € 18.820 €	01.03. - 08.03.2025 15.997 € 18.820 €	08.03. - 15.03.2025 15.997 € 18.820 €
15.03. - 22.03.2025 15.997 € 18.820 €	22.03. - 29.03.2025 15.997 € 18.820 €	29.03. - 05.04.2025 14.423 € 19.230 €	05.04. - 17.04.2025 NOT AVAILABLE
19.04. - 26.04.2025 14.059 € 16.540 €	26.04. - 03.05.2025 14.059 € 16.540 €		



WEBSITE
www.plujeme.cz



E-MAIL
info@plujeme.cz



PHONE
+420 720 755 085



MOBILE
+420 777 170 276



PLUJEME RÁDI S.R.O.
Dlouhá 730/35, 11000 Praha 1 – Staré Město, Czech Republic

PRICE AND AVAILABILITY

03.05. - 10.05.2025 14.059 € 16.540 €	10.05. - 17.05.2025 12.427 € 14.620 €	17.05. - 24.05.2025 12.427 € 14.620 €	24.05. - 31.05.2025 12.427 € 14.620 €
31.05. - 07.06.2025 12.427 € 14.620 €	07.06. - 14.06.2025 12.427 € 14.620 €	20.06. - 29.06.2025 NOT AVAILABLE	05.07. - 13.07.2025 NOT AVAILABLE
19.07. - 26.07.2025 9.155 € 10.770 €	26.07. - 02.08.2025 9.155 € 10.770 €	04.08. - 10.10.2025 NOT AVAILABLE	11.10. - 18.10.2025 9.155 € 10.770 €
18.10. - 25.10.2025 9.155 € 10.770 €	25.10. - 01.11.2025 9.155 € 10.770 €	01.11. - 08.11.2025 9.155 € 10.770 €	08.11. - 15.11.2025 9.155 € 10.770 €
15.11. - 22.11.2025 9.155 € 10.770 €	22.11. - 29.11.2025 12.427 € 14.620 €	29.11. - 06.12.2025 12.427 € 14.620 €	06.12. - 13.12.2025 12.427 € 14.620 €
13.12. - 20.12.2025 12.427 € 14.620 €	20.12. - 27.12.2025 19.230 €		



WEBSITE

www.plujeme.cz



E-MAIL

info@plujeme.cz



PHONE

+420 720 755 085



MOBILE

+420 777 170 276



PLUJEME RÁDI S.R.O.

Dlouhá 730/35, 11000 Praha 1 – Staré Město, Czech Republic