

# LAGOON 46

Ghost Buster (2023)

Catamaran Lagoon 46 Ghost Buster, built in 2023 is anchored in the **Seychelles, Eden Island Marina, Mahé, Seychelles**. It has **4 + 2 cabins**, can accommodate **8 + 2 people** and has **4 toilets**. Bed linen and kitchen equipment are included in the price.

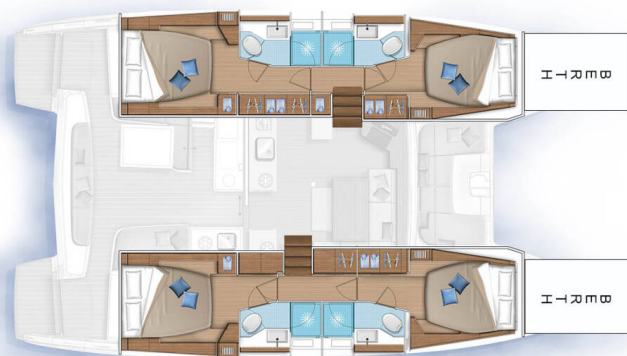

## YACHT SPECIFICATIONS

Yacht Base

**Seychelles, Eden Island Marina,  
Seychelles**

Yacht ID

**8896**

Brands

**Lagoon**

Yacht name

**Ghost Buster**

Production year

**2023**

Length

**46 ft**

Cabins

**4 + 2**

Berths

**8 + 2**

Max Persons

**10**

WC

**4**

Engine

**2 x 57 HP**

Fuel tank

**1040 l**



**WEBSITE**

[www.plujeme.cz](http://www.plujeme.cz)



**PHONE**

+420 720 755 085



**MOBILE**

+420 777 170 276



**E-MAIL**

[info@plujeme.cz](mailto:info@plujeme.cz)



**PLUJEME RÁDI S.R.O.**

Dlouhá 730/35, 11000 Praha 1 – Staré Město, Czech Republic

## STANDARD YACHT EQUIPMENT

Additional	Flag
Comfort	<b>Blankets, Cockpit cushions, Outside cushions, Pillows</b>
Deck	<b>Anchor with chain, Bilge pump - Mechanic, Bimini top, Boat hook, Bosun's chair (Safe seat) (boatswain's chair), Cockpit fridge, Cockpit table, Cockpit/stern, outside shower, Deck brush, Deck lights, Dinghy with outboard engine, Electric anchor windlass, Fenders, Flybridge, Gangway, Jerry cans for fuel, LED outdoor ambiance lights, Mooring Cleats, Mooring ropes , Round/globular fender, Spare anchor (Reserve, Auxiliary anchor), Sponge, Spring cleats, Swimming ladder, Teak cockpit, Teak cockpit table with folding leaves, Water hose, Winch handles</b>
Entertainment	<b>Bose Sound System, Fins, Fusion radio, Mask and snorkel, Underwater lights</b>
Galley	<b>Blender, Gas bottles, Gas cookers, Kitchen towel, Kitchen utensils (Galley equipment, cutlery), Oven, Refrigerator, Side galley, Stove, Water pump</b>
Interior	<b>Clothes hangers, Electric fans in cabins, Electric toilet, Foldable table, LED interior lights, Toilet brush, Upholstery, Yacht interior refit</b>
Navigation	<b>Autopilot, Binoculars, Compass, Forwardscan sounder, GPS chart plotter, LED Navigation lights, Nautical charts, Navigation (Nautical) charts and nautical guide , Navigation set, Parallel ruler, Radar, Radar reflector, Tridata, Windex</b>
Safety	<b>Black Water Tank, Distress flare box, Emergency tiller, Fire extinguisher , First aid kit , Flashlight, Fog horn, Horseshoe lifebuoy, Life belts (Safety harness), Life jacket (children), Life jackets, Liferaft , Rescue sling (Life sling), Set of tools , Signal flags, Signaling mirror, Spare parts, Torch, VHF radio , Wire (shroud) cutter</b>
Sails	<b>Dacron square top main sail, Electric Flatwinder, Electric winch, Lazy bag, Sails, Winch</b>
Yacht electrics	<b>110V socket, Air Conditioning, Battery charger , Bilge pump - Electric, DSC station, Generator, Inverter, Motor hours counter, Service batteries, Shore power cable, Start battery, USB sockets, Water heater, Watermaker - desalinator, WC pump</b>



**WEBSITE**

[www.plujeme.cz](http://www.plujeme.cz)



**PHONE**

+420 720 755 085



**MOBILE**

+420 777 170 276



**E-MAIL**

[info@plujeme.cz](mailto:info@plujeme.cz)



**PLUJEME RÁDI S.R.O.**

Dlouhá 730/35, 11000 Praha 1 – Staré Město, Czech Republic

## SERVICES

SELECTED SERVICES	OBLIGATORY	PAYMENT TYPE	PRICE
<p><b>Comfort Pack</b> (Payable now)</p> <p><b>Season: 2026 Exotic</b> . To be added upon client's price - OBLIGATORY - SEY Welcome package, final cleaning, bed sheets &amp; towels, dinghy, outboard engine &amp; fuel, propane gas, full water tanks, snorkelling equipment, free Wi-Fi Internet on board with 10GB. Yacht Fuel is not included - the fuel tank will be full when your charter starts and you are responsible for topping off the fuel tank at the end of your charter. Security deposit is obligatory and is paid on spot in the base.</p>	Yes	per booking	<b>615,00 €</b>
<p><b>Tourist tax</b> (Payable now)</p> <p><b>Season: 2026 Exotic</b> . SEY: Touristic tax payable in advance: 100 SCR per person / day (7 EUR per person/day)(Price will be adjusted when the option is confirmed)</p>	Yes	per guest/day	<b>7,00 €</b>
<p><b>Accommodation point purchase</b> (Payable now)</p> <p><b>Season: 2026 Exotic</b> .</p>	No	per boat	<b>15,00 €</b>
<p><b>APA (Advance Provisioning Allowance)</b> (Payable now)</p> <p><b>Season: 2026 Exotic</b> . The APA amount is used to cover all expenses during the course of the charter such as fuel, food, beverages, mooring fee and other expenses not included in the Charter Fee. The captain of the yacht is responsible for accounting for all APA expenses during the charter, and the breakdown will be presented to the client at the end of the charter. (AVAILABLE ONLY WHEN BOOKED WITH NAVIGARE SKIPPER AND HOSTESS OR COOK)</p>	No	per week	<b>4.000,00 €</b>
<p><b>Cook</b> (Payable now)</p> <p><b>Season: 2026 Exotic</b> . Cook/Steward (requires own cabin and access to one of the bathrooms/toilets + food). Cooking breakfast, lunch, dinners, supply, keeping the kitchen clean (not the rest of the boat, not the cabins). ***NOTE: Cook details will be available 3 days before the charter.the charter.</p>	No	per day + food	<b>255,00 €</b>
<p><b>Extra cleaning</b> (Payable now)</p> <p><b>Season: 2026 Exotic</b> . Cleaning and new bed linen and towels</p>	No	per booking	<b>350,00 €</b>
<p><b>Gritchen cancellation insurance</b> (Payable now)</p> <p><b>Season: 2026 Exotic</b> . with Covid coverage (4% of client's Total price)- European clients Only</p>	No	per booking	<b>0,00 €</b>

**Skipper** (Payable now)

No

per day + food

**255,00 €**

**Season: 2026 Exotic** . Skipper (requires own cabin and access to one of the bathrooms/toilets + food). \*\*\*NOTE: Skipper details will be available 3 days before the charter.



**WEBSITE**

[www.plujeme.cz](http://www.plujeme.cz)



**E-MAIL**

[info@plujeme.cz](mailto:info@plujeme.cz)



**PHONE**

+420 720 755 085



**MOBILE**

+420 777 170 276



**PLUJEME RÁDI S.R.O.**

Dlouhá 730/35, 11000 Praha 1 – Staré Město, Czech Republic

## ADDITIONAL EXTRAS

EXTRA	OBLIGATORY	PAYMENT TYPE	PRICE
<b>Extra bedlinen and towels</b> <i>(Payable now)</i> <b>Season: 2026 Exotic</b> . <i>Payable now</i>	No	per person	<b>20,00 €</b>
<b>Stand up paddle (SUP)</b> <i>(Payable now)</i> <b>Season: 2026 Exotic</b> . <i>Payable now</i>	No	per day	<b>30,00 €</b>

**WEBSITE**

[www.plujeme.cz](http://www.plujeme.cz)

**E-MAIL**

[info@plujeme.cz](mailto:info@plujeme.cz)

**PHONE**

+420 720 755 085

**MOBILE**

+420 777 170 276

**PLUJEME RÁDI S.R.O.**

Dlouhá 730/35, 11000 Praha 1 – Staré Město, Czech Republic

## PRICE AND AVAILABILITY

28.12. - 04.01.2025 NOT AVAILABLE	04.01. - 11.01.2025 NOT AVAILABLE	11.01. - 18.01.2025 NOT AVAILABLE	18.01. - 25.01.2025 NOT AVAILABLE
25.01. - 01.02.2025 NOT AVAILABLE	01.02. - 08.02.2025 7.128 € 8.910 €	08.02. - 15.02.2025 NOT AVAILABLE	15.02. - 22.02.2025 9.816 € 12.270 €
22.02. - 01.03.2025 NOT AVAILABLE	01.03. - 08.03.2025 NOT AVAILABLE	08.03. - 15.03.2025 11.043 € 12.270 €	19.03. - 26.03.2025 NOT AVAILABLE
29.03. - 05.04.2025 10.854 € 12.060 €	05.04. - 12.04.2025 10.854 € 12.060 €	12.04. - 19.04.2025 10.854 € 12.060 €	19.04. - 26.04.2025 12.060 € 13.400 €
26.04. - 03.05.2025 NOT AVAILABLE	03.05. - 10.05.2025 8.172 € 9.080 €	10.05. - 17.05.2025 7.353 € 8.170 €	17.05. - 24.05.2025 6.759 € 7.510 €
24.05. - 31.05.2025 6.759 € 7.510 €	31.05. - 07.06.2025 6.084 € 6.760 €	07.06. - 14.06.2025 6.084 € 6.760 €	14.06. - 21.06.2025 6.084 € 6.760 €
21.06. - 28.06.2025 6.084 € 6.760 €	28.06. - 05.07.2025 6.948 € 7.720 €	05.07. - 12.07.2025 7.353 € 8.170 €	12.07. - 19.07.2025 7.353 € 8.170 €
19.07. - 26.07.2025 9.513 € 10.570 €	26.07. - 02.08.2025 9.513 € 10.570 €		



WEBSITE

[www.plujeme.cz](http://www.plujeme.cz)



E-MAIL

[info@plujeme.cz](mailto:info@plujeme.cz)



PHONE

+420 720 755 085



MOBILE

+420 777 170 276



PLUJEME RÁDI S.R.O.

Dlouhá 730/35, 11000 Praha 1 – Staré Město, Czech Republic

## PRICE AND AVAILABILITY

02.08. - 09.08.2025 <b>9.513 €</b> 10.570 €	09.08. - 16.08.2025 <b>9.513 €</b> 10.570 €	16.08. - 23.08.2025 <b>5.634 €</b> 6.260 €	23.08. - 30.08.2025 <b>5.913 €</b> 6.570 €
30.08. - 06.09.2025 <b>5.913 €</b> 6.570 €	06.09. - 13.09.2025 <b>5.913 €</b> 6.570 €	13.09. - 20.09.2025 <b>5.913 €</b> 6.570 €	20.09. - 27.09.2025 <b>5.913 €</b> 6.570 €
27.09. - 04.10.2025 <b>9.108 €</b> 10.120 €	04.10. - 11.10.2025 <b>10.719 €</b> 11.910 €	11.10. - 18.10.2025 <b>10.719 €</b> 11.910 €	18.10. - 25.10.2025 <b>10.719 €</b> 11.910 €
25.10. - 01.11.2025 <b>10.719 €</b> 11.910 €	01.11. - 08.11.2025 <b>10.719 €</b> 11.910 €	08.11. - 15.11.2025 <b>10.719 €</b> 11.910 €	15.11. - 22.11.2025 <b>10.719 €</b> 11.910 €
22.11. - 06.12.2025 NOT AVAILABLE	06.12. - 13.12.2025 <b>5.634 €</b> 6.260 €	13.12. - 20.12.2025 <b>5.634 €</b> 6.260 €	20.12. - 27.12.2025 <b>13.400 €</b>



### WEBSITE

[www.plujeme.cz](http://www.plujeme.cz)



### E-MAIL

[info@plujeme.cz](mailto:info@plujeme.cz)



### PHONE

+420 720 755 085



### MOBILE

+420 777 170 276



### PLUJEME RÁDI S.R.O.

Dlouhá 730/35, 11000 Praha 1 – Staré Město, Czech Republic