

LEOPARD 45

Lady Lety (2023)

Catamaran **Leopard 45 Lady Lety**, built in **2023** is anchored in the **Procida, Campania, Italy**. It has **4 + 1 cabins**, can accommodate **8 + 2 + 1 people** and has **4 + 1 toilets**. Bed linen and kitchen equipment are included in the price.

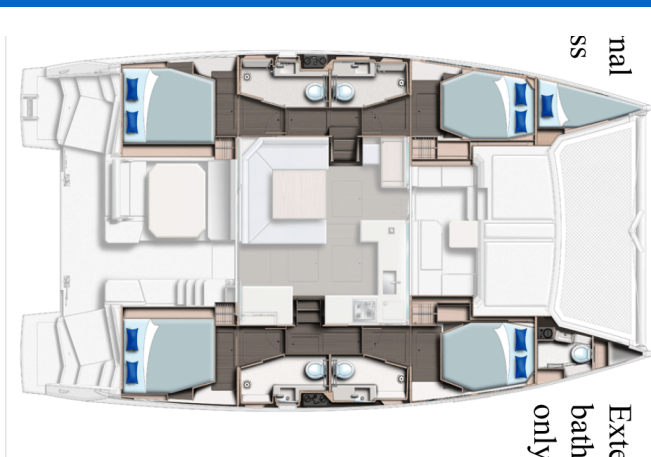

YACHT SPECIFICATIONS

Yacht Base

Procida, Italy

Yacht ID

8621

Brands

Leopard

Yacht name

Lady Lety

Production year

2023

Length

45 ft

Cabins

4 + 1

Berths

8 + 2 + 1

WC

4 + 1

Engine

2 x 45 HP

Fuel tank

700 l



WEBSITE

www.plujeme.cz



PHONE

+420 720 755 085



MOBILE

+420 777 170 276



E-MAIL

info@plujeme.cz



PLUJEME RÁDI S.R.O.

Dlouhá 730/35, 11000 Praha 1 – Staré Město, Czech Republic

STANDARD YACHT EQUIPMENT

Comfort	Pillows
Deck	Anchor with chain, Bilge pump - Mechanic, Bimini top, Boat hook, Bosun's chair (Safe seat) (boatswain's chair), Deck brush, Electric anchor windlass, Fenders, Flybridge, Fuel funnel, Gangway, Mooring ropes , Outboard engine, Plastic bucket, Spare anchor (Reserve, Auxiliary anchor), Swimming ladder, Tender, Water hose, Winch handles
Entertainment	CD player, Fins, Outdoor speakers
Galley	Coffee machine, Gas bottles, Hot water, Kitchen utensils (Galley equipment, cutlery), Oven, Refrigerator, Stove
Interior	Barometer, Clock, Water Purifier
Navigation	Autopilot, Binoculars, Echosounder/Depthsounder, GPS chart plotter, Hand bearing compass, Log, Nautical charts, Pilot book, Radar reflector, Wind instrument/Anemometer
Safety	Buoyant smoke signal, Distress flare box, Emergency tiller, Fire extinguisher , First aid kit , Fog horn, Horseshoe lifebuoy, Life belts (Safety harness), Life jackets, Liferaft , Repair kit, Torch, VHF radio
Sails	Electric winch
Yacht electrics	Air Conditioning, Bilge pump - Electric, Generator, Inverter, Solar panels, Watermaker - desalinator



WEBSITE

www.plujeme.cz



PHONE

+420 720 755 085



MOBILE

+420 777 170 276



E-MAIL

info@plujeme.cz



PLUJEME RÁDI S.R.O.

Dlouhá 730/35, 11000 Praha 1 - Staré Město, Czech Republic

SERVICES

SELECTED SERVICES	OBLIGATORY	PAYMENT TYPE	PRICE
Permit (Payable at the base) Season: 2024. Local Permit "Regno di Nettuno"	Yes	per boat	20,00 €
Permit (Payable at the base) Season: 2025. Local Permit "Regno di Nettuno"	Yes	per boat	20,00 €
Advanced half board (Payable at the base) Season: 2024. Naples Airport/Train station - Base Procida, 9-12 pax	Yes	one-way	315,00 €
Airport transfer (Payable at the base) Season: 2024. Olbia Airport - Cannigione Base, 1- 4 pax	Yes	one-way	200,00 €
Airport transfer (Payable at the base) Season: 2024. Naples Airport/Train station - Base Procida, 1- 4 pax	Yes	one-way	210,00 €
Airport transfer (Payable at the base) Season: 2024. Catania Airport - Portorosa Base, 1- 3 pax	Yes	one-way	230,00 €
Airport transfer (Payable at the base) Season: 2024. Olbia Airport - Cannigione Base, 5 - 8 pax	Yes	one-way	250,00 €
Airport transfer (Payable at the base) Season: 2024. Naples Airport/Train station - Base Procida, 5-8 pax	Yes	one-way	265,00 €
Airport transfer (Payable at the base) Season: 2024. Catania Airport - Portorosa Base, 4 - 8 pax	Yes	one-way	300,00 €
Airport transfer (Payable at the base) Season: 2024. Olbia Airport - Cannigione Base, 9 - 12 pax	Yes	one-way	300,00 €
Airport transfer (Payable at the base) Season: 2024. Palermo Airport - Portorosa Base, 1- 3 pax	Yes	one-way	305,00 €
Airport transfer (Payable at the base) Season: 2024. Naples Airport/Train station - Base Procida, 9-12 pax	Yes	one-way	315,00 €
Airport transfer (Payable at the base) Season: 2024. Palermo Airport - Portorosa Base, 4 - 8 pax	Yes	one-way	370,00 €

Airport transfer (Payable at the base) Season: 2024. Catania Airport - Portorosa Base, 9 - 14 pax	Yes	one-way	390,00 €
Airport transfer (Payable at the base) Season: 2024. Palermo Airport - Portorosa Base, 9 - 14 pax	Yes	one-way	450,00 €
Airport transfer (Payable at the base) Season: 2024. Rome Airport - Base Procida, 1- 4 pax	Yes	one-way	630,00 €
Airport transfer (Payable at the base) Season: 2024. Rome Airport - Base Procida, 5 - 8 pax	Yes	one-way	820,00 €
Damage waiver (Payable at the base) Season: 2024. security deposit € 1050	Yes	per booking	511,00 €
Flotilla fee (Payable at the base) Season: 2024.	Yes	per person	255,00 €
Food & drink package (Payable at the base) Season: 2024. SailEATalia, for more details contact charter company	Yes	per person	425,00 €
Hostess (Payable at the base) Season: 2024. must be confirmed at the time of booking	Yes	per week	1.400,00 €
One way (Payable at the base) Season: 2024. not available from/to Cannigione and from every base for the period between 23/07 to 27/08	Yes	per booking	950,00 €
Permit (Payable at the base) Season: 2024. Local Permit "Regno di Nettuno"	Yes	per boat	20,00 €
Provisioning (Payable at the base) Season: 2024. Available on request	Yes	per booking	0,00 €
Skipper (Payable at the base) Season: 2024. must be confirmed at the time of booking	Yes	per week	1.900,00 €
WI-FI Internet connection on boat (Payable at the base) Season: 2024. 5GB - 5 connections (€50 deposit for the modem)	Yes	per week	100,00 €
Advanced half board (Payable at the base) Season: 2025. Naples Airport/Train station - Base Procida, 9-12 pax	Yes	one-way	315,00 €
Airport transfer (Payable at the base) Season: 2025. Olbia Airport - Cannigione Base, 1- 4 pax	Yes	one-way	200,00 €

Airport transfer (Payable at the base) Season: 2025. Naples Airport/Train station - Base Procida, 1- 4 pax	Yes	one-way	210,00 €
Airport transfer (Payable at the base) Season: 2025. Catania Airport - Portorosa Base, 1- 3 pax	Yes	one-way	230,00 €
Airport transfer (Payable at the base) Season: 2025. Olbia Airport - Cannigione Base, 5 - 8 pax	Yes	one-way	250,00 €
Airport transfer (Payable at the base) Season: 2025. Naples Airport/Train station - Base Procida, 5-8 pax	Yes	one-way	265,00 €
Airport transfer (Payable at the base) Season: 2025. Catania Airport - Portorosa Base, 4 - 8 pax	Yes	one-way	300,00 €
Airport transfer (Payable at the base) Season: 2025. Olbia Airport - Cannigione Base, 9 - 12 pax	Yes	one-way	300,00 €
Airport transfer (Payable at the base) Season: 2025. Palermo Airport - Portorosa Base, 1- 3 pax	Yes	one-way	305,00 €
Airport transfer (Payable at the base) Season: 2025. Naples Airport/Train station - Base Procida, 9-12 pax	Yes	one-way	315,00 €
Airport transfer (Payable at the base) Season: 2025. Palermo Airport - Portorosa Base, 4 - 8 pax	Yes	one-way	370,00 €
Airport transfer (Payable at the base) Season: 2025. Catania Airport - Portorosa Base, 9 - 14 pax	Yes	one-way	390,00 €
Airport transfer (Payable at the base) Season: 2025. Palermo Airport - Portorosa Base, 9 - 14 pax	Yes	one-way	450,00 €
Airport transfer (Payable at the base) Season: 2025. Rome Airport - Base Procida, 1- 4 pax	Yes	one-way	630,00 €
Airport transfer (Payable at the base) Season: 2025. Rome Airport - Base Procida, 5 - 8 pax	Yes	one-way	820,00 €
Damage waiver (Payable at the base) Season: 2025. security deposit € 1050	Yes	per booking	511,00 €
Flotilla fee (Payable at the base) Season: 2025.	Yes	per person	255,00 €

Food & drink package (Payable at the base)	Yes	per person	425,00 €
Season: 2025. SailEATalia, for more details contact charter company			
Hostess (Payable at the base)	Yes	per week	1.400,00 €
Season: 2025. must be confirmed at the time of booking			
One way (Payable at the base)	Yes	per booking	950,00 €
Season: 2025. not available from/to Cannigione and from every base for the period between 23/07 to 27/08			
Permit (Payable at the base)	Yes	per boat	20,00 €
Season: 2025. Local Permit "Regno di Nettuno"			
Provisioning (Payable at the base)	Yes	per booking	0,00 €
Season: 2025. Available on request			
Skipper (Payable at the base)	Yes	per week	1.900,00 €
Season: 2025. must be confirmed at the time of booking			
WI-FI Internet connection on boat (Payable at the base)	Yes	per week	100,00 €
Season: 2025. 5GB - 5 connections (€50 deposit for the modem)			



WEBSITE

www.plujeme.cz



E-MAIL

info@plujeme.cz



PHONE

+420 720 755 085



MOBILE

+420 777 170 276



PLUJEME RÁDI S.R.O.

Dlouhá 730/35, 11000 Praha 1 – Staré Město, Czech Republic

ADDITIONAL EXTRAS

EXTRA	OBLIGATORY	PAYMENT TYPE	PRICE
Kayak (Payable at the base) Season: 2024. One person, on availability at the base - Payable at the base	Yes	per week	180,00 €
Railing net (Safety net) (Payable at the base) Season: 2024. Payable at the base	Yes	per booking	200,00 €
Stand up paddle (SUP) (Payable at the base) Season: 2024. on availability at the base - Payable at the base	Yes	per week	200,00 €
Kayak (Payable at the base) Season: 2025. One person, on availability at the base - Payable at the base	Yes	per week	180,00 €
Railing net (Safety net) (Payable at the base) Season: 2025. Payable at the base	Yes	per booking	200,00 €
Stand up paddle (SUP) (Payable at the base) Season: 2025. on availability at the base - Payable at the base	Yes	per week	200,00 €



WEBSITE

www.plujeme.cz



E-MAIL

info@plujeme.cz



PHONE

+420 720 755 085



MOBILE

+420 777 170 276



PLUJEME RÁDI S.R.O.

Dlouhá 730/35, 11000 Praha 1 – Staré Město, Czech Republic

PRICE AND AVAILABILITY

21.09. - 28.09.2024 NOT AVAILABLE	28.09. - 05.10.2024 NOT AVAILABLE	05.10. - 12.10.2024 4.410 € 6.300 €	12.10. - 19.10.2024 4.410 € 6.300 €
19.10. - 26.10.2024 4.410 € 6.300 €	26.10. - 02.11.2024 4.410 € 6.300 €	02.11. - 09.11.2024 5.670 € 6.300 €	09.11. - 16.11.2024 5.670 € 6.300 €
16.11. - 23.11.2024 5.670 € 6.300 €	23.11. - 30.11.2024 5.670 € 6.300 €	30.11. - 07.12.2024 5.670 € 6.300 €	07.12. - 14.12.2024 5.670 € 6.300 €
14.12. - 21.12.2024 5.670 € 6.300 €	21.12. - 28.12.2024 5.670 € 6.300 €	04.01. - 11.01.2025 6.480 € 7.200 €	11.01. - 18.01.2025 6.480 € 7.200 €
18.01. - 25.01.2025 6.480 € 7.200 €	25.01. - 01.02.2025 6.480 € 7.200 €	01.02. - 08.02.2025 6.480 € 7.200 €	08.02. - 15.02.2025 6.480 € 7.200 €
15.02. - 22.02.2025 6.480 € 7.200 €	22.02. - 01.03.2025 6.480 € 7.200 €	01.03. - 08.03.2025 6.480 € 7.200 €	08.03. - 15.03.2025 6.480 € 7.200 €
15.03. - 22.03.2025 6.480 € 7.200 €	22.03. - 29.03.2025 6.480 € 7.200 €	29.03. - 05.04.2025 6.480 € 7.200 €	05.04. - 12.04.2025 6.480 € 7.200 €
12.04. - 19.04.2025 6.480 € 7.200 €	19.04. - 26.04.2025 6.480 € 7.200 €	26.04. - 03.05.2025 7.200 € 8.000 €	



WEBSITE

www.plujeme.cz



E-MAIL

info@plujeme.cz



PHONE

+420 720 755 085



MOBILE

+420 777 170 276



PLUJEME RÁDI S.R.O.

Dlouhá 730/35, 11000 Praha 1 – Staré Město, Czech Republic

PRICE AND AVAILABILITY

03.05. - 10.05.2025 6.480 € 7.200 €	10.05. - 17.05.2025 6.480 € 7.200 €	17.05. - 24.05.2025 7.560 € 8.400 €	24.05. - 31.05.2025 7.560 € 8.400 €
31.05. - 07.06.2025 8.280 € 9.200 €	07.06. - 14.06.2025 8.280 € 9.200 €	14.06. - 21.06.2025 9.000 € 10.000 €	21.06. - 28.06.2025 9.000 € 10.000 €
28.06. - 05.07.2025 9.450 € 10.500 €	05.07. - 12.07.2025 9.450 € 10.500 €	12.07. - 19.07.2025 9.990 € 11.100 €	19.07. - 26.07.2025 9.990 € 11.100 €
26.07. - 02.08.2025 11.025 € 12.250 €	02.08. - 09.08.2025 11.025 € 12.250 €	09.08. - 16.08.2025 12.150 € 13.500 €	16.08. - 23.08.2025 12.150 € 13.500 €
23.08. - 30.08.2025 9.990 € 11.100 €	30.08. - 06.09.2025 9.990 € 11.100 €	06.09. - 13.09.2025 10.440 € 11.600 €	13.09. - 20.09.2025 NOT AVAILABLE
20.09. - 27.09.2025 10.440 € 11.600 €	27.09. - 04.10.2025 NOT AVAILABLE	04.10. - 11.10.2025 9.000 € 10.000 €	11.10. - 18.10.2025 9.000 € 10.000 €
18.10. - 25.10.2025 5.400 € 6.000 €	25.10. - 01.11.2025 5.400 € 6.000 €	01.11. - 08.11.2025 5.400 € 6.000 €	08.11. - 15.11.2025 5.400 € 6.000 €
15.11. - 22.11.2025 5.400 € 6.000 €	22.11. - 29.11.2025 5.400 € 6.000 €	29.11. - 06.12.2025 5.400 € 6.000 €	06.12. - 13.12.2025 5.400 € 6.000 €
13.12. - 20.12.2025 5.400 € 6.000 €	20.12. - 27.12.2025 5.400 € 6.000 €		



WEBSITE

www.plujeme.cz



E-MAIL

info@plujeme.cz



PHONE

+420 720 755 085



MOBILE

+420 777 170 276



PLUJEME RÁDI S.R.O.

Dlouhá 730/35, 11000 Praha 1 – Staré Město, Czech Republic