

SUN ODYSSEY 419

OFFENBACH (2017)

Sailing yacht Sun Odyssey 419 OFFENBACH, built in 2017 is anchored in the **Seychelles, Praslin, Mahé, Seychelles**. It has **3 cabins**, can accommodate **6 + 2 people** and has **2 toilets**. Bed linen and kitchen equipment are included in the price.

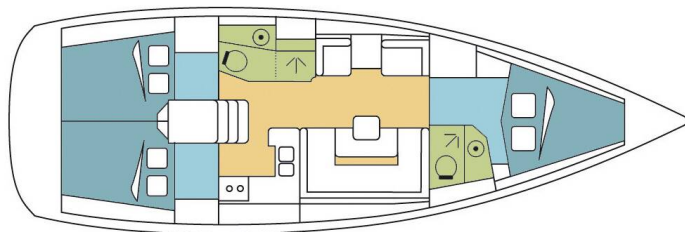

YACHT SPECIFICATIONS

Yacht Base

Seychelles, Praslin, Seychelles

Yacht ID

8425

Brands

Jeanneau

Yacht name

OFFENBACH

Production year

2017

Length

42 ft

Cabins

3

Berths

6 + 2

Max Persons

6

WC

2

Engine

1 x 45 HP

Fuel tank

220 l



WEBSITE

www.plujeme.cz



PHONE

+420 720 755 085



MOBILE

+420 777 170 276



E-MAIL

info@plujeme.cz



PLUJEME RÁDI S.R.O.

Dlouhá 730/35, 11000 Praha 1 – Staré Město, Czech Republic

STANDARD YACHT EQUIPMENT

Comfort	Cockpit cushions
Deck	Bimini top, Cockpit table, Cockpit/stern, outside shower, Dinghy, Electric anchor windlass, Outboard engine, Sprayhood, Swimming ladder
Entertainment	Radio
Galley	Hot water, Oven, Refrigerator, Stove
Interior	Convertible table in salon, Electric toilet
Navigation	Autopilot, Depthsounder, GPS chart plotter, Speedometer (Speed log), Wind instrument/Anemometer
Safety	VHF radio
Sails	Self tailing (manual) winch
Yacht electrics	Battery switch, Inverter, Plug 220V, 12 V



WEBSITE
www.plujeme.cz



E-MAIL
info@plujeme.cz



PHONE
+420 720 755 085



PLUJEME RÁDI S.R.O.
Dlouhá 730/35, 11000 Praha 1 – Staré Město, Czech Republic



MOBILE
+420 777 170 276

SERVICES

SELECTED SERVICES	OBLIGATORY	PAYMENT TYPE	PRICE
<p>Essentials pack (Payable now)</p> <p>Season: 2026 Exotic. INCLUDED: full reduction of security deposit (0 € at base)// starter pack – (1 gallon water or 4 bottles of 1.5L, 1 bottle of disinfectant, 1 small bottle of washing up liquid, 1 dish cloth, 1 sponge, garbage bags, 1 roll of paper towels, 1 box of matches, 1 roll of toilet paper in each head)// final cleaning // 1 set of bed sheets & towels, dinghy, outboard engine & initial supply of fuel, gas and water tanks// DYC assistance guarantee // 1st & last night in the marina /// NOT INCLUDED: refuelling, gas & water consumption at end of charter, taxes if any, handling fees, additional equipment deposit</p>	Yes	per booking	565,00 €
<p>Handling fees (Payable now)</p> <p>Season: 2026 Exotic.</p>	Yes	per booking	35,00 €
<p>The Tourism Environmental Sustainability Levy (Payable at the base)</p> <p>Season: 2026 Exotic. Compulsory to pay in SCR or equivalent Currency as per daily rate on base. To be paid locally, price is 100 SCR per person per day. NOT be applicable to citizens and residents of Seychelles, children of 12 years and below (visitors), and Dream Yacht crew.</p>	Yes	per guest/day	6,67 €
<p>Deckhand/ Marinero (Payable now)</p> <p>Season: 2026 Exotic. + provisioning</p>	No	per night	130,00 €
<p>Electric & Water consumption in the Marinas (Payable at the base)</p> <p>Season: 2026 Exotic. Electric & Water consumption based on 2 nights on our dock (base will confirm the amount to pay locally depending on nights spent on dock)</p>	No	per booking	16,00 €
<p>Extra set of linen (choose how many) (Payable now)</p> <p>Season: 2026 Exotic. Extra set of linen : 15 € 1 set of linen (2 sheets & 2 pillow case) - to be updated manually</p>	No	per booking	15,00 €
<p>Extra set of towels (choose how many) (Payable now)</p> <p>Season: 2026 Exotic. Extra set of towels: 10 € 1 set of towels (1 face & 1 bath towel) - to be updated manually</p>	No	per booking	10,00 €
<p>Final cleaning (Payable now)</p> <p>Season: 2026 Exotic. included in Essentials pack</p>	No	per booking	220,00 €

Full board 1-4 pax (number of guests to update manually) (Payable now) Season: 2026 Exotic. only available if cook is booked on board as the cook will do the provisioning based on client's preference. Includes breakfast, lunch & dinner + the crew's food. Does not included alcoholic drinks	No	per guest/day	60,00 €
Full board 5-12 pax (number of guests to update manually) (Payable now) Season: 2026 Exotic. only available if cook is booked on board as the cook will do the provisioning based on client's preference. Includes breakfast, lunch & dinner + the crew's food. Does not included alcoholic drinks	No	per guest/day	55,00 €
Half board 1-4 pax (number of guests to update manually) (Payable now) Season: 2026 Exotic. only available if cook is booked on board as the cook will do the provisioning based on client's preference. Includes breakfast & lunch OR dinner + the crew's food. Does not included alcoholic drinks	No	per guest/day	50,00 €
Half board 5-12 pax (number of guests to update manually) (Payable now) Season: 2026 Exotic. only available if cook is booked on board as the cook will do the provisioning based on client's preference. Includes breakfast & lunch OR dinner + the crew's food. Does not included alcoholic drinks	No	per guest/day	45,00 €
Regatta surcharge (Payable now) Season: 2026 Exotic. all the regattas apart of ASW (different regatta surcharge for ASW) // A special race deposit need to be doubled manually once the regatta surcharge is added.	No	per booking	0,00 €
Skipper (Payable now) Season: 2026 Exotic. + provisioning, a cabin or forepeak to sleep and access to a WC/Shower	No	per night	150,00 €
Skipper+Cook (Payable now) Season: 2026 Exotic. (for charters up to max 3 guests, one person works as a skipper and cook)+ provisioning, a cabin or forepeak to sleep and access to a WC/Shower	No	per night	210,00 €
Starter pack (Payable now) Season: 2026 Exotic. included in Essentials pack (The pack includes: 1 gallon water (or 4 bottles of 1.5L), 1 bottle of disinfectant, 1 small bottle of washing up liquid, 1 dish cloth, 1 sponge, garbage bags, 1 roll of paper towels, 1 box of matches, 1 roll of toilet paper in each head	No	per booking	50,00 €
Steward/Cook (Payable now) Season: 2026 Exotic. + provisioning, a cabin or forepeak to sleep and access to a WC/Shower	No	per night	135,00 €
Transfer (Payable now) Season: 2026 Exotic. OW - Jetty Terminal/base 1 to 4 pax	No	one-way	15,00 €

Transfer (Payable now)	No	one-way	20,00 €
Season: 2026 Exotic. OW - Jetty Terminal/base 5 to 8 pax			
Transfer (Payable now)	No	one-way	29,00 €
Season: 2026 Exotic. OW - Jetty Terminal/base 9 to 12 pax			
Transfer (Payable now)	No	round trip	78,00 €
Season: 2026 Exotic. RT - Praslin airport/base/airport 1 to 4 pax			
Transfer (Payable now)	No	round trip	98,00 €
Season: 2026 Exotic. RT - Praslin airport/base/airport 5 to 8 pax			
Transfer (Payable now)	No	round trip	118,00 €
Season: 2026 Exotic. RT - Praslin airport/base/airport 9 to 12 pax			
Transfer (Payable now)	No	round trip	136,00 €
Season: 2026 Exotic. RT - Praslin airport/base/airport 13 to 16 pax			



WEBSITE

www.plujeme.cz



E-MAIL

info@plujeme.cz



PHONE

+420 720 755 085



MOBILE

+420 777 170 276



PLUJEME RÁDI S.R.O.

Dlouhá 730/35, 11000 Praha 1 – Staré Město, Czech Republic

ADDITIONAL EXTRAS

EXTRA	OBLIGATORY	PAYMENT TYPE	PRICE
Fishing equipment (Payable now) Season: 2026 Exotic. Additional deposit 100 EUR (subject to availability) - Payable now	No	per day	15,00 €
Kayak single (Payable now) Season: 2026 Exotic. price per day - Additional deposit 100 EUR - Payable now	No	per night	15,00 €
Kayak tandem (Payable now) Season: 2026 Exotic. price per day - Additional deposit 100 EUR - Payable now	No	per night	15,00 €
Railing net (Safety net) (Payable now) Season: 2026 Exotic. net is supplied but not installed - Payable now	No	per booking	220,00 €
Stand up paddle (SUP) (Payable now) Season: 2026 Exotic. Price per day - Additional deposit 100 EUR - Payable now	No	per night	15,00 €



WEBSITE

www.plujeme.cz



PHONE

+420 720 755 085



MOBILE

+420 777 170 276



E-MAIL

info@plujeme.cz



PLUJEME RÁDI S.R.O.

Dlouhá 730/35, 11000 Praha 1 – Staré Město, Czech Republic

PRICE AND AVAILABILITY

30.11. - 07.12.2024 2.960 €	07.12. - 14.12.2024 2.960 €	14.12. - 21.12.2024 NOT AVAILABLE	22.12. - 29.12.2024 NOT AVAILABLE
02.01. - 09.01.2025 NOT AVAILABLE	11.01. - 18.01.2025 3.015 €	18.01. - 25.01.2025 3.020 €	25.01. - 01.02.2025 3.020 €
01.02. - 08.02.2025 3.305 €	08.02. - 15.02.2025 3.305 €	15.02. - 22.02.2025 3.470 €	22.02. - 01.03.2025 3.470 €
01.03. - 08.03.2025 3.470 €	08.03. - 15.03.2025 3.470 €	15.03. - 22.03.2025 3.685 €	22.03. - 29.03.2025 3.685 €
29.03. - 05.04.2025 3.700 €	05.04. - 19.04.2025 NOT AVAILABLE	19.04. - 26.04.2025 3.740 €	26.04. - 03.05.2025 3.355 €
03.05. - 17.05.2025 NOT AVAILABLE	17.05. - 31.05.2025 NOT AVAILABLE	31.05. - 07.06.2025 3.092 € 3.255 €	07.06. - 14.06.2025 3.092 € 3.255 €
14.06. - 21.06.2025 3.092 € 3.255 €	21.06. - 28.06.2025 3.092 € 3.255 €	28.06. - 05.07.2025 3.140 € 3.305 €	



WEBSITE

www.plujeme.cz



E-MAIL

info@plujeme.cz



PHONE

+420 720 755 085



MOBILE

+420 777 170 276



PLUJEME RÁDI S.R.O.

Dlouhá 730/35, 11000 Praha 1 – Staré Město, Czech Republic

PRICE AND AVAILABILITY

05.07. - 12.07.2025 3.187 € 3.355 €	12.07. - 19.07.2025 3.187 € 3.355 €	19.07. - 26.07.2025 3.477 € 3.660 €	26.07. - 02.08.2025 NOT AVAILABLE
02.08. - 09.08.2025 3.762 € 3.960 €	09.08. - 16.08.2025 3.762 € 3.960 €	16.08. - 23.08.2025 3.320 € 3.495 €	23.08. - 30.08.2025 3.092 € 3.255 €
30.08. - 06.09.2025 3.092 € 3.255 €	06.09. - 13.09.2025 3.092 € 3.255 €	13.09. - 20.09.2025 3.092 € 3.255 €	20.09. - 27.09.2025 3.211 € 3.380 €
27.09. - 04.10.2025 3.313 € 3.487 €	04.10. - 11.10.2025 3.686 € 3.880 €	11.10. - 18.10.2025 3.886 € 4.090 €	18.10. - 25.10.2025 3.886 € 4.090 €
25.10. - 01.11.2025 3.890 € 4.095 €	01.11. - 08.11.2025 3.890 € 4.095 €	08.11. - 15.11.2025 3.890 € 4.095 €	15.11. - 22.11.2025 3.890 € 4.095 €
22.11. - 29.11.2025 3.501 € 3.685 €	29.11. - 06.12.2025 3.273 € 3.445 €	06.12. - 13.12.2025 3.273 € 3.445 €	13.12. - 20.12.2025 3.273 € 3.445 €
20.12. - 27.12.2025 5.049 € 5.315 €			



WEBSITE

www.plujeme.cz



E-MAIL

info@plujeme.cz



PHONE

+420 720 755 085



MOBILE

+420 777 170 276



PLUJEME RÁDI S.R.O.

Dlouhá 730/35, 11000 Praha 1 – Staré Město, Czech Republic