

# LAGOON 40

Nina (2020)

Catamaran Lagoon 40 Nina, built in 2020 is anchored in the Dubrovnik, Marina Frapa, Dubrovnik region, Croatia. It has 4 + 2 cabins, can accommodate 8 + 2 + 2 people and has 4 + 1 toilets. Bed linen and kitchen equipment are included in the price.

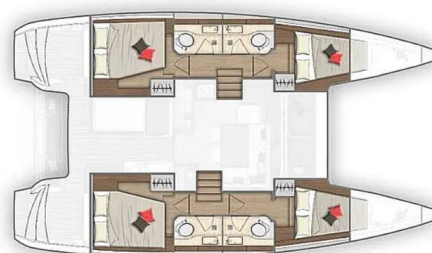

4 cabines 4 Salles de bain / 4 cabins 4 bathrooms

## YACHT SPECIFICATIONS

Yacht Base

**Dubrovnik, Marina Frapa, Croatia**

Yacht ID

**8398**

Brands

**Lagoon**

Yacht name

**Nina**

Production year

**2020**

Length

**39 ft**

Cabins

**4 + 2**

Berths

**8 + 2 + 2**

WC

**4 + 1**

Engine

**2 x 45 HP**

Fuel tank

**400 l**



**WEBSITE**

[www.plujeme.cz](http://www.plujeme.cz)



**PHONE**

+420 720 755 085



**MOBILE**

+420 777 170 276



**E-MAIL**

[info@plujeme.cz](mailto:info@plujeme.cz)



**PLUJEME RÁDI S.R.O.**

Dlouhá 730/35, 11000 Praha 1 – Staré Město, Czech Republic

## STANDARD YACHT EQUIPMENT

Deck	<b>Dinghy, Outboard engine</b>
Entertainment	<b>Outdoor speakers, TV</b>
Yacht electrics	<b>Air Conditioning, Generator</b>



**WEBSITE**

[www.plujeme.cz](http://www.plujeme.cz)



**E-MAIL**

[info@plujeme.cz](mailto:info@plujeme.cz)



**PHONE**

+420 720 755 085



**MOBILE**

+420 777 170 276



**PLUJEME RÁDI S.R.O.**

Dlouhá 730/35, 11000 Praha 1 – Staré Město, Czech Republic

## SERVICES

SELECTED SERVICES	OBLIGATORY	PAYMENT TYPE	PRICE
<b>Additional charge</b> (Payable at the base) <b>Season: 2025.</b> additional crew member	No	per day	<b>100,00 €</b>
<b>Captain</b> (Payable at the base) <b>Season: 2025.</b>	No	per day + food	<b>220,00 €</b>
<b>Crew change</b> (Payable at the base) <b>Season: 2025.</b>	No	per day	<b>200,00 €</b>
<b>Deposit insurance</b> (Payable at the base) <b>Season: 2025.</b> +400 EUR refundable	No	per booking	<b>300,00 €</b>
<b>Early boarding/check-in</b> (Payable at the base) <b>Season: 2025.</b> at 13h	No	per booking	<b>300,00 €</b>
<b>Hostess</b> (Payable at the base) <b>Season: 2025.</b>	No	per day + food	<b>220,00 €</b>
<b>Pet on board</b> (Payable at the base) <b>Season: 2025.</b>	No	per booking	<b>350,00 €</b>
<b>Provisioning</b> (Payable at the base) <b>Season: 2025.</b> +purchase price	No	per booking	<b>150,00 €</b>
<b>Transit log</b> (Payable at the base) <b>Season: 2025.</b>	No	per booking	<b>400,00 €</b>
<b>WI-FI Internet connection on boat</b> (Payable at the base) <b>Season: 2025.</b> in Croatia	No	per booking	<b>0,00 €</b>



**WEBSITE**  
www.plujeme.cz



**PHONE**  
+420 720 755 085



**MOBILE**  
+420 777 170 276



**E-MAIL**  
info@plujeme.cz



**PLUJEME RÁDI S.R.O.**  
Dlouhá 730/35, 11000 Praha 1 – Staré Město, Czech Republic

## ADDITIONAL EXTRAS

EXTRA	OBLIGATORY	PAYMENT TYPE	PRICE
<b>Cockpit grill</b> (Payable at the base) <b>Season: 2025.</b> Tefal OptiGril XXL - Payable at the base	No	per booking	<b>99,00 €</b>
<b>Extra bedlinen</b> (Payable at the base) <b>Season: 2025.</b> Payable at the base	No	per booking	<b>100,00 €</b>
<b>Extra towel - large</b> (Payable at the base) <b>Season: 2025.</b> Payable at the base	No	per piece	<b>20,00 €</b>
<b>Railing net (Safety net)</b> (Payable at the base) <b>Season: 2025.</b> Payable at the base	No	per booking	<b>250,00 €</b>
<b>Snorkeling equipment</b> (Payable at the base) <b>Season: 2025.</b> Payable at the base	No	per booking	<b>100,00 €</b>
<b>Toaster</b> (Payable at the base) <b>Season: 2025.</b> Payable at the base	No	per booking	<b>20,00 €</b>



**WEBSITE**

[www.plujeme.cz](http://www.plujeme.cz)



**E-MAIL**

[info@plujeme.cz](mailto:info@plujeme.cz)



**PHONE**

+420 720 755 085



**MOBILE**

+420 777 170 276



**PLUJEME RÁDI S.R.O.**

Dlouhá 730/35, 11000 Praha 1 – Staré Město, Czech Republic

## PRICE AND AVAILABILITY

23.11. - 30.11.2024 6.715 € 7.900 €	30.11. - 07.12.2024 6.715 € 7.900 €	07.12. - 14.12.2024 6.715 € 7.900 €	14.12. - 21.12.2024 6.715 € 7.900 €
21.12. - 28.12.2024 6.715 € 7.900 €	04.01. - 11.01.2025 8.415 € 9.900 €	11.01. - 18.01.2025 8.415 € 9.900 €	18.01. - 25.01.2025 8.415 € 9.900 €
25.01. - 01.02.2025 8.415 € 9.900 €	01.02. - 08.02.2025 6.715 € 7.900 €	08.02. - 15.02.2025 6.715 € 7.900 €	15.02. - 22.02.2025 6.715 € 7.900 €
22.02. - 01.03.2025 6.715 € 7.900 €	01.03. - 08.03.2025 3.060 € 3.600 €	08.03. - 15.03.2025 3.060 € 3.600 €	15.03. - 22.03.2025 3.060 € 3.600 €
22.03. - 29.03.2025 3.060 € 3.600 €	29.03. - 05.04.2025 3.060 € 3.600 €	05.04. - 12.04.2025 3.060 € 3.600 €	12.04. - 19.04.2025 3.060 € 3.600 €
19.04. - 26.04.2025 3.060 € 3.600 €	26.04. - 03.05.2025 3.060 € 3.600 €	03.05. - 10.05.2025 3.570 € 4.200 €	10.05. - 17.05.2025 3.570 € 4.200 €
17.05. - 24.05.2025 3.570 € 4.200 €	24.05. - 31.05.2025 3.570 € 4.200 €	31.05. - 07.06.2025 3.570 € 4.200 €	07.06. - 14.06.2025 5.525 € 6.500 €
14.06. - 21.06.2025 5.525 € 6.500 €	21.06. - 28.06.2025 5.525 € 6.500 €	28.06. - 05.07.2025 7.990 € 9.400 €	



WEBSITE

[www.plujeme.cz](http://www.plujeme.cz)



E-MAIL

[info@plujeme.cz](mailto:info@plujeme.cz)



PHONE

+420 720 755 085



MOBILE

+420 777 170 276



PLUJEME RÁDI S.R.O.

Dlouhá 730/35, 11000 Praha 1 – Staré Město, Czech Republic

## PRICE AND AVAILABILITY

05.07. - 12.07.2025 <b>7.990 €</b> 9.400 €	12.07. - 19.07.2025 <b>7.990 €</b> 9.400 €	19.07. - 26.07.2025 <b>7.990 €</b> 9.400 €	26.07. - 02.08.2025 <b>7.990 €</b> 9.400 €
02.08. - 09.08.2025 <b>7.990 €</b> 9.400 €	09.08. - 16.08.2025 <b>7.990 €</b> 9.400 €	16.08. - 23.08.2025 <b>7.990 €</b> 9.400 €	23.08. - 30.08.2025 <b>7.990 €</b> 9.400 €
30.08. - 06.09.2025 <b>5.525 €</b> 6.500 €	06.09. - 13.09.2025 <b>5.525 €</b> 6.500 €	13.09. - 20.09.2025 <b>5.525 €</b> 6.500 €	20.09. - 27.09.2025 <b>5.525 €</b> 6.500 €
27.09. - 04.10.2025 <b>5.525 €</b> 6.500 €	05.10. - 31.12.2025 NOT AVAILABLE		



### WEBSITE

[www.plujeme.cz](http://www.plujeme.cz)



### E-MAIL

[info@plujeme.cz](mailto:info@plujeme.cz)



### PHONE

+420 720 755 085



### MOBILE

+420 777 170 276



### PLUJEME RÁDI S.R.O.

Dlouhá 730/35, 11000 Praha 1 – Staré Město, Czech Republic