

# BALI 5.4

Maravela (2025)

Catamaran Bali 5.4 Maravela, built in 2025 is anchored in the BVI, Tortola, Nanny Cay Marina, British Virgin Islands, British Virgin Islands. It has 6 + 2 cabins, can accommodate 12 + 2 people and has 6 toilets. Bed linen and kitchen equipment are included in the price.

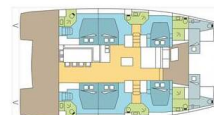

## YACHT SPECIFICATIONS

Yacht Base

**BVI, Tortola, Nanny Cay Marina,  
British Virgin Islands**

Yacht ID

**8329**

Brands

**Catana**

Yacht name

**Maravela**

Production year

**2025**

Length

**55 ft**

Cabins

**6 + 2**

Berths

**12 + 2**

Max Persons

**12**

WC

**6**

Engine

**2 x 80 HP**

Fuel tank

**1200 l**



**WEBSITE**

[www.plujeme.cz](http://www.plujeme.cz)



**PHONE**

+420 720 755 085



**MOBILE**

+420 777 170 276



**E-MAIL**

[info@plujeme.cz](mailto:info@plujeme.cz)



**PLUJEME RÁDI S.R.O.**

Dlouhá 730/35, 11000 Praha 1 – Staré Město, Czech Republic

## STANDARD YACHT EQUIPMENT

Comfort	<b>Beach towel, Cockpit cushions, Pillows, Premier pack, Sheets, Shower towels, Sundeck cushions, Towels</b>
Deck	<b>Black ball, Black conus, Boat hook, Chain counter on helm station, Cockpit table, Cockpit/stern, outside shower, Deck brush, Dinghy with outboard engine, Fenders, Floating rope, Grill/Barbecue/Plancha, Hard Top Bimini, Hydraulic lifting swimming platform, Jerry cans for fuel, Swimming ladder, Teak deck, Water hose</b>
Entertainment	<b>LED submarine lights, Radio, Snorkeling equipment, Stand up paddle (SUP) - FREE, TV, Underwater lights</b>
Galley	<b>Blender, Coffee machine, Dishwasher, Kitchen utensils (Galley equipment, cutlery), Microwave, Mug, Oven, Refrigerator, Toaster, Wine cooler</b>
Interior	<b>Electric fans in cabins, Electric toilet, Indirect lighting in cabins and cockpit</b>
Navigation	<b>AIS, Autopilot, Binoculars, Bow thruster, Compass, GPS chart plotter, Parallel ruler, Radar, Radar reflector, Windex</b>
Safety	<b>Buoyant smoke signal, Extra fuel tank, Extra water tank, Fire extinguisher , First aid kit , Flashlight, Fog horn, Horseshoe lifebuoy, Life jacket (children), Life jackets, Liferaft , Set of tools , Signaling mirror, Smoke detector, Torch, VHF radio</b>
Sails	<b>Aluminium canoe boom, Dacron square top main sail, Electric winch, Lazy bag, Lazy jacks, Sails</b>
Yacht electrics	<b>Air Conditioning, Battery charger , Generator, Inverter, Service batteries, Solar panels, Watermaker - desalinator</b>



**WEBSITE**  
[www.plujeme.cz](http://www.plujeme.cz)



**PHONE**  
+420 720 755 085



**MOBILE**  
+420 777 170 276



**E-MAIL**  
[info@plujeme.cz](mailto:info@plujeme.cz)



**PLUJEME RÁDI S.R.O.**  
Dlouhá 730/35, 11000 Praha 1 – Staré Město, Czech Republic

## SERVICES

SELECTED SERVICES	OBLIGATORY	PAYMENT TYPE	PRICE
<b>Cruising tax</b> (Payable now) <b>Season: 2025.</b> BVI: Cruising tax payable in advance: 4 USD per person / day (Price will be adjusted when the option is confirmed)	Yes	per guest/day	<b>3,48 €</b>
<b>Navigare Carefree</b> (Payable now) <b>Season: 2025.</b> *** To be added upon client's price - OBLIGATORY - CAT from 46 ft - BVI - Includes damage waiver insurance/full coverage* - NEW!, welcome package, final cleaning, bed sheets & towels, dinghy, outboard engine & fuel, propane gas, full water tanks, snorkelling equipment, National parks permits and VISAR . Beach towels are provided 1 per person for the charter. Yacht Fuel is not included - the fuel tank will be full when your charter starts and you are responsible for topping off the fuel tank at the end of your charter. ***** CRUISING TAX is NOT INCLUDED.	Yes	per booking	<b>840,00 €</b>
<b>APA (Advance Provisioning Allowance)</b> (Payable now) <b>Season: 2025.</b> The APA amount is used to cover all expenses during the course of the charter such as fuel, food, beverages, mooring fee and other expenses not included in the Charter Fee. The captain of the yacht is responsible for accounting for all APA expenses during the charter, and the breakdown will be presented to the client at the end of the charter. (AVAILABLE ONLY WHEN BOOKED WITH NAVIGARE SKIPPER AND HOSTESS OR COOK)	No	per week	<b>4.000,00 €</b>
<b>Checkout Skipper</b> (Payable now) <b>Season: 2025.</b> A check-out skipper (COS) is a professional captain that boards with you on Day 1, and is dropped off late afternoon the same day. A COS may be requested by you or may be required by Navigare after review of your sailing resume.	No	per booking	<b>370,00 €</b>
<b>Cook</b> (Payable now) <b>Season: 2025.</b> Cook requires standard cabin with access to a toilet and shower + food. A gratuity of 15-20% of the crew fee is customary for excellent service. Cooking breakfast, lunch, dinners, and supplies, keeping the kitchen clean (not the rest of the boat, not the cabins). ***NOTE: Cook details will be available 3 days before the charter.	No	per day + food	<b>240,00 €</b>
<b>Extra cleaning</b> (Payable now) <b>Season: 2025.</b> Cleaning and new bed linen and towels	No	per booking	<b>350,00 €</b>

<b>Sailing Instructor</b> (Payable at the base) <b>Season: 2025.</b> Sailing instructor BVI	No	per day + food	<b>350,00 €</b>
<b>Skipper</b> (Payable now) <b>Season: 2025.</b> Skipper requires standard cabin with access to a toilet and shower + food (not peak skipper cabin). A gratuity of 15-20% of the crew fee is customary for excellent service ***NOTE: Skipper details will be available 3 days before the charter.	No	per day + food	<b>295,00 €</b>
<b>Skipper</b> (Payable now) <b>Season: 2025.</b> Skipper using crew-cabin (peak cabin) with access to a toilet and shower*** Gratuity A gratuity of 15-20% of the crew fee is customary for excellent service ***NOTE: Skipper details will be available 3 days before the charter	No	per day + food	<b>345,00 €</b>
<b>Sleep over before check in</b> (Payable now) <b>Season: 2025.</b> Sleep over on a day before the check-in: Sleep over from 5PM on a day before the check-in date and time stated in the contract: 65% of the daily rate. (Price will be adjusted when the option is confirmed)	No	per booking	<b>1.000,00 €</b>
<b>WIFI package</b> (Payable now) <b>Season: 2025.</b> Unlimited Wifi / BVI / BAH / CAR	No	per booking	<b>130,44 €</b>



**WEBSITE**

[www.plujeme.cz](http://www.plujeme.cz)



**PHONE**

+420 720 755 085



**MOBILE**

+420 777 170 276



**E-MAIL**

[info@plujeme.cz](mailto:info@plujeme.cz)



**PLUJEME RÁDI S.R.O.**

Dlouhá 730/35, 11000 Praha 1 – Staré Město, Czech Republic

## ADDITIONAL EXTRAS

EXTRA	OBLIGATORY	PAYMENT TYPE	PRICE
<b>Railing net (Safety net)</b> (Payable now) <i>Season: 2025. mounting not included - Payable now</i>	No	per booking	<b>155,00 €</b>
<b>Stand up paddle (SUP)</b> (Payable now) <i>Season: 2025. Payable now</i>	No	per day	<b>20,00 €</b>

**WEBSITE**

[www.plujeme.cz](http://www.plujeme.cz)

**E-MAIL**

[info@plujeme.cz](mailto:info@plujeme.cz)

**PHONE**

+420 720 755 085

**MOBILE**

+420 777 170 276

**PLUJEME RÁDI S.R.O.**

Dlouhá 730/35, 11000 Praha 1 – Staré Město, Czech Republic

## PRICE AND AVAILABILITY

<b>13.12. - 12.01.2025</b> NOT AVAILABLE	<b>13.01. - 15.01.2025</b> NOT AVAILABLE	<b>18.01. - 25.01.2025</b> ON OPTION	<b>25.01. - 01.02.2025</b> ON OPTION
<b>06.02. - 12.02.2025</b> NOT AVAILABLE	<b>16.02. - 28.02.2025</b> NOT AVAILABLE	<b>05.03. - 14.03.2025</b> NOT AVAILABLE	<b>15.03. - 22.03.2025</b> NOT AVAILABLE
<b>22.03. - 29.03.2025</b> <b>19.168 €</b> 23.960 €	<b>01.04. - 09.04.2025</b> NOT AVAILABLE	<b>12.04. - 20.04.2025</b> NOT AVAILABLE	<b>23.04. - 22.05.2025</b> NOT AVAILABLE
<b>24.05. - 01.06.2025</b> NOT AVAILABLE	<b>01.06. - 09.06.2025</b> NOT AVAILABLE	<b>10.06. - 21.06.2025</b> NOT AVAILABLE	<b>23.06. - 01.07.2025</b> NOT AVAILABLE



### WEBSITE

[www.plujeme.cz](http://www.plujeme.cz)



### E-MAIL

[info@plujeme.cz](mailto:info@plujeme.cz)



### PHONE

+420 720 755 085



### MOBILE

+420 777 170 276



### PLUJEME RÁDI S.R.O.

Dlouhá 730/35, 11000 Praha 1 – Staré Město, Czech Republic

## PRICE AND AVAILABILITY

03.07. - 07.07.2025 NOT AVAILABLE	08.07. - 20.07.2025 NOT AVAILABLE	22.07. - 30.07.2025 NOT AVAILABLE	04.08. - 10.10.2025 NOT AVAILABLE
11.10. - 18.10.2025 <b>11.733 €</b> 12.350 €	18.10. - 25.10.2025 <b>13.034 €</b> 13.720 €	25.10. - 01.11.2025 <b>13.034 €</b> 13.720 €	03.11. - 09.11.2025 NOT AVAILABLE
09.11. - 17.11.2025 NOT AVAILABLE	22.11. - 29.11.2025 <b>19.447 €</b> 20.470 €	29.11. - 06.12.2025 <b>15.913 €</b> 16.750 €	06.12. - 13.12.2025 <b>15.029 €</b> 15.820 €
13.12. - 20.12.2025 <b>15.029 €</b> 15.820 €	20.12. - 27.12.2025 <b>20.600 €</b>		



### WEBSITE

[www.plujeme.cz](http://www.plujeme.cz)



### E-MAIL

[info@plujeme.cz](mailto:info@plujeme.cz)



### PHONE

+420 720 755 085



### MOBILE

+420 777 170 276



### PLUJEME RÁDI S.R.O.

Dlouhá 730/35, 11000 Praha 1 – Staré Město, Czech Republic