

AZIMUT 78

OMR Group (2021)

Motor yacht Azimut 78 OMR Group, built in 2021 is anchored in the Marina Lav - Podstrana, Split region, Croatia. It has 4 cabins, can accommodate 8 people and has 4 toilets. Bed linen and kitchen equipment are included in the price.

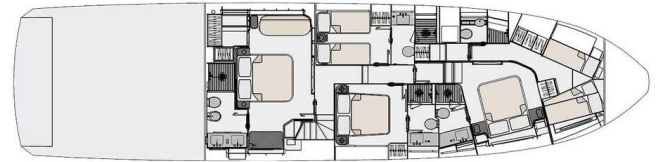

YACHT SPECIFICATIONS

Yacht Base

Marina Lav - Podstrana, Croatia

Yacht ID

8118

Brands

Azimut / Benetti Yachts

Yacht name

OMR Group

Production year

2021

Length

78 ft

Cabins

4

Berths

8

Max Persons

8

WC

4

Engine

3 x 1000 HP

Fuel tank

5000 l



WEBSITE

www.plujeme.cz



PHONE

+420 720 755 085



MOBILE

+420 777 170 276



E-MAIL

info@plujeme.cz



PLUJEME RÁDI S.R.O.

Dlouhá 730/35, 11000 Praha 1 - Staré Město, Czech Republic

STANDARD YACHT EQUIPMENT

| | |
|-----------------|---|
| Comfort | Deck cushions, Outside cushions, Sundeck beds, Sundeck cushions |
| Deck | Bar, Bow sunbathing area, Flybridge, Forward lounge area, Grill/Barbecue/Plancha, Hydraulic lifting swimming platform, Sun deck, Teak deck, Tender |
| Entertainment | Donut, Jet Ski SEA-D00 Spark, Seabob, Snorkeling equipment, Stand up paddle (SUP), Wakeboard, Water skis |
| Galley | Ice maker |
| Interior | Ambiental lighting |
| Navigation | Stabilizers |
| Yacht electrics | Air Conditioning, Generator |



WEBSITE

www.plujeme.cz



E-MAIL

info@plujeme.cz



PHONE

+420 720 755 085



MOBILE

+420 777 170 276



PLUJEME RÁDI S.R.O.

Dlouhá 730/35, 11000 Praha 1 – Staré Město, Czech Republic

SERVICES

| SELECTED SERVICES | OBLIGATORY | PAYMENT TYPE | PRICE |
|---|------------|----------------|-----------------|
| APA (Advance Provisioning Allowance) <i>(Payable at the base)</i> Season: 2025. 30% from the yacht price | Yes | per booking | 0,00 € |
| Crew <i>(Payable at the base)</i> Season: 2025. Crew of 3 included in price | Yes | per booking | 0,00 € |
| Cook <i>(Payable at the base)</i> Season: 2025. | No | per day + food | 350,00 € |



WEBSITE

www.plujeme.cz



E-MAIL

info@plujeme.cz



PHONE

+420 720 755 085



MOBILE

+420 777 170 276



PLUJEME RÁDI S.R.O.

Dlouhá 730/35, 11000 Praha 1 – Staré Město, Czech Republic

ADDITIONAL EXTRAS

| EXTRA | OBLIGATORY | PAYMENT TYPE | PRICE |
|--|------------|--------------|-------------------|
| Bike (Payable at the base) Season: 2025. kids - Payable at the base | No | per week | 150,00 € |
| Bike (Payable at the base) Season: 2025. foldable - Payable at the base | No | per week | 200,00 € |
| Bike (Payable at the base) Season: 2025. mountain bike - Payable at the base | No | per week | 250,00 € |
| eFoil (Payable at the base) Season: 2025. + 2000 EUR security deposit - Payable at the base | No | per week | 1.500,00 € |
| Fishing cane/rod (Payable at the base) Season: 2025. Payable at the base | No | per week | 20,00 € |
| Hoverboard (Payable at the base) Season: 2025. Payable at the base | No | per week | 150,00 € |
| Jet Ski (Payable at the base) Season: 2025. Spark 60HP (2 seats) +1000 EUR security deposit - Payable at the base | No | per week | 1.200,00 € |
| Kayak (Payable at the base) Season: 2025. 3 seats, with paddles - Payable at the base | No | per week | 200,00 € |
| Kneeboard (Payable at the base) Season: 2025. Payable at the base | No | per week | 200,00 € |
| Playstation 4 (Payable at the base) Season: 2025. Payable at the base | No | per week | 100,00 € |
| Scooter (Payable at the base) Season: 2025. electric (foldable)- Payable at the base | No | per week | 200,00 € |
| Water skis for children (Payable at the base) Season: 2025. with rope - Payable at the base | No | per week | 100,00 € |
| Windsurf (Payable at the base) Season: 2025. Beginner - Payable at the base | No | per week | 300,00 € |

Windsurf (Payable at the base)

No

per week

400,00 €

Season: 2025. Professional - Payable at the base



WEBSITE

www.plujeme.cz



E-MAIL

info@plujeme.cz



PHONE

+420 720 755 085



MOBILE

+420 777 170 276



PLUJEME RÁDI S.R.O.

Dlouhá 730/35, 11000 Praha 1 – Staré Město, Czech Republic

PRICE AND AVAILABILITY

| | | | |
|--|--|--|--|
| 23.11. - 30.11.2024 49.327 € 51.924 € | 30.11. - 07.12.2024 49.327 € 51.924 € | 07.12. - 14.12.2024 49.327 € 51.924 € | 14.12. - 21.12.2024 49.327 € 51.924 € |
| 21.12. - 28.12.2024 49.327 € 51.924 € | 04.01. - 11.01.2025 49.327 € 51.924 € | 11.01. - 18.01.2025 49.327 € 51.924 € | 18.01. - 25.01.2025 49.327 € 51.924 € |
| 25.01. - 01.02.2025 49.327 € 51.924 € | 01.02. - 08.02.2025 49.327 € 51.924 € | 08.02. - 15.02.2025 49.327 € 51.924 € | 15.02. - 22.02.2025 49.327 € 51.924 € |
| 22.02. - 01.03.2025 49.327 € 51.924 € | 01.03. - 08.03.2025 49.327 € 51.924 € | 08.03. - 15.03.2025 49.327 € 51.924 € | 15.03. - 22.03.2025 49.327 € 51.924 € |
| 22.03. - 29.03.2025 49.327 € 51.924 € | 29.03. - 05.04.2025 49.327 € 51.924 € | 05.04. - 12.04.2025 49.327 € 51.924 € | 12.04. - 19.04.2025 49.327 € 51.924 € |
| 19.04. - 26.04.2025 49.327 € 51.924 € | 26.04. - 03.05.2025 49.327 € 51.924 € | 03.05. - 10.05.2025 49.327 € 51.924 € | 10.05. - 17.05.2025 49.327 € 51.924 € |
| 17.05. - 24.05.2025 49.327 € 51.924 € | 29.05. - 02.06.2025 NOT AVAILABLE | 07.06. - 14.06.2025 52.172 € 54.918 € | 14.06. - 21.06.2025 52.172 € 54.918 € |
| 21.06. - 28.06.2025 52.172 € 54.918 € | 28.06. - 05.07.2025 56.896 € 59.890 € | | |



WEBSITE
www.plujeme.cz



E-MAIL
info@plujeme.cz



PHONE
+420 720 755 085



MOBILE
+420 777 170 276



PLUJEME RÁDI S.R.O.
Dlouhá 730/35, 11000 Praha 1 – Staré Město, Czech Republic

PRICE AND AVAILABILITY

| | | | |
|---|---|---|---|
| 05.07. - 12.07.2025 56.896 € 59.890 € | 12.07. - 19.07.2025 56.896 € 59.890 € | 19.07. - 26.07.2025 56.896 € 59.890 € | 26.07. - 02.08.2025 56.896 € 59.890 € |
| 02.08. - 09.08.2025 56.896 € 59.890 € | 09.08. - 16.08.2025 56.896 € 59.890 € | 16.08. - 23.08.2025 56.896 € 59.890 € | 23.08. - 30.08.2025 56.896 € 59.890 € |
| 30.08. - 06.09.2025 52.172 € 54.918 € | 06.09. - 13.09.2025 52.172 € 54.918 € | 13.09. - 20.09.2025 52.172 € 54.918 € | 20.09. - 27.09.2025 52.172 € 54.918 € |
| 27.09. - 04.10.2025 49.327 € 51.924 € | 04.10. - 11.10.2025 49.327 € 51.924 € | 11.10. - 18.10.2025 49.327 € 51.924 € | 18.10. - 25.10.2025 49.327 € 51.924 € |
| 25.10. - 01.11.2025 49.327 € 51.924 € | 01.11. - 08.11.2025 49.327 € 51.924 € | 08.11. - 15.11.2025 49.327 € 51.924 € | 15.11. - 22.11.2025 49.327 € 51.924 € |
| 22.11. - 29.11.2025 49.327 € 51.924 € | 29.11. - 06.12.2025 49.327 € 51.924 € | 06.12. - 13.12.2025 49.327 € 51.924 € | 13.12. - 20.12.2025 49.327 € 51.924 € |
| 20.12. - 27.12.2025 49.327 € 51.924 € | | | |



WEBSITE

www.plujeme.cz



E-MAIL

info@plujeme.cz



PHONE

+420 720 755 085



MOBILE

+420 777 170 276



PLUJEME RÁDI S.R.O.

Dlouhá 730/35, 11000 Praha 1 – Staré Město, Czech Republic