

# BALI 4.6

TAMARA GRACE (2022)

Catamaran Bali 4.6 TAMARA GRACE, built in 2022 is anchored in the **Antigua, Jolly Harbour Marina, Antigua, Caribbean**. It has **5 + 2 cabins**, can accommodate **10 + 2 people** and has **4 toilets**. Bed linen and kitchen equipment are included in the price.

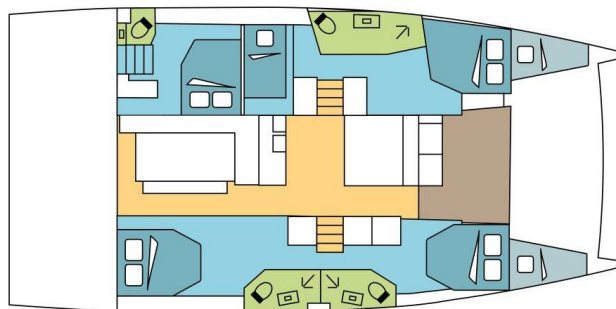

## YACHT SPECIFICATIONS

Yacht Base

**Antigua, Jolly Harbour Marina,  
Caribbean**

Yacht ID

**7964**

Brands

**Catana**

Yacht name

**TAMARA GRACE**

Production year

**2022**

Length

**47 ft**

Cabins

**5 + 2**

Berths

**10 + 2**

Max Persons

**12**

WC

**4**

Engine

**2 x 57 HP**

Fuel tank

**800 l**



**WEBSITE**

[www.plujeme.cz](http://www.plujeme.cz)



**PHONE**

+420 720 755 085



**MOBILE**

+420 777 170 276



**E-MAIL**

[info@plujeme.cz](mailto:info@plujeme.cz)



**PLUJEME RÁDI S.R.O.**

Dlouhá 730/35, 11000 Praha 1 – Staré Město, Czech Republic

## STANDARD YACHT EQUIPMENT

Comfort	<b>Deck cushions, Forward cockpit cushions, Helmstation seat cushions, Mosquito nets, Pillows</b>
Deck	<b>Anchor chain counter, Bar, Bimini top, Chairs, Cockpit table, Dinghy, Electric anchor windlass, Flybridge, Forward cockpit, Outboard engine, Seats for aft bench, Spring cleats, Sun awning (forward cockpit)</b>
Entertainment	<b>LCD TV, Sound System</b>
Galley	<b>Coffee machine, Dishwasher, Microwave, Oven</b>
Interior	<b>Curtains, Electric fans in cabins, Electric toilet, Indirect lighting in cabins and cockpit, LED lights, Upholstery</b>
Navigation	<b>3 blade folding propeller, AIS, Autopilot, GPS chart plotter, Radar</b>
Safety	<b>VHF radio</b>
Sails	<b>Electric main sail winch, Electric winch, Lazy bag, Lazy jacks</b>
Yacht electrics	<b>Air Conditioning, Battery charger , Generator, Inverter, Service batteries, Solar panels, Watermaker - desalinator</b>



#### WEBSITE

[www.plujeme.cz](http://www.plujeme.cz)



#### E-MAIL

[info@plujeme.cz](mailto:info@plujeme.cz)



#### PHONE

+420 720 755 085



#### MOBILE

+420 777 170 276



#### PLUJEME RÁDI S.R.O.

Dlouhá 730/35, 11000 Praha 1 – Staré Město, Czech Republic

## SERVICES

SELECTED SERVICES	OBLIGATORY	PAYMENT TYPE	PRICE
<b>Essentials pack</b> (Payable now) <b>Season: 2026 Exotic.</b> INCLUDED: full reduction of security deposit (0 € at base)// starter pack – (1 gallon water or 4 bottles of 1.5L, 1 bottle of disinfectant, 1 small bottle of washing up liquid, 1 dish cloth, 1 sponge, garbage bags, 1 roll of paper towels, 1 box of matches, 1 roll of toilet paper in each head)// final cleaning // 1 set of bed sheets & towels, dinghy, outboard engine & initial supply of fuel, gas and water tanks// DYC assistance guarantee // 1st & last night in the marina /// NOT INCLUDED: refuelling, gas & water consumption at end of charter, taxes if any, handling fees, additional equipment deposit	Yes	per booking	<b>815,00 €</b>
<b>Handling fees</b> (Payable now) <b>Season: 2026 Exotic.</b>	Yes	per booking	<b>35,00 €</b>
<b>Crew change</b> (Payable now) <b>Season: 2026 Exotic.</b> Any crew change during the charter is subject to € 200.- additional cost. The charge includes administration cost, change of bed linen and towels and one night at DYC ponton (marina fee included only if the same base than start base). It doesn't include cleaning, nor new transit log where applicable.	No	per booking	<b>200,00 €</b>
<b>Early boarding/check-in</b> (Payable now) <b>Season: 2026 Exotic.</b> EB (boat only) - 14:00 h / 2 PM starting time of boat's delivery // limited number of early boardings on same departure day	No	per booking	<b>480,00 €</b>
<b>Early boarding/check-in</b> (Payable now) <b>Season: 2026 Exotic.</b> EB boat + extra fee skipper - 14:00 h / 2 PM starting time of boat's delivery // limited number of early boardings on same departure day	No	per booking	<b>720,00 €</b>
<b>Early boarding/check-in</b> (Payable now) <b>Season: 2026 Exotic.</b> EB + extra fee Skipper & Hostes - 14:00 h / 2 PM starting time of boat's delivery // limited number of early boardings on same departure day	No	per booking	<b>910,00 €</b>
<b>Electric &amp; Water consumption in the Marinas</b> (Payable at the base) <b>Season: 2026 Exotic.</b> Electric & Water consumption based on 2 nights on our dock (base will confirm the amount to pay locally depending on nights spent on dock)	No	per booking	<b>36,00 €</b>

<b>Extra set of linen (choose how many)</b> (Payable now)	No	per booking	<b>15,00 €</b>
<b>Season: 2026 Exotic.</b> Extra set of linen : 15 € 1 set of linen (2 sheets & 2 pillow case) - to be updated manually			
<b>Extra set of towels (choose how many)</b> (Payable now)	No	per booking	<b>10,00 €</b>
<b>Season: 2026 Exotic.</b> Extra set of towels: 10 € 1 set of towels (1 face & 1 bath towel) - to be updated manually			
<b>Final cleaning</b> (Payable now)	No	per booking	<b>340,00 €</b>
<b>Season: 2026 Exotic.</b> included in Essentials pack			
<b>Full board 1-4 pax (number of guests to update manually)</b> (Payable now)	No	per guest/day	<b>65,00 €</b>
<b>Season: 2026 Exotic.</b> only available if cook is booked on board as the cook will do the provisioning based on client's preference. Includes breakfast, lunch & dinner + the crew's food. Does not included alcoholic drinks			
<b>Full board 5-12 pax (number of guests to update manually)</b> (Payable now)	No	per guest/day	<b>60,00 €</b>
<b>Season: 2026 Exotic.</b> only available if cook is booked on board as the cook will do the provisioning based on client's preference. Includes breakfast, lunch & dinner + the crew's food. Does not included alcoholic drinks			
<b>Half board 1-4 pax (number of guests to update manually)</b> (Payable now)	No	per guest/day	<b>55,00 €</b>
<b>Season: 2026 Exotic.</b> only available if cook is booked on board as the cook will do the provisioning based on client's preference. Includes breakfast & lunch OR dinner + the crew's food. Does not included alcoholic drinks			
<b>Half board 5-12 pax (number of guests to update manually)</b> (Payable now)	No	per guest/day	<b>50,00 €</b>
<b>Season: 2026 Exotic.</b> only available if cook is booked on board as the cook will do the provisioning based on client's preference. Includes breakfast & lunch OR dinner + the crew's food. Does not included alcoholic drinks			
<b>Hostess</b> (Payable now)	No	per night	<b>190,00 €</b>
<b>Season: 2026 Exotic.</b> + provisioning, a cabin or forepeak to sleep and access to a WC/Shower			
<b>Race pack</b> (Payable now)	No	per booking	<b>1.320,00 €</b>
<b>Season: 2026 Exotic.</b> BVI Spring Regatta, Briefing before the race, preparation and gauging of sails, registration of the yacht (not of the passengers), technical assistance during the race *** technical assistance during the race not valid for RORC Caribbean 600 // A special race deposit need to be doubled manually once the race fee is added.			

<b>Race pack</b> (Payable now)	No	per booking	<b>1.650,00 €</b>
<b>Season: 2026 Exotic.</b> Antigua, Briefing before the race, preparation and gauging of sails, registration of the yacht (not of the passengers), technical assistance during the race *** technical assistance during the race not valid for RORC Caribbean 600 // A special race deposit need to be doubled manually once the race fee is added.			
<b>Race pack</b> (Payable now)	No	per booking	<b>1.650,00 €</b>
<b>Season: 2026 Exotic.</b> RORC caribbean 600, Briefing before the race, preparation and gauging of sails, registration of the yacht (not of the passengers), technical assistance during the race *** technical assistance during the race not valid for RORC Caribbean 600 // A special race deposit need to be doubled manually once the race fee is added.			
<b>Regatta surcharge</b> (Payable now)	No	per booking	<b>2.150,00 €</b>
<b>Season: 2026 Exotic.</b> valid for ASW regatta only // A special race deposit need to be doubled manually once the regatta surcharge is added.			
<b>Regatta surcharge</b> (Payable now)	No	per booking	<b>0,00 €</b>
<b>Season: 2026 Exotic.</b> all the regattas apart of ASW (different regatta surcharge for ASW) // A special race deposit need to be doubled manually once the regatta surcharge is added.			
<b>Same day briefing</b> (Payable now)	No	per booking	<b>150,00 €</b>
<b>Season: 2026 Exotic.</b> Same day briefing starting between 5 & 5.30pm (departure following morning)			
<b>Skipper</b> (Payable now)	No	per night	<b>240,00 €</b>
<b>Season: 2026 Exotic.</b> + provisioning, a cabin or forepeak to sleep and access to a WC/Shower			
<b>Starter pack</b> (Payable now)	No	per booking	<b>50,00 €</b>
<b>Season: 2026 Exotic.</b> included in Essentials pack (The pack includes: 1 gallon water (or 4 bottles of 1.5L), 1 bottle of disinfectant, 1 small bottle of washing up liquid, 1 dish cloth, 1 sponge, garbage bags, 1 roll of paper towels, 1 box of matches, 1 roll of toilet paper in each head)			
<b>Transfer</b> (Payable now)	No	one-way	<b>20,00 €</b>
<b>Season: 2026 Exotic.</b> OW - Antigua Airport - Base - additional pax			
<b>Transfer</b> (Payable now)	No	round trip	<b>40,00 €</b>
<b>Season: 2026 Exotic.</b> RT - Antigua Airport/ Base/Airport - additional pax			
<b>Transfer</b> (Payable now)	No	one-way	<b>51,00 €</b>
<b>Season: 2026 Exotic.</b> OW - Antigua Airport/Base 1-2 pax			

**Transfer** (Payable now)

No

round trip

**102,00 €**

**Season: 2026 Exotic.** RT - Antigua airport/base/airport - 1-2 pax

---

**WI-FI Internet connection on boat** (Payable now)

No

per week

**130,00 €**

**Season: 2026 Exotic.**



**WEBSITE**

[www.plujeme.cz](http://www.plujeme.cz)



**PHONE**

+420 720 755 085



**MOBILE**

+420 777 170 276



**E-MAIL**

[info@plujeme.cz](mailto:info@plujeme.cz)



**PLUJEME RÁDI S.R.O.**

Dlouhá 730/35, 11000 Praha 1 – Staré Město, Czech Republic

## ADDITIONAL EXTRAS

EXTRA	OBLIGATORY	PAYMENT TYPE	PRICE
<b>Fishing equipment</b> (Payable now) <b>Season: 2026 Exotic.</b> Additional deposit 100 EUR (subject to availability) - Payable now	No	per day	<b>15,00 €</b>
<b>Kayak single</b> (Payable now) <b>Season: 2026 Exotic.</b> price per day - Additional deposit 100 EUR - Payable now	No	per night	<b>15,00 €</b>
<b>Outboard engine 8 &amp; 9,8 HP</b> (Payable now) <b>Season: 2026 Exotic.</b> Dinghy not suitable in any case for waterski or wakeboard. Additional security deposit of 500 € - Payable now	No	per day	<b>35,00 €</b>
<b>Railing net (Safety net)</b> (Payable now) <b>Season: 2026 Exotic.</b> net is supplied but not installed - Payable now	No	per booking	<b>300,00 €</b>
<b>Stand up paddle (SUP)</b> (Payable now) <b>Season: 2026 Exotic.</b> Price per day - Additional deposit 100 EUR - Payable now	No	per night	<b>15,00 €</b>



**WEBSITE**  
www.plujeme.cz



**PHONE**  
+420 720 755 085



**MOBILE**  
+420 777 170 276



**E-MAIL**  
info@plujeme.cz



**PLUJEME RÁDI S.R.O.**  
Dlouhá 730/35, 11000 Praha 1 - Staré Město, Czech Republic

## PRICE AND AVAILABILITY

01.02. - 08.02.2025 <b>8.058 €</b> 9.480 €	08.02. - 15.02.2025 ON OPTION	15.02. - 22.02.2025 <b>8.645 €</b> 10.170 €	22.02. - 01.03.2025 <b>8.662 €</b> 10.190 €
01.03. - 08.03.2025 NOT AVAILABLE	08.03. - 15.03.2025 <b>9.490 €</b>	15.03. - 22.03.2025 <b>8.065 €</b>	22.03. - 29.03.2025 ON OPTION
29.03. - 05.04.2025 <b>9.990 €</b>	05.04. - 12.04.2025 <b>9.350 €</b>	12.04. - 19.04.2025 NOT AVAILABLE	19.04. - 26.04.2025 <b>9.385 €</b>
26.04. - 24.05.2025 NOT AVAILABLE	24.05. - 04.06.2025 NOT AVAILABLE	07.06. - 14.06.2025 <b>5.284 €</b> 6.165 €	14.06. - 21.06.2025 <b>5.284 €</b> 6.165 €
21.06. - 28.06.2025 <b>5.284 €</b> 6.165 €	28.06. - 05.07.2025 <b>5.284 €</b> 6.165 €	05.07. - 12.07.2025 <b>5.284 €</b> 6.165 €	12.07. - 19.07.2025 <b>5.229 €</b> 6.100 €
19.07. - 26.07.2025 <b>5.237 €</b> 6.110 €	26.07. - 02.08.2025 <b>4.813 €</b> 5.615 €		



WEBSITE

[www.plujeme.cz](http://www.plujeme.cz)



E-MAIL

[info@plujeme.cz](mailto:info@plujeme.cz)



PHONE

+420 720 755 085



MOBILE

+420 777 170 276



PLUJEME RÁDI S.R.O.

Dlouhá 730/35, 11000 Praha 1 – Staré Město, Czech Republic



## PRICE AND AVAILABILITY

02.08. - 09.08.2025 4.809 € 5.610 €	09.08. - 16.08.2025 4.813 € 5.615 €	16.08. - 23.08.2025 4.813 € 5.615 €	23.08. - 30.08.2025 4.813 € 5.615 €
30.08. - 06.09.2025 4.813 € 5.615 €	06.09. - 13.09.2025 4.813 € 5.615 €	13.09. - 20.09.2025 4.813 € 5.615 €	20.09. - 27.09.2025 4.813 € 5.615 €
27.09. - 04.10.2025 4.813 € 5.615 €	04.10. - 11.10.2025 4.813 € 5.615 €	11.10. - 18.10.2025 5.482 € 5.770 €	18.10. - 25.10.2025 5.695 € 5.995 €
25.10. - 01.11.2025 6.028 € 6.345 €	01.11. - 08.11.2025 6.655 € 7.005 €	08.11. - 15.11.2025 7.234 € 7.615 €	15.11. - 22.11.2025 7.234 € 7.615 €
22.11. - 29.11.2025 7.234 € 7.615 €	29.11. - 06.12.2025 7.006 € 7.375 €	06.12. - 13.12.2025 7.006 € 7.375 €	13.12. - 20.12.2025 7.006 € 7.375 €
20.12. - 27.12.2025 12.645 € 13.310 €			



WEBSITE

[www.plujeme.cz](http://www.plujeme.cz)



E-MAIL

[info@plujeme.cz](mailto:info@plujeme.cz)



PHONE

+420 720 755 085



MOBILE

+420 777 170 276



PLUJEME RÁDI S.R.O.

Dlouhá 730/35, 11000 Praha 1 – Staré Město, Czech Republic