

LAGOON 46

Maryna (2021)

Catamaran Lagoon 46 Maryna, built in 2021 is anchored in the Seychelles, Eden Island Marina, Mahé, Seychelles. It has 4 + 1 cabins, can accommodate 8 + 1 people and has 4 toilets. Bed linen and kitchen equipment are included in the price.

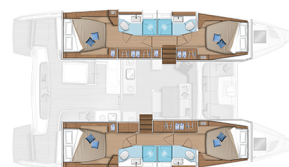

YACHT SPECIFICATIONS

Yacht Base

**Seychelles, Eden Island Marina,
Seychelles**

Yacht ID

7853

Brands

Lagoon

Yacht name

Maryna

Production year

2021

Length

46 ft

Cabins

4 + 1

Berths

8 + 1

Max Persons

9

WC

4

Engine

2 x 57 HP

Fuel tank

1040 l



WEBSITE

www.plujeme.cz



PHONE

+420 720 755 085



MOBILE

+420 777 170 276



E-MAIL

info@plujeme.cz



PLUJEME RÁDI S.R.O.

Dlouhá 730/35, 11000 Praha 1 – Staré Město, Czech Republic

STANDARD YACHT EQUIPMENT

| | |
|-----------------|---|
| Additional | Flag |
| Comfort | Cockpit cushions, Pillows |
| Deck | Anchor with chain, Bilge pump - Mechanic, Bimini top, Bosun's chair (Safe seat) (boatswain's chair), Cockpit fridge, Cockpit table, Cockpit/stern, outside shower, Deck brush, Deck lights, Dinghy with outboard engine, Electric anchor windlass, Fenders, Flybridge, Gangway, Jerry cans for fuel, LED outdoor ambiance lights, Mooring Cleats, Mooring ropes , Round/globular fender, Spare anchor (Reserve, Auxiliary anchor), Sponge, Spring cleats, Swimming ladder, Teak cockpit table with folding leaves, Water hose, Winch handles |
| Entertainment | Fusion radio |
| Galley | Blender, Freezer, Gas bottles, Gas cookers, Kitchen utensils (Galley equipment, cutlery), Oven, Refrigerator, Side galley, Water pump |
| Interior | Clothes hangers, Electric fans in cabins, Electric toilet, LED interior lights, Salon table, Toilet brush, Upholstery |
| Navigation | GPS chart plotter, Navigation (Nautical) charts and nautical guide , Navigation set, Parallel ruler, Radar reflector, Tridata |
| Safety | Black Water Tank, Distress flare box, Emergency tiller, Fire extinguisher , First aid kit , Flashlight, Fog horn, Horseshoe lifebuoy, Life belts (Safety harness), Life jacket (children), Life jackets, Liferaft , Rescue sling (Life sling), Set of tools , Signal flags, Spare parts, VHF radio , Wire (shroud) cutter |
| Yacht electrics | 220V socket, Air Conditioning, Battery charger , Bilge pump - Electric, DSC station, Fish finder, Generator, Inverter, Motor hours counter, Service batteries, Shore connection 220 V, Shore power cable, Start battery, USB sockets, Water heater, Watermaker - desalinator |



WEBSITE

www.plujeme.cz



PHONE

+420 720 755 085



MOBILE

+420 777 170 276



E-MAIL

info@plujeme.cz



PLUJEME RÁDI S.R.O.

Dlouhá 730/35, 11000 Praha 1 – Staré Město, Czech Republic

SERVICES

| SELECTED SERVICES | OBLIGATORY | PAYMENT TYPE | PRICE |
|--|------------|----------------|-----------------|
| Final cleaning (Payable at the base) <i>Season: 2025. if paid in the office, 15% charge added</i> | Yes | per booking | 300,00 € |
| Tourist tax (Payable at the base) <i>Season: 2025.</i> | Yes | per person/day | 7,00 € |
| Cook (Payable at the base) <i>Season: 2025. if paid in the office, 15% charge added</i> | No | per day + food | 200,00 € |
| Full board (Payable at the base) <i>Season: 2025. without seafood if paid in the office, 15% charge added</i> | No | per person/day | 60,00 € |
| Full board (Payable at the base) <i>Season: 2025. Sea food included if paid in the office, 15% charge added</i> | No | per person/day | 80,00 € |
| Hostess (Payable at the base) <i>Season: 2025. if paid in the office, 15% charge added</i> | No | per day + food | 200,00 € |
| Skipper (Payable at the base) <i>Season: 2025. if paid in the office, 15% charge added</i> | No | per day + food | 200,00 € |
| Transfer (Payable at the base) <i>Season: 2025. for 8 pax - 2 way if paid in the office, 15% charge added</i> | No | round trip | 150,00 € |
| WI-FI Internet connection on boat (Payable at the base) <i>Season: 2025. if paid in the office, 15% charge added</i> | No | per week | 130,00 € |



WEBSITE

www.plujeme.cz



PHONE

+420 720 755 085



MOBILE

+420 777 170 276



E-MAIL

info@plujeme.cz



PLUJEME RÁDI S.R.O.

Dlouhá 730/35, 11000 Praha 1 – Staré Město, Czech Republic

ADDITIONAL EXTRAS

| EXTRA | OBLIGATORY | PAYMENT TYPE | PRICE |
|---|------------|--------------|-----------------|
| Fishing cane/rod <i>(Payable at the base)</i> Season: 2025. <i>Payable at the base</i> | No | per week | 100,00 € |
| Railing net (Safety net) <i>(Payable at the base)</i> Season: 2025. <i>Payable at the base</i> | No | per week | 150,00 € |
| Stand up paddle (SUP) <i>(Payable at the base)</i> Season: 2025. <i>Payable at the base</i> | No | per week | 125,00 € |



WEBSITE

www.plujeme.cz



E-MAIL

info@plujeme.cz



PHONE

+420 720 755 085



MOBILE

+420 777 170 276



PLUJEME RÁDI S.R.O.

Dlouhá 730/35, 11000 Praha 1 – Staré Město, Czech Republic

PRICE AND AVAILABILITY

| | | | |
|---|---|---|---|
| 04.01. - 11.01.2025 NOT AVAILABLE | 11.01. - 18.01.2025 NOT AVAILABLE | 18.01. - 25.01.2025 6.376 € 7.970 € | 25.01. - 01.02.2025 NOT AVAILABLE |
| 01.02. - 08.02.2025 10.908 € 12.120 € | 08.02. - 15.02.2025 10.908 € 12.120 € | 15.02. - 22.02.2025 10.908 € 12.120 € | 22.02. - 01.03.2025 NOT AVAILABLE |
| 01.03. - 08.03.2025 NOT AVAILABLE | 08.03. - 15.03.2025 9.630 € 10.700 € | 15.03. - 22.03.2025 NOT AVAILABLE | 22.03. - 29.03.2025 9.630 € 10.700 € |
| 29.03. - 05.04.2025 NOT AVAILABLE | 05.04. - 12.04.2025 10.908 € 12.120 € | 12.04. - 19.04.2025 10.908 € 12.120 € | 19.04. - 26.04.2025 10.908 € 12.120 € |
| 26.04. - 12.05.2025 NOT AVAILABLE | 17.05. - 24.05.2025 7.173 € 7.970 € | 24.05. - 31.05.2025 6.489 € 7.210 € | 31.05. - 07.06.2025 6.489 € 7.210 € |
| 07.06. - 14.06.2025 6.489 € 7.210 € | 14.06. - 21.06.2025 6.489 € 7.210 € | 21.06. - 28.06.2025 6.489 € 7.210 € | 28.06. - 05.07.2025 7.173 € 7.970 € |
| 05.07. - 12.07.2025 7.173 € 7.970 € | 12.07. - 19.07.2025 7.173 € 7.970 € | 19.07. - 26.07.2025 8.478 € 9.420 € | 26.07. - 02.08.2025 8.478 € 9.420 € |



WEBSITE

www.plujeme.cz



E-MAIL

info@plujeme.cz



PHONE

+420 720 755 085



MOBILE

+420 777 170 276



PLUJEME RÁDI S.R.O.

Dlouhá 730/35, 11000 Praha 1 – Staré Město, Czech Republic

PRICE AND AVAILABILITY

| | | | |
|---|--|--|---|
| 02.08. - 09.08.2025 8.478 € 9.420 € | 09.08. - 16.08.2025 8.478 € 9.420 € | 16.08. - 23.08.2025 5.040 € 5.600 € | 23.08. - 30.08.2025 5.040 € 5.600 € |
| 30.08. - 06.09.2025 5.040 € 5.600 € | 06.09. - 13.09.2025 5.040 € 5.600 € | 13.09. - 20.09.2025 5.040 € 5.600 € | 20.09. - 27.09.2025 5.040 € 5.600 € |
| 27.09. - 04.10.2025 9.630 € 10.700 € | 04.10. - 11.10.2025 9.630 € 10.700 € | 11.10. - 18.10.2025 9.630 € 10.700 € | 18.10. - 25.10.2025 9.630 € 10.700 € |
| 25.10. - 01.11.2025 9.630 € 10.700 € | 01.11. - 08.11.2025 9.630 € 10.700 € | 08.11. - 15.11.2025 9.630 € 10.700 € | 15.11. - 22.11.2025 9.630 € 10.700 € |
| 22.11. - 29.11.2025 9.630 € 10.700 € | 29.11. - 06.12.2025 5.040 € 5.600 € | 06.12. - 13.12.2025 5.040 € 5.600 € | 13.12. - 20.12.2025 12.150 € 13.500 € |
| 20.12. - 27.12.2025 12.150 € 13.500 € | | | |



WEBSITE
www.plujeme.cz



E-MAIL
info@plujeme.cz



PHONE
+420 720 755 085



PLUJEME RÁDI S.R.O.
Dlouhá 730/35, 11000 Praha 1 – Staré Město, Czech Republic



MOBILE
+420 777 170 276