

AZIMUT 68

M/Y Maoro (2006)

Luxury Charter Azimut 68 M/Y Maoro, built in 2006 is anchored in the **Marina Kastela, Split region, Croatia**. It has **3 + 1 cabins**, can accommodate **6 + 1 people** and has **3 + 1 toilets**. Bed linen and kitchen equipment are included in the price.

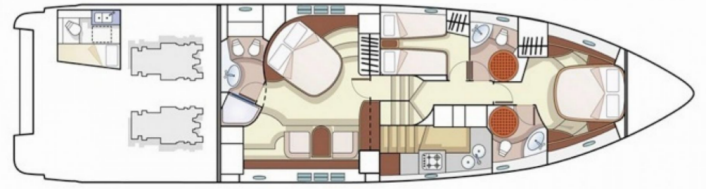

YACHT SPECIFICATIONS

Yacht Base Marina Kastela, Croatia	Yacht ID 7695	Brands Azimut / Benetti Yachts
Yacht name M/Y Maoro	Production year 2006	Length 69 ft
Cabins 3 + 1	Berths 6 + 1	Max Persons 6
WC 3 + 1	Engine 2 x 1360 HP	Fuel tank 3200 l



WEBSITE
www.plujeme.cz



PHONE
+420 720 755 085



MOBILE
+420 777 170 276



E-MAIL
info@plujeme.cz



PLUJEME RÁDI S.R.O.
Dlouhá 730/35, 11000 Praha 1 – Staré Město, Czech Republic

STANDARD YACHT EQUIPMENT

Deck	Bathing platform, Grill/Barbecue/Plancha, Hydraulic gangway, Sun deck, Sun tent, Tender
Entertainment	Bose Sound System, Donut, Fishing cane/rod, Jet Ski SEA-DOO Spark, LCD TV + DVD, Snorkeling equipment, Stand up paddle (SUP), TV, Water skis, Water skis for children, Wi-Fi Internet
Galley	Ice maker, Microwave
Interior	Table, Washer/dryer
Yacht electrics	Air Conditioning, Generator, Watermaker - desalinator



WEBSITE

www.plujeme.cz



E-MAIL

info@plujeme.cz



PHONE

+420 720 755 085



MOBILE

+420 777 170 276



PLUJEME RÁDI S.R.O.

Dlouhá 730/35, 11000 Praha 1 – Staré Město, Czech Republic

SERVICES

SELECTED SERVICES	OBLIGATORY	PAYMENT TYPE	PRICE
APA (Advance Provisioning Allowance) (Payable at the base) Season: 2024. The APA amounts to 30% of the total yacht charter net price and includes fuel, berths, food and beverage costs and ancillary costs for the boat throughout the cruise period. All additional expenses during your week charter (fuel, moorings, food, beverages,...) will go up to 30%, on the top of the charter rate (of course all depending on particular request for services, itinerary, F&B, etc.). Therefore, APA for these additional costs/expenses is paid upfront. The crew keeps an accurate record of spending (hands the bills to the guest to check), and at the end of the charter guest will be refunded or asked to pay the difference if additional operating costs have incurred.	Yes	per booking	0,00 €
Transit log (Payable at the base) Season: 2024.	Yes	per booking	450,00 €

**WEBSITE**www.plujeme.cz**E-MAIL**info@plujeme.cz**PHONE**

+420 720 755 085

**MOBILE**

+420 777 170 276

**PLUJEME RÁDI S.R.O.**

Dlouhá 730/35, 11000 Praha 1 – Staré Město, Czech Republic

ADDITIONAL EXTRAS

EXTRA	OBLIGATORY	PAYMENT TYPE	PRICE
eFoil (Payable at the base) Season: 2024. on request - Payable at the base	Yes	per day	450,00 €
Seabob (Payable at the base) Season: 2024. on request - Payable at the base	Yes	per day	350,00 €



WEBSITE

www.plujeme.cz



E-MAIL

info@plujeme.cz



PHONE

+420 720 755 085



MOBILE

+420 777 170 276



PLUJEME RÁDI S.R.O.

Dlouhá 730/35, 11000 Praha 1 – Staré Město, Czech Republic

PRICE AND AVAILABILITY

21.09. - 28.09.2024 22.000 €	28.09. - 05.10.2024 21.000 €	05.10. - 12.10.2024 21.000 €	12.10. - 19.10.2024 21.000 €
19.10. - 26.10.2024 21.000 €	26.10. - 02.11.2024 21.000 €	02.11. - 09.11.2024 21.000 €	09.11. - 16.11.2024 21.000 €
16.11. - 23.11.2024 21.000 €	23.11. - 30.11.2024 21.000 €	30.11. - 07.12.2024 21.000 €	07.12. - 14.12.2024 21.000 €
14.12. - 21.12.2024 21.000 €	21.12. - 28.12.2024 21.000 €		



WEBSITE

www.plujeme.cz



E-MAIL

info@plujeme.cz



PHONE

+420 720 755 085



MOBILE

+420 777 170 276



PLUJEME RÁDI S.R.O.

Dlouhá 730/35, 11000 Praha 1 – Staré Město, Czech Republic