

OCEANIS 46.1

Nemo (2024)

Sailing yacht Oceanis 46.1 Nemo, built in 2024 is anchored in the Pula, ACI Marina Pomer, Istra, Croatia. It has 4 cabins, can accommodate 8 + 2 people and has 4 toilets. Bed linen and kitchen equipment are included in the price.

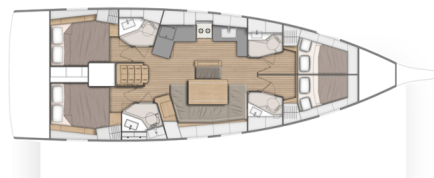

YACHT SPECIFICATIONS

Yacht Base

Pula, ACI Marina Pomer, Croatia

Yacht ID

7607

Brands

Beneteau

Yacht name

Nemo

Production year

2024

Length

48 ft

Cabins

4

Berths

8 + 2

WC

4

Engine

1 x 57 HP

Fuel tank

200 l



WEBSITE

www.plujeme.cz



PHONE

+420 720 755 085



MOBILE

+420 777 170 276



E-MAIL

info@plujeme.cz



PLUJEME RÁDI S.R.O.

Dlouhá 730/35, 11000 Praha 1 – Staré Město, Czech Republic

STANDARD YACHT EQUIPMENT

Comfort	Bed linen, Cockpit cushions, Mosquito nets, Towels
Deck	Anchor, Bathing platform, Bilge pump - Mechanic, Bimini top, Boat hook, Bosun's chair (Safe seat) (boatswain's chair), Cockpit table, Cockpit/stern, outside shower, Dinghy, Electric anchor windlass, Fenders, Gangway, Round/globular fender, Spare anchor (Reserve, Auxiliary anchor), Sprayhood
Entertainment	FUSION sound system, Indoor speakers, Outdoor speakers, Radio with USB
Galley	Gas bottles, Hot water, Kitchen utensils (Galley equipment, cutlery), Oven, Refrigerator, Sink, Stove, Water pump
Interior	Walnut interior
Navigation	Autopilot, Binoculars, Bow thruster, Compass, GPS chart plotter - cockpit, Log/speed instrument, Navigation (Nautical) charts and nautical guide , Pilot book, Wind instrument/Anemometer
Safety	Black Water Tank, Buoyant smoke signal, Distress signals, Fire axe, Fire extinguisher , First aid kit , Fog horn, Life belts (Safety harness), Life jackets, VHF radio
Yacht electrics	Battery charger , Bilge pump - Electric, Heating, Service batteries, Shore connection 220 V, Solar panels, USB sockets



WEBSITE

www.plujeme.cz



PHONE

+420 720 755 085



MOBILE

+420 777 170 276



E-MAIL

info@plujeme.cz



PLUJEME RÁDI S.R.O.

Dlouhá 730/35, 11000 Praha 1 – Staré Město, Czech Republic

SERVICES

SELECTED SERVICES	OBLIGATORY	PAYMENT TYPE	PRICE
Charter pack (Payable now) Season: 2025. Includes: bed linen, towels, kitchen utensils, 3 GB WiFi, snorkeling set, diver's inspection, end cleaning	Yes	per booking	363,00 €
APA (Advance Provisioning Allowance) (Payable at the base) Season: 2025. Obligatory with Hostess	No	per week	3.000,00 €
Damage waiver (Payable now) Season: 2025. + 100 EUR refundable	No	per booking	390,00 €
Hostess (Payable now) Season: 2025. Preparation of 2 meals daily; + obligatory APA 3000,00eur	No	per week + food	1.837,00 €
Pet on board (Payable at the base) Season: 2025.	No	per booking	150,00 €
Skipper (Payable now) Season: 2025. + cabin	No	per week + food	1.750,00 €
Tourist tax (Payable now) Season: 2025. cash or card	No	per guest/night	1,33 €
Transfer (Payable at the base) Season: 2025. Transfer APT Pula- ACI(8pax)	No	one-way	60,00 €
WI-FI Internet connection on boat (Payable at the base) Season: 2025. 40GB	No	per booking	30,00 €



WEBSITE

www.plujeme.cz



E-MAIL

info@plujeme.cz



PHONE

+420 720 755 085



MOBILE

+420 777 170 276



PLUJEME RÁDI S.R.O.

Dlouhá 730/35, 11000 Praha 1 – Staré Město, Czech Republic

ADDITIONAL EXTRAS

EXTRA	OBLIGATORY	PAYMENT TYPE	PRICE
Beach towel (Payable at the base) Season: 2025. Payable at the base	No	per piece	9,00 €
Extra towels (Payable at the base) Season: 2025. small towel (70x50) + medium towel - Payable at the base	No	per set	7,00 €
Gennaker (Payable at the base) Season: 2025. on request - Payable at the base	No	per week	200,00 €
Outboard engine (Payable now) Season: 2025. Payable now	No	per week	100,00 €
Railing net (Safety net) (Payable at the base) Season: 2025. Payable at the base	No	per booking	100,00 €
Snorkeling equipment (Payable at the base) Season: 2025. Payable at the base	No	per set	12,00 €
Stand up paddle (SUP) (Payable at the base) Season: 2025. Payable at the base	No	per week	120,00 €
Water toys (Payable at the base) Season: 2025. On request - Payable at the base	No	per booking	0,00 €



WEBSITE
www.plujeme.cz



PHONE
+420 720 755 085



MOBILE
+420 777 170 276



E-MAIL
info@plujeme.cz



PLUJEME RÁDI S.R.O.
Dlouhá 730/35, 11000 Praha 1 – Staré Město, Czech Republic

PRICE AND AVAILABILITY

05.04. - 12.04.2025 2.067 € 3.180 €	12.04. - 19.04.2025 2.067 € 3.180 €	19.04. - 26.04.2025 2.067 € 3.180 €	26.04. - 03.05.2025 2.067 € 3.180 €
03.05. - 10.05.2025 2.226 € 3.180 €	10.05. - 17.05.2025 NOT AVAILABLE	17.05. - 24.05.2025 2.821 € 4.030 €	24.05. - 31.05.2025 NOT AVAILABLE
31.05. - 21.06.2025 NOT AVAILABLE	21.06. - 28.06.2025 4.505 € 5.300 €	28.06. - 05.07.2025 4.505 € 5.300 €	05.07. - 12.07.2025 5.381 € 6.330 €
12.07. - 19.07.2025 5.381 € 6.330 €	19.07. - 26.07.2025 5.381 € 6.330 €	26.07. - 02.08.2025 5.381 € 6.330 €	02.08. - 09.08.2025 5.381 € 6.330 €
09.08. - 16.08.2025 5.381 € 6.330 €	16.08. - 23.08.2025 4.505 € 5.300 €	23.08. - 30.08.2025 4.505 € 5.300 €	30.08. - 06.09.2025 NOT AVAILABLE
06.09. - 13.09.2025 NOT AVAILABLE	13.09. - 20.09.2025 3.825 € 4.500 €	20.09. - 27.09.2025 3.230 € 3.800 €	27.09. - 04.10.2025 2.975 € 3.500 €



WEBSITE

www.plujeme.cz



E-MAIL

info@plujeme.cz



PHONE

+420 720 755 085



MOBILE

+420 777 170 276



PLUJEME RÁDI S.R.O.

Dlouhá 730/35, 11000 Praha 1 – Staré Město, Czech Republic

PRICE AND AVAILABILITY

04.10. - 11.10.2025

2.975 € 3.500 €

11.10. - 18.10.2025

2.975 € 3.500 €

18.10. - 25.10.2025

2.975 € 3.500 €

26.10. - 31.12.2025

NOT AVAILABLE



WEBSITE

www.plujeme.cz



E-MAIL

info@plujeme.cz



PHONE

+420 720 755 085



MOBILE

+420 777 170 276



PLUJEME RÁDI S.R.O.

Dlouhá 730/35, 11000 Praha 1 – Staré Město, Czech Republic