

BALI 5.4

Virginia (2022)

Catamaran Bali 5.4 Virginia, built in 2022 is anchored in the Capo D'orlando Marina, Sicily, Italy. It has 5 + 2 cabins, can accommodate 10 + 2 people and has 5 + 2 toilets. Bed linen and kitchen equipment are included in the price.

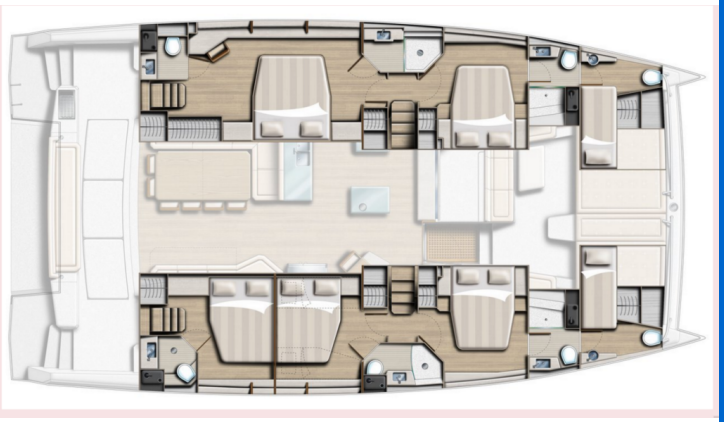

YACHT SPECIFICATIONS

Yacht Base

Capo D'orlando Marina, Italy

Yacht ID

7585

Brands

Catana

Yacht name

Virginia

Production year

2022

Length

55 ft

Cabins

5 + 2

Berths

10 + 2

WC

5 + 2

Engine

2 x 80 HP

Fuel tank

1200 l



WEBSITE

www.plujeme.cz



PHONE

+420 720 755 085



MOBILE

+420 777 170 276



E-MAIL

info@plujeme.cz



PLUJEME RÁDI S.R.O.

Dlouhá 730/35, 11000 Praha 1 – Staré Město, Czech Republic

STANDARD YACHT EQUIPMENT

Comfort	Cockpit cushions
Deck	Bimini top, Cockpit table, Cockpit/stern, outside shower
Entertainment	Radio
Galley	Refrigerator
Interior	Electric fans, Electric toilet
Navigation	Autopilot, GPS chart plotter, Wind/speed/depth instruments
Safety	VHF radio
Sails	Electric winch, Lazy bag
Yacht electrics	Air Conditioning, Generator, Inverter, Watermaker - desalinator



WEBSITE

www.plujeme.cz



E-MAIL

info@plujeme.cz



PHONE

+420 720 755 085



MOBILE

+420 777 170 276



PLUJEME RÁDI S.R.O.

Dlouhá 730/35, 11000 Praha 1 – Staré Město, Czech Republic

SERVICES

SELECTED SERVICES	OBLIGATORY	PAYMENT TYPE	PRICE
Hostess (Payable at the base) Season: 2025. + own cabin	Yes	per week + food	1.300,00 €
Skipper (Payable at the base) Season: 2025.	Yes	per week + food	1.600,00 €
Transit log (Payable at the base) Season: 2025. include: (Welcome pack, 2 SUP, Wi-Fi, final cleaning cat, bed linen and Towels, Mattress cover, Pillowcase, Bed sheet, Large towel and Small towel), Outboard engine, Gas bottle, Mooring first and last night in our base, Check-in and check-out)	Yes	per booking	1.000,00 €
Damage waiver (Payable at the base) Season: 2025. non-repayable + 1.000,00 EUR deposit; With skipper	No	per booking	500,00 €
Damage waiver (Payable at the base) Season: 2025. non-repayable + 2.000,00 EUR deposit; Without skipper	No	per booking	650,00 €
Early Check in (Payable at the base) Season: 2025. at 14:30h	No	per booking	350,00 €
Fuel charge (Payable at the base) Season: 2025. + Fuel	No	per service	150,00 €
Late Check in (Payable at the base) Season: 2025. After 20:00h	No	per booking	100,00 €
Pet on board (Payable at the base) Season: 2025.	No	per booking	250,00 €
Provisioning (Payable at the base) Season: 2025. + storeroom	No	per booking	100,00 €
Regatta charge (Payable at the base) Season: 2025. Availability on request	No	per booking	0,00 €
Sunday Check-in (Payable at the base) Season: 2025.	No	per booking	200,00 €

Transfer (Payable at the base)

No

per booking

0,00 €

Season: 2025. On request; Sicily - Salerno

WI-FI Internet connection on boat (Payable at the base)

No

per week

50,00 €

Season: 2025.



WEBSITE

www.plujeme.cz



E-MAIL

info@plujeme.cz



PHONE

+420 720 755 085



MOBILE

+420 777 170 276



PLUJEME RÁDI S.R.O.

Dlouhá 730/35, 11000 Praha 1 – Staré Město, Czech Republic

ADDITIONAL EXTRAS

EXTRA	OBLIGATORY	PAYMENT TYPE	PRICE
Beach towel (Payable at the base) Season: 2025. Payable at the base	No	per person	15,00 €
Bedlinen and towels (Payable at the base) Season: 2025. Payable at the base	No	per week/ person	20,00 €
Canoe (Payable at the base) Season: 2025. 2 places - Payable at the base	No	per booking	150,00 €
Railing net (Safety net) (Payable at the base) Season: 2025. Payable at the base	No	per booking	100,00 €
Snorkeling equipment (Payable at the base) Season: 2025. Payable at the base	No	per person	30,00 €
Stand up paddle (SUP) (Payable at the base) Season: 2025. Payable at the base	No	per week	150,00 €



WEBSITE

www.plujeme.cz



E-MAIL

info@plujeme.cz



PHONE

+420 720 755 085



MOBILE

+420 777 170 276



PLUJEME RÁDI S.R.O.

Dlouhá 730/35, 11000 Praha 1 – Staré Město, Czech Republic

PRICE AND AVAILABILITY

04.01. - 11.01.2025 9.300 € 10.690 €	11.01. - 18.01.2025 9.300 € 10.690 €	18.01. - 25.01.2025 9.300 € 10.690 €	25.01. - 01.02.2025 9.300 € 10.690 €
01.02. - 08.02.2025 9.300 € 10.690 €	08.02. - 15.02.2025 9.300 € 10.690 €	15.02. - 22.02.2025 9.300 € 10.690 €	22.02. - 01.03.2025 9.300 € 10.690 €
01.03. - 08.03.2025 9.300 € 10.690 €	08.03. - 15.03.2025 9.300 € 10.690 €	15.03. - 22.03.2025 9.300 € 10.690 €	22.03. - 29.03.2025 9.300 € 10.690 €
29.03. - 05.04.2025 9.300 € 10.690 €	05.04. - 12.04.2025 9.300 € 10.690 €	12.04. - 19.04.2025 9.300 € 10.690 €	19.04. - 26.04.2025 9.300 € 10.690 €
26.04. - 03.05.2025 9.300 € 10.690 €	03.05. - 10.05.2025 9.300 € 10.690 €	10.05. - 17.05.2025 9.300 € 10.690 €	17.05. - 24.05.2025 9.300 € 10.690 €
24.05. - 31.05.2025 12.093 € 13.900 €	31.05. - 07.06.2025 12.093 € 13.900 €	07.06. - 14.06.2025 12.093 € 13.900 €	14.06. - 21.06.2025 13.920 € 16.000 €
21.06. - 28.06.2025 13.920 € 16.000 €	28.06. - 05.07.2025 13.920 € 16.000 €	05.07. - 12.07.2025 NOT AVAILABLE	12.07. - 19.07.2025 17.400 € 20.000 €
19.07. - 26.07.2025 17.400 € 20.000 €	26.07. - 02.08.2025 NOT AVAILABLE		



WEBSITE

www.plujeme.cz



E-MAIL

info@plujeme.cz



PHONE

+420 720 755 085



MOBILE

+420 777 170 276



PLUJEME RÁDI S.R.O.

Dlouhá 730/35, 11000 Praha 1 – Staré Město, Czech Republic

PRICE AND AVAILABILITY

02.08. - 09.08.2025 24.000 €	09.08. - 16.08.2025 NOT AVAILABLE	16.08. - 23.08.2025 20.500 €	23.08. - 30.08.2025 20.000 €
30.08. - 06.09.2025 20.000 €	06.09. - 13.09.2025 13.920 € 16.000 €	13.09. - 20.09.2025 13.920 € 16.000 €	20.09. - 27.09.2025 NOT AVAILABLE
27.09. - 04.10.2025 12.093 € 13.900 €	04.10. - 11.10.2025 12.093 € 13.900 €	11.10. - 18.10.2025 9.300 € 10.690 €	18.10. - 25.10.2025 9.300 € 10.690 €
25.10. - 01.11.2025 9.300 € 10.690 €	01.11. - 08.11.2025 9.300 € 10.690 €	08.11. - 15.11.2025 9.300 € 10.690 €	15.11. - 22.11.2025 9.300 € 10.690 €
22.11. - 29.11.2025 9.300 € 10.690 €	29.11. - 06.12.2025 9.300 € 10.690 €	06.12. - 13.12.2025 9.300 € 10.690 €	13.12. - 20.12.2025 9.300 € 10.690 €
20.12. - 27.12.2025 9.300 € 10.690 €			



WEBSITE

www.plujeme.cz



E-MAIL

info@plujeme.cz



PHONE

+420 720 755 085



MOBILE

+420 777 170 276



PLUJEME RÁDI S.R.O.

Dlouhá 730/35, 11000 Praha 1 – Staré Město, Czech Republic