

# ELAN IMPRESSION 45.1

Oxygen (2023)

Sailing yacht Elan Impression 45.1 Oxygen, built in 2023 is anchored in the **Trogir, Marina Trogir (ex.SCT), Split region, Croatia**. It has **3 cabins**, can accommodate **6 + 2 people** and has **2 toilets**. Bed linen and kitchen equipment are included in the price.

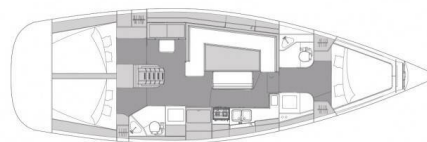

## YACHT SPECIFICATIONS

Yacht Base

**Trogir, Marina Trogir (ex.SCT),  
Croatia**

Yacht ID

**7161**

Brands

**Elan Marine**

Yacht name

**Oxygen**

Production year

**2023**

Length

**44 ft**

Cabins

**3**

Berths

**6 + 2**

WC

**2**

Engine

**1 x 75 HP**

Fuel tank

**215 l**



**WEBSITE**

[www.plujeme.cz](http://www.plujeme.cz)



**PHONE**

+420 720 755 085



**MOBILE**

+420 777 170 276



**E-MAIL**

[info@plujeme.cz](mailto:info@plujeme.cz)



**PLUJEME RÁDI S.R.O.**

Dlouhá 730/35, 11000 Praha 1 – Staré Město, Czech Republic

## STANDARD YACHT EQUIPMENT

Comfort	<b>Bedlinen and towels, Cockpit cushions</b>
Deck	<b>Anchor with chain, Bathing platform, Bilge pump - Mechanic, Bimini top, Boat hook, Cockpit fridge, Cockpit light, Cockpit table, Cockpit/stern, outside shower, Dinghy, Electric anchor windlass, Fenders, Grill/Barbecue/Plancha, Jerry cans for diesel, Sprayhood, Swimming ladder, Teak cockpit</b>
Entertainment	<b>Fusion radio, Outdoor speakers, Wi-Fi Internet</b>
Galley	<b>Freezer, Gas bottles, Hot water, Kitchen utensils (Galley equipment, cutlery), Refrigerator</b>
Interior	<b>Electric toilet, Vacuum toilet</b>
Navigation	<b>Autopilot, Bow thruster, Complete navigation equipment, GPS chart plotter - cockpit, Nautical charts, Wind/speed/depth instruments</b>
Safety	<b>Black Water Tank, Distress signals, First aid kit , Life belts (Safety harness), Life jackets, Signal rockets and torches , VHF radio</b>
Yacht electrics	<b>220V socket, Air Conditioning, Battery charger , Bilge pump - Electric, Extra 12V battery, Heating, Inverter, Shore connection 220 V, USB sockets</b>



**WEBSITE**

[www.plujeme.cz](http://www.plujeme.cz)



**PHONE**

+420 720 755 085



**MOBILE**

+420 777 170 276



**E-MAIL**

[info@plujeme.cz](mailto:info@plujeme.cz)



**PLUJEME RÁDI S.R.O.**

Dlouhá 730/35, 11000 Praha 1 – Staré Město, Czech Republic

## SERVICES

SELECTED SERVICES	OBLIGATORY	PAYMENT TYPE	PRICE
<b>Transit log</b> (Payable at the base) <b>Season: 2025.</b> includes final cleaning, 1 set of bedlinen and towels/person/week, gas, basic package for toilets and kitchen, check-in and out service, Wi-Fi package (10GB)	Yes	per booking	<b>280,00 €</b>
<b>Adrenalin pack</b> (Payable now) <b>Season: 2025.</b> Pack 75 - includes: RIB 5M with outboard engine 75 HP, 1 pair of water skis, 1 wakeboard, 1 tube (security deposit 500Eur) *RIB needs to be towed	No	per week	<b>1.600,00 €</b>
<b>Adrenalin pack</b> (Payable now) <b>Season: 2025.</b> Pack 100 - includes: RIB 5,6M with outboard engine 100 HP, 1 pair of water skis, 1 wakeboard, 1 tube (security deposit 500Eur) *RIB needs to be towed	No	per week	<b>1.700,00 €</b>
<b>Adrenalin pack</b> (Payable now) <b>Season: 2025.</b> Pack 115 - includes: RIB 5,7M with outboard engine 115 HP, 1 pair of water skis, 1 wakeboard, 1 tube (security deposit 500Eur) *RIB needs to be towed	No	per week	<b>1.800,00 €</b>
<b>Chef</b> (Payable at the base) <b>Season: 2025.</b>	No	per day + food	<b>300,00 €</b>
<b>Deposit insurance</b> (Payable at the base) <b>Season: 2025.</b> + 250EUR refundable. The insurance is based on a fixed and a refundable part, in case of damage the maximum cost is the refundable part please see terms and condition. For multiple weeks charter, 70% of the fixed part for the first week price shall be paid in addition. Deposit insurance does not cover losses and damages of dinghy and outboard engine	No	per booking	<b>250,00 €</b>
<b>Early Check in</b> (Payable at the base) <b>Season: 2025.</b> for charters in May; access to the yacht at 13:00h (Number of Early check-in/per Saturday is limited)	No	per booking	<b>150,00 €</b>
<b>Early Check in</b> (Payable at the base) <b>Season: 2025.</b> for charters in October; access to the yacht at 13:00h (Number of Early check-in/per Saturday is limited)	No	per booking	<b>150,00 €</b>

<b>Early Check in</b> (Payable at the base) <b>Season: 2025.</b> for charters from June till September; access to the yacht at 13:00h (Number of Early check-in/per Saturday is limited)	No	per booking	<b>200,00 €</b>
<b>Hostess</b> (Payable now) <b>Season: 2025.</b>	No	per day + food	<b>220,00 €</b>
<b>Late check out</b> (Payable at the base) <b>Season: 2025.</b> on request only	No	per booking	<b>500,00 €</b>
<b>One way fee</b> (Payable at the base) <b>Season: 2025.</b> Trogir - Dubrovnik/Dubrovnik - Trogir	No	per booking	<b>1.000,00 €</b>
<b>Skipper</b> (Payable now) <b>Season: 2025.</b>	No	per day + food	<b>220,00 €</b>
<b>Skipper + personal trainer</b> (Payable now) <b>Season: 2025.</b> Skipper with a university degree in kinesiology with a specialization in sailing. Activities: Fitness, Free diving, Massage, Sailing, Swimming, Windsurfing, Yoga	No	per day + food	<b>400,00 €</b>
<b>Skipper training practice</b> (Payable now) <b>Season: 2025.</b> Hire a Certified Instructional Skipper who is able to add a fun training experience to your vacation.	No	per week + food	<b>2.500,00 €</b>
<b>WI-FI Internet connection on boat</b> (Payable at the base) <b>Season: 2025.</b> 50 GB	No	per booking	<b>15,00 €</b>



**WEBSITE**

[www.plujeme.cz](http://www.plujeme.cz)



**E-MAIL**

[info@plujeme.cz](mailto:info@plujeme.cz)



**PHONE**

+420 720 755 085



**MOBILE**

+420 777 170 276









**PLUJEME RÁDI S.R.O.**

Dlouhá 730/35, 11000 Praha 1 – Staré Město, Czech Republic

## ADDITIONAL EXTRAS

EXTRA	OBLIGATORY	PAYMENT TYPE	PRICE
<b>Coffee machine</b> (Payable at the base) <b>Season: 2025.</b> Dolce gusto - including 10 capsules - Payable at the base	No	per week	<b>30,00 €</b>
<b>Extra bedlinen</b> (Payable at the base) <b>Season: 2025.</b> Payable at the base	No	per set	<b>12,00 €</b>
<b>Extra bedlinen and towels</b> (Payable at the base) <b>Season: 2025.</b> Extra set of bedlinen and towels for second week - Payable at the base	No	per booking	<b>80,00 €</b>
<b>Extra towels</b> (Payable at the base) <b>Season: 2025.</b> 1 big, 1 small towel - Payable at the base	No	per set	<b>7,00 €</b>
<b>Gennaker</b> (Payable now) <b>Season: 2025.</b> + deposit 500 EUR - Payable now	No	per week	<b>250,00 €</b>
<b>Inflatable lifejacket</b> (Payable at the base) <b>Season: 2025.</b> limited availability - Payable at the base	No	per week/ person	<b>15,00 €</b>
<b>Inflatable tube</b> (Payable at the base) <b>Season: 2025.</b> Payable at the base	No	per week	<b>150,00 €</b>
<b>Kayak</b> (Payable at the base) <b>Season: 2025.</b> 2 seat - Payable at the base	No	per week	<b>150,00 €</b>
<b>Outboard engine</b> (Payable at the base) <b>Season: 2025.</b> 2,5HP - Payable at the base	No	per week	<b>90,00 €</b>
<b>Railing net (Safety net)</b> (Payable at the base) <b>Season: 2025.</b> excluding installation - Payable at the base	No	per week	<b>80,00 €</b>
<b>Railing net (Safety net)</b> (Payable at the base) <b>Season: 2025.</b> including installation - Payable at the base	No	per week	<b>200,00 €</b>
<b>Seabob</b> (Payable at the base) <b>Season: 2025.</b> Payable at the base	No	per week	<b>1.200,00 €</b>

 <b>Stand up paddle (SUP)</b> (Payable at the base) <b>Season: 2025.</b> Payable at the base	 <b>WEBSITE</b> <a href="http://www.plujeme.cz">www.plujeme.cz</a>	 <b>PHONE</b> +420 720 755 089	 <b>MOBILE</b> +420 771 70 276	<b>120,00 €</b>
	 <b>E-MAIL</b> <a href="mailto:info@plujeme.cz">info@plujeme.cz</a>	 <b>PLUJEME RÁDI S.R.O.</b> Dlouhá 730/35, 11000 Praha 1 – Staré Město, Czech Republic		

## PRICE AND AVAILABILITY

12.04. - 19.04.2025 2.253 € 2.650 €	19.04. - 26.04.2025 2.253 € 2.650 €	26.04. - 03.05.2025 2.550 € 3.000 €	03.05. - 10.05.2025 2.550 € 3.000 €
10.05. - 17.05.2025 2.890 € 3.400 €	17.05. - 24.05.2025 2.890 € 3.400 €	24.05. - 31.05.2025 NOT AVAILABLE	31.05. - 07.06.2025 NOT AVAILABLE
07.06. - 14.06.2025 3.938 € 4.500 €	14.06. - 21.06.2025 4.375 € 5.000 €	21.06. - 28.06.2025 4.375 € 5.000 €	28.06. - 05.07.2025 4.988 € 5.700 €
05.07. - 12.07.2025 5.130 € 5.700 €	12.07. - 19.07.2025 5.130 € 5.700 €	19.07. - 26.07.2025 NOT AVAILABLE	26.07. - 02.08.2025 5.130 € 5.700 €
02.08. - 09.08.2025 5.130 € 5.700 €	09.08. - 16.08.2025 5.130 € 5.700 €	16.08. - 23.08.2025 4.845 € 5.700 €	23.08. - 30.08.2025 4.335 € 5.100 €
30.08. - 06.09.2025 4.590 € 5.100 €			



**WEBSITE**  
[www.plujeme.cz](http://www.plujeme.cz)



**E-MAIL**  
[info@plujeme.cz](mailto:info@plujeme.cz)



**PHONE**  
+420 720 755 085



**PLUJEME RÁDI S.R.O.**  
Dlouhá 730/35, 11000 Praha 1 – Staré Město, Czech Republic



**MOBILE**  
+420 777 170 276

## PRICE AND AVAILABILITY

06.09. - 13.09.2025

**4.275 €** 4.750 €

13.09. - 20.09.2025

**4.275 €** 4.750 €

20.09. - 27.09.2025

**3.600 €** 4.000 €

27.09. - 04.10.2025

**3.600 €** 4.000 €

04.10. - 11.10.2025

**2.550 €** 3.000 €

11.10. - 18.10.2025

**2.550 €** 3.000 €

18.10. - 25.10.2025

**2.550 €** 3.000 €

25.10. - 01.11.2025

**3.000 €**

01.11. - 27.12.2025

NOT AVAILABLE



**WEBSITE**

[www.plujeme.cz](http://www.plujeme.cz)



**E-MAIL**

[info@plujeme.cz](mailto:info@plujeme.cz)



**PHONE**

+420 720 755 085



**MOBILE**

+420 777 170 276



**PLUJEME RÁDI S.R.O.**

Dlouhá 730/35, 11000 Praha 1 – Staré Město, Czech Republic