

BALI 4.2

Kamla (2024)

Catamaran Bali 4.2 Kamla, built in 2024 is anchored in the Marina Šangulin, Biograd, Zadar region, Croatia. It has 4 + 1 cabins, can accommodate 8 + 2 + 1 people and has 4 toilets. Bed linen and kitchen equipment are included in the price.

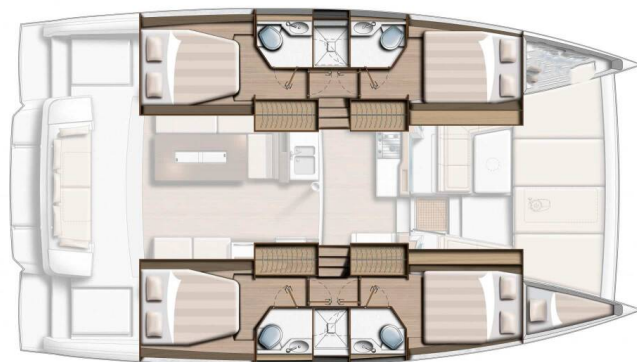

YACHT SPECIFICATIONS

Yacht Base

Marina Šangulin, Biograd, Croatia

Yacht ID

7144

Brands

Catana

Yacht name

Kamla

Production year

2024

Length

42 ft

Cabins

4 + 1

Berths

8 + 2 + 1

Max Persons

11

WC

4

Engine

2 x 45 HP

Fuel tank

640 l



WEBSITE

www.plujeme.cz



PHONE

+420 720 755 085



MOBILE

+420 777 170 276



E-MAIL

info@plujeme.cz



PLUJEME RÁDI S.R.O.

Dlouhá 730/35, 11000 Praha 1 – Staré Město, Czech Republic

STANDARD YACHT EQUIPMENT

Comfort	Bed linen, Cockpit cushions, Deck cushions, Helmstation seat cushions, Mosquito nets, Pillows
Deck	Anchor, Bilge pump - Mechanic, Cockpit table, Cockpit/stern, outside shower, Dinghy, Electric anchor windlass, Fenders, Grill/Barbecue/Plancha, Hard Top Bimini, Spare anchor (Reserve, Auxiliary anchor), Winch handles
Entertainment	FUSION sound system, Outdoor speakers, Stand up paddle (SUP) - FREE, Wireless Internet Router
Galley	Coffee pot, Electrical kettle, Gas bottles, Gas cookers, Moka pot, Oven, Refrigerator, Sink
Interior	Duvet cover, Electric fans in cabins, Electric toilet, Upholstery
Navigation	Autopilot, Binoculars, Compass, GPS chart plotter, Hand bearing compass, Nautical charts, Pilot book, Radar reflector, Tridata, Wind instrument/Anemometer
Safety	Distress flare box, Fire extinguisher , First aid kit , Flashlight, Fog horn, Life belts (Safety harness), Life jackets, Repair kit, Set of tools , VHF radio
Sails	Electric winch
Yacht electrics	220V socket, Air Conditioning, Battery charger , Bilge pump - Electric, Electric tilting door lift, Heating, Inverter, Service batteries, Solar panels, USB sockets



WEBSITE

www.plujeme.cz



PHONE

+420 720 755 085



MOBILE

+420 777 170 276



E-MAIL

info@plujeme.cz



PLUJEME RÁDI S.R.O.

Dlouhá 730/35, 11000 Praha 1 – Staré Město, Czech Republic

SERVICES

SELECTED SERVICES	OBLIGATORY	PAYMENT TYPE	PRICE
Charter package (Payable at the base) Season: 2025 - Angelina Yachtcharter. Charter package includes final cleaning, gas, check-in and out services, Wi-Fi 70GB/week, package for toilets (toilet paper and soap /per each toilet) and kitchen (1 kitchen paper towels, a sponge and a cleaning cloth, a small package of dish detergent, 1 waste bag, 2 kitchen towels, 2x 1l bottle of water), bed linen/bath towels (2 sets per cabin - do not include saloon and skipper cabin).	Yes	per booking	400,00 €
WiFi GRATIS ON BOAT (Payable now) Season: 2025 - Angelina Yachtcharter. GRATIS	Yes	per booking	0,00 €
Assisted Sailing (Payable at the base) Season: 2025 - Angelina Yachtcharter. Valovie - remote sailing assistance; Our skipper will help and assist you remotely during your charter, and provide you advices when it comes to berths, restaurant recommendations, weather forecasts etc.	No	per booking	270,00 €
Deposit insurance (Payable at the base) Season: 2025 - Angelina Yachtcharter. + refundable deposit 300,00 EUR	No	per booking	360,00 €
Early boarding/check-in (Payable at the base) Season: 2025 - Angelina Yachtcharter. boarding between 13:00 - 14:00h	No	per booking	250,00 €
Extra cleaning (Payable at the base) Season: 2025 - Angelina Yachtcharter. penalty fee for boat in dirty condition (garbage,dirty dishes,ect..)	No	per booking	120,00 €
Late check out (Payable at the base) Season: 2025 - Angelina Yachtcharter. Saturday till 10 AM, on request	No	per booking	350,00 €
Pet on board (Payable at the base) Season: 2025 - Angelina Yachtcharter. maximum 2 pets allowed	No	per booking	200,00 €



WEBSITE

www.plujeme.cz



PHONE

+420 720 755 085



MOBILE

+420 777 170 276



E-MAIL

info@plujeme.cz



PLUJEME RÁDI S.R.O.

Dlouhá 730/35, 11000 Praha 1 – Staré Město, Czech Republic

ADDITIONAL EXTRAS

EXTRA	OBLIGATORY	PAYMENT TYPE	PRICE
Beach towel (Payable at the base) Season: 2025 - Angelina Yachtcharter. Payable at the base	No	per piece	10,00 €
e-SUP (Payable at the base) Season: 2025 - Angelina Yachtcharter. SipaBoards - Allrounder; + additional deposit 1500 EUR, order in advance due to limited quantity of equipment - Payable at the base	No	per week	270,00 €
eFoil (Payable at the base) Season: 2025 - Angelina Yachtcharter. + 3000,00 EUR refundable deposit, order in advance due to limited quantity of equipment - Payable at the base	No	per week	1.600,00 €
Extra bedlinen (Payable at the base) Season: 2025 - Angelina Yachtcharter. Payable at the base	No	per set	10,00 €
Kayak (Payable at the base) Season: 2025 - Angelina Yachtcharter. *additional deposit 250 EUR, order in advance due to limited quantity of equipment - Payable at the base	No	per week	150,00 €
Outboard engine 1 (Payable at the base) Season: 2025 - Angelina Yachtcharter. 20HP, possible on most of catamarans (includes spare tank 10l gasoline); order in advance due to limited quantity of equipment - Payable at the base	No	per week	400,00 €
Outboard engine 5 HP (Payable at the base) Season: 2025 - Angelina Yachtcharter. Special promotion, free of charge - Payable at the base	No	per booking	0,00 €
Railing net (Safety net) (Payable at the base) Season: 2025 - Angelina Yachtcharter. Rental without mounting; order in advance due to limited quantity of equipment - Payable at the base	No	per booking	30,00 €
Railing net (Safety net) (Payable at the base) Season: 2025 - Angelina Yachtcharter. order in advance due to limited quantity of equipment - Payable at the base	No	per booking	180,00 €
Seabob (Payable at the base) Season: 2025 - Angelina Yachtcharter. additional deposit 1500 EUR, order in advance due to limited quantity of equipment - Payable at the base	No	per week	1.050,00 €

Stand up paddle (SUP) (Payable at the base)

No

per week

100,00 €

Season: 2025 - Angelina Yachtcharter. *additional deposit 250 EUR, order in advance due to limited quantity of equipment - Payable at the base

Towels (Payable at the base)

No

per set

10,00 €

Season: 2025 - Angelina Yachtcharter. Payable at the base



WEBSITE

www.plujeme.cz



PHONE

+420 720 755 085



MOBILE

+420 777 170 276



E-MAIL

info@plujeme.cz



PLUJEME RÁDI S.R.O.

Dlouhá 730/35, 11000 Praha 1 – Staré Město, Czech Republic

PRICE AND AVAILABILITY

01.01. - 14.03.2025 NOT AVAILABLE	15.03. - 22.03.2025 2.322 € 2.732 €	22.03. - 29.03.2025 2.322 € 2.732 €	29.03. - 05.04.2025 2.322 € 2.732 €
05.04. - 12.04.2025 2.322 € 2.732 €	12.04. - 19.04.2025 2.322 € 2.732 €	19.04. - 26.04.2025 2.740 € 3.224 €	26.04. - 03.05.2025 2.740 € 3.224 €
03.05. - 10.05.2025 3.269 € 3.846 €	10.05. - 17.05.2025 3.896 € 4.584 €	17.05. - 24.05.2025 5.054 € 5.946 €	24.05. - 31.05.2025 6.120 € 7.200 €
31.05. - 07.06.2025 6.817 € 8.020 €	07.06. - 14.06.2025 7.253 € 8.533 €	14.06. - 21.06.2025 8.095 € 9.523 €	21.06. - 28.06.2025 8.595 € 10.112 €
28.06. - 05.07.2025 9.041 € 10.637 €	05.07. - 12.07.2025 9.041 € 10.637 €	12.07. - 19.07.2025 9.151 € 10.766 €	19.07. - 26.07.2025 9.151 € 10.766 €
26.07. - 02.08.2025 9.151 € 10.766 €			



WEBSITE
www.plujeme.cz



E-MAIL
info@plujeme.cz



PHONE
+420 720 755 085



PLUJEME RÁDI S.R.O.
Dlouhá 730/35, 11000 Praha 1 – Staré Město, Czech Republic



MOBILE
+420 777 170 276

PRICE AND AVAILABILITY

02.08. - 09.08.2025 9.151 € 10.766 €	09.08. - 16.08.2025 9.151 € 10.766 €	16.08. - 23.08.2025 7.840 € 9.223 €	23.08. - 30.08.2025 7.694 € 9.052 €
30.08. - 06.09.2025 8.010 € 8.900 €	06.09. - 13.09.2025 6.840 € 7.600 €	13.09. - 20.09.2025 NOT AVAILABLE	20.09. - 27.09.2025 NOT AVAILABLE
27.09. - 04.10.2025 3.150 € 3.500 €	04.10. - 11.10.2025 3.027 € 3.363 €	11.10. - 18.10.2025 2.795 € 3.106 €	18.10. - 25.10.2025 2.738 € 3.042 €
25.10. - 01.11.2025 2.738 € 3.042 €	01.11. - 08.11.2025 2.586 € 3.042 €	10.11. - 13.03.2026 NOT AVAILABLE	



WEBSITE

www.plujeme.cz



E-MAIL

info@plujeme.cz



PHONE

+420 720 755 085



MOBILE

+420 777 170 276



PLUJEME RÁDI S.R.O.

Dlouhá 730/35, 11000 Praha 1 – Staré Město, Czech Republic