

# SEAWIND 1160

Dc al Coda (2022)

Catamaran Seawind 1160 Dc al Coda, built in 2022 is anchored in the **Newport, Jamestown, Conanicut Marina, Rhode Island, USA**. It has **3 + 2 cabins**, can accommodate **8 + 2 people** and has **2 toilets**. Bed linen and kitchen equipment are included in the price.

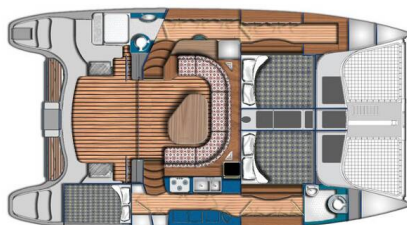

## YACHT SPECIFICATIONS

Yacht Base

**Newport, Jamestown, Conanicut Marina, USA**

Yacht ID

**6842**

Brands

**Seawind Catamarans**

Yacht name

**Dc al Coda**

Production year

**2022**

Length

**38 ft**

Cabins

**3 + 2**

Berths

**8 + 2**

Max Persons

**8**

WC

**2**

Engine

**2 x 29 HP**

Fuel tank

**268 l**



**WEBSITE**

[www.plujeme.cz](http://www.plujeme.cz)



**PHONE**

+420 720 755 085



**MOBILE**

+420 777 170 276



**E-MAIL**

[info@plujeme.cz](mailto:info@plujeme.cz)



**PLUJEME RÁDI S.R.O.**

Dlouhá 730/35, 11000 Praha 1 – Staré Město, Czech Republic

## STANDARD YACHT EQUIPMENT

Comfort	<b>Cockpit cushions</b>
Deck	<b>Bilge pump - Mechanic, Cockpit table, Cockpit/stern, outside shower, Davit, Swimming ladder, Tender</b>
Entertainment	<b>Outdoor speakers, Radio</b>
Galley	<b>Freezer, Hot water, Microwave, Oven, Refrigerator, Water pump</b>
Interior	<b>Electric toilet</b>
Navigation	<b>Autopilot, Compass, Folding propeller, GPS, GPS chart plotter, Navigation set, Radar, Radar reflector, Wind/speed/depth instruments</b>
Safety	<b>Liferaft , VHF radio</b>
Sails	<b>Electric mainsail windlass, Electric winch</b>
Yacht electrics	<b>Air Conditioning, Battery charger , Bilge pump - Electric, Inverter, Shore power connection, Watermaker - desalinator</b>



**WEBSITE**

[www.plujeme.cz](http://www.plujeme.cz)



**PHONE**

+420 720 755 085



**MOBILE**

+420 777 170 276



**E-MAIL**

[info@plujeme.cz](mailto:info@plujeme.cz)



**PLUJEME RÁDI S.R.O.**

Dlouhá 730/35, 11000 Praha 1 – Staré Město, Czech Republic

## SERVICES

SELECTED SERVICES	OBLIGATORY	PAYMENT TYPE	PRICE
<b>BVI Cruising Tax</b> (Payable at the base) <b>Season: 2024.</b>	Yes	per guest/day	<b>4,00 €</b>
<b>Divers inspection</b> (Payable at the base) <b>Season: 2024.</b> upon return	Yes	per booking	<b>95,00 €</b>
<b>Final cleaning</b> (Payable at the base) <b>Season: 2024.</b>	Yes	per booking	<b>400,00 €</b>
<b>National Park Mooring Permit Tortola</b> (Payable at the base) <b>Season: 2024.</b> 25 USD per person/week up to 4 pax 35 USD per person/week for 5 - 6 pax 45 USD per person/week for 7 to 8 pax 55 USD per person/week from 9 pax	Yes	per guest/week	<b>55,00 €</b>
<b>Sales Tax</b> (Payable now) <b>Season: 2024.</b>	Yes	per booking	<b>0,00 €</b>
<b>Search &amp; Sea rescue</b> (Payable at the base) <b>Season: 2024.</b>	Yes	per booking	<b>10,00 €</b>
<b>Yacht Insurance</b> (Payable at the base) <b>Season: 2024.</b>	Yes	per day	<b>50,00 €</b>
<b>Captain</b> (Payable at the base) <b>Season: 2024.</b>	Yes	per day + food	<b>400,00 €</b>
<b>Cook</b> (Payable at the base) <b>Season: 2024.</b>	Yes	per day + food	<b>350,00 €</b>
<b>First Mate</b> (Payable at the base) <b>Season: 2024.</b>	Yes	per day + food	<b>250,00 €</b>
<b>Sleep over before check in</b> (Payable at the base) <b>Season: 2024.</b>	Yes	per booking	<b>400,00 €</b>



**WEBSITE**  
www.plujeme.cz



**PHONE**  
+420 720 755 085



**MOBILE**  
+420 777 170 276



**E-MAIL**  
info@plujeme.cz



**PLUJEME RÁDI S.R.O.**  
Dlouhá 730/35, 11000 Praha 1 – Staré Město, Czech Republic

## ADDITIONAL EXTRAS

EXTRA	OBLIGATORY	PAYMENT TYPE	PRICE
<b>Stand up paddle (SUP)</b> <i>(Payable at the base)</i> <b>Season: 2024.</b> <i>Payable at the base</i>	Yes	per day	<b>25,00 €</b>



#### WEBSITE

[www.plujeme.cz](http://www.plujeme.cz)



#### E-MAIL

[info@plujeme.cz](mailto:info@plujeme.cz)



#### PHONE

+420 720 755 085



#### MOBILE

+420 777 170 276



#### PLUJEME RÁDI S.R.O.

Dlouhá 730/35, 11000 Praha 1 – Staré Město, Czech Republic

## PRICE AND AVAILABILITY

21.09. - 28.09.2024 5.525 €	28.09. - 05.10.2024 5.525 €	05.10. - 12.10.2024 5.525 €	12.10. - 19.10.2024 5.525 €
20.10. - 31.10.2024 NOT AVAILABLE	01.11. - 13.11.2024 NOT AVAILABLE	16.11. - 23.11.2024 5.985 €	23.11. - 30.11.2024 5.985 €
30.11. - 07.12.2024 5.985 €	07.12. - 14.12.2024 5.985 €	14.12. - 21.12.2024 6.301 €	21.12. - 28.12.2024 6.722 €



### WEBSITE

[www.plujeme.cz](http://www.plujeme.cz)



### E-MAIL

[info@plujeme.cz](mailto:info@plujeme.cz)



### PHONE

+420 720 755 085



### MOBILE

+420 777 170 276



### PLUJEME RÁDI S.R.O.

Dlouhá 730/35, 11000 Praha 1 – Staré Město, Czech Republic