

BALI 4.6

TUBEROSE (2024)

Catamaran Bali 4.6 TUBEROSE, built in 2024 is anchored in the Guadeloupe, La Marina Bas du Fort, Guadeloupe, Caribbean. It has 5 + 2 cabins, can accommodate 10 + 2 people and has 4 toilets. Bed linen and kitchen equipment are included in the price.

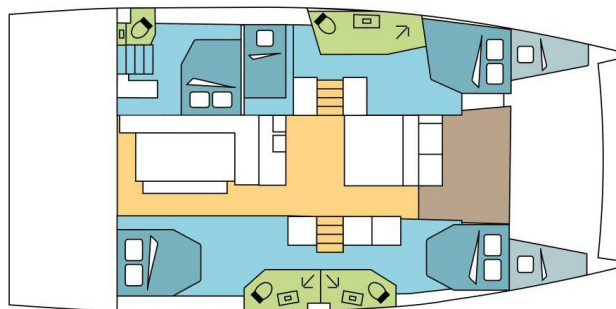

YACHT SPECIFICATIONS

Yacht Base

**Guadeloupe, La Marina Bas du Fort,
Caribbean**

Yacht ID

6441

Brands

Catana

Yacht name

TUBEROSE

Production year

2024

Length

47 ft

Cabins

5 + 2

Berths

10 + 2

Max Persons

12

WC

4

Engine

2 x 57 HP

Fuel tank

800 l



WEBSITE

www.plujeme.cz



PHONE

+420 720 755 085



MOBILE

+420 777 170 276



E-MAIL

info@plujeme.cz



PLUJEME RÁDI S.R.O.

Dlouhá 730/35, 11000 Praha 1 – Staré Město, Czech Republic

STANDARD YACHT EQUIPMENT

Comfort	Cockpit cushions, Mosquito nets
Deck	Bimini top, Cockpit table, Cockpit/stern, outside shower, Davit, Electric anchor windlass, Flybridge, Grill/Barbecue/Plancha, Remote control for anchor winch with chain counter at helm, Swimming ladder
Entertainment	Fusion radio
Galley	Oven, Refrigerator
Interior	Electric fans in cabins, Electric toilet
Navigation	AIS, Autopilot, Depthsounder, GPS chart plotter, Speedometer (Speed log)
Safety	VHF radio
Sails	Electric main sail winch, Lazy bag, Lazy jacks
Yacht electrics	230 volt socket, Air Conditioning, Alternator, Battery charger , Generator, Inverter, Service batteries, Solar panels, Watermaker - desalinator



WEBSITE

www.plujeme.cz



E-MAIL

info@plujeme.cz



PHONE

+420 720 755 085



MOBILE

+420 777 170 276



PLUJEME RÁDI S.R.O.

Dlouhá 730/35, 11000 Praha 1 – Staré Město, Czech Republic

SERVICES

SELECTED SERVICES	OBLIGATORY	PAYMENT TYPE	PRICE
Essentials pack (Payable now) Season: 2026 Exotic. INCLUDED: full reduction of security deposit (0 € at base)// starter pack – (1 gallon water or 4 bottles of 1.5L, 1 bottle of disinfectant, 1 small bottle of washing up liquid, 1 dish cloth, 1 sponge, garbage bags, 1 roll of paper towels, 1 box of matches, 1 roll of toilet paper in each head)// final cleaning // 1 set of bed sheets & towels, dinghy, outboard engine & initial supply of fuel, gas and water tanks// DYC assistance guarantee // 1st & last night in the marina /// NOT INCLUDED: refuelling, gas & water consumption at end of charter, taxes if any, handling fees, additional equipment deposit	Yes	per booking	815,00 €
Handling fees (Payable now) Season: 2026 Exotic.	Yes	per booking	35,00 €
Crew change (Payable now) Season: 2026 Exotic. Any crew change during the charter is subject to € 200.- additional cost. The charge includes administration cost, change of bed linen and towels and one night at DYC ponton (marina fee included only if the same base than start base). It doesn't include cleaning, nor new transit log where applicable.	No	per booking	200,00 €
Diving (Payable now) Season: 2026 Exotic. For bareboat charters only Upon request	No	per booking	0,00 €
Early boarding/check-in (Payable now) Season: 2026 Exotic. EB (boat only) - 14:00 h / 2 PM starting time of boat's delivery // limited number of early boardings on same departure day	No	per booking	480,00 €
Early boarding/check-in (Payable now) Season: 2026 Exotic. EB boat + extra fee skipper - 14:00 h / 2 PM starting time of boat's delivery // limited number of early boardings on same departure day	No	per booking	700,00 €
Early boarding/check-in (Payable now) Season: 2026 Exotic. EB + extra fee Skipper & Hostes - 14:00 h / 2 PM starting time of boat's delivery // limited number of early boardings on same departure day	No	per booking	885,00 €

Electric & Water consumption in the Marinas (Payable at the base) Season: 2026 Exotic. Electric & Water consumption based on 2 nights on our dock (base will confirm the amount to pay locally depending on nights spent on dock)	No	per booking	36,00 €
Extra set of linen (choose how many) (Payable now) Season: 2026 Exotic. Extra set of linen : 15 € 1 set of linen (2 sheets & 2 pillow case) - to be updated manually	No	per booking	15,00 €
Extra set of towels (choose how many) (Payable now) Season: 2026 Exotic. Extra set of towels: 10 € 1 set of towels (1 face & 1 bath towel) - to be updated manually	No	per booking	10,00 €
Final cleaning (Payable now) Season: 2026 Exotic. included in Essentials pack	No	per booking	340,00 €
Full board 1-4 pax (number of guests to update manually) (Payable now) Season: 2026 Exotic. only available if cook is booked on board as the cook will do the provisioning based on client's preference. Includes breakfast, lunch & dinner + the crew's food. Does not included alcoholic drinks	No	per guest/day	65,00 €
Full board 5-12 pax (number of guests to update manually) (Payable now) Season: 2026 Exotic. only available if cook is booked on board as the cook will do the provisioning based on client's preference. Includes breakfast, lunch & dinner + the crew's food. Does not included alcoholic drinks	No	per guest/day	60,00 €
Half board 1-4 pax (number of guests to update manually) (Payable now) Season: 2026 Exotic. only available if cook is booked on board as the cook will do the provisioning based on client's preference. Includes breakfast & lunch OR dinner + the crew's food. Does not included alcoholic drinks	No	per guest/day	55,00 €
Half board 5-12 pax (number of guests to update manually) (Payable now) Season: 2026 Exotic. only available if cook is booked on board as the cook will do the provisioning based on client's preference. Includes breakfast & lunch OR dinner + the crew's food. Does not included alcoholic drinks	No	per guest/day	50,00 €
Hostess (Payable now) Season: 2026 Exotic. + provisioning, a cabin or forepeak to sleep and access to a WC/Shower	No	per night	200,00 €
Race pack (Payable now) Season: 2026 Exotic. BVI Spring Regatta, Briefing before the race, preparation and gauging of sails, registration of the yacht (not of the passengers), technical assistance during the race *** technical assistance during the race not valid for RORC Caribbean 600 // A special race deposit need to be doubled manually once the race fee is added.	No	per booking	1.320,00 €

Race pack (Payable now)	No	per booking	1.650,00 €
Season: 2026 Exotic. Antigua, Briefing before the race, preparation and gauging of sails, registration of the yacht (not of the passengers), technical assistance during the race *** technical assistance during the race not valid for RORC Caribbean 600 // A special race deposit need to be doubled manually once the race fee is added.			
Race pack (Payable now)	No	per booking	1.650,00 €
Season: 2026 Exotic. RORC caribbean 600, Briefing before the race, preparation and gauging of sails, registration of the yacht (not of the passengers), technical assistance during the race *** technical assistance during the race not valid for RORC Caribbean 600 // A special race deposit need to be doubled manually once the race fee is added.			
Regatta surcharge (Payable now)	No	per booking	2.150,00 €
Season: 2026 Exotic. valid for ASW regatta only // A special race deposit need to be doubled manually once the regatta surcharge is added.			
Regatta surcharge (Payable now)	No	per booking	0,00 €
Season: 2026 Exotic. all the regattas apart of ASW (different regatta surcharge for ASW) // A special race deposit need to be doubled manually once the regatta surcharge is added.			
Same day briefing (Payable now)	No	per booking	150,00 €
Season: 2026 Exotic. Same day briefing starting between 5 & 5.30pm (departure following morning)			
Skipper (Payable now)	No	per night	260,00 €
Season: 2026 Exotic. + provisioning, a cabin or forepeak to sleep and access to a WC/Shower			
Starter pack (Payable now)	No	per booking	50,00 €
Season: 2026 Exotic. included in Essentials pack (The pack includes: 1 gallon water (or 4 bottles of 1.5L), 1 bottle of disinfectant, 1 small bottle of washing up liquid, 1 dish cloth, 1 sponge, garbage bags, 1 roll of paper towels, 1 box of matches, 1 roll of toilet paper in each head)			
Transfer (Payable now)	No	one-way	49,50 €
Season: 2026 Exotic. OW - Airport/Base (1-4 pax)			
Transfer (Payable now)	No	one-way	65,00 €
Season: 2026 Exotic. OW - Airport/Base (5-8 pax)			
Transfer (Payable now)	No	round trip	99,00 €
Season: 2026 Exotic. RT - Guadeloupe airport/base/airport (1-4 pax)			

Transfer (Payable now)	No	one-way	130,00 €
Season: 2026 Exotic. OW - Airport/Base (9-12 pax)			
Transfer (Payable now)	No	round trip	130,00 €
Season: 2026 Exotic. RT - Guadeloupe - Airport/Base/Airport (5-8 pax)			
Transfer (Payable now)	No	round trip	260,00 €
Season: 2026 Exotic. RT - Airport/Base/Airport (9-12 pax)			



WEBSITE
www.plujeme.cz



PHONE
+420 720 755 085



MOBILE
+420 777 170 276



E-MAIL
info@plujeme.cz



PLUJEME RÁDI S.R.O.
Dlouhá 730/35, 11000 Praha 1 - Staré Město, Czech Republic

ADDITIONAL EXTRAS

EXTRA	OBLIGATORY	PAYMENT TYPE	PRICE
Fishing equipment (Payable now) Season: 2026 Exotic. Additional deposit 100 EUR (subject to availability) - Payable now	No	per day	15,00 €
Kayak single (Payable now) Season: 2026 Exotic. price per day - Additional deposit 100 EUR - Payable now	No	per night	15,00 €
Kayak tandem (Payable now) Season: 2026 Exotic. price per day - Additional deposit 100 EUR - Payable now	No	per night	15,00 €
Outboard engine 8 & 9,8 HP (Payable now) Season: 2026 Exotic. Dinghy not suitable in any case for waterski or wakeboard. Additional security deposit of 500 € on outboard engines. A powerboat licence is mandatory in French territories to drive a dinghy with an outboard more powerful than 6hp. It's client responsibility to ensure to have the right powerboat licence when renting a more powerful outboard. In case the needed licence is not presented at base, it will not be possible to use this larger outboard which will not be refunded - Payable now	No	per day	35,00 €
Railing net (Safety net) (Payable now) Season: 2026 Exotic. net is supplied but not installed - Payable now	No	per booking	300,00 €
Stand up paddle (SUP) (Payable now) Season: 2026 Exotic. Price per day - Additional deposit 100 EUR - Payable now	No	per night	15,00 €



WEBSITE
www.plujeme.cz



PHONE
+420 720 755 085



MOBILE
+420 777 170 276



E-MAIL
info@plujeme.cz



PLUJEME RÁDI S.R.O.
Dlouhá 730/35, 11000 Praha 1 - Staré Město, Czech Republic

PRICE AND AVAILABILITY

18.10. - 02.11.2024 NOT AVAILABLE	02.11. - 09.11.2024 4.114 € 4.840 €	09.11. - 16.11.2024 NOT AVAILABLE	16.11. - 23.11.2024 4.114 € 4.840 €
23.11. - 30.11.2024 NOT AVAILABLE	03.12. - 17.12.2024 NOT AVAILABLE	22.12. - 29.12.2024 NOT AVAILABLE	29.12. - 02.01.2025 ON OPTION
02.01. - 11.01.2025 NOT AVAILABLE	11.01. - 18.01.2025 8.755 € 10.300 €	18.01. - 25.01.2025 8.993 € 10.580 €	25.01. - 01.02.2025 8.993 € 10.580 €
01.02. - 08.02.2025 8.993 € 10.580 €	08.02. - 15.02.2025 8.993 € 10.580 €	15.02. - 22.02.2025 8.993 € 10.580 €	22.02. - 01.03.2025 9.847 € 11.585 €
02.03. - 09.03.2025 NOT AVAILABLE	15.03. - 22.03.2025 9.057 € 10.655 €	22.03. - 05.04.2025 NOT AVAILABLE	05.04. - 12.04.2025 6.664 € 7.840 €
12.04. - 19.04.2025 7.174 € 8.440 €	19.04. - 03.05.2025 NOT AVAILABLE	03.05. - 10.05.2025 6.129 € 7.150 €	10.05. - 24.05.2025 NOT AVAILABLE
24.05. - 31.05.2025 NOT AVAILABLE	31.05. - 07.06.2025 4.924 € 5.745 €		



WEBSITE

www.plujeme.cz



E-MAIL

info@plujeme.cz



PHONE

+420 720 755 085



MOBILE

+420 777 170 276



PLUJEME RÁDI S.R.O.

Dlouhá 730/35, 11000 Praha 1 – Staré Město, Czech Republic

PRICE AND AVAILABILITY

07.06. - 14.06.2025 4.800 € 5.600 €	14.06. - 21.06.2025 4.800 € 5.600 €	21.06. - 28.06.2025 5.001 € 5.835 €	28.06. - 05.07.2025 5.001 € 5.835 €
05.07. - 12.07.2025 5.824 € 6.795 €	12.07. - 19.07.2025 6.403 € 7.470 €	19.07. - 26.07.2025 6.403 € 7.470 €	26.07. - 02.08.2025 7.526 € 8.780 €
02.08. - 09.08.2025 7.526 € 8.780 €	09.08. - 16.08.2025 5.794 € 6.760 €	16.08. - 23.08.2025 4.054 € 4.730 €	23.08. - 30.08.2025 4.054 € 4.730 €
30.08. - 06.09.2025 3.831 € 4.470 €	06.09. - 13.09.2025 3.831 € 4.470 €	13.09. - 20.09.2025 3.831 € 4.470 €	20.09. - 27.09.2025 3.831 € 4.470 €
27.09. - 04.10.2025 3.831 € 4.470 €	04.10. - 11.10.2025 3.849 € 4.490 €	11.10. - 18.10.2025 4.479 € 4.715 €	18.10. - 25.10.2025 4.731 € 4.980 €
25.10. - 01.11.2025 4.731 € 4.980 €	01.11. - 08.11.2025 4.712 € 4.960 €	08.11. - 15.11.2025 5.244 € 5.520 €	15.11. - 22.11.2025 6.037 € 6.355 €
22.11. - 29.11.2025 6.037 € 6.355 €	29.11. - 06.12.2025 6.522 € 6.865 €	06.12. - 13.12.2025 6.175 € 6.500 €	13.12. - 20.12.2025 6.175 € 6.500 €
20.12. - 27.12.2025 11.785 € 12.405 €			



WEBSITE

www.plujeme.cz



E-MAIL

info@plujeme.cz



PHONE

+420 720 755 085



MOBILE

+420 777 170 276



PLUJEME RÁDI S.R.O.

Dlouhá 730/35, 11000 Praha 1 – Staré Město, Czech Republic