

# LAGOON 42

Fleur de Sel (2018)

Catamaran Lagoon 42 Fleur de Sel, built in 2018 is anchored in the Marina Tehnomont Veruda, Pula, Istra, Croatia. It has 4 + 2 cabins, can accommodate 8 + 2 + 2 people and has 4 toilets. Bed linen and kitchen equipment are included in the price.

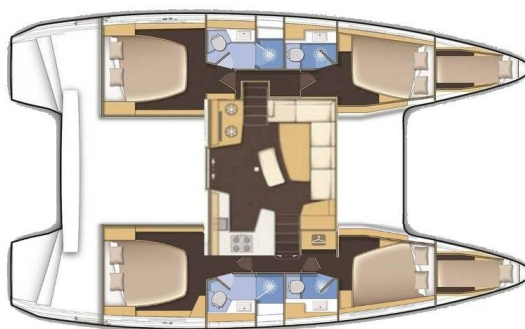

## YACHT SPECIFICATIONS

Yacht Base

**Marina Tehnomont Veruda, Pula, Croatia**

Yacht ID

**6429**

Brands

**Lagoon**

Yacht name

**Fleur de Sel**

Production year

**2018**

Length

**42 ft**

Cabins

**4 + 2**

Berths

**8 + 2 + 2**

WC

**4**

Engine

**2 x 27 HP**

Fuel tank

**300 l**



**WEBSITE**

[www.plujeme.cz](http://www.plujeme.cz)



**PHONE**

+420 720 755 085



**MOBILE**

+420 777 170 276



**E-MAIL**

[info@plujeme.cz](mailto:info@plujeme.cz)



**PLUJEME RÁDI S.R.O.**

Dlouhá 730/35, 11000 Praha 1 – Staré Město, Czech Republic

## STANDARD YACHT EQUIPMENT

Comfort	<b>Cockpit cushions</b>
Deck	<b>Bathing platform, Bimini top, Cockpit/stern, outside shower, Dinghy, Electric anchor windlass, Fenders, Gangway, Main Deck Compass, Sprayhood</b>
Entertainment	<b>CD player</b>
Galley	<b>Gas bottles, Hot water, Oven, Refrigerator</b>
Interior	<b>Convertible table</b>
Navigation	<b>Autopilot, Compass, GPS chart plotter - cockpit, Log, Speed, Depth- echo sounder, Nautical charts, Navigation set, Wind instrument/Anemometer</b>
Safety	<b>Black Water Tank, Fire extinguisher , First aid kit , Flashlight, Set of tools , VHF radio</b>
Yacht electrics	<b>Batteries, Shore connection 220 V</b>



#### WEBSITE

[www.plujeme.cz](http://www.plujeme.cz)



#### E-MAIL

[info@plujeme.cz](mailto:info@plujeme.cz)



#### PHONE

+420 720 755 085



#### MOBILE

+420 777 170 276



#### PLUJEME RÁDI S.R.O.

Dlouhá 730/35, 11000 Praha 1 – Staré Město, Czech Republic

## SERVICES

SELECTED SERVICES	OBLIGATORY	PAYMENT TYPE	PRICE
<b>Service Pack</b> (Payable at the base) <b>Season: 2025.</b> end-cleaning, water / 1x cooking gas bottle at the departure, batteries, linen equipment for each crew member, production of documents and registration, 1 towel/person, outboard engine and Wi-Fi	Yes	per booking	<b>500,00 €</b>
<b>Early boarding/check-in</b> (Payable at the base) <b>Season: 2025.</b> (at 13:00)(Limited availability)	No	per booking	<b>300,00 €</b>
<b>Flotilla fee</b> (Payable at the base) <b>Season: 2025.</b> price on request	No	per booking	<b>0,00 €</b>
<b>Hostess</b> (Payable at the base) <b>Season: 2025.</b> Hostess' meals are not included and are covered by the customer	No	per day	<b>160,00 €</b>
<b>Non refundable deposit/ insurance</b> (Payable at the base) <b>Season: 2025.</b> (Risk & security deposit is limited to € 595) – with refundable Security Deposit 595 €	No	per day	<b>35,00 €</b>
<b>Non refundable deposit/ insurance</b> (Payable at the base) <b>Season: 2025.</b> full cover, Minimum Charge: 7 days	No	per day	<b>45,00 €</b>
<b>Pet on board</b> (Payable at the base) <b>Season: 2025.</b> allowed, extra cleaning - PRICE ON REQUEST	No	per booking	<b>0,00 €</b>
<b>Skipper</b> (Payable at the base) <b>Season: 2025.</b> (25% charge applicable if skipper is cancelled in less than 4 weeks before departure), skipper's meals are not included and are covered by the customer	No	per day + food	<b>200,00 €</b>
<b>Starter pack</b> (Payable at the base) <b>Season: 2025.</b> (Dishwashing liquid, sponge, rubbish bags, matches, toilet and kitchen rolls, fruit plate, water, orange juice, wine, packet of biscuits, individual sachets of tea, coffee, sugar, milk)	No	per booking	<b>50,00 €</b>
<b>Taxi</b> (Payable at the base) <b>Season: 2025.</b> PRICE ON REQUEST	No	per booking	<b>0,00 €</b>
<b>Transfer</b> (Payable at the base) <b>Season: 2025.</b> (available, PRICE ON REQUEST)	No	per booking	<b>0,00 €</b>



**WEBSITE**

[www.plujeme.cz](http://www.plujeme.cz)



**PHONE**

+420 720 755 085



**MOBILE**

+420 777 170 276



**E-MAIL**

[info@plujeme.cz](mailto:info@plujeme.cz)



**PLUJEME RÁDI S.R.O.**

Dlouhá 730/35, 11000 Praha 1 – Staré Město, Czech Republic

**Plujeme**

## ADDITIONAL EXTRAS

EXTRA	OBLIGATORY	PAYMENT TYPE	PRICE
<b>Additional gas bottle</b> (Payable at the base) <b>Season: 2025.</b> Payable at the base	No	per piece	<b>10,00 €</b>
<b>Beach towel</b> (Payable at the base) <b>Season: 2025.</b> Payable at the base	No	per person	<b>10,00 €</b>
<b>Extra bedlinen</b> (Payable at the base) <b>Season: 2025.</b> Payable at the base	No	per person	<b>10,00 €</b>
<b>Extra towels</b> (Payable at the base) <b>Season: 2025.</b> Payable at the base	No	per week/ person	<b>5,00 €</b>
<b>Gennaker</b> (Payable at the base) <b>Season: 2025.</b> asymmetric spinnaker (mps), on request, not available for all yachts - Payable at the base	No	per week	<b>200,00 €</b>
<b>Grill/Barbecue/Plancha</b> (Payable at the base) <b>Season: 2025.</b> Payable at the base	No	per week	<b>100,00 €</b>
<b>Railing net (Safety net)</b> (Payable at the base) <b>Season: 2025.</b> Payable at the base	No	per booking	<b>150,00 €</b>
<b>Stand up paddle (SUP)</b> (Payable at the base) <b>Season: 2025.</b> Payable at the base	No	per week	<b>130,00 €</b>



**WEBSITE**  
www.plujeme.cz



**E-MAIL**  
info@plujeme.cz



**PHONE**  
+420 720 755 085



**MOBILE**  
+420 777 170 276



**PLUJEME RÁDI S.R.O.**  
Dlouhá 730/35, 11000 Praha 1 – Staré Město, Czech Republic