

BALI 4.6

APRES SAIL II (2025)

Catamaran Bali 4.6 APRES SAIL II, built in 2025 is anchored in the **Belize, Placencia, Roberts Grove Marina, Belize, Belize**. It has **5 + 2 cabins**, can accommodate **10 + 2 people** and has **4 toilets**. Bed linen and kitchen equipment are included in the price.

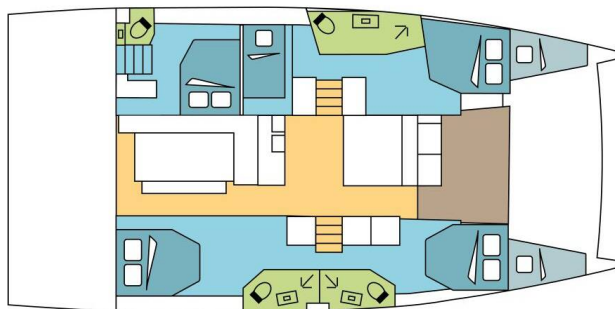

YACHT SPECIFICATIONS

Yacht Base

Belize, Placencia, Roberts Grove Marina, Belize

Yacht ID

5847

Brands

Catana

Yacht name

APRES SAIL II

Production year

2025

Length

47 ft

Cabins

5 + 2

Berths

10 + 2

Max Persons

12

WC

4

Engine

2 x 57 HP

Fuel tank

800 l



WEBSITE

www.plujeme.cz



PHONE

+420 720 755 085



MOBILE

+420 777 170 276



E-MAIL

info@plujeme.cz



PLUJEME RÁDI S.R.O.

Dlouhá 730/35, 11000 Praha 1 – Staré Město, Czech Republic

STANDARD YACHT EQUIPMENT

Comfort	Cockpit seat cushions with backrest, Mosquito nets, Sun loungers
Deck	Bimini top, Cockpit table, Cockpit/stern, outside shower, Davit, Electric anchor windlass, Flybridge, Forward cockpit, Grill/Barbecue/Plancha, Remote control for anchor winch with chain counter at helm, Swimming ladder
Entertainment	Fusion radio
Galley	Freezer, Oven
Interior	Electric fans, Electric toilet
Navigation	AIS, Autopilot, GPS chart plotter, Log, Speed, Depth- echo sounder, Wind instrument/Anemometer
Safety	VHF radio
Sails	Electric main sail winch, Lazy bag, Lazy jacks
Yacht electrics	Air Conditioning, Battery charger , Generator, Inverter, Service batteries, Solar panels, Watermaker - desalinator



WEBSITE

www.plujeme.cz



PHONE

+420 720 755 085



MOBILE

+420 777 170 276



E-MAIL

info@plujeme.cz



PLUJEME RÁDI S.R.O.

Dlouhá 730/35, 11000 Praha 1 – Staré Město, Czech Republic

SERVICES

SELECTED SERVICES	OBLIGATORY	PAYMENT TYPE	PRICE
Belize Taxes (Payable now) Season: 2026 Exotic.	Yes	per booking	0,00 €
Essentials pack (Payable now) Season: 2026 Exotic. INCLUDED: full reduction of security deposit (0 € at base)// starter pack – (1 gallon water or 4 bottles of 1.5L, 1 bottle of disinfectant, 1 small bottle of washing up liquid, 1 dish cloth, 1 sponge, garbage bags, 1 roll of paper towels, 1 box of matches, 1 roll of toilet paper in each head)// final cleaning // 1 set of bed sheets & towels, dinghy, outboard engine & initial supply of fuel, gas and water tanks// DYC assistance guarantee // 1st & last night in the marina /// NOT INCLUDED: refuelling, gas & water consumption at end of charter, taxes if any, handling fees, additional equipment deposit	Yes	per booking	945,00 €
Handling fees (Payable now) Season: 2026 Exotic.	Yes	per booking	35,00 €
Temporary Belize Skipper Certificate fee (Payable now) Season: 2026 Exotic. + provisioning, a cabin or forepeak to sleep and access to a WC/Shower	Yes	per booking	17,00 €
Crew change (Payable now) Season: 2026 Exotic. Any crew change during the charter is subject to € 200.- additional cost. The charge includes administration cost, change of bed linen and towels and one night at DYC ponton (marina fee included only if the same base than start base). It doesn't include cleaning, nor new transit log where applicable.	No	per booking	200,00 €
Early boarding/check-in (Payable now) Season: 2026 Exotic. EB (boat only) - 14:00 h / 2 PM starting time of boat's delivery // limited number of early boardings on same departure day	No	per booking	480,00 €
Early boarding/check-in (Payable now) Season: 2026 Exotic. EB boat + extra fee skipper - 14:00 h / 2 PM starting time of boat's delivery // limited number of early boardings on same departure day	No	per booking	620,00 €

Early boarding/check-in (Payable now)	No	per booking	730,00 €
Season: 2026 Exotic. EB + extra fee Skipper & Hostes - 14:00 h / 2 PM starting time of boat's delivery // limited number of early boardings on same departure day			
Electric & Water consumption in the Marinas (Payable at the base)	No	per booking	36,00 €
Season: 2026 Exotic. Electric & Water consumption based on 2 nights on our dock (base will confirm the amount to pay locally depending on nights spent on dock)			
Extra set of linen (choose how many) (Payable now)	No	per booking	15,00 €
Season: 2026 Exotic. Extra set of linen : 15 € 1 set of linen (2 sheets & 2 pillow case) - to be updated manually			
Extra set of towels (choose how many) (Payable now)	No	per booking	10,00 €
Season: 2026 Exotic. Extra set of towels: 10 € 1 set of towels (1 face & 1 bath towel) - to be updated manually			
Final cleaning (Payable now)	No	per booking	340,00 €
Season: 2026 Exotic. included in Essentials pack			
Full board 1-4 pax (number of guests to update manually) (Payable now)	No	per guest/day	65,00 €
Season: 2026 Exotic. only available if cook is booked on board as the cook will do the provisioning based on client's preference. Includes breakfast, lunch & dinner + the crew's food. Does not included alcoholic drinks			
Full board 5-12 pax (number of guests to update manually) (Payable now)	No	per guest/day	60,00 €
Season: 2026 Exotic. only available if cook is booked on board as the cook will do the provisioning based on client's preference. Includes breakfast, lunch & dinner + the crew's food. Does not included alcoholic drinks			
Hostess (Payable now)	No	per night	110,00 €
Season: 2026 Exotic. + provisioning, a cabin or forepeak to sleep and access to a WC/Shower			
Regatta surcharge (Payable now)	No	per booking	0,00 €
Season: 2026 Exotic. all the regattas apart of ASW (different regatta surcharge for ASW) // A special race deposit need to be doubled manually once the regatta surcharge is added.			
Same day briefing (Payable now)	No	per booking	150,00 €
Season: 2026 Exotic. Same day briefing starting between 5 & 5.30pm (departure following morning)			

Skipper (Payable now)	No	per night	140,00 €
Season: 2026 Exotic. + provisioning, a cabin or forepeak to sleep and access to a WC/Shower			
Starter pack (Payable now)	No	per booking	50,00 €
Season: 2026 Exotic. included in Essentials pack (The pack includes: 1 gallon water (or 4 bottles of 1.5L), 1 bottle of disinfectant, 1 small bottle of washing up liquid, 1 dish cloth, 1 sponge, garbage bags, 1 roll of paper towels, 1 box of matches, 1 roll of toilet paper in each head)			
Transfer (Payable now)	No	one-way	7,00 €
Season: 2026 Exotic. OW - Placencia airport/base/airport + additional per pax			
Transfer (Payable now)	No	one-way	16,00 €
Season: 2026 Exotic. OW - 1 - 2 pax from/to airport Placencia - base			
Transfer (Payable now)	No	one-way	86,00 €
Season: 2026 Exotic. OW - Belize City airport/base/airport - additional per pax			
Transfer (Payable now)	No	one-way	555,00 €
Season: 2026 Exotic. OW - 1 - 5 pax from/to airport Belize City - base			



WEBSITE

www.plujeme.cz



E-MAIL

info@plujeme.cz



PHONE

+420 720 755 085



MOBILE

+420 777 170 276



PLUJEME RÁDI S.R.O.

Dlouhá 730/35, 11000 Praha 1 - Staré Město, Czech Republic

ADDITIONAL EXTRAS

EXTRA	OBLIGATORY	PAYMENT TYPE	PRICE
Fishing equipment (Payable now) Season: 2026 Exotic. Additional deposit 100 EUR (subject to availability) - Payable now	No	per day	15,00 €
Kayak single (Payable now) Season: 2026 Exotic. price per day - Additional deposit 100 EUR - Payable now	No	per night	15,00 €
Kayak tandem (Payable now) Season: 2026 Exotic. price per day - Additional deposit 100 EUR - Payable now	No	per night	15,00 €
Outboard engine 8 & 9,8 HP (Payable now) Season: 2026 Exotic. Dinghy not suitable in any case for waterski or wakeboard. Additional security deposit of 500 € - Payable now	No	per day	35,00 €
Railing net (Safety net) (Payable now) Season: 2026 Exotic. net is supplied but not installed - Payable now	No	per booking	300,00 €
Stand up paddle (SUP) (Payable now) Season: 2026 Exotic. Price per day - Additional deposit 100 EUR - Payable now	No	per night	15,00 €



WEBSITE
www.plujeme.cz



PHONE
+420 720 755 085



MOBILE
+420 777 170 276



E-MAIL
info@plujeme.cz



PLUJEME RÁDI S.R.O.
Dlouhá 730/35, 11000 Praha 1 – Staré Město, Czech Republic

PRICE AND AVAILABILITY

11.01. - 18.01.2025 9.656 € 11.360 €	24.01. - 01.02.2025 NOT AVAILABLE	01.02. - 08.02.2025 8.691 € 10.225 €	09.02. - 03.03.2025 NOT AVAILABLE
03.03. - 10.03.2025 NOT AVAILABLE	15.03. - 22.03.2025 10.255 € 12.065 €	22.03. - 29.03.2025 10.255 € 12.065 €	29.03. - 12.04.2025 NOT AVAILABLE
18.04. - 26.04.2025 NOT AVAILABLE	26.04. - 03.05.2025 11.160 €	03.05. - 10.05.2025 9.370 €	10.05. - 17.05.2025 8.520 €
17.05. - 24.05.2025 8.945 €	24.05. - 31.05.2025 8.520 €	31.05. - 07.06.2025 7.825 €	07.06. - 14.06.2025 7.805 €
14.06. - 07.07.2025 NOT AVAILABLE	12.07. - 19.07.2025 7.040 € 7.410 €	19.07. - 26.07.2025 7.040 € 7.410 €	26.07. - 02.08.2025 6.009 € 6.325 €



WEBSITE

www.plujeme.cz



E-MAIL

info@plujeme.cz



PHONE

+420 720 755 085



MOBILE

+420 777 170 276



PLUJEME RÁDI S.R.O.

Dlouhá 730/35, 11000 Praha 1 – Staré Město, Czech Republic

PRICE AND AVAILABILITY

02.08. - 09.08.2025 5.529 € 5.820 €	09.08. - 16.08.2025 5.320 € 5.600 €	16.08. - 23.08.2025 4.788 € 5.040 €	23.08. - 30.08.2025 4.788 € 5.040 €
30.08. - 06.09.2025 4.788 € 5.040 €	06.09. - 13.09.2025 4.788 € 5.040 €	13.09. - 20.09.2025 4.788 € 5.040 €	20.09. - 27.09.2025 4.788 € 5.040 €
27.09. - 04.10.2025 4.788 € 5.040 €	04.10. - 11.10.2025 4.788 € 5.040 €	11.10. - 18.10.2025 5.254 € 5.530 €	18.10. - 25.10.2025 5.648 € 5.945 €
25.10. - 01.11.2025 5.971 € 6.285 €	01.11. - 11.11.2025 NOT AVAILABLE	15.11. - 22.11.2025 7.206 € 7.585 €	22.11. - 29.11.2025 7.562 € 7.960 €
29.11. - 06.12.2025 6.484 € 6.825 €	06.12. - 13.12.2025 6.484 € 6.825 €	13.12. - 20.12.2025 7.206 € 7.585 €	20.12. - 27.12.2025 14.602 € 15.370 €



WEBSITE

www.plujeme.cz



E-MAIL

info@plujeme.cz



PHONE

+420 720 755 085



MOBILE

+420 777 170 276



PLUJEME RÁDI S.R.O.

Dlouhá 730/35, 11000 Praha 1 – Staré Město, Czech Republic