

# FOUNTAINE PAJOT ISLA 40

Almiriki (2023)

Catamaran Fountaine Pajot Isla 40 Almiriki, built in 2023 is anchored in the **Paros, Cyclades, Greece**. It has **4 + 1 cabins**, can accommodate **8 + 1 + 1 people** and has **4 toilets**. Bed linen and kitchen equipment are included in the price.

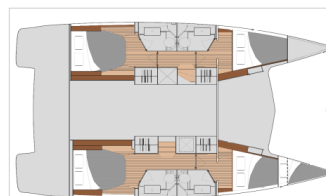

## YACHT SPECIFICATIONS

Yacht Base

**Paros, Greece**

Yacht ID

**5744**

Brands

**Fountaine Pajot**

Yacht name

**Almiriki**

Production year

**2023**

Length

**39 ft**

Cabins

**4 + 1**

Berths

**8 + 1 + 1**

Max Persons

**10**

WC

**4**

Engine

**2 x 30 HP**

Fuel tank

**300 l**



**WEBSITE**

[www.plujeme.cz](http://www.plujeme.cz)



**PHONE**

+420 720 755 085



**MOBILE**

+420 777 170 276



**E-MAIL**

[info@plujeme.cz](mailto:info@plujeme.cz)



**PLUJEME RÁDI S.R.O.**

Dlouhá 730/35, 11000 Praha 1 – Staré Město, Czech Republic

## STANDARD YACHT EQUIPMENT

Comfort	<b>Cockpit cushions, Sundeck cushions</b>
Deck	<b>Bimini top, Cockpit/stern, outside shower, Deck lights, Dinghy, Electric anchor windlass, Gangway, Sprayhood, Teak table</b>
Entertainment	<b>Outdoor speakers, Radio with USB, TV</b>
Galley	<b>Coffee machine, Gas cookers, Oven, Refrigerator</b>
Interior	<b>Convertible table in salon, Curtains, Electric fans in cabins, Electric toilet</b>
Navigation	<b>Autopilot, Depthsounder, GPS chart plotter - cockpit, Navigation (Nautical) charts and nautical guide , Navigation set, Spyglass with bearing compass, Wind instrument/Anemometer</b>
Safety	<b>First aid kit , VHF radio</b>
Sails	<b>Electric winch, Lazy bag, Lazy jacks</b>
Yacht electrics	<b>Batteries, Battery charger , Inverter, Shore connection 220 V, Solar panels, USB sockets</b>



#### WEBSITE

[www.plujeme.cz](http://www.plujeme.cz)



#### E-MAIL

[info@plujeme.cz](mailto:info@plujeme.cz)



#### PHONE

+420 720 755 085



#### MOBILE

+420 777 170 276



#### PLUJEME RÁDI S.R.O.

Dlouhá 730/35, 11000 Praha 1 – Staré Město, Czech Republic

## SERVICES

SELECTED SERVICES	OBLIGATORY	PAYMENT TYPE	PRICE
<b>Skipper</b> (Payable at the base) <b>Season: 2025.</b> (Crew require their own cabin); Payable on the spot with cash	Yes	per day + food	<b>200,00 €</b>
<b>Starter pack</b> (Payable at the base) <b>Season: 2025.</b> End cleaning, 1x Cooking gas, Water, Linen 1 set (2 sheets, 1 pillow case, 1 bath towel) per person, Harbour fees for the first & last night. * If there is pet on board, then double cleaning will be applied.; Payable on the spot with cash 🎁 bag with Greek Local Products is offered to all of our charters as a welcome gift.	Yes	per booking	<b>300,00 €</b>
<b>Crew change</b> (Payable at the base) <b>Season: 2025.</b> Payable on the spot with cash	No	per booking	<b>150,00 €</b>
<b>Early boarding/check-in</b> (Payable at the base) <b>Season: 2025.</b> Access to the yacht by 14:00 In the event of delay beyond our control refunds will be made.; Payable on the spot with cash	No	per booking	<b>250,00 €</b>
<b>Hostess</b> (Payable at the base) <b>Season: 2025.</b> *crew require their own cabin; Payable on the spot with cash Down payment is required and 25% charge applicable if crew is cancelled less than 4 weeks before embarkation. 100% charge applicable If crew is cancelled less than 14 days prior to embarkation	No	per day + food	<b>180,00 €</b>
<b>Internet pack</b> (Payable at the base) <b>Season: 2025.</b> +20 € per week after the 1st (WiFi hotspot for up to 5 devices and unlimited usage of internet); Payable on the spot with cash	No	per booking	<b>70,00 €</b>
<b>Linen Pack</b> (Payable at the base) <b>Season: 2025.</b> 1 Extra set of linen (2 sheets, 1 pillow case, 1 bath towel); Payable on the spot with cash	No	per set	<b>10,00 €</b>
<b>Non refundable deposit/ insurance</b> (Payable at the base) <b>Season: 2025.</b> + refundable deposit 700 EUR; non refundable payable on spot in cash and refundable payable by credit card on spot. MG Yachts reserves the right not to accept this option due to weather conditions or skipper's incompetence.	No	per booking	<b>400,00 €</b>

**Welcome package** (Payable at the base)

No

per booking

**70,00 €**

**Season: 2025.** Toilet and Kitchen rolls, matches, Plastic bags for rubbish, 1 Dish Sponge, 1 Dish, Soap, Sugar, Salt and Pepper, Coffee, 6 bottles of Water, 1 bottle of wine, 6 cans of Coke, 6 cans of Beer, Milk, Orange Juice;  
Payable on the spot with cash



**WEBSITE**

[www.plujeme.cz](http://www.plujeme.cz)



**PHONE**

+420 720 755 085



**MOBILE**

+420 777 170 276



**E-MAIL**

[info@plujeme.cz](mailto:info@plujeme.cz)



**PLUJEME RÁDI S.R.O.**

Dlouhá 730/35, 11000 Praha 1 – Staré Město, Czech Republic

## ADDITIONAL EXTRAS

EXTRA	OBLIGATORY	PAYMENT TYPE	PRICE
<b>Automatic Inflatable Life Jacket</b> (Payable at the base) <b>Season: 2025.</b> Payable on the spot with cash - Payable at the base	No	per person	<b>30,00 €</b>
<b>Beach towel</b> (Payable at the base) <b>Season: 2025.</b> Payable on the spot with cash - Payable at the base	No	per piece	<b>5,00 €</b>
<b>Bed linen</b> (Payable at the base) <b>Season: 2025.</b> Payable on the spot with cash - Payable at the base	No	per set	<b>10,00 €</b>
<b>Blister</b> (Payable at the base) <b>Season: 2025.</b> + additional security deposit 500EUR; Payable on the spot with cash - Payable at the base	No	per week	<b>200,00 €</b>
<b>Kayak</b> (Payable at the base) <b>Season: 2025.</b> Payable on the spot with cash - Payable at the base	No	per week	<b>130,00 €</b>
<b>Life jacket (children)</b> (Payable at the base) <b>Season: 2025.</b> for children under 25 kg, one included in every yacht free of charge; Payable on the spot with cash - Payable at the base	No	per week/ person	<b>20,00 €</b>
<b>Outboard engine</b> (Payable at the base) <b>Season: 2025.</b> Payable on the spot with cash - Payable at the base	No	per week	<b>80,00 €</b>
<b>Railing net (Safety net)</b> (Payable at the base) <b>Season: 2025.</b> 200 € for yachts up to 46 ft., 260 € per week for yachts above 46ft & catamarans (Half price if the railing net is supplied uninstalled). Payable on the spot with cash - Payable at the base	No	per week	<b>260,00 €</b>
<b>SEA-DOO underwater scooter</b> (Payable at the base) <b>Season: 2025.</b> Payable on the spot with cash - Payable at the base	No	per week	<b>150,00 €</b>
<b>Snorkeling equipment</b> (Payable at the base) <b>Season: 2025.</b> The set contains mask, inhalator and flippers; Payable on the spot with cash - Payable at the base	No	per week/ person	<b>10,00 €</b>
<b>Stand up paddle (SUP)</b> (Payable at the base) <b>Season: 2025.</b> Payable on the spot with cash - Payable at the base	No	per week	<b>130,00 €</b>



**WEBSITE**

www.plujeme.cz



**E-MAIL**

info@plujeme.cz



**PHONE**

+420 720 755 085



**MOBILE**

+420 777 170 276



**PLUJEME RÁDI S.R.O.**

Dlouhá 730/35, 11000 Praha 1 – Staré Město, Czech Republic

## PRICE AND AVAILABILITY

05.04. - 12.04.2025 <b>2.420 €</b> 4.770 €	12.04. - 19.04.2025 <b>2.420 €</b> 4.770 €	19.04. - 26.04.2025 <b>3.395 €</b> 5.550 €	26.04. - 03.05.2025 NOT AVAILABLE
03.05. - 10.05.2025 <b>4.289 €</b> 5.550 €	10.05. - 17.05.2025 <b>4.289 €</b> 5.550 €	17.05. - 24.05.2025 <b>4.290 €</b> 7.150 €	24.05. - 31.05.2025 <b>5.268 €</b> 7.150 €
31.05. - 07.06.2025 <b>5.268 €</b> 7.150 €	07.06. - 14.06.2025 NOT AVAILABLE	14.06. - 21.06.2025 NOT AVAILABLE	21.06. - 28.06.2025 NOT AVAILABLE
28.06. - 05.07.2025 NOT AVAILABLE	05.07. - 12.07.2025 NOT AVAILABLE	12.07. - 19.07.2025 ON OPTION	19.07. - 26.07.2025 NOT AVAILABLE
26.07. - 02.08.2025 <b>7.220 €</b> 9.100 €			



WEBSITE

[www.plujeme.cz](http://www.plujeme.cz)



E-MAIL

[info@plujeme.cz](mailto:info@plujeme.cz)



PHONE

+420 720 755 085



MOBILE

+420 777 170 276



PLUJEME RÁDI S.R.O.

Dlouhá 730/35, 11000 Praha 1 – Staré Město, Czech Republic

## PRICE AND AVAILABILITY

02.08. - 09.08.2025 7.220 € 9.100 €	09.08. - 16.08.2025 7.220 € 9.100 €	16.08. - 23.08.2025 NOT AVAILABLE	23.08. - 30.08.2025 6.200 € 8.000 €
30.08. - 06.09.2025 NOT AVAILABLE	06.09. - 13.09.2025 6.200 € 7.150 €	13.09. - 20.09.2025 NOT AVAILABLE	20.09. - 27.09.2025 5.268 € 7.150 €
27.09. - 04.10.2025 NOT AVAILABLE	04.10. - 11.10.2025 4.290 € 4.770 €	11.10. - 18.10.2025 3.599 € 4.770 €	18.10. - 25.10.2025 3.399 € 4.770 €
25.10. - 01.11.2025 3.399 € 4.770 €	01.11. - 08.11.2025 4.770 €	08.11. - 15.11.2025 4.770 €	15.11. - 22.11.2025 4.770 €
22.11. - 29.11.2025 4.770 €	29.11. - 06.12.2025 4.770 €	06.12. - 13.12.2025 4.770 €	13.12. - 20.12.2025 4.770 €
20.12. - 27.12.2025 4.770 €			



WEBSITE

[www.plujeme.cz](http://www.plujeme.cz)



E-MAIL

[info@plujeme.cz](mailto:info@plujeme.cz)



PHONE

+420 720 755 085



MOBILE

+420 777 170 276



PLUJEME RÁDI S.R.O.

Dlouhá 730/35, 11000 Praha 1 – Staré Město, Czech Republic