

OCEANIS 51.1

Glafki (2023)

Sailing yacht Oceanis 51.1 Glafki, built in 2023 is anchored in the Athens, Alimos marina, Athens area/Saronic/Peloponese, Greece. It has 5 + 1 cabins, can accommodate 10 + 2 people and has 3 + 1 toilets. Bed linen and kitchen equipment are included in the price.

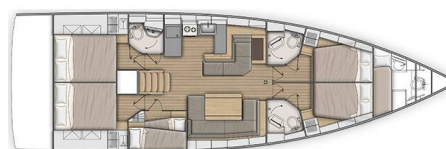

YACHT SPECIFICATIONS

Yacht Base

Athens, Alimos marina, Greece

Yacht ID

5586

Brands

Beneteau

Yacht name

Glafki

Production year

2023

Length

52 ft

Cabins

5 + 1

Berths

10 + 2

Max Persons

12

WC

3 + 1

Engine

1 x 110 HP

Fuel tank

770 l



WEBSITE

www.plujeme.cz



PHONE

+420 720 755 085



MOBILE

+420 777 170 276



E-MAIL

info@plujeme.cz



PLUJEME RÁDI S.R.O.

Dlouhá 730/35, 11000 Praha 1 – Staré Město, Czech Republic

STANDARD YACHT EQUIPMENT

Comfort	Cockpit cushions
Deck	Cockpit table, Cockpit/stern, outside shower, Dinghy with outboard engine, Gangway, Teak cockpit
Entertainment	Radio CD/mp3 player, USB, AUX input
Galley	Oven, Refrigerator
Interior	Electric fans in cabins, Electric toilet
Navigation	Autopilot, Bow thruster, GPS chart plotter - cockpit, Wind/speed/depth instruments
Safety	VHF radio
Yacht electrics	Air Conditioning, Battery charger , Generator, Solar panels



WEBSITE

www.plujeme.cz



E-MAIL

info@plujeme.cz



PHONE

+420 720 755 085



MOBILE

+420 777 170 276



PLUJEME RÁDI S.R.O.

Dlouhá 730/35, 11000 Praha 1 – Staré Město, Czech Republic

SERVICES

SELECTED SERVICES	OBLIGATORY	PAYMENT TYPE	PRICE
Generator (Payable at the base) Season: 2024. Generator Fair Use Policy: Free of Charge 8 hours per day. 10 € per extra hour or 200 € per week for unlimited use.; Payable on the spot with cash	Yes	per hour	0,00 €
Starter pack (Payable at the base) Season: 2024. End cleaning, 1x Cooking gas, Water, Linen 1 set (2 sheets, 1 pillow case, 1 bath towel) per person, Harbour fees for the first & last night. * If there is pet on board, then double cleaning will be applied.; Payable on the spot with cash 🧺 bag with Greek Local Products is offered to all of our charters as a welcome gift.	Yes	per booking	300,00 €
Generator (Payable at the base) Season: 2025. Generator Fair Use Policy: Free of Charge 8 hours per day. 10 € per extra hour or 200 € per week for unlimited use.; Payable on the spot with cash	Yes	per hour	0,00 €
Starter pack (Payable at the base) Season: 2025. End cleaning, 1x Cooking gas, Water, Linen 1 set (2 sheets, 1 pillow case, 1 bath towel) per person, Harbour fees for the first & last night. * If there is pet on board, then double cleaning will be applied.; Payable on the spot with cash 🧺 bag with Greek Local Products is offered to all of our charters as a welcome gift.	Yes	per booking	300,00 €
Crew change (Payable at the base) Season: 2024. Payable on the spot with cash	Yes	per booking	150,00 €
Early boarding/check-in (Payable at the base) Season: 2024. Access to the yacht by 14:00 In the event of delay beyond our control refunds will be made.; Payable on the spot with cash	Yes	per booking	150,00 €
Hostess (Payable at the base) Season: 2024. or 190€ / day for more than 10 pax. *crew require their own cabin; Payable on the spot with cash Down payment is required and 25% charge applicable if crew is cancelled less than 4 weeks before embarkation. 100% charge applicable If crew is cancelled less than 14 days prior to embarkation	Yes	per day + food	170,00 €

Internet pack (Payable at the base)	Yes	per booking	70,00 €
Season: 2024. +20 € per week after the 1st (WiFi hotspot for up to 5 devices and unlimited usage of internet); Payable on the spot with cash			
Linen Pack (Payable at the base)	Yes	per set	15,00 €
Season: 2024. 1 Extra set of linen (2 sheets, 1 pillow case, 1 bath towel); Payable on the spot with cash			
Non refundable deposit/ insurance (Payable at the base)	Yes	per booking	400,00 €
Season: 2024. + refundable deposit 700 EUR; non refundable payable on spot in cash and refundable payable by credit card on spot. Charter Company reserves the right not to accept this option due to weather conditions or skipper's incompetence.			
Skipper (Payable at the base)	Yes	per day + food	190,00 €
Season: 2024. (Crew require their own cabin); Payable on the spot with cash Down payment is required and 25% charge applicable if crew is cancelled less than 4 weeks before embarkation. 100% charge applicable if crew is cancelled less than 14 days prior to embarkation			
Welcome package (Payable at the base)	Yes	per booking	70,00 €
Season: 2024. Toilet and Kitchen rolls, matches, Plastic bags for rubbish, 1 Dish Sponge, 1 Dish, Soap, Sugar, Salt and Pepper, Coffee, 6 bottles of Water, 1 bottle of wine, 6 cans of Coke, 6 cans of Beer, Milk, Orange Juice; Payable on the spot with cash			
Crew change (Payable at the base)	Yes	per booking	150,00 €
Season: 2025. Payable on the spot with cash			
Early boarding/ check-in (Payable at the base)	Yes	per booking	150,00 €
Season: 2025. Access to the yacht by 14:00 In the event of delay beyond our control refunds will be made.; Payable on the spot with cash			
Hostess (Payable at the base)	Yes	per day + food	170,00 €
Season: 2025. or 190€ / day for more than 10 pax. *crew require their own cabin; Payable on the spot with cash Down payment is required and 25% charge applicable if crew is cancelled less than 4 weeks before embarkation. 100% charge applicable if crew is cancelled less than 14 days prior to embarkation			
Internet pack (Payable at the base)	Yes	per booking	70,00 €
Season: 2025. +20 € per week after the 1st (WiFi hotspot for up to 5 devices and unlimited usage of internet); Payable on the spot with cash			

Linen Pack (Payable at the base)	Yes	per set	15,00 €
Season: 2025. 1 Extra set of linen (2 sheets, 1 pillow case, 1 bath towel); Payable on the spot with cash			
Non refundable deposit/ insurance (Payable at the base)	Yes	per booking	400,00 €
Season: 2025. + refundable deposit 700 EUR; non refundable payable on spot in cash and refundable payable by credit card on spot. Charter Company reserves the right not to accept this option due to weather conditions or skipper's incompetence.			
Skipper (Payable at the base)	Yes	per day + food	190,00 €
Season: 2025. (Crew require their own cabin); Payable on the spot with cash Down payment is required and 25% charge applicable if crew is cancelled less than 4 weeks before embarkation. 100% charge applicable if crew is cancelled less than 14 days prior to embarkation			
Welcome package (Payable at the base)	Yes	per booking	70,00 €
Season: 2025. Toilet and Kitchen rolls, matches, Plastic bags for rubbish, 1 Dish Sponge, 1 Dish, Soap, Sugar, Salt and Pepper, Coffee, 6 bottles of Water, 1 bottle of wine, 6 cans of Coke, 6 cans of Beer, Milk, Orange Juice; Payable on the spot with cash			



WEBSITE

www.plujeme.cz



PHONE

+420 720 755 085



MOBILE

+420 777 170 276



E-MAIL

info@plujeme.cz



PLUJEME RÁDI S.R.O.

Dlouhá 730/35, 11000 Praha 1 – Staré Město, Czech Republic

ADDITIONAL EXTRAS

EXTRA	OBLIGATORY	PAYMENT TYPE	PRICE
Automatic Inflatable Life Jacket (Payable at the base) Season: 2024. Payable on the spot with cash - Payable at the base	Yes	per week/ person	30,00 €
Beach towel (Payable at the base) Season: 2024. Payable on the spot with cash - Payable at the base	Yes	per piece	5,00 €
Electric outboard engine (Payable at the base) Season: 2024. 3 HP - Payable at the base	Yes	per week	120,00 €
Kayak (Payable at the base) Season: 2024. Payable on the spot with cash - Payable at the base	Yes	per week	130,00 €
Life jacket (children) (Payable at the base) Season: 2024. for children under 25 kg, one included in every yacht free of charge; Payable on the spot with cash - Payable at the base	Yes	per week/ person	20,00 €
Railing net (Safety net) (Payable at the base) Season: 2024. 200 € for yachts up to 46 ft., 260 € per week for yachts above 46ft & catamarans (Half price if the railing net is supplied uninstalled). Payable on the spot with cash - Payable at the base	Yes	per week	260,00 €
Railing net (Safety net) (Payable at the base) Season: 2024. 200 € for yachts up to 46 ft., 260 € per week for yachts above 46ft & catamarans (Half price if the railing net is supplied uninstalled). Payable on the spot with cash - Payable at the base	Yes	per week	260,00 €
SEA-D00 underwater scooter (Payable at the base) Season: 2024. Payable on the spot with cash - Payable at the base	Yes	per week	150,00 €
Snorkeling equipment (Payable at the base) Season: 2024. The set contains mask, inhalator and flippers - Payable at the base	Yes	per week/ person	10,00 €
Stand up paddle (SUP) (Payable at the base) Season: 2024. Payable on the spot with cash - Payable at the base	Yes	per week	130,00 €
Automatic Inflatable Life Jacket (Payable at the base) Season: 2025. Payable on the spot with cash - Payable at the base	Yes	per week/ person	30,00 €

Beach towel (Payable at the base) Season: 2025. Payable on the spot with cash - Payable at the base	Yes	per piece	5,00 €
Electric outboard engine (Payable at the base) Season: 2025. 3 HP - Payable at the base	Yes	per week	120,00 €
Kayak (Payable at the base) Season: 2025. Payable on the spot with cash - Payable at the base	Yes	per week	130,00 €
Life jacket (children) (Payable at the base) Season: 2025. for children under 25 kg, one included in every yacht free of charge; Payable on the spot with cash - Payable at the base	Yes	per week/ person	20,00 €
Railing net (Safety net) (Payable at the base) Season: 2025. 200 € for yachts up to 46 ft., 260 € per week for yachts above 46ft & catamarans (Half price if the railing net is supplied uninstalled). Payable on the spot with cash - Payable at the base	Yes	per week	260,00 €
SEA-DOO underwater scooter (Payable at the base) Season: 2025. Payable on the spot with cash - Payable at the base	Yes	per week	150,00 €
Snorkeling equipment (Payable at the base) Season: 2025. The set contains mask, inhalator and flippers - Payable at the base	Yes	per week/ person	10,00 €
Stand up paddle (SUP) (Payable at the base) Season: 2025. Payable on the spot with cash - Payable at the base	Yes	per week	130,00 €



WEBSITE
www.plujeme.cz



PHONE
+420 720 755 085



MOBILE
+420 777 170 276



E-MAIL
info@plujeme.cz



PLUJEME RÁDI S.R.O.
Dlouhá 730/35, 11000 Praha 1 – Staré Město, Czech Republic

PRICE AND AVAILABILITY

21.09. - 28.09.2024 NOT AVAILABLE	28.09. - 05.10.2024 NOT AVAILABLE	05.10. - 12.10.2024 NOT AVAILABLE	12.10. - 19.10.2024 NOT AVAILABLE
19.10. - 26.10.2024 2.772 € 4.780 €	26.10. - 02.11.2024 NOT AVAILABLE	02.11. - 09.11.2024 2.772 € 4.780 €	09.11. - 16.11.2024 2.772 € 4.780 €
16.11. - 23.11.2024 2.772 € 4.780 €	23.11. - 30.11.2024 4.780 €	30.11. - 07.12.2024 4.780 €	07.12. - 14.12.2024 4.780 €
14.12. - 21.12.2024 4.780 €	21.12. - 05.04.2025 NOT AVAILABLE	05.04. - 12.04.2025 4.541 € 4.780 €	12.04. - 19.04.2025 4.541 € 4.780 €
19.04. - 26.04.2025 4.845 € 5.100 €	26.04. - 03.05.2025 4.845 € 5.100 €		



WEBSITE
www.plujeme.cz



E-MAIL
info@plujeme.cz



PHONE
+420 720 755 085



MOBILE
+420 777 170 276



PLUJEME RÁDI S.R.O.
Dlouhá 730/35, 11000 Praha 1 – Staré Město, Czech Republic

PRICE AND AVAILABILITY

03.05. - 10.05.2025 4.845 € 5.100 €	10.05. - 17.05.2025 4.845 € 5.100 €	17.05. - 24.05.2025 6.337 € 6.670 €	24.05. - 31.05.2025 6.337 € 6.670 €
31.05. - 07.06.2025 6.337 € 6.670 €	07.06. - 14.06.2025 6.337 € 6.670 €	14.06. - 21.06.2025 6.973 € 7.340 €	21.06. - 28.06.2025 6.973 € 7.340 €
28.06. - 05.07.2025 6.973 € 7.340 €	05.07. - 12.07.2025 6.973 € 7.340 €	12.07. - 19.07.2025 6.973 € 7.340 €	19.07. - 26.07.2025 6.973 € 7.340 €
26.07. - 02.08.2025 7.971 € 8.390 €	02.08. - 09.08.2025 7.971 € 8.390 €	09.08. - 16.08.2025 7.971 € 8.390 €	16.08. - 06.09.2025 NOT AVAILABLE
06.09. - 13.09.2025 6.337 € 6.670 €	13.09. - 20.09.2025 NOT AVAILABLE	20.09. - 27.09.2025 6.337 € 6.670 €	27.09. - 04.10.2025 NOT AVAILABLE
04.10. - 11.10.2025 4.541 € 4.780 €	11.10. - 18.10.2025 4.541 € 4.780 €	18.10. - 25.10.2025 4.541 € 4.780 €	25.10. - 01.11.2025 4.541 € 4.780 €
01.11. - 08.11.2025 4.541 € 4.780 €	08.11. - 15.11.2025 4.541 € 4.780 €	15.11. - 22.11.2025 4.541 € 4.780 €	22.11. - 29.11.2025 4.541 € 4.780 €
29.11. - 06.12.2025 4.541 € 4.780 €	06.12. - 13.12.2025 4.541 € 4.780 €	13.12. - 20.12.2025 4.541 € 4.780 €	20.12. - 27.12.2025 4.541 € 4.780 €



WEBSITE

www.plujeme.cz



E-MAIL

info@plujeme.cz



PHONE

+420 720 755 085



MOBILE

+420 777 170 276



PLUJEME RÁDI S.R.O.

Dlouhá 730/35, 11000 Praha 1 – Staré Město, Czech Republic