

OCEANIS 51.1

South Point (2018)

Sailing yacht Oceanis 51.1 South Point, built in 2018 is anchored in the ACI Marina Trogir, Split region, Croatia. It has **5 + 1 cabins**, can accommodate **10 + 1 + 1 people** and has **3 + 1 toilets**. Bed linen and kitchen equipment are included in the price.

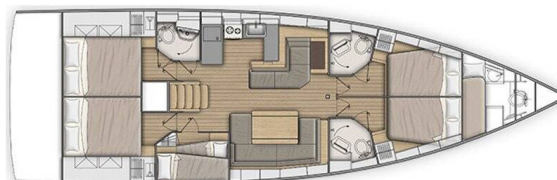

YACHT SPECIFICATIONS

Yacht Base

ACI Marina Trogir, Croatia

Yacht ID

5188

Brands

Beneteau

Yacht name

South Point

Production year

2018

Length

52 ft

Cabins

5 + 1

Berths

10 + 1 + 1

Max Persons

12

WC

3 + 1

Engine

0 x 0 HP

Fuel tank

0 l



WEBSITE

www.plujeme.cz



PHONE

+420 720 755 085



MOBILE

+420 777 170 276



E-MAIL

info@plujeme.cz



PLUJEME RÁDI S.R.O.

Dlouhá 730/35, 11000 Praha 1 – Staré Město, Czech Republic

STANDARD YACHT EQUIPMENT

Comfort	Cockpit cushions
Deck	Bathing platform, Bimini top, Cockpit/stern, outside shower, Dinghy with outboard engine, Electric anchor windlass, Sprayhood, Teak cockpit
Entertainment	Fusion radio, Indoor speakers, Outdoor speakers, Stand up paddle (SUP) - FREE
Galley	Freezer, Gas cookers, Nescaffe Dolce Gusto Coffee Maker, NESPRESSO coffee machine, Oven, Refrigerator, Water pump
Interior	Electric fans, LED lights
Navigation	Autopilot, Bow thruster, GPS chart plotter - cockpit
Safety	Safety equipment, VHF radio
Sails	Electric winch, Lazy bag
Yacht electrics	Air Conditioning, Battery charger , Generator, Heating, Plug 220V, 12 V



WEBSITE

www.plujeme.cz



PHONE

+420 720 755 085



MOBILE

+420 777 170 276



E-MAIL

info@plujeme.cz



PLUJEME RÁDI S.R.O.

Dlouhá 730/35, 11000 Praha 1 – Staré Město, Czech Republic

SERVICES

SELECTED SERVICES	OBLIGATORY	PAYMENT TYPE	PRICE
Charter package (Payable now) Season: 2025. End cleaning, bed linen, towels (1 small and 1 medium per pax), starter kit (1 dishtowel, toilet paper, dustbin bag, 1 roll of paper towel, dish, soap and sponge), outboard fuel 5 l, 2 bottles of gas, transit log. Obligatory surcharge for 2 or more weeks : + 100 euro	Yes	per booking	390,00 €
Outboard engine (Payable at the base) Season: 2025. included in price	Yes	per booking	0,00 €
Cook (Payable at the base) Season: 2025. payable in advance or upon embarkation; obligatory to have his / her own cabin.	No	per day + food	250,00 €
Early boarding/check-in (Payable at the base) Season: 2025. at 13:00h	No	per booking	220,00 €
Hostess (Payable at the base) Season: 2025. payable in advance or upon embarkation; obligatory to have his / her own cabin.	No	per day + food	200,00 €
One way fee (Payable at the base) Season: 2025. (+1 day mooring fee to be paid extra on check in day)	No	one-way	720,00 €
Pet on board (Payable at the base) Season: 2025.	No	per booking	150,00 €
Skipper (Payable at the base) Season: 2025. payable in advance or upon embarkation; obligatory to have his / her own cabin.	No	per day + food	210,00 €



WEBSITE
www.plujeme.cz



PHONE
+420 720 755 085



MOBILE
+420 777 170 276



E-MAIL
info@plujeme.cz



PLUJEME RÁDI S.R.O.
Dlouhá 730/35, 11000 Praha 1 – Staré Město, Czech Republic

ADDITIONAL EXTRAS

EXTRA	OBLIGATORY	PAYMENT TYPE	PRICE
Beach towel (Payable at the base) Season: 2025. 2 pcs - Payable at the base	No	per booking	10,00 €
Coffee machine (Payable at the base) Season: 2025. Dolce Gusto + 16 Capsules - Payable at the base	No	per week	50,00 €
Donut (Payable at the base) Season: 2025. Payable at the base	No	per week	50,00 €
Grill/Barbecue/Plancha (Payable at the base) Season: 2025. Electric - Payable at the base	No	per week	100,00 €
Ice maker (Payable at the base) Season: 2025. Payable at the base	No	per week	50,00 €
Kayak (Payable at the base) Season: 2025. Payable at the base	No	per week	170,00 €
Railing net (Safety net) (Payable at the base) Season: 2025. Payable at the base	No	per booking	130,00 €
Stand up paddle (SUP) (Payable at the base) Season: 2025. Payable at the base	No	per week	130,00 €



WEBSITE
www.plujeme.cz



E-MAIL
info@plujeme.cz



PHONE
+420 720 755 085



MOBILE
+420 777 170 276



PLUJEME RÁDI S.R.O.
Dlouhá 730/35, 11000 Praha 1 – Staré Město, Czech Republic

PRICE AND AVAILABILITY

01.03. - 08.03.2025 2.850 € 3.750 €	08.03. - 15.03.2025 2.850 € 3.750 €	15.03. - 22.03.2025 2.850 € 3.750 €	22.03. - 29.03.2025 2.850 € 3.750 €
29.03. - 05.04.2025 2.850 € 3.750 €	05.04. - 12.04.2025 2.850 € 3.750 €	12.04. - 19.04.2025 2.850 € 3.750 €	19.04. - 26.04.2025 3.040 € 4.000 €
26.04. - 03.05.2025 3.040 € 4.000 €	03.05. - 10.05.2025 3.040 € 4.000 €	10.05. - 17.05.2025 3.572 € 4.700 €	17.05. - 24.05.2025 3.572 € 4.700 €
24.05. - 31.05.2025 4.256 € 5.600 €	31.05. - 07.06.2025 5.092 € 6.700 €	07.06. - 14.06.2025 NOT AVAILABLE	14.06. - 21.06.2025 5.092 € 6.700 €
21.06. - 28.06.2025 5.092 € 6.700 €	28.06. - 12.07.2025 NOT AVAILABLE	12.07. - 19.07.2025 NOT AVAILABLE	19.07. - 26.07.2025 6.232 € 8.200 €
26.07. - 02.08.2025 6.101 € 8.200 €			



WEBSITE
www.plujeme.cz



E-MAIL
info@plujeme.cz



PHONE
+420 720 755 085



PLUJEME RÁDI S.R.O.
Dlouhá 730/35, 11000 Praha 1 – Staré Město, Czech Republic



MOBILE
+420 777 170 276

PRICE AND AVAILABILITY

02.08. - 09.08.2025 6.101 € 8.200 €	09.08. - 16.08.2025 6.101 € 8.200 €	16.08. - 23.08.2025 5.692 € 7.650 €	23.08. - 30.08.2025 5.692 € 7.650 €
30.08. - 06.09.2025 5.692 € 7.650 €	06.09. - 13.09.2025 5.092 € 6.700 €	13.09. - 20.09.2025 5.092 € 6.700 €	20.09. - 27.09.2025 4.256 € 5.600 €
27.09. - 04.10.2025 4.256 € 5.600 €	04.10. - 11.10.2025 3.572 € 4.700 €	11.10. - 18.10.2025 3.572 € 4.700 €	18.10. - 25.10.2025 3.572 € 4.700 €
25.10. - 01.11.2025 3.572 € 4.700 €	01.11. - 08.11.2025 3.572 € 4.700 €	08.11. - 15.11.2025 3.572 € 4.700 €	15.11. - 22.11.2025 3.572 € 4.700 €
22.11. - 29.11.2025 3.572 € 4.700 €	29.11. - 06.12.2025 3.572 € 4.700 €	06.12. - 13.12.2025 3.572 € 4.700 €	13.12. - 20.12.2025 3.760 € 4.700 €
20.12. - 27.12.2025 3.760 € 4.700 €			



WEBSITE

www.plujeme.cz



E-MAIL

info@plujeme.cz



PHONE

+420 720 755 085



MOBILE

+420 777 170 276



PLUJEME RÁDI S.R.O.

Dlouhá 730/35, 11000 Praha 1 – Staré Město, Czech Republic