

HANSE 510

Hype (2023)

Sailing yacht **Hanse 510 Hype**, built in **2023** is anchored in the **Marina Kornati, Biograd, Zadar region, Croatia**. It has **5 + 1 cabins**, can accommodate **10 + 2 + 1 people** and has **3 + 1 toilets**. Bed linen and kitchen equipment are included in the price.

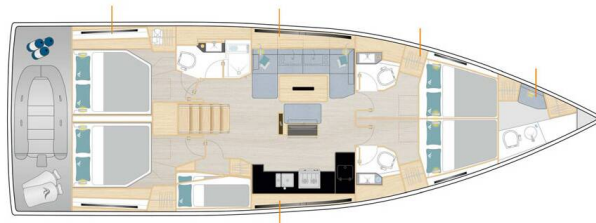

YACHT SPECIFICATIONS

Yacht Base

Marina Kornati, Biograd, Croatia

Yacht ID

5094

Brands

Hanse Yachts

Yacht name

Hype

Production year

2023

Length

52 ft

Cabins

5 + 1

Berths

10 + 2 + 1

Max Persons

12

WC

3 + 1

Engine

1 x 80 HP

Fuel tank

200l



WEBSITE

www.plujeme.cz



PHONE

+420 720 755 085



MOBILE

+420 777 170 276



E-MAIL

info@plujeme.cz



PLUJEME RÁDI S.R.O.

Dlouhá 730/35, 11000 Praha 1 – Staré Město, Czech Republic

STANDARD YACHT EQUIPMENT

Comfort	Bed linen, Cockpit cushions
Deck	Bathing platform, Bimini top, Cockpit table, Cockpit/stern, outside shower, Dinghy, Sprayhood, Teak cockpit
Entertainment	Indoor speakers, Outdoor speakers, Radio CD player
Galley	Hot water, Kitchen utensils (Galley equipment, cutlery), Oven, Refrigerator, Stove
Interior	Electric toilet
Navigation	Autopilot, Bow thruster, GPS chart plotter - cockpit, Navigation (Nautical) charts and nautical guide , Pilot book, Tridata
Safety	VHF radio
Sails	Electric halyard winch
Yacht electrics	Battery charger , Inverter



WEBSITE

www.plujeme.cz



E-MAIL

info@plujeme.cz



PHONE

+420 720 755 085



MOBILE

+420 777 170 276



PLUJEME RÁDI S.R.O.

Dlouhá 730/35, 11000 Praha 1 – Staré Město, Czech Republic

SERVICES

SELECTED SERVICES	OBLIGATORY	PAYMENT TYPE	PRICE
Charter pack (Payable at the base) Season: 2024. includes final cleaning, bedlinen, towels - 1 set/person, cooking gas	Yes	per booking	380,00 €
Charter pack (Payable at the base) Season: 2025. includes final cleaning, bedlinen, towels - 1 set/person, cooking gas	Yes	per booking	380,00 €
Carefree package (Payable at the base) Season: 2024. includes deposit insurance fee, outboard 2,5 HP, WiFi router. Surcharge for 2 or more weeks (all boats) € 90.-/week	Yes	per week	380,00 €
Carefree Premium package (Payable at the base) Season: 2024. includes deposit insurance fee, outboard 5 HP, WiFi router. Surcharge for 2 or more weeks (all boats) € 120.-/week.	Yes	per week	420,00 €
Comfort Pack (Payable at the base) Season: 2024. includes outboard 2,5 HP, WiFi routers	Yes	per week	105,00 €
Deposit insurance (Payable at the base) Season: 2024. + 400 EUR refundable deposit	Yes	per booking	320,00 €
Early Check in (Payable at the base) Season: 2024. Saturdays between 13hr - 14hr. Early check in can be confirmed only on embarkation day in the charter base.	Yes	per booking	250,00 €
Flexible booking (Payable now) Season: 2024. allows you to cancel or rebook your charter up to 30 days before the embarkation for no specific reason. You can reschedule your holiday at no cost for unlimited number of times or use a credit note if you are uncertain of new charter dates. With our FLEX PLAN your rebooking costs are completely eliminated while cancellation costs with refund option are reduced to a minimum (15% of the charter fee, min 350 EUR). Extra bonus: free cancellation and FULL REFUND granted in case of closed state borders within 7 days before the embarkation. Notes: FLEX PLAN costs 7% of the final charter price, can be added to booking up to 72hr after booking confirmation and is not available for bookings confirmed within 30 days before the embarkation.	Yes	per booking	0,00 €

Hostess (Payable at the base) Season: 2024.	Yes	per week + food	1.400,00 €
Late check out (Payable at the base) Season: 2024. Saturdays till 10hr Late check-out can be confirmed only on Friday before the embarkation day.	Yes	per booking	350,00 €
One way fee (Payable at the base) Season: 2024. Bio - Kas / Seg On request only. One-way conditions: one way fee + skippers daily fee + berth charges in port of embarkation/diseembarkation	Yes	per booking	480,00 €
Parking (Payable at the base) Season: 2024. Per Car/week - parking place within Marina Baotić, can be ordered in advance and paid in our office (limited availability)	Yes	per week	50,00 €
Provisioning (Payable now) Season: 2024. upon request + price of groceries, to be done online	Yes	per booking	0,00 €
Skipper (Payable at the base) Season: 2024.	Yes	per week + food	1.680,00 €
Comfort Pack (Payable at the base) Season: 2025. includes outboard 2,5 HP, WiFi routers	Yes	per week	105,00 €
Early Check in (Payable at the base) Season: 2025. Saturdays between 13hr - 14hr. Early check in can be confirmed only on embarkation day in the charter base.	Yes	per booking	250,00 €
Flexible booking (Payable now) Season: 2025. allows you to cancel or rebook your charter up to 30 days before the embarkation for no specific reason. You can reschedule your holiday at no cost for unlimited number of times or use a credit note if you are uncertain of new charter dates. With our FLEX PLAN your rebooking costs are completely eliminated while cancellation costs with refund option are reduced to a minimum (15% of the charter fee, min 350 EUR). Extra bonus: free cancellation and FULL REFUND granted in case of closed state borders within 7 days before the embarkation. Notes: FLEX PLAN costs 7% of the final charter price, can be added to booking up to 72hr after booking confirmation and is not available for bookings confirmed within 30 days before the embarkation.	Yes	per booking	0,00 €
Hostess (Payable at the base) Season: 2025.	Yes	per week + food	1.400,00 €

Late check out (Payable at the base) Season: 2025. Saturdays till 10hr Late check-out can be confirmed only on Friday before the embarkation day.	Yes	per booking	350,00 €
One way fee (Payable at the base) Season: 2025. Bio - Kas / Seg On request only. One-way conditions: one way fee + skippers daily fee + berth charges in port of embarkation/diseembarkation	Yes	per booking	480,00 €
Parking (Payable at the base) Season: 2025. Per Car/week - parking place within Marina Baotić, can be ordered in advance and paid in our office (limited availability)	Yes	per week	50,00 €
Provisioning (Payable now) Season: 2025. upon request + price of groceries, to be done online	Yes	per booking	0,00 €
Skipper (Payable at the base) Season: 2025.	Yes	per week + food	1.680,00 €



WEBSITE

www.plujeme.cz



E-MAIL

info@plujeme.cz



PHONE

+420 720 755 085



MOBILE

+420 777 170 276



PLUJEME RÁDI S.R.O.

Dlouhá 730/35, 11000 Praha 1 – Staré Město, Czech Republic

ADDITIONAL EXTRAS

EXTRA	OBLIGATORY	PAYMENT TYPE	PRICE
Beach towel <i>(Payable at the base)</i> Season: 2024. <i>Payable at the base</i>	Yes	per piece	8,00 €
Cockpit cushions <i>(Payable at the base)</i> Season: 2024. <i>set - Payable at the base</i>	Yes	per week	30,00 €
Extra bedlinen <i>(Payable at the base)</i> Season: 2024. <i>Payable at the base</i>	Yes	per set	15,00 €
Outboard engine 2,5 HP <i>(Payable at the base)</i> Season: 2024. <i>Payable at the base</i>	Yes	per week	100,00 €
Outboard engine 5 HP <i>(Payable at the base)</i> Season: 2024. <i>on request - Payable at the base</i>	Yes	per week	150,00 €
Railing net (Safety net) <i>(Payable at the base)</i> Season: 2024. <i>Rental without mounting - Payable at the base</i>	Yes	per booking	20,00 €
Snorkeling equipment <i>(Payable at the base)</i> Season: 2024. <i>Payable at the base</i>	Yes	per week	10,00 €
Stand up paddle (SUP) <i>(Payable at the base)</i> Season: 2024. <i>Payable at the base</i>	Yes	per week	120,00 €
Towels <i>(Payable at the base)</i> Season: 2024. <i>2 psc/set (1 x 50x100cm + 1 x 70x140cm) - Payable at the base</i>	Yes	per set	8,00 €
Wi-Fi Internet <i>(Payable at the base)</i> Season: 2024. <i>Payable at the base</i>	Yes	per week	25,00 €
Beach towel <i>(Payable at the base)</i> Season: 2025. <i>Payable at the base</i>	Yes	per piece	8,00 €
Cockpit cushions <i>(Payable at the base)</i> Season: 2025. <i>set - Payable at the base</i>	Yes	per week	30,00 €
Extra bedlinen <i>(Payable at the base)</i> Season: 2025. <i>Payable at the base</i>	Yes	per set	15,00 €

Outboard engine 2,5 HP (Payable at the base) Season: 2025. Payable at the base	Yes	per week	100,00 €
Outboard engine 5 HP (Payable at the base) Season: 2025. on request - Payable at the base	Yes	per week	150,00 €
Railing net (Safety net) (Payable at the base) Season: 2025. Rental without mounting - Payable at the base	Yes	per booking	20,00 €
Snorkeling equipment (Payable at the base) Season: 2025. Payable at the base	Yes	per week	10,00 €
Stand up paddle (SUP) (Payable at the base) Season: 2025. Payable at the base	Yes	per week	120,00 €
Towels (Payable at the base) Season: 2025. 2 psc/set (1 x 50x100cm + 1 x 70x140cm) - Payable at the base	Yes	per set	8,00 €
Wi-Fi Internet (Payable at the base) Season: 2025. Payable at the base	Yes	per week	25,00 €



WEBSITE

www.plujeme.cz



E-MAIL

info@plujeme.cz



PHONE

+420 720 755 085



MOBILE

+420 777 170 276



PLUJEME RÁDI S.R.O.

Dlouhá 730/35, 11000 Praha 1 – Staré Město, Czech Republic

PRICE AND AVAILABILITY

21.09. - 28.09.2024 NOT AVAILABLE	28.09. - 05.10.2024 NOT AVAILABLE	05.10. - 12.10.2024 NOT AVAILABLE	12.10. - 19.10.2024 1.928 € 3.690 €
19.10. - 26.10.2024 2.046 € 3.590 €	26.10. - 02.11.2024 2.046 € 3.590 €	03.11. - 31.12.2024 NOT AVAILABLE	01.01. - 28.02.2025 NOT AVAILABLE
01.03. - 08.03.2025 3.231 € 3.590 €	08.03. - 15.03.2025 3.231 € 3.590 €	15.03. - 22.03.2025 3.231 € 3.590 €	22.03. - 29.03.2025 3.231 € 3.590 €
29.03. - 05.04.2025 3.231 € 3.590 €	05.04. - 12.04.2025 2.558 € 3.590 €	12.04. - 19.04.2025 2.629 € 3.690 €	19.04. - 26.04.2025 2.700 € 3.790 €
26.04. - 03.05.2025 2.985 € 4.190 €			



WEBSITE
www.plujeme.cz



E-MAIL
info@plujeme.cz



PHONE
+420 720 755 085



PLUJEME RÁDI S.R.O.
Dlouhá 730/35, 11000 Praha 1 – Staré Město, Czech Republic



MOBILE
+420 777 170 276

PRICE AND AVAILABILITY

03.05. - 10.05.2025 3.057 € 4.290 €	10.05. - 17.05.2025 3.698 € 5.190 €	17.05. - 24.05.2025 4.097 € 5.750 €	24.05. - 31.05.2025 5.289 € 6.550 €
31.05. - 07.06.2025 5.774 € 7.150 €	07.06. - 14.06.2025 6.097 € 7.550 €	14.06. - 21.06.2025 6.339 € 7.850 €	21.06. - 28.06.2025 6.985 € 8.650 €
28.06. - 05.07.2025 7.146 € 8.850 €	05.07. - 12.07.2025 7.227 € 8.950 €	12.07. - 19.07.2025 7.631 € 9.450 €	19.07. - 26.07.2025 7.631 € 9.450 €
26.07. - 02.08.2025 7.631 € 9.450 €	02.08. - 09.08.2025 7.631 € 9.450 €	09.08. - 16.08.2025 7.631 € 9.450 €	16.08. - 23.08.2025 6.743 € 8.350 €
23.08. - 30.08.2025 6.581 € 8.150 €	30.08. - 06.09.2025 6.420 € 7.950 €	06.09. - 13.09.2025 NOT AVAILABLE	13.09. - 20.09.2025 5.344 € 6.250 €
20.09. - 27.09.2025 4.095 € 4.790 €	27.09. - 04.10.2025 3.924 € 4.590 €	04.10. - 11.10.2025 2.843 € 3.990 €	11.10. - 18.10.2025 2.629 € 3.690 €
18.10. - 25.10.2025 2.558 € 3.590 €	25.10. - 01.11.2025 2.693 € 3.590 €	01.11. - 08.11.2025 3.231 € 3.590 €	08.11. - 15.11.2025 3.231 € 3.590 €
15.11. - 22.11.2025 3.231 € 3.590 €	22.11. - 29.11.2025 3.231 € 3.590 €	29.11. - 06.12.2025 3.231 € 3.590 €	06.12. - 13.12.2025 3.231 € 3.590 €
13.12. - 20.12.2025 3.231 € 3.590 €	20.12. - 27.12.2025 3.231 € 3.590 €		



WEBSITE
www.plujeme.cz



E-MAIL
info@plujeme.cz



PHONE
+420 720 755 085



MOBILE
+420 777 170 276



PLUJEME RÁDI S.R.O.
Dlouhá 730/35, 11000 Praha 1 – Staré Město, Czech Republic