

# BALI CATSPACE OW

NANCYE IV (2023)

Catamaran Bali Catspace OW NANCYE IV, built in 2023 is anchored in the **St. Thomas, Compass Point Marina, US-Virgin Islands, United States Virgin Islands**. It has **3 cabins**, can accommodate **6 people** and has **3 toilets**. Bed linen and kitchen equipment are included in the price.

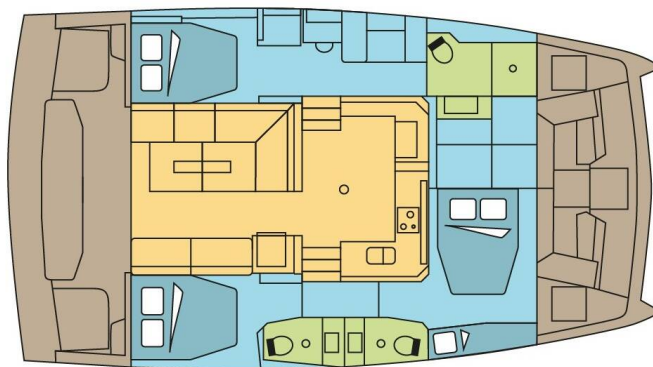

## YACHT SPECIFICATIONS

Yacht Base

**St. Thomas, Compass Point Marina,  
United States Virgin Islands**

Yacht ID

**4833**

Brands

**Catana**

Yacht name

**NANCYE IV**

Production year

**2023**

Length

**40 ft**

Cabins

**3**

Berths

**6**

Max Persons

**7**

WC

**3**

Engine

**2 x 40 HP**

Fuel tank

**400 l**



**WEBSITE**

[www.plujeme.cz](http://www.plujeme.cz)



**PHONE**

+420 720 755 085



**MOBILE**

+420 777 170 276



**E-MAIL**

[info@plujeme.cz](mailto:info@plujeme.cz)



**PLUJEME RÁDI S.R.O.**

Dlouhá 730/35, 11000 Praha 1 – Staré Město, Czech Republic

## STANDARD YACHT EQUIPMENT

|                 |  |
|-----------------|--|
| Comfort         | <b>Cockpit cushions, Mosquito nets</b>   |
| Deck            | <b>Anchor with chain, Bimini top, Cockpit light, Cockpit table, Cockpit/stern, outside shower, Davit, Dinghy, Electric anchor windlass, Flybridge, Foredeck sunbathing area, Outboard engine, Remote control for anchor winch with chain counter at helm, Spring cleats, Sun awning (forward cockpit), Swimming ladder</b> |
| Entertainment   | <b>Fusion radio</b>  |
| Galley          | <b>Freezer, Oven</b>   |
| Interior        | <b>Curtains, Electric fans in cabins, Electric toilet</b>  |
| Navigation      | <b>AIS, Autopilot, Depthsounder, GPS chart plotter, Wind instrument/Anemometer</b>   |
| Safety          | <b>Extra water tank, Safety equipment, VHF radio</b>   |
| Sails           | <b>Electric winch, Lazy bag, Lazy jacks</b>  |
| Yacht electrics | <b>Air Conditioning, Battery charger, Generator, Inverter, Service batteries, Solar panels, Watermaker - desalinator</b>   |



**WEBSITE**

[www.plujeme.cz](http://www.plujeme.cz)



**PHONE**

+420 720 755 085



**MOBILE**

+420 777 170 276



**E-MAIL**

[info@plujeme.cz](mailto:info@plujeme.cz)



**PLUJEME RÁDI S.R.O.**

Dlouhá 730/35, 11000 Praha 1 – Staré Město, Czech Republic

## SERVICES

| SELECTED SERVICES   | OBLIGATORY | PAYMENT TYPE | PRICE           |
|---|------------|--------------|-----------------|
| <b>Essentials pack</b> (Payable now)<br><b>Season: 2026 Exotic.</b> INCLUDED: full reduction of security deposit (0 € at base)// starter pack – (1 gallon water or 4 bottles of 1.5L, 1 bottle of disinfectant, 1 small bottle of washing up liquid, 1 dish cloth, 1 sponge, garbage bags, 1 roll of paper towels, 1 box of matches, 1 roll of toilet paper in each head)// final cleaning // 1 set of bed sheets & towels, dinghy, outboard engine & initial supply of fuel, gas and water tanks// DYC assistance guarantee // 1st & last night in the marina /// NOT INCLUDED: refuelling, gas & water consumption at end of charter, taxes if any, handling fees, additional equipment deposit | Yes        | per booking  | <b>810,00 €</b> |
| <b>Handling fees</b> (Payable now)<br><b>Season: 2026 Exotic.</b>   | Yes        | per booking  | <b>35,00 €</b>  |
| <b>Visar (USVI search &amp; rescue)</b> (Payable now)<br><b>Season: 2026 Exotic.</b>  | Yes        | per booking  | <b>8,33 €</b>   |
| <b>Crew change</b> (Payable now)<br><b>Season: 2026 Exotic.</b> Any crew change during the charter is subject to € 200.- additional cost. The charge includes administration cost, change of bed linen and towels and one night at DYC ponton (marina fee included only if the same base than start base). It doesn't include cleaning, nor new transit log where applicable.   | No         | per booking  | <b>200,00 €</b> |
| <b>Early boarding/check-in</b> (Payable now)<br><b>Season: 2026 Exotic.</b> EB(boat only) - 14:00 h / 2 PM starting time of boat's delivery // limited number of early boardings on same departure day  | No         | per booking  | <b>450,00 €</b> |
| <b>Electric &amp; Water consumption in the Marinas</b> (Payable at the base)<br><b>Season: 2026 Exotic.</b> Electric & Water consumption based on 2 nights on our dock (base will confirm the amount to pay locally depending on nights spent on dock)  | No         | per booking  | <b>28,00 €</b>  |
| <b>Extra set of linen (choose how many)</b> (Payable now)<br><b>Season: 2026 Exotic.</b> Extra set of linen : 15 € 1 set of linen (2 sheets & 2 pillow case) - to be updated manually   | No         | per booking  | <b>15,00 €</b>  |
| <b>Extra set of towels (choose how many)</b> (Payable now)<br><b>Season: 2026 Exotic.</b> Extra set of towels: 10 € 1 set of towels (1 face & 1 bath towel) - to be updated manually  | No         | per booking  | <b>10,00 €</b>  |

|   |    |             |                   |
|---|----|-------------|-------------------|
| <b>Final cleaning</b> (Payable now)   | No | per booking | <b>335,00 €</b>   |
| <b>Season: 2026 Exotic.</b> included in Essentials pack   |    |             |                   |
| <b>Race pack</b> (Payable now)  | No | per booking | <b>1.320,00 €</b> |
| <b>Season: 2026 Exotic.</b> BVI Spring Regatta, Briefing before the race, preparation and gauging of sails, registration of the yacht (not of the passengers), technical assistance during the race *** technical assistance during the race not valid for RORC Caribbean 600 // A special race deposit need to be doubled manually once the race fee is added. |    |             |                   |
| <b>Race pack</b> (Payable now)  | No | per booking | <b>1.650,00 €</b> |
| <b>Season: 2026 Exotic.</b> Antigua, Briefing before the race, preparation and gauging of sails, registration of the yacht (not of the passengers), technical assistance during the race *** technical assistance during the race not valid for RORC Caribbean 600 // A special race deposit need to be doubled manually once the race fee is added.            |    |             |                   |
| <b>Race pack</b> (Payable now)  | No | per booking | <b>1.650,00 €</b> |
| <b>Season: 2026 Exotic.</b> RORC caribbean 600, Briefing before the race, preparation and gauging of sails, registration of the yacht (not of the passengers), technical assistance during the race *** technical assistance during the race not valid for RORC Caribbean 600 // A special race deposit need to be doubled manually once the race fee is added. |    |             |                   |
| <b>Regatta surcharge</b> (Payable now)  | No | per booking | <b>2.050,00 €</b> |
| <b>Season: 2026 Exotic.</b> valid for ASW regatta only // A special race deposit need to be doubled manually once the regatta surcharge is added.   |    |             |                   |
| <b>Regatta surcharge</b> (Payable now)  | No | per booking | <b>0,00 €</b>     |
| <b>Season: 2026 Exotic.</b> all the regattas apart of ASW (different regatta surcharge for ASW) // A special race deposit need to be doubled manually once the regatta surcharge is added.  |    |             |                   |
| <b>Same day briefing</b> (Payable now)  | No | per booking | <b>150,00 €</b>   |
| <b>Season: 2026 Exotic.</b> Same day briefing starting between 5 & 5.30pm (departure following morning)   |    |             |                   |
| <b>Skipper</b> (Payable at the base)  | No | per night   | <b>320,00 €</b>   |
| <b>Season: 2026 Exotic.</b> + provisioning, a double cabin to sleep (not a forepeak) and access to a WC/Shower // to be paid at base in cash  |    |             |                   |
| <b>Starter pack</b> (Payable now)   | No | per booking | <b>50,00 €</b>    |
| <b>Season: 2026 Exotic.</b> included in Essentials pack (The pack includes: 1 gallon water (or 4 bottles of 1.5L), 1 bottle of disinfectant, 1 small bottle of washing up liquid, 1 dish cloth, 1 sponge, garbage bags, 1 roll of paper towels, 1 box of matches, 1 roll of toilet paper in each head)  |    |             |                   |

**Transfer** (Payable now)

No

one-way

**163,00 €**

**Season: 2026 Exotic.** OW- Airport to St. Thomas Base - 1-10 pax

---

**Transfer** (Payable now)

No

round trip

**326,00 €**

**Season: 2026 Exotic.** RT - Airport to St. Thomas Base - 1-10 pax



**WEBSITE**

[www.plujeme.cz](http://www.plujeme.cz)



**PHONE**

+420 720 755 085



**MOBILE**

+420 777 170 276



**E-MAIL**

[info@plujeme.cz](mailto:info@plujeme.cz)



**PLUJEME RÁDI S.R.O.**

Dlouhá 730/35, 11000 Praha 1 – Staré Město, Czech Republic

## ADDITIONAL EXTRAS

| EXTRA  | OBLIGATORY | PAYMENT TYPE | PRICE           |
|--|------------|--------------|-----------------|
| <b>Kayak single</b> (Payable now)<br><b>Season: 2026 Exotic.</b> price per day - Additional deposit 100 EUR - Payable now  | No         | per night    | <b>15,00 €</b>  |
| <b>Kayak tandem</b> (Payable now)<br><b>Season: 2026 Exotic.</b> price per day - Additional deposit 100 EUR - Payable now  | No         | per night    | <b>15,00 €</b>  |
| <b>Outboard engine 8 &amp; 9,8 HP</b> (Payable now)<br><b>Season: 2026 Exotic.</b> Dinghy not suitable in any case for waterski or wakeboard. Additional security deposit of 500 € - Payable now | No         | per day      | <b>35,00 €</b>  |
| <b>Railing net (Safety net)</b> (Payable now)<br><b>Season: 2026 Exotic.</b> net is supplied but not installed - Payable now   | No         | per booking  | <b>250,00 €</b> |
| <b>Stand up paddle (SUP)</b> (Payable now)<br><b>Season: 2026 Exotic.</b> Price per day - Additional deposit 100 EUR - Payable now   | No         | per night    | <b>15,00 €</b>  |



**WEBSITE**

[www.plujeme.cz](http://www.plujeme.cz)



**E-MAIL**

[info@plujeme.cz](mailto:info@plujeme.cz)



**PHONE**

+420 720 755 085



**MOBILE**

+420 777 170 276



**PLUJEME RÁDI S.R.O.**

Dlouhá 730/35, 11000 Praha 1 - Staré Město, Czech Republic

## PRICE AND AVAILABILITY

|  |  |  |  |
|--|--|--|--|
| 28.11. - 05.12.2024<br>NOT AVAILABLE   | 05.12. - 14.12.2024<br>NOT AVAILABLE   | 14.12. - 21.12.2024<br>NOT AVAILABLE   | 21.12. - 28.12.2024<br>NOT AVAILABLE   |
| 28.12. - 04.01.2025<br>ON OPTION       | 04.01. - 11.01.2025<br>NOT AVAILABLE   | 11.01. - 18.01.2025<br>4.319 € 6.170 € | 19.01. - 26.01.2025<br>NOT AVAILABLE   |
| 01.02. - 08.02.2025<br>4.305 € 6.150 € | 08.02. - 15.02.2025<br>4.305 € 6.150 € | 15.02. - 22.02.2025<br>5.079 € 7.255 € | 22.02. - 26.02.2025<br>NOT AVAILABLE   |
| 01.03. - 08.03.2025<br>4.113 € 5.875 € | 08.03. - 15.03.2025<br>4.113 € 5.875 € | 15.03. - 22.03.2025<br>NOT AVAILABLE   | 22.03. - 29.03.2025<br>4.116 € 5.880 € |
| 29.03. - 05.04.2025<br>5.865 €         | 05.04. - 19.04.2025<br>NOT AVAILABLE   | 19.04. - 26.04.2025<br>6.280 €         | 26.04. - 03.05.2025<br>5.540 €         |
| 03.05. - 10.05.2025<br>3.878 € 5.540 € | 10.05. - 17.05.2025<br>3.878 € 5.540 € | 17.05. - 24.05.2025<br>3.878 € 5.540 € | 24.05. - 31.05.2025<br>3.878 € 5.540 € |
| 31.05. - 07.06.2025<br>3.878 € 5.540 € | 07.06. - 14.06.2025<br>3.707 € 5.295 € | 14.06. - 21.06.2025<br>3.707 € 5.295 € | 21.06. - 28.06.2025<br>3.707 € 5.295 € |



WEBSITE

[www.plujeme.cz](http://www.plujeme.cz)



E-MAIL

[info@plujeme.cz](mailto:info@plujeme.cz)



PHONE

+420 720 755 085



MOBILE

+420 777 170 276



PLUJEME RÁDI S.R.O.

Dlouhá 730/35, 11000 Praha 1 – Staré Město, Czech Republic

## PRICE AND AVAILABILITY

|  |  |  |  |
|--|--|--|--|
| 01.07. - 08.07.2025<br>NOT AVAILABLE   | 12.07. - 19.07.2025<br>4.912 € 5.170 € | 19.07. - 26.07.2025<br>4.912 € 5.170 € | 26.07. - 02.08.2025<br>4.332 € 4.560 € |
| 02.08. - 09.08.2025<br>3.729 € 3.925 € | 09.08. - 16.08.2025<br>3.282 € 3.455 € | 16.08. - 23.08.2025<br>3.282 € 3.455 € | 23.08. - 30.08.2025<br>3.282 € 3.455 € |
| 30.08. - 06.09.2025<br>3.282 € 3.455 € | 06.09. - 13.09.2025<br>3.282 € 3.455 € | 13.09. - 20.09.2025<br>3.282 € 3.455 € | 20.09. - 27.09.2025<br>3.282 € 3.455 € |
| 27.09. - 04.10.2025<br>3.282 € 3.455 € | 04.10. - 11.10.2025<br>3.050 € 3.210 € | 11.10. - 18.10.2025<br>3.306 € 3.480 € | 18.10. - 25.10.2025<br>3.563 € 3.750 € |
| 25.10. - 01.11.2025<br>3.753 € 3.950 € | 01.11. - 08.11.2025<br>3.952 € 4.160 € | 08.11. - 15.11.2025<br>4.199 € 4.420 € | 15.11. - 22.11.2025<br>4.028 € 4.240 € |
| 22.11. - 29.11.2025<br>4.437 € 4.670 € | 29.11. - 06.12.2025<br>4.028 € 4.240 € | 06.12. - 13.12.2025<br>3.715 € 3.910 € | 13.12. - 20.12.2025<br>3.715 € 3.910 € |
| 20.12. - 27.12.2025<br>7.947 € 8.365 € |  |  |  |



WEBSITE

[www.plujeme.cz](http://www.plujeme.cz)



E-MAIL

[info@plujeme.cz](mailto:info@plujeme.cz)



PHONE

+420 720 755 085



MOBILE

+420 777 170 276



PLUJEME RÁDI S.R.O.

Dlouhá 730/35, 11000 Praha 1 – Staré Město, Czech Republic