

# FOUNTAIN PAJOT AURA 51

Endless Summer (2022)

Catamaran Fountaine Pajot Aura 51 Endless Summer, built in 2022 is anchored in the BVI, Tortola, Nanny Cay Marina, British Virgin Islands, British Virgin Islands. It has 6 cabins, can accommodate 12 + 2 people and has 6 toilets. Bed linen and kitchen equipment are included in the price.

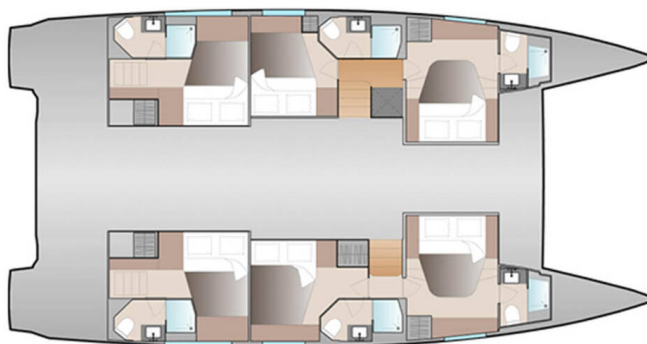

## YACHT SPECIFICATIONS

Yacht Base

**BVI, Tortola, Nanny Cay Marina,  
British Virgin Islands**

Yacht ID

**4545**

Brands

**Fountaine Pajot**

Yacht name

**Endless Summer**

Production year

**2022**

Length

**51 ft**

Cabins

**6**

Berths

**12 + 2**

Max Persons

**12**

WC

**6**

Engine

**2 x 75 HP**

Fuel tank

**900 l**



**WEBSITE**

[www.plujeme.cz](http://www.plujeme.cz)



**PHONE**

+420 720 755 085



**MOBILE**

+420 777 170 276



**E-MAIL**

[info@plujeme.cz](mailto:info@plujeme.cz)



**PLUJEME RÁDI S.R.O.**

Dlouhá 730/35, 11000 Praha 1 – Staré Město, Czech Republic

## STANDARD YACHT EQUIPMENT

Comfort	<b>Blankets, Cockpit cushions, Pillows</b>
Deck	<b>Anchor with chain, Bilge pump – Mechanic, Bimini top, Boat hook, Bosun's chair (Safe seat) (boatswain's chair), Cockpit fridge, Cockpit table, Cockpit/stern, outside shower, Deck brush, Dinghy with outboard engine, Electric anchor windlass, Fenders, Gangway, Grill/Barbecue/Plancha, Jerry cans for fuel, Mooring ropes , Plastic bucket, Round/globular fender, Spare anchor (Reserve, Auxiliary anchor), Spring cleats, Swimming ladder, Water hose, Winch handles</b>
Entertainment	<b>Fins, Fusion radio, FUSION sound system, Mask and snorkel, Stand up paddle (SUP) - FREE</b>
Galley	<b>Bin bag, Blender, Dishwasher, Electrical filter coffee maker, Freezer, Gas bottles, Gas cookers, Kitchen towel, Kitchen utensils (Galley equipment, cutlery), Microwave, Oven, Refrigerator, Water pump</b>
Interior	<b>Clothes hangers, Electric fans in cabins, Electric toilet, Toilet brush</b>
Navigation	<b>Autopilot, Binoculars, Compass, GPS chart plotter, LED Navigation lights, Nautical charts, Navigation set, Radar reflector, Tridata, Windex</b>
Safety	<b>Black Water Tank, Distress flare box, Fire extinguisher , First aid kit , Flashlight, Fog horn, Horseshoe lifebuoy, Life belts (Safety harness), Life jacket (children), Life jackets, Liferaft , Rescue sling (Life sling), Set of tools , Signal flags, Torch, VHF radio , Wire (shroud) cutter</b>
Sails	<b>Electric winch, Lazy bag, Winch</b>
Yacht electrics	<b>110V socket, Air Conditioning, Batteries, Bilge pump – Electric, Generator, Inverter, Shore power cable, Start battery, USB sockets, Water heater, Watermaker – desalinator, WC pump</b>



**WEBSITE**

[www.plujeme.cz](http://www.plujeme.cz)



**PHONE**

+420 720 755 085



**MOBILE**

+420 777 170 276



**E-MAIL**

[info@plujeme.cz](mailto:info@plujeme.cz)



**PLUJEME RÁDI S.R.O.**

Dlouhá 730/35, 11000 Praha 1 – Staré Město, Czech Republic

## SERVICES

SELECTED SERVICES	OBLIGATORY	PAYMENT TYPE	PRICE
<b>Cruising tax</b> (Payable now) <b>Season: 2025.</b> BVI: Cruising tax payable in advance: 4 USD per person / day (Price will be adjusted when the option is confirmed)	Yes	per guest/day	<b>3,48 €</b>
<b>Navigare Carefree</b> (Payable now) <b>Season: 2025.</b> *** To be added upon client's price - OBLIGATORY - CAT from 46 ft - BVI - Includes damage waiver insurance/full coverage* - NEW!, welcome package, final cleaning, bed sheets & towels, dinghy, outboard engine & fuel, propane gas, full water tanks, snorkelling equipment, National parks permits and VISAR . Beach towels are provided 1 per person for the charter. Yacht Fuel is not included - the fuel tank will be full when your charter starts and you are responsible for topping off the fuel tank at the end of your charter. ***** CRUISING TAX is NOT INCLUDED.	Yes	per booking	<b>840,00 €</b>
<b>APA (Advance Provisioning Allowance)</b> (Payable now) <b>Season: 2025.</b> The APA amount is used to cover all expenses during the course of the charter such as fuel, food, beverages, mooring fee and other expenses not included in the Charter Fee. The captain of the yacht is responsible for accounting for all APA expenses during the charter, and the breakdown will be presented to the client at the end of the charter. (AVAILABLE ONLY WHEN BOOKED WITH NAVIGARE SKIPPER AND HOSTESS OR COOK)	No	per week	<b>4.000,00 €</b>
<b>Checkout Skipper</b> (Payable now) <b>Season: 2025.</b> A check-out skipper (COS) is a professional captain that boards with you on Day 1, and is dropped off late afternoon the same day. A COS may be requested by you or may be required by Navigare after review of your sailing resume.	No	per booking	<b>370,00 €</b>
<b>Cook</b> (Payable now) <b>Season: 2025.</b> Cook requires standard cabin with access to a toilet and shower + food. A gratuity of 15-20% of the crew fee is customary for excellent service. Cooking breakfast, lunch, dinners, and supplies, keeping the kitchen clean (not the rest of the boat, not the cabins). ***NOTE: Cook details will be available 3 days before the charter.	No	per day + food	<b>240,00 €</b>
<b>Extra cleaning</b> (Payable now) <b>Season: 2025.</b> Cleaning and new bed linen and towels	No	per booking	<b>350,00 €</b>

<b>Sailing Instructor</b> (Payable at the base) <b>Season: 2025.</b> Sailing instructor BVI	No	per day + food	<b>350,00 €</b>
<b>Skipper</b> (Payable now) <b>Season: 2025.</b> Skipper requires standard cabin with access to a toilet and shower + food (not peak skipper cabin). A gratuity of 15-20% of the crew fee is customary for excellent service ***NOTE: Skipper details will be available 3 days before the charter.	No	per day + food	<b>295,00 €</b>
<b>Skipper</b> (Payable now) <b>Season: 2025.</b> Skipper using crew-cabin (peak cabin) with access to a toilet and shower*** Gratuity A gratuity of 15-20% of the crew fee is customary for excellent service ***NOTE: Skipper details will be available 3 days before the charter	No	per day + food	<b>345,00 €</b>
<b>Sleep over before check in</b> (Payable now) <b>Season: 2025.</b> Sleep over on a day before the check-in: Sleep over from 5PM on a day before the check-in date and time stated in the contract: 65% of the daily rate. (Price will be adjusted when the option is confirmed)	No	per booking	<b>1.000,00 €</b>
<b>WIFI package</b> (Payable now) <b>Season: 2025.</b> Unlimited Wifi / BVI / BAH / CAR	No	per booking	<b>130,44 €</b>



**WEBSITE**  
www.plujeme.cz



**PHONE**  
+420 720 755 085



**MOBILE**  
+420 777 170 276



**E-MAIL**  
info@plujeme.cz



**PLUJEME RÁDI S.R.O.**  
Dlouhá 730/35, 11000 Praha 1 – Staré Město, Czech Republic

## ADDITIONAL EXTRAS

EXTRA	OBLIGATORY	PAYMENT TYPE	PRICE
<b>Railing net (Safety net)</b> <i>(Payable now)</i> <b>Season: 2025.</b> <i>mounting not included - Payable now</i>	No	per booking	<b>155,00 €</b>
<b>Stand up paddle (SUP)</b> <i>(Payable now)</i> <b>Season: 2025.</b> <i>Payable now</i>	No	per day	<b>20,00 €</b>

**WEBSITE**

[www.plujeme.cz](http://www.plujeme.cz)

**E-MAIL**

[info@plujeme.cz](mailto:info@plujeme.cz)

**PHONE**

+420 720 755 085

**MOBILE**

+420 777 170 276

**PLUJEME RÁDI S.R.O.**

Dlouhá 730/35, 11000 Praha 1 – Staré Město, Czech Republic

## PRICE AND AVAILABILITY

16.11. - 23.11.2024 17.250 €	23.11. - 30.11.2024 12.075 € 17.250 €	30.11. - 12.12.2024 NOT AVAILABLE	14.12. - 21.12.2024 13.190 €
25.12. - 01.01.2025 NOT AVAILABLE	02.01. - 10.01.2025 ON OPTION	10.01. - 19.01.2025 NOT AVAILABLE	20.01. - 29.01.2025 ON OPTION
01.02. - 09.02.2025 NOT AVAILABLE	13.02. - 24.02.2025 NOT AVAILABLE	24.02. - 04.03.2025 NOT AVAILABLE	11.03. - 19.03.2025 NOT AVAILABLE
22.03. - 29.03.2025 16.507 € 19.420 €	01.04. - 09.04.2025 NOT AVAILABLE	18.04. - 28.04.2025 NOT AVAILABLE	02.05. - 09.05.2025 ON OPTION
09.05. - 17.05.2025 NOT AVAILABLE	17.05. - 24.05.2025 NOT AVAILABLE	24.05. - 03.06.2025 NOT AVAILABLE	07.06. - 14.06.2025 13.572 € 15.080 €
14.06. - 21.06.2025 ON OPTION	21.06. - 28.06.2025 ON OPTION		



WEBSITE

[www.plujeme.cz](http://www.plujeme.cz)



E-MAIL

[info@plujeme.cz](mailto:info@plujeme.cz)



PHONE

+420 720 755 085



MOBILE

+420 777 170 276



PLUJEME RÁDI S.R.O.

Dlouhá 730/35, 11000 Praha 1 – Staré Město, Czech Republic

## PRICE AND AVAILABILITY

05.07. - 10.07.2025 NOT AVAILABLE	10.07. - 22.07.2025 NOT AVAILABLE	25.07. - 02.08.2025 NOT AVAILABLE	04.08. - 10.10.2025 NOT AVAILABLE
11.10. - 18.10.2025 9.999 € 11.110 €	18.10. - 25.10.2025 9.999 € 11.110 €	25.10. - 01.11.2025 9.999 € 11.110 €	01.11. - 08.11.2025 9.999 € 11.110 €
08.11. - 15.11.2025 13.572 € 15.080 €	15.11. - 22.11.2025 13.572 € 15.080 €	22.11. - 29.11.2025 13.572 € 15.080 €	29.11. - 06.12.2025 13.572 € 15.080 €
06.12. - 13.12.2025 13.572 € 15.080 €	13.12. - 20.12.2025 13.572 € 15.080 €	20.12. - 27.12.2025 16.860 €	



### WEBSITE

[www.plujeme.cz](http://www.plujeme.cz)



### E-MAIL

[info@plujeme.cz](mailto:info@plujeme.cz)



### PHONE

+420 720 755 085



### MOBILE

+420 777 170 276



### PLUJEME RÁDI S.R.O.

Dlouhá 730/35, 11000 Praha 1 – Staré Město, Czech Republic