

LAGOON 46

PRESTIGE (2022)

Catamaran Lagoon 46 PRESTIGE, built in 2022 is anchored in the **Capo D'orlando Marina, Sicily, Italy**. It has **4 + 2 cabins**, can accommodate **8 + 2 people** and has **4 toilets**. Bed linen and kitchen equipment are included in the price.

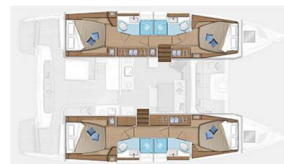

YACHT SPECIFICATIONS

Yacht Base

Capo D'orlando Marina, Italy

Yacht ID

4416

Brands

Lagoon

Yacht name

PRESTIGE

Production year

2022

Length

46 ft

Cabins

4 + 2

Berths

8 + 2

Max Persons

10

WC

4

Engine

2 x 45 HP

Fuel tank

1040 l



WEBSITE

www.plujeme.cz



PHONE

+420 720 755 085



MOBILE

+420 777 170 276



E-MAIL

info@plujeme.cz



PLUJEME RÁDI S.R.O.

Dlouhá 730/35, 11000 Praha 1 – Staré Město, Czech Republic

STANDARD YACHT EQUIPMENT

Comfort	Cockpit cushions
Deck	Anchor, Bimini top, Cockpit/stern, outside shower, Deck brush, Dinghy, Electric anchor windlass, Fenders, Outboard engine, Plastic bucket, Sprayhood
Entertainment	Fusion radio, Outdoor speakers, USB
Galley	Hot water, Kitchen utensils (Galley equipment, cutlery), Oven, Refrigerator, Stove
Interior	Convertible table in salon, Electric toilet, Inside shower
Navigation	Autopilot, Compass, GPS, GPS chart plotter, Logge/Lot/Speed, Nautical charts, Navigation set, Wind instrument/Anemometer
Safety	Black Water Tank, Fire extinguisher , First aid kit , Flashlight, Safety equipment, Set of tools , VHF radio
Sails	Lazy bag, Lazy jacks
Yacht electrics	Air Conditioning, Generator, Solar panels, Watermaker - desalinator



WEBSITE

www.plujeme.cz



E-MAIL

info@plujeme.cz



PHONE

+420 720 755 085



MOBILE

+420 777 170 276



PLUJEME RÁDI S.R.O.

Dlouhá 730/35, 11000 Praha 1 – Staré Město, Czech Republic

SERVICES

SELECTED SERVICES	OBLIGATORY	PAYMENT TYPE	PRICE
Service Pack (Payable at the base) Season: 2024. end-cleaning, water / 1x cooking gaz bottle at the departure, batteries, linen equipment (towels included) for each crew member	Yes	per booking	350,00 €
Service Pack (Payable at the base) Season: 2024. end-cleaning, water / 1x cooking gaz bottle at the departure, batteries, linen equipment (towels included) for each crew member	Yes	per booking	410,00 €
Service Pack (Payable at the base) Season: 2025. end-cleaning, water / 1x cooking gaz bottle at the departure, batteries, linen equipment (towels included) for each crew member	Yes	per booking	410,00 €
Service Pack (Payable at the base) Season: 2025. end-cleaning, water / 1x cooking gaz bottle at the departure, batteries, linen equipment (towels included) for each crew member	Yes	per booking	450,00 €
Early Check in (Payable at the base) Season: 2024. embarkation at 13:00h option is subject to the condition that the yacht returns without damage from the previous charter	Yes	per booking	200,00 €
Harbour and marine fee (Payable at the base) Season: 2024. for the first and the last charter-night	Yes	per booking	0,00 €
Hostess (Payable at the base) Season: 2024. Hostess' meals are not included and are covered by the customer	Yes	per day	185,00 €
Non refundable deposit/ insurance (Payable at the base) Season: 2024. without security deposit; payable only by credit card	Yes	per day	60,00 €
Skipper (Payable at the base) Season: 2024.	Yes	per day	200,00 €
Starter pack (Payable at the base) Season: 2024. washing up liquid, sponge, rubbish bags, matches, toilet & kitchen rolls, fruit plate, water, orange juice, wine, packet of biscuits, individual sachets of tea, coffee, sugar, milk	Yes	per booking	50,00 €
WI-FI Internet connection on boat (Payable at the base) Season: 2024. 5GB	Yes	per week	30,00 €

WI-FI Internet connection on boat (Payable at the base) <i>Season: 2024. 10GB</i>	Yes	per week	40,00 €
WI-FI Internet connection on boat (Payable at the base) <i>Season: 2024. 20GB</i>	Yes	per week	50,00 €
WI-FI Internet connection on boat (Payable at the base) <i>Season: 2024. 5GB</i>	Yes	per week	50,00 €
WI-FI Internet connection on boat (Payable at the base) <i>Season: 2024. 20GB</i>	Yes	per week	70,00 €
WI-FI Internet connection on boat (Payable at the base) <i>Season: 2024. 5GB</i>	Yes	per week	80,00 €
Early Check in (Payable at the base) <i>Season: 2025. Embarkation at 13:00h option is subject to the condition that the yacht returns without damages from the previous charter</i>	Yes	per booking	300,00 €
Harbour and marine fee (Payable at the base) <i>Season: 2025. for the first and the last charter-night</i>	Yes	per booking	0,00 €
Hostess (Payable at the base) <i>Season: 2025. Hostess' meals are not included and are covered by the customer</i>	Yes	per day + food	185,00 €
Non refundable deposit/ insurance (Payable at the base) <i>Season: 2025. without security deposit; payable only by credit card</i>	Yes	per day	60,00 €
Non refundable deposit/ insurance (Payable at the base) <i>Season: 2025. Option #2 with Security Deposit) Optional non-refundable deposit per day. payable only by credit card at base. Payable only by credit card (Minimum Charge: 7 days)</i>	Yes	per day	50,00 €
Starter pack (Payable at the base) <i>Season: 2025. washing up liquid, sponge, rubbish bags, matches, toilet & kitchen rolls, fruit plate, water, orange juice, wine, packet of biscuits, individual sachets of tea, coffee, sugar, milk</i>	Yes	per booking	60,00 €
WI-FI Internet connection on boat (Payable at the base) <i>Season: 2025. 5GB</i>	Yes	per week	30,00 €
WI-FI Internet connection on boat (Payable at the base) <i>Season: 2025. 10GB</i>	Yes	per week	40,00 €

WI-FI Internet connection on boat (Payable at the base) <i>Season: 2025. 20GB</i>	Yes	per week	50,00 €
WI-FI Internet connection on boat (Payable at the base) <i>Season: 2025. 5GB</i>	Yes	per week	50,00 €
WI-FI Internet connection on boat (Payable at the base) <i>Season: 2025. 20GB</i>	Yes	per week	70,00 €
WI-FI Internet connection on boat (Payable at the base) <i>Season: 2025. 5GB</i>	Yes	per week	80,00 €



WEBSITE
www.plujeme.cz



E-MAIL
info@plujeme.cz



PHONE
+420 720 755 085



MOBILE
+420 777 170 276



PLUJEME RÁDI S.R.O.
Dlouhá 730/35, 11000 Praha 1 – Staré Město, Czech Republic

ADDITIONAL EXTRAS

EXTRA	OBLIGATORY	PAYMENT TYPE	PRICE
Extra bedlinen (Payable at the base) Season: 2024. Payable at the base	Yes	per person	15,00 €
Railing net (Safety net) (Payable at the base) Season: 2024. Payable at the base	Yes	per booking	150,00 €
Stand up paddle (SUP) (Payable at the base) Season: 2024. inflatable + 300 EUR security deposit - Payable at the base	Yes	per week	150,00 €
Extra bedlinen (Payable at the base) Season: 2025. Payable at the base	Yes	per person	15,00 €
Railing net (Safety net) (Payable at the base) Season: 2025. Payable at the base	Yes	per booking	300,00 €
Stand up paddle (SUP) (Payable at the base) Season: 2025. + 300 EUR security deposit - Payable at the base	Yes	per week	130,00 €

**WEBSITE**www.plujeme.cz**E-MAIL**info@plujeme.cz**PHONE**

+420 720 755 085

**MOBILE**

+420 777 170 276

**PLUJEME RÁDI S.R.O.**

Dlouhá 730/35, 11000 Praha 1 – Staré Město, Czech Republic

PRICE AND AVAILABILITY

21.09. - 28.09.2024 NOT AVAILABLE	28.09. - 05.10.2024 5.428 € 7.754 €	05.10. - 12.10.2024 5.428 € 7.754 €	12.10. - 19.10.2024 5.428 € 7.754 €
19.10. - 26.10.2024 5.428 € 7.754 €	26.10. - 02.11.2024 5.428 € 7.754 €	02.11. - 09.11.2024 5.428 € 7.754 €	09.11. - 16.11.2024 5.428 € 7.754 €
16.11. - 23.11.2024 5.428 € 7.754 €	23.11. - 30.11.2024 5.428 € 7.754 €	30.11. - 30.12.2024 NOT AVAILABLE	01.01. - 28.02.2025 NOT AVAILABLE
01.03. - 08.03.2025 5.583 € 6.979 €	08.03. - 15.03.2025 5.583 € 6.979 €	15.03. - 22.03.2025 5.583 € 6.979 €	22.03. - 29.03.2025 5.583 € 6.979 €
29.03. - 05.04.2025 5.583 € 6.979 €	05.04. - 12.04.2025 5.583 € 6.979 €	12.04. - 19.04.2025 5.583 € 6.979 €	19.04. - 26.04.2025 5.583 € 6.979 €
26.04. - 03.05.2025 5.583 € 6.979 €			



WEBSITE
www.plujeme.cz



E-MAIL
info@plujeme.cz



PHONE
+420 720 755 085



MOBILE
+420 777 170 276



PLUJEME RÁDI S.R.O.
Dlouhá 730/35, 11000 Praha 1 – Staré Město, Czech Republic

PRICE AND AVAILABILITY

03.05. - 10.05.2025 5.583 € 6.979 €	10.05. - 17.05.2025 5.583 € 6.979 €	17.05. - 24.05.2025 5.583 € 6.979 €	24.05. - 31.05.2025 8.145 € 10.181 €
31.05. - 07.06.2025 8.145 € 10.181 €	07.06. - 14.06.2025 8.145 € 10.181 €	14.06. - 21.06.2025 8.145 € 10.181 €	21.06. - 28.06.2025 9.050 € 11.313 €
28.06. - 05.07.2025 9.050 € 11.313 €	05.07. - 12.07.2025 9.050 € 11.313 €	12.07. - 19.07.2025 9.050 € 11.313 €	19.07. - 26.07.2025 9.050 € 11.313 €
26.07. - 02.08.2025 9.050 € 11.313 €	02.08. - 09.08.2025 10.182 € 11.313 €	09.08. - 16.08.2025 12.727 € 14.141 €	16.08. - 23.08.2025 12.727 € 14.141 €
23.08. - 30.08.2025 8.145 € 10.181 €	30.08. - 06.09.2025 8.145 € 10.181 €	06.09. - 13.09.2025 8.145 € 10.181 €	13.09. - 20.09.2025 8.145 € 10.181 €
20.09. - 27.09.2025 5.583 € 6.979 €	27.09. - 04.10.2025 5.583 € 6.979 €	04.10. - 11.10.2025 5.583 € 6.979 €	11.10. - 18.10.2025 5.583 € 6.979 €
18.10. - 25.10.2025 5.583 € 6.979 €	25.10. - 01.11.2025 5.583 € 6.979 €	01.11. - 08.11.2025 5.583 € 6.979 €	08.11. - 15.11.2025 5.583 € 6.979 €
15.11. - 22.11.2025 5.583 € 6.979 €	22.11. - 29.11.2025 5.583 € 6.979 €	30.11. - 30.12.2025 NOT AVAILABLE	



WEBSITE

www.plujeme.cz



E-MAIL

info@plujeme.cz



PHONE

+420 720 755 085



MOBILE

+420 777 170 276



PLUJEME RÁDI S.R.O.

Dlouhá 730/35, 11000 Praha 1 – Staré Město, Czech Republic