

# LAGOON 42

George A (2019)

Catamaran Lagoon 42 George A, built in 2019 is anchored in the **Kos, Kos Marina, Dodecanese, Greece**. It has **4 + 2 cabins**, can accommodate **8 + 2 + 2 people** and has **4 + 1 toilets**. Bed linen and kitchen equipment are included in the price.

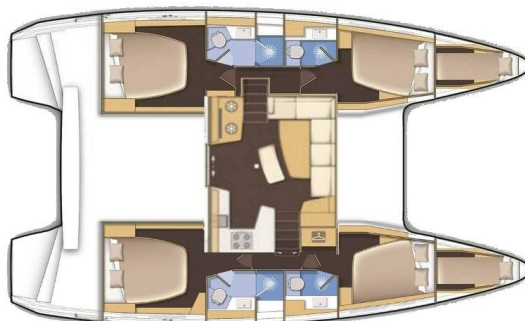

## YACHT SPECIFICATIONS

Yacht Base

**Kos, Kos Marina, Greece**

Yacht ID

**4282**

Brands

**Lagoon**

Yacht name

**George A**

Production year

**2019**

Length

**42 ft**

Cabins

**4 + 2**

Berths

**8 + 2 + 2**

Max Persons

**12**

WC

**4 + 1**

Engine

**2 x 57 HP**

Fuel tank

**600 l**



**WEBSITE**

[www.plujeme.cz](http://www.plujeme.cz)



**PHONE**

+420 720 755 085



**MOBILE**

+420 777 170 276



**E-MAIL**

[info@plujeme.cz](mailto:info@plujeme.cz)



**PLUJEME RÁDI S.R.O.**

Dlouhá 730/35, 11000 Praha 1 – Staré Město, Czech Republic

## STANDARD YACHT EQUIPMENT

Comfort	<b>Cockpit cushions</b>
Deck	<b>Bimini top, Cockpit table, Dinghy, Electric anchor windlass, Hydraulic gangway, Outboard engine, Teak cockpit</b>
Entertainment	<b>Radio with USB</b>
Galley	<b>Refrigerator</b>
Navigation	<b>Autopilot, Depthsounder, GPS chart plotter - cockpit, Speedometer (Speed log), Wind instrument/Anemometer</b>
Safety	<b>Black Water Tank, Horseshoe lifebuoy, Life belts (Safety harness), Life jackets, Liferaft , VHF radio</b>
Sails	<b>Electric winch, Lazy jacks</b>
Yacht electrics	<b>Air Conditioning, Generator, Shore connection 220 V, Solar panels, Watermaker - desalinator</b>



**WEBSITE**

[www.plujeme.cz](http://www.plujeme.cz)



**E-MAIL**

[info@plujeme.cz](mailto:info@plujeme.cz)



**PHONE**

+420 720 755 085



**MOBILE**

+420 777 170 276



**PLUJEME RÁDI S.R.O.**

Dlouhá 730/35, 11000 Praha 1 – Staré Město, Czech Republic

## SERVICES

SELECTED SERVICES	OBLIGATORY	PAYMENT TYPE	PRICE
<b>Charter pack</b> (Payable at the base) <b>Season: 2025.</b> Final cleaning, 2 Bottles (2lt) of water, soap and toilet paper/head, Bed Linen, towels, quilts, one set/cabin (up to 2 weeks), First Gas Bottle, Mooring fees for the first and last day in Marinas/Ports (except electricity and water); payable on the spot in cash	Yes	per booking	<b>310,00 €</b>
<b>Damage waiver</b> (Payable at the base) <b>Season: 2025.</b> + Refundable Security Deposit 1000 €/per charter. Our security policy reduces the client's financial liability in the event of damage to the yacht, damage or loss of ancillary equipment or damage caused by a third party during the charter. The Damage waiver is not refundable under any circumstances and covers loss or accident to the yacht, the equipment, or third party and all risks of damage/theft, whether through negligence or malicious intent, by the skipper or the clients. The refundable deposit covers any damage or loss over the damage waiver amount and the customer's total financial liability will not exceed the amount of the damage waiver and the refundable deposit. Please feel free to contact us for any further info you may require	Yes	per booking	<b>500,00 €</b>
<b>Cabin conversion</b> (Payable at the base) <b>Season: 2025.</b> where applicable	No	per booking	<b>150,00 €</b>
<b>Cook</b> (Payable at the base) <b>Season: 2025.</b> require their own cabin	No	per day + food	<b>200,00 €</b>
<b>Crew change</b> (Payable at the base) <b>Season: 2025.</b> Crew Change during the charter is allowed up to 75%. If it is over than 75%, is considered as a new charter; The skipper remains the same; Includes: water, electricity and marina fees/services; Charter pack for crew changes as per our Price List .	No	per crew change	<b>120,00 €</b>
<b>Early boarding/check-in</b> (Payable at the base) <b>Season: 2025.</b> at 14:00hrs; upon request & subject to no damages from the previous charterer	No	per booking	<b>200,00 €</b>
<b>Hostess</b> (Payable at the base) <b>Season: 2025.</b> Require their own cabin	No	per day + food	<b>190,00 €</b>
<b>Internet pack</b> (Payable at the base) <b>Season: 2025.</b> Wi-Fi router, unlimited	No	per week	<b>50,00 €</b>

<b>Pet on board</b> (Payable at the base) <b>Season: 2025.</b> Pets allowed (up to 7 kg)	No	per booking	<b>200,00 €</b>
<b>Provisioning</b> (Payable at the base) <b>Season: 2025.</b> Provisioning service	No	per booking	<b>20,00 €</b>
<b>Skipper</b> (Payable at the base) <b>Season: 2025.</b> Damage Waiver is compulsory with skippered charter Require their own cabin	No	per day + food	<b>210,00 €</b>
<b>Transfer</b> (Payable at the base) <b>Season: 2025.</b> Kindly contact charter company for the transfer cost. Transfer service upon request (can only be arranged the latest 7 days before embarkation)	No	per booking	<b>0,00 €</b>



**WEBSITE**  
www.plujeme.cz



**E-MAIL**  
info@plujeme.cz



**PHONE**  
+420 720 755 085



**PLUJEME RÁDI S.R.O.**  
Dlouhá 730/35, 11000 Praha 1 – Staré Město, Czech Republic



**MOBILE**  
+420 777 170 276

## ADDITIONAL EXTRAS

EXTRA	OBLIGATORY	PAYMENT TYPE	PRICE
<b>Automatic Inflatable Life Jacket</b> (Payable at the base) <b>Season: 2025.</b> subject to availability - Payable at the base	No	per week/ person	<b>30,00 €</b>
<b>Beach towel</b> (Payable at the base) <b>Season: 2025.</b> yours to keep - Payable at the base	No	per piece	<b>13,00 €</b>
<b>Extra bedlinen and towels</b> (Payable at the base) <b>Season: 2025.</b> 1 set = 2 sheets, 1 pillow case, 1 face towel, 1 bath towel - Payable at the base	No	per set	<b>12,00 €</b>
<b>Grill/Barbecue/Plancha</b> (Payable at the base) <b>Season: 2025.</b> BBQ Instant Grill - Payable at the base	No	per piece	<b>12,00 €</b>
<b>Railing net (Safety net)</b> (Payable at the base) <b>Season: 2025.</b> Payable at the base	No	per booking	<b>200,00 €</b>
<b>Stand up paddle (SUP)</b> (Payable at the base) <b>Season: 2025.</b> plus Refundable Security Deposit € 300 payable by credit card - subject to availability - Payable at the base	No	per week	<b>120,00 €</b>



**WEBSITE**

[www.plujeme.cz](http://www.plujeme.cz)



**E-MAIL**

[info@plujeme.cz](mailto:info@plujeme.cz)



**PHONE**

+420 720 755 085



**MOBILE**

+420 777 170 276



**PLUJEME RÁDI S.R.O.**

Dlouhá 730/35, 11000 Praha 1 – Staré Město, Czech Republic

## PRICE AND AVAILABILITY

05.04. - 12.04.2025 <b>3.360 €</b> 4.200 €	12.04. - 19.04.2025 <b>3.360 €</b> 4.200 €	19.04. - 26.04.2025 <b>4.568 €</b> 5.710 €	26.04. - 03.05.2025 <b>4.568 €</b> 5.710 €
03.05. - 10.05.2025 <b>4.854 €</b> 5.710 €	10.05. - 17.05.2025 <b>4.854 €</b> 5.710 €	17.05. - 31.05.2025 NOT AVAILABLE	31.05. - 07.06.2025 NOT AVAILABLE
07.06. - 14.06.2025 NOT AVAILABLE	14.06. - 21.06.2025 <b>5.857 €</b> 6.890 €	21.06. - 28.06.2025 NOT AVAILABLE	28.06. - 05.07.2025 <b>7.140 €</b> 8.400 €
05.07. - 12.07.2025 ON OPTION	12.07. - 19.07.2025 <b>7.140 €</b> 8.400 €	19.07. - 26.07.2025 NOT AVAILABLE	26.07. - 02.08.2025 <b>8.568 €</b> 10.080 €
02.08. - 09.08.2025 NOT AVAILABLE	09.08. - 16.08.2025 <b>8.568 €</b> 10.080 €	16.08. - 23.08.2025 <b>8.568 €</b> 10.080 €	23.08. - 30.08.2025 <b>7.140 €</b> 8.400 €
30.08. - 06.09.2025 <b>7.140 €</b> 8.400 €			



WEBSITE

[www.plujeme.cz](http://www.plujeme.cz)



E-MAIL

[info@plujeme.cz](mailto:info@plujeme.cz)



PHONE

+420 720 755 085



MOBILE

+420 777 170 276



PLUJEME RÁDI S.R.O.

Dlouhá 730/35, 11000 Praha 1 – Staré Město, Czech Republic

## PRICE AND AVAILABILITY

06.09. - 13.09.2025 <b>7.140 €</b> 8.400 €	13.09. - 20.09.2025 NOT AVAILABLE	20.09. - 27.09.2025 NOT AVAILABLE	27.09. - 11.10.2025 NOT AVAILABLE
11.10. - 18.10.2025 <b>3.570 €</b> 4.200 €	18.10. - 25.10.2025 <b>3.570 €</b> 4.200 €	25.10. - 01.11.2025 <b>3.570 €</b> 4.200 €	01.11. - 08.11.2025 <b>3.570 €</b> 4.200 €
08.11. - 15.11.2025 <b>3.570 €</b> 4.200 €	15.11. - 22.11.2025 <b>3.570 €</b> 4.200 €	22.11. - 29.11.2025 <b>3.570 €</b> 4.200 €	29.11. - 06.12.2025 <b>3.570 €</b> 4.200 €
06.12. - 13.12.2025 <b>4.200 €</b>	13.12. - 20.12.2025 <b>4.200 €</b>	20.12. - 27.12.2025 <b>4.200 €</b>	



### WEBSITE

[www.plujeme.cz](http://www.plujeme.cz)



### E-MAIL

[info@plujeme.cz](mailto:info@plujeme.cz)



### PHONE

+420 720 755 085



### MOBILE

+420 777 170 276



### PLUJEME RÁDI S.R.O.

Dlouhá 730/35, 11000 Praha 1 – Staré Město, Czech Republic