

# BALI 4.8

Aldebaran (2021)

Catamaran Bali 4.8 Aldebaran, built in 2021 is anchored in the Marina Kornati, Biograd, Zadar region, Croatia. It has 6 + 1 cabins, can accommodate 12 + 1 people and has 7 toilets. Bed linen and kitchen equipment are included in the price.

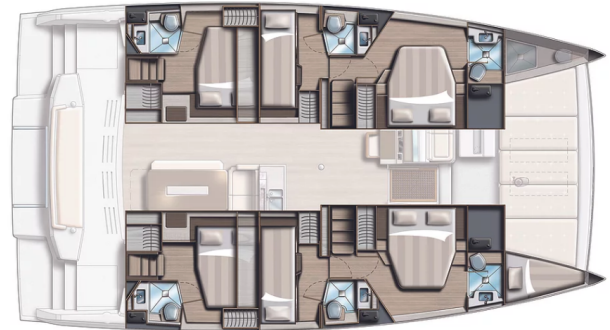

## YACHT SPECIFICATIONS

Yacht Base

**Marina Kornati, Biograd, Croatia**

Yacht ID

**4113**

Brands

**Catana**

Yacht name

**Aldebaran**

Production year

**2021**

Length

**49 ft**

Cabins

**6 + 1**

Berths

**12 + 1**

Max Persons

**13**

WC

**7**

Engine

**2 x 57 HP**

Fuel tank

**1000 l**



**WEBSITE**

[www.plujeme.cz](http://www.plujeme.cz)



**PHONE**

+420 720 755 085



**MOBILE**

+420 777 170 276



**E-MAIL**

[info@plujeme.cz](mailto:info@plujeme.cz)



**PLUJEME RÁDI S.R.O.**

Dlouhá 730/35, 11000 Praha 1 – Staré Město, Czech Republic

## STANDARD YACHT EQUIPMENT

Comfort	<b>Bed linen, Cockpit cushions, Sun mattresses</b>
Deck	<b>Bathing platform, Bimini top, Cockpit table, Cockpit/stern, outside shower, Dinghy, Flybridge, Forward cockpit</b>
Entertainment	<b>Outdoor speakers, Radio CD player, Wi-Fi Internet</b>
Galley	<b>Freezer, Hot water, Ice maker, Kitchen utensils (Galley equipment, cutlery), Oven, Refrigerator, Stove</b>
Interior	<b>Electric toilet</b>
Navigation	<b>Autopilot, GPS chart plotter, Navigation (Nautical) charts and nautical guide , Pilot book, Tridata</b>
Safety	<b>VHF radio</b>
Sails	<b>Electric halyard winch</b>
Yacht electrics	<b>Air Conditioning, Battery charger , Generator, Heating, Inverter, Solar panels, Watermaker - desalinator</b>



**WEBSITE**

[www.plujeme.cz](http://www.plujeme.cz)



**E-MAIL**

[info@plujeme.cz](mailto:info@plujeme.cz)



**PHONE**

+420 720 755 085



**MOBILE**

+420 777 170 276



**PLUJEME RÁDI S.R.O.**

Dlouhá 730/35, 11000 Praha 1 – Staré Město, Czech Republic

## SERVICES

SELECTED SERVICES	OBLIGATORY	PAYMENT TYPE	PRICE
<b>Charter pack</b> (Payable at the base) <b>Season: 2024.</b> includes final cleaning, bedding, basic toiletries, bathroom towels, beach towels, RIB/dinghy + outboard engine 2.5hp, wifi 20GB	Yes	per booking	<b>680,00 €</b>
<b>Charter pack</b> (Payable at the base) <b>Season: 2025.</b> includes final cleaning, bedding, basic toiletries, bathroom towels, beach towels, RIB/dinghy + outboard engine 2.5hp, wifi 20GB	Yes	per booking	<b>680,00 €</b>
<b>Deposit insurance</b> (Payable at the base) <b>Season: 2024.</b> + 500 EUR refundable deposit	Yes	per booking	<b>440,00 €</b>
<b>Early Check in</b> (Payable at the base) <b>Season: 2024.</b> Saturdays between 13hr - 14hr. Early check in can be confirmed only on embarkation day in the charter base.	Yes	per booking	<b>250,00 €</b>
<b>Flexible booking</b> (Payable now) <b>Season: 2024.</b> allows you to cancel or rebook your charter up to 30 days before the embarkation for no specific reason. You can reschedule your holiday at no cost for unlimited number of times or use a credit note if you are uncertain of new charter dates. With our FLEX PLAN your rebooking costs are completely eliminated while cancellation costs with refund option are reduced to a minimum (15% of the charter fee, min 350 EUR). Extra bonus: free cancellation and FULL REFUND granted in case of closed state borders within 7 days before the embarkation. Notes: FLEX PLAN costs 7% of the final charter price, can be added to booking up to 72hr after booking confirmation and is not available for bookings confirmed within 30 days before the embarkation.	Yes	per booking	<b>0,00 €</b>
<b>Hostess</b> (Payable at the base) <b>Season: 2024.</b>	Yes	per week + food	<b>1.400,00 €</b>
<b>Late check out</b> (Payable at the base) <b>Season: 2024.</b> Saturdays till 10hr Late check-out can be confirmed only on Friday before the embarkation day.	Yes	per booking	<b>350,00 €</b>
<b>One way fee</b> (Payable at the base) <b>Season: 2024.</b> Bio - Kas / Seg On request only. One-way conditions: one way fee + skippers daily fee + berth charges in port of embarkation/dise embarkation	Yes	per booking	<b>480,00 €</b>

<b>Parking</b> (Payable at the base) <b>Season: 2024.</b> Per Car/week – parking place within Marina Baotić, can be ordered in advance and paid in our office (limited availability)	Yes	per week	<b>50,00 €</b>
<b>Provisioning</b> (Payable now) <b>Season: 2024.</b> upon request + price of groceries, to be done online	Yes	per booking	<b>0,00 €</b>
<b>Skipper</b> (Payable at the base) <b>Season: 2024.</b>	Yes	per week + food	<b>1.680,00 €</b>
<b>Early Check in</b> (Payable at the base) <b>Season: 2025.</b> Saturdays between 13hr - 14hr. Early check in can be confirmed only on embarkation day in the charter base.	Yes	per booking	<b>250,00 €</b>
<b>Flexible booking</b> (Payable now) <b>Season: 2025.</b> allows you to cancel or rebook your charter up to 30 days before the embarkation for no specific reason. You can reschedule your holiday at no cost for unlimited number of times or use a credit note if you are uncertain of new charter dates. With our FLEX PLAN your rebooking costs are completely eliminated while cancellation costs with refund option are reduced to a minimum (15% of the charter fee, min 350 EUR). Extra bonus: free cancellation and FULL REFUND granted in case of closed state borders within 7 days before the embarkation. Notes: FLEX PLAN costs 7% of the final charter price, can be added to booking up to 72hr after booking confirmation and is not available for bookings confirmed within 30 days before the embarkation.	Yes	per booking	<b>0,00 €</b>
<b>Hostess</b> (Payable at the base) <b>Season: 2025.</b>	Yes	per week + food	<b>1.400,00 €</b>
<b>Late check out</b> (Payable at the base) <b>Season: 2025.</b> Saturdays till 10hr Late check-out can be confirmed only on Friday before the embarkation day.	Yes	per booking	<b>350,00 €</b>
<b>One way fee</b> (Payable at the base) <b>Season: 2025.</b> Bio - Kas / Seg On request only. One-way conditions: one way fee + skippers daily fee + berth charges in port of embarkation/disembarkation	Yes	per booking	<b>480,00 €</b>
<b>Parking</b> (Payable at the base) <b>Season: 2025.</b> Per Car/week – parking place within Marina Baotić, can be ordered in advance and paid in our office (limited availability)	Yes	per week	<b>50,00 €</b>
<b>Provisioning</b> (Payable now) <b>Season: 2025.</b> upon request + price of groceries, to be done online	Yes	per booking	<b>0,00 €</b>

**Skipper** (Payable at the base)

Yes

per week + food

**1.680,00 €**

**Season: 2025.**



**WEBSITE**

[www.plujeme.cz](http://www.plujeme.cz)



**E-MAIL**

[info@plujeme.cz](mailto:info@plujeme.cz)



**PHONE**

+420 720 755 085



**MOBILE**

+420 777 170 276



**PLUJEME RÁDI S.R.O.**

Dlouhá 730/35, 11000 Praha 1 – Staré Město, Czech Republic

## ADDITIONAL EXTRAS

EXTRA	OBLIGATORY	PAYMENT TYPE	PRICE
<b>Beach towel</b> (Payable at the base) <b>Season: 2024.</b> Payable at the base	Yes	per piece	<b>8,00 €</b>
<b>eFoil</b> (Payable at the base) <b>Season: 2024.</b> Lift foil; + 230 EUR delivery fee; Refundable safety deposit 1000 EUR 50% cancellation fee in case of cancellation within 2 weeks prior to embarkation - Payable at the base	Yes	per week	<b>2.500,00 €</b>
<b>Extra bedlinen</b> (Payable at the base) <b>Season: 2024.</b> Payable at the base	Yes	per set	<b>15,00 €</b>
<b>Outboard engine 5 HP</b> (Payable at the base) <b>Season: 2024.</b> on request - Payable at the base	Yes	per week	<b>150,00 €</b>
<b>Railing net (Safety net)</b> (Payable at the base) <b>Season: 2024.</b> Rental without mounting - Payable at the base	Yes	per booking	<b>20,00 €</b>
<b>Seabob</b> (Payable at the base) <b>Season: 2024.</b> Seabob F5; + 230 EUR delivery fee; Refundable safety deposit 500 EUR 50% cancellation fee in case of cancellation within 2 weeks prior to embarkation - Payable at the base	Yes	per week	<b>1.300,00 €</b>
<b>Seabob 1</b> (Payable at the base) <b>Season: 2024.</b> Seabob F5s; + 230 EUR delivery fee; Refundable safety deposit 500 EUR 50% cancellation fee in case of cancellation within 2 weeks prior to embarkation - Payable at the base	Yes	per week	<b>1.500,00 €</b>
<b>Snorkeling equipment</b> (Payable at the base) <b>Season: 2024.</b> Payable at the base	Yes	per week	<b>10,00 €</b>
<b>Stand up paddle (SUP)</b> (Payable at the base) <b>Season: 2024.</b> Payable at the base	Yes	per week	<b>120,00 €</b>
<b>Surf board</b> (Payable at the base) <b>Season: 2024.</b> Awake jet surf ; + 230 EUR delivery fee; Refundable safety deposit 1000 EUR 50% cancellation fee in case of cancellation within 2 weeks prior to embarkation - Payable at the base	Yes	per week	<b>2.500,00 €</b>
<b>Towels</b> (Payable at the base) <b>Season: 2024.</b> 2 psc/set (1 x 50x100cm + 1 x 70x140cm) - Payable at the base	Yes	per set	<b>8,00 €</b>

<b>Beach towel</b> (Payable at the base) <b>Season: 2025.</b> Payable at the base	Yes	per piece	<b>8,00 €</b>
<b>Extra bedlinen</b> (Payable at the base) <b>Season: 2025.</b> Payable at the base	Yes	per set	<b>15,00 €</b>
<b>Outboard engine 5 HP</b> (Payable at the base) <b>Season: 2025.</b> on request - Payable at the base	Yes	per week	<b>150,00 €</b>
<b>Railing net (Safety net)</b> (Payable at the base) <b>Season: 2025.</b> Rental without mounting - Payable at the base	Yes	per booking	<b>20,00 €</b>
<b>Snorkeling equipment</b> (Payable at the base) <b>Season: 2025.</b> Payable at the base	Yes	per week	<b>10,00 €</b>
<b>Stand up paddle (SUP)</b> (Payable at the base) <b>Season: 2025.</b> Payable at the base	Yes	per week	<b>120,00 €</b>
<b>Towels</b> (Payable at the base) <b>Season: 2025.</b> 2 psc/set (1 x 50x100cm + 1 x 70x140cm) - Payable at the base	Yes	per set	<b>8,00 €</b>



**WEBSITE**

[www.plujeme.cz](http://www.plujeme.cz)



**E-MAIL**

[info@plujeme.cz](mailto:info@plujeme.cz)



**PHONE**

+420 720 755 085



**MOBILE**

+420 777 170 276



**PLUJEME RÁDI S.R.O.**

Dlouhá 730/35, 11000 Praha 1 – Staré Město, Czech Republic

## PRICE AND AVAILABILITY

21.09. - 28.09.2024 NOT AVAILABLE	28.09. - 05.10.2024 NOT AVAILABLE	05.10. - 12.10.2024 NOT AVAILABLE	12.10. - 19.10.2024 <b>2.488 €</b> 4.850 €
19.10. - 26.10.2024 <b>2.480 €</b> 4.350 €	26.10. - 02.11.2024 <b>2.423 €</b> 4.250 €	03.11. - 31.12.2024 NOT AVAILABLE	01.01. - 28.02.2025 NOT AVAILABLE
01.03. - 08.03.2025 <b>4.038 €</b> 4.250 €	08.03. - 15.03.2025 <b>4.038 €</b> 4.250 €	15.03. - 22.03.2025 <b>4.038 €</b> 4.250 €	22.03. - 29.03.2025 <b>4.038 €</b> 4.250 €
29.03. - 05.04.2025 <b>4.038 €</b> 4.250 €	05.04. - 12.04.2025 <b>3.188 €</b> 4.250 €	12.04. - 19.04.2025 <b>3.338 €</b> 4.450 €	19.04. - 26.04.2025 <b>3.863 €</b> 5.150 €
26.04. - 03.05.2025 <b>4.238 €</b> 5.650 €			



**WEBSITE**  
[www.plujeme.cz](http://www.plujeme.cz)



**E-MAIL**  
[info@plujeme.cz](mailto:info@plujeme.cz)



**PHONE**  
+420 720 755 085



**PLUJEME RÁDI S.R.O.**  
Dlouhá 730/35, 11000 Praha 1 – Staré Město, Czech Republic



**MOBILE**  
+420 777 170 276



## PRICE AND AVAILABILITY

03.05. - 10.05.2025 4.913 € 6.550 €	10.05. - 17.05.2025 6.113 € 8.150 €	17.05. - 24.05.2025 7.313 € 9.750 €	24.05. - 31.05.2025 9.733 € 11.450 €
31.05. - 07.06.2025 10.328 € 12.150 €	07.06. - 14.06.2025 NOT AVAILABLE	14.06. - 21.06.2025 12.283 € 14.450 €	21.06. - 28.06.2025 ON OPTION
28.06. - 05.07.2025 14.355 € 15.950 €	05.07. - 12.07.2025 14.625 € 16.250 €	12.07. - 19.07.2025 15.435 € 17.150 €	19.07. - 26.07.2025 ON OPTION
26.07. - 02.08.2025 15.435 € 17.150 €	02.08. - 09.08.2025 15.435 € 17.150 €	09.08. - 16.08.2025 15.435 € 17.150 €	16.08. - 23.08.2025 13.725 € 15.250 €
23.08. - 30.08.2025 12.555 € 13.950 €	30.08. - 06.09.2025 11.914 € 12.950 €	06.09. - 13.09.2025 11.086 € 12.050 €	13.09. - 20.09.2025 9.154 € 9.950 €
20.09. - 27.09.2025 6.854 € 7.450 €	27.09. - 04.10.2025 5.474 € 5.950 €	04.10. - 11.10.2025 NOT AVAILABLE	11.10. - 18.10.2025 3.638 € 4.850 €
18.10. - 25.10.2025 3.263 € 4.350 €	25.10. - 01.11.2025 3.188 € 4.250 €	01.11. - 08.11.2025 4.038 € 4.250 €	08.11. - 15.11.2025 4.038 € 4.250 €
15.11. - 22.11.2025 4.038 € 4.250 €	22.11. - 29.11.2025 4.038 € 4.250 €	29.11. - 06.12.2025 4.038 € 4.250 €	06.12. - 13.12.2025 4.038 € 4.250 €
13.12. - 20.12.2025 4.038 € 4.250 €	20.12. - 27.12.2025 4.038 € 4.250 €		



WEBSITE

[www.plujeme.cz](http://www.plujeme.cz)



E-MAIL

[info@plujeme.cz](mailto:info@plujeme.cz)



PHONE

+420 720 755 085



MOBILE

+420 777 170 276



PLUJEME RÁDI S.R.O.

Dlouhá 730/35, 11000 Praha 1 – Staré Město, Czech Republic