

BALI 4.6

AMARE (2023)

Catamaran Bali 4.6 AMARE, built in 2023 is anchored in the Cote D'Azur, Port Pin Rolland, Provence-Alpes-Côte d'Azur, France. It has 5 + 1 cabins, can accommodate 10 + 1 people and has 4 + 1 toilets. Bed linen and kitchen equipment are included in the price.

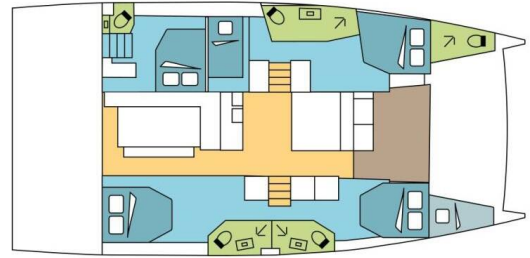

YACHT SPECIFICATIONS

Yacht Base

Cote D'Azur, Port Pin Rolland, France

Yacht ID

4043

Brands

Catana

Yacht name

AMARE

Production year

2023

Length

47 ft

Cabins

5 + 1

Berths

10 + 1

Max Persons

11

WC

4 + 1

Engine

2 x 57 HP

Fuel tank

800 l



WEBSITE

www.plujeme.cz



PHONE

+420 720 755 085



MOBILE

+420 777 170 276



E-MAIL

info@plujeme.cz



PLUJEME RÁDI S.R.O.

Dlouhá 730/35, 11000 Praha 1 – Staré Město, Czech Republic

STANDARD YACHT EQUIPMENT

Deck	Cockpit table, Cockpit/stern, outside shower, Davit, Dinghy, Electric anchor windlass, Outboard engine, Swimming ladder
Entertainment	Radio
Galley	Kitchen utensils (Galley equipment, cutlery), Oven, Refrigerator, Stove
Interior	Electric fans in cabins, Electric toilet
Navigation	Autopilot, GPS chart plotter, Wind/speed/depth instruments
Safety	VHF radio
Sails	Electric main sail winch, Lazy bag, Lazy jacks
Yacht electrics	Air Conditioning, Battery charger , Generator, Inverter, Solar panels, Watermaker - desalinator



WEBSITE

www.plujeme.cz



PHONE

+420 720 755 085



MOBILE

+420 777 170 276



E-MAIL

info@plujeme.cz



PLUJEME RÁDI S.R.O.

Dlouhá 730/35, 11000 Praha 1 – Staré Město, Czech Republic

SERVICES

SELECTED SERVICES	OBLIGATORY	PAYMENT TYPE	PRICE
Essentials pack (Payable now) Season: 2025. INCLUDED: full reduction of security deposit (0 € at base) // starter pack – (1 gallon water or 4 bottles of 1.5L, 1 bottle of disinfectant, 1 small bottle of washing up liquid, 1 dish cloth, 1 sponge, garbage bags, 1 roll of paper towels, 1 box of matches, 1 roll of toilet paper in each head) // final cleaning // 1 set of bed sheets & towels, dinghy, outboard engine & initial supply of fuel, gas and water tanks // DYC assistance guarantee // 1st & last night in the marina /// NOT INCLUDED: refuelling, gas & water consumption at end of charter, taxes if any, handling fees & additional equipment deposit.	Yes	per booking	725,00 €
Handling fees (Payable now) Season: 2025.	Yes	per booking	25,00 €
Crew change (Payable now) Season: 2025. Any crew change during the charter is subject to € 200.- additional cost. The charge includes administration cost, change of bed linen and towels and one night at DYC ponton (marina fee included only if the same base than start base). It doesn't include cleaning, nor new transit log where applicable.	No	per booking	200,00 €
Early boarding/check-in (Payable now) Season: 2025. EB (boat only) – 13:00h, starting time of boat's delivery // limited number of early boardings on same departure day	No	per booking	360,00 €
Early boarding/check-in (Payable now) Season: 2025. EB + extra fee skipper – 13:00h, starting time of boat's delivery // limited number of early boardings on same departure day	No	per booking	490,00 €
Early boarding/check-in (Payable now) Season: 2025. EB + extra fee Skipper & Hostess – 13:00h, starting time of boat's delivery // limited number of early boardings on same departure day	No	per booking	590,00 €
Electric & Water consumption in the Marinas (Payable at the base) Season: 2025. Electric & Water consumption based on 2 nights on our dock (base will confirm the amount to pay locally depending on nights spent on dock)	No	per booking	36,00 €

Extra set of linen (choose how many) (Payable now)	No	per booking	15,00 €
Season: 2025. Extra set of linen : 15 € 1 extra set of linen (2 sheets & 2 pillow case) - to be updated manually			
Extra set of towels (choose how many) (Payable now)	No	per booking	10,00 €
Season: 2025. Extra set of towels: 10 € 1 extra set of towels (1 face & 1 bath towel) - to be updated manually			
Final cleaning (Payable now)	No	per booking	340,00 €
Season: 2025. included in Essentials pack			
Full board 1-4 pax (number of guests to update manually) (Payable now)	No	per guest/day	60,00 €
Season: 2025. only available if cook is booked on board as the cook will do the provisioning based on client's preference. Includes breakfast, lunch & dinner + the crew's food. Does not included alcoholic drinks			
Full board 5-12 pax (number of guests to update manually) (Payable now)	No	per guest/day	55,00 €
Season: 2025. only available if cook is booked on board as the cook will do the provisioning based on client's preference. Includes breakfast, lunch & dinner + the crew's food. Does not included alcoholic drinks			
Half board 1-4 pax (number of guests to update manually) (Payable now)	No	per guest/day	50,00 €
Season: 2025. only available if cook is booked on board as the cook will do the provisioning based on client's preference. Includes breakfast & lunch OR dinner + the crew's food. Does not included alcoholic drinks			
Half board 5-12 pax (number of guests to update manually) (Payable now)	No	per guest/day	45,00 €
Season: 2025. only available if cook is booked on board as the cook will do the provisioning based on client's preference. Includes breakfast & lunch OR dinner + the crew's food. Does not included alcoholic drinks			
Hostess/Cook (Payable now)	No	per night	200,00 €
Season: 2025. + provisioning, a cabin or forepeak to sleep and access to a WC/Shower			
Regatta surcharge (Payable now)	No	per booking	0,00 €
Season: 2025. A special race deposit need to be doubled manually once the regatta surcharge is added.			
Skipper (Payable now)	No	per night	270,00 €
Season: 2025. + provisioning, a cabin or forepeak to sleep and access to a WC/Shower			

Starter pack (Payable now)	No	per booking	35,00 €
Season: 2025. included in Essentials pack (The pack includes: 1 gallon water (or 4 bottles of 1.5L), 1 bottle of disinfectant, 1 small bottle of washing up liquid, 1 dish cloth, 1 sponge, garbage bags, 1 roll of paper towels, 1 box of matches, 1 roll of toilet paper in each head)			
Transfer (Payable now)	No	one-way	52,00 €
Season: 2025. OW - 1-4pax ,Day rate , Train station SNCF of Toulon from/to Port Pin Rolland base			
Transfer (Payable now)	No	one-way	52,00 €
Season: 2025. OW - 1-4pax ,Day rate , Ferry terminal of Toulon from/to Port Pin Rolland base			
Transfer (Payable now)	No	one-way	65,00 €
Season: 2025. OW - 1-4pax ,Night rate(19:00 – 07:00) Train station SNCF of Toulon from/to Port Pin Rolland			
Transfer (Payable now)	No	one-way	65,00 €
Season: 2025. OW - 1-4pax ,Night rate(19:00-07:00) ,Ferry terminal of Toulon from/to Port Pin Rolland			
Transfer (Payable now)	No	one-way	65,00 €
Season: 2025. OW - 5-7 pax ,Day rate , Train station SNCF of Toulon from/to Port Pin Rolland			
Transfer (Payable now)	No	one-way	65,00 €
Season: 2025. OW - 5-7 pax ,Day rate, Ferry terminal of Toulon from/to Port Pin Rolland base			
Transfer (Payable now)	No	one-way	78,00 €
Season: 2025. OW-5-7pax ,Bank Holidays,Sundays,Night rate(19:00-07:00), Ferry terminal of Toulon from/to Port Pin Rolland base			
Transfer (Payable now)	No	one-way	78,00 €
Season: 2025. OW -5-7pax ,Holidays,Sundays,Night rate(19:00-07:00), Train station SNCF of Toulon from/to Port Pin Rolland			
Transfer (Payable now)	No	one-way	117,00 €
Season: 2025. OW - 1-4pax ,Day rate ,Airport Toulon-Hyères from/to Port Pin Rolland			
Transfer (Payable now)	No	one-way	143,00 €
Season: 2025. OW - 1-4pax ,Night rate(19:00 – 07:00) , Airport Toulon-Hyères from/to Port Pin Rolland base			

Transfer (Payable now)

No

one-way

143,00 €

Season: 2025. OW - 5-7 pax ,Day rate , Airport Toulon-Hyères from/to Port

Pin Rolland

Transfer (Payable now)

No

one-way

169,00 €

Season: 2025. OW -5-7pax,Holidays ,Sundays,Night rate(19:00-07:00),

Airport Toulon-Hyères from/to Port Pin Rolland base



WEBSITE

www.plujeme.cz



PHONE

+420 720 755 085



MOBILE

+420 777 170 276



E-MAIL

info@plujeme.cz



PLUJEME RÁDI S.R.O.

Dlouhá 730/35, 11000 Praha 1 – Staré Město, Czech Republic

ADDITIONAL EXTRAS

EXTRA	OBLIGATORY	PAYMENT TYPE	PRICE
Kayak single (Payable now) Season: 2025. Price per day / Additional deposit 100 EUR - Payable now	No	per night	15,00 €
Outboard engine 8 & 9,8 HP (Payable now) Season: 2025. Subject to Availability ; 8 & 9.8hp. Dinghy not suitable in any case for waterski or wakeboard. Additional security deposit of 500 € "a powerboat licence is mandatory in French territories to drive a dinghy with an outboard more powerful than 6hp. It's client responsibility to ensure to have the right powerboat licence when renting a more powerful outboard. In case the needed licence is not presented at base, it will not be possible to use this larger outboard which will not be refunded" - Payable now	No	per day	35,00 €
Railing net (Safety net) (Payable now) Season: 2025. net is supplied but not installed - Payable now	No	per booking	300,00 €
Stand up paddle (SUP) (Payable now) Season: 2025. Price per day / Additional deposit 100 EUR - Payable now	No	per night	15,00 €



WEBSITE
www.plujeme.cz



PHONE
+420 720 755 085



MOBILE
+420 777 170 276



E-MAIL
info@plujeme.cz



PLUJEME RÁDI S.R.O.
Dlouhá 730/35, 11000 Praha 1 – Staré Město, Czech Republic

PRICE AND AVAILABILITY

07.03. - 16.03.2025 NOT AVAILABLE	22.03. - 29.03.2025 2.287 € 2.675 €	29.03. - 05.04.2025 2.287 € 2.675 €	05.04. - 12.04.2025 2.531 € 2.960 €
12.04. - 19.04.2025 2.616 € 3.060 €	19.04. - 26.04.2025 2.886 € 3.375 €	26.04. - 03.05.2025 3.565 € 4.170 €	03.05. - 10.05.2025 4.279 € 5.005 €
10.05. - 17.05.2025 4.279 € 5.005 €	17.05. - 24.05.2025 4.245 € 4.965 €	24.05. - 31.05.2025 NOT AVAILABLE	31.05. - 07.06.2025 5.387 € 6.300 €
07.06. - 14.06.2025 6.930 € 8.105 €	14.06. - 28.06.2025 NOT AVAILABLE	28.06. - 05.07.2025 NOT AVAILABLE	05.07. - 12.07.2025 NOT AVAILABLE
12.07. - 19.07.2025 10.479 € 11.030 €	19.07. - 26.07.2025 11.267 € 11.860 €	26.07. - 02.08.2025 NOT AVAILABLE	



WEBSITE
www.plujeme.cz



E-MAIL
info@plujeme.cz



PHONE
+420 720 755 085



PLUJEME RÁDI S.R.O.
Dlouhá 730/35, 11000 Praha 1 – Staré Město, Czech Republic



MOBILE
+420 777 170 276

PRICE AND AVAILABILITY

02.08. - 09.08.2025 13.652 € 14.370 €	09.08. - 16.08.2025 13.595 € 14.310 €	16.08. - 23.08.2025 NOT AVAILABLE	23.08. - 30.08.2025 8.731 € 9.190 €
30.08. - 06.09.2025 NOT AVAILABLE	06.09. - 20.09.2025 NOT AVAILABLE	20.09. - 11.10.2025 NOT AVAILABLE	11.10. - 18.10.2025 3.610 € 3.800 €
18.10. - 25.10.2025 3.515 € 3.700 €	25.10. - 01.11.2025 2.912 € 3.065 €	01.11. - 08.11.2025 2.822 € 2.970 €	08.11. - 15.11.2025 2.822 € 2.970 €
15.11. - 22.11.2025 2.822 € 2.970 €	22.11. - 29.11.2025 2.822 € 2.970 €	01.12. - 27.02.2026 NOT AVAILABLE	



WEBSITE

www.plujeme.cz



E-MAIL

info@plujeme.cz



PHONE

+420 720 755 085



MOBILE

+420 777 170 276



PLUJEME RÁDI S.R.O.

Dlouhá 730/35, 11000 Praha 1 – Staré Město, Czech Republic