

LAGOON 40

You (2022)

Catamaran **Lagoon 40 You**, built in **2022** is anchored in the **Marina Kornati, Biograd, Zadar region, Croatia**. It has **4 + 2 cabins**, can accommodate **8 + 2 + 2 people** and has **4 toilets**. Bed linen and kitchen equipment are included in the price.

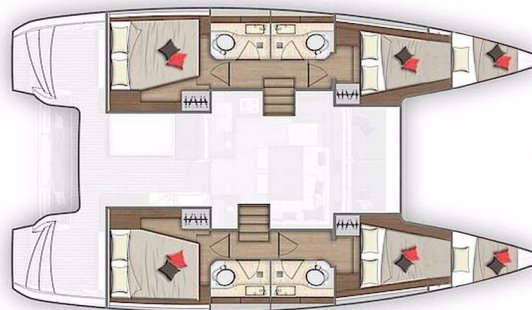

YACHT SPECIFICATIONS

Yacht Base

Marina Kornati, Biograd, Croatia

Yacht ID

3847

Brands

Lagoon

Yacht name

You

Production year

2022

Length

39 ft

Cabins

4 + 2

Berths

8 + 2 + 2

WC

4

Engine

2 x 45 HP

Fuel tank

300 l



WEBSITE

www.plujeme.cz



PHONE

+420 720 755 085



MOBILE

+420 777 170 276



E-MAIL

info@plujeme.cz



PLUJEME RÁDI S.R.O.

Dlouhá 730/35, 11000 Praha 1 - Staré Město, Czech Republic

STANDARD YACHT EQUIPMENT

| | |
|-----------------|--|
| Comfort | Cockpit cushions |
| Deck | Bimini top, Cockpit fridge, Cockpit table, Cockpit/stern, outside shower, Dinghy, Electric anchor windlass, Outboard engine 5 HP, Swimming ladder, Teak cockpit |
| Entertainment | LCD TV, Outdoor speakers, Radio CD player, USB, AUX input |
| Galley | Freezer, Hot water, Microwave |
| Interior | Electric toilet, Foldable table |
| Navigation | Autopilot, GPS chart plotter, GPS chart plotter - cockpit, Nautical charts, Pilot book |
| Safety | VHF radio |
| Sails | Electric winch |
| Yacht electrics | Air Conditioning, Batteries, Battery charger , Generator, Heating, Shore connection 220 V |



WEBSITE

www.plujeme.cz



PHONE

+420 720 755 085



MOBILE

+420 777 170 276



E-MAIL

info@plujeme.cz



PLUJEME RÁDI S.R.O.

Dlouhá 730/35, 11000 Praha 1 – Staré Město, Czech Republic

SERVICES

| SELECTED SERVICES | OBLIGATORY | PAYMENT TYPE | PRICE |
|--|------------|--------------|-----------------|
| Charter package (Payable at the base) Season: 2024. final cleaning, bed linen, 2x gas bottles, coffee machine, basic package for kitchen and toilets, set of towels (2pc/person-1 small, 1 big), WiFi 100GB, outboard engine 5HP, SUP, ice maker, snorkeling equipment (2 sets of snorkeling equipment), diver report upon check out, check in and out services | Yes | per booking | 420,00 € |
| Charter package (Payable at the base) Season: 2025. final cleaning, bed linen, 2x gas bottles, coffee machine, basic package for kitchen and toilets, set of towels (2pc/person-1 small, 1 big), WiFi 100GB, outboard engine 5HP, SUP, ice maker, snorkeling equipment (2 sets of snorkeling equipment), diver report upon check out, check in and out services | Yes | per booking | 420,00 € |
| Base expenses: fuel charges (Payable at the base) Season: 2024. 5L for outboard engine | Yes | per booking | 10,00 € |
| Early Check in (Payable at the base) Season: 2024. 14:30h | Yes | per booking | 180,00 € |
| Early Check in (Payable at the base) Season: 2024. 12:30h | Yes | per booking | 280,00 € |
| Extra cleaning (Payable at the base) Season: 2024. | Yes | per booking | 150,00 € |
| Extra cleaning- change of crew (Payable at the base) Season: 2024. includes bedlinen | Yes | per booking | 200,00 € |
| Hostess (Payable at the base) Season: 2024. food not included | Yes | per day | 180,00 € |
| Pet on board (Payable at the base) Season: 2024. | Yes | per booking | 200,00 € |
| Skipper (Payable at the base) Season: 2024. (food not included) | Yes | per day | 220,00 € |
| Skipper change (Payable at the base) Season: 2024. new diver report | Yes | per booking | 70,00 € |

| | | | |
|--|-----|-------------|-----------------|
| Sleep over before check in (Payable now) | Yes | per booking | 100,00 € |
| Season: 2024. on request, for short charters only | | | |
| VIP comfort package (Payable at the base) | Yes | per booking | 750,00 € |
| Season: 2024. early check in 12:30h, final cleaning, bed linen, 2x gas bottles, coffee machine, basic package for kitchen and toilets, set of towels (2pc/person-1 small, 1 big), WiFi 200GB, ice maker, outboard engine 5HP, 5l fuel for outboarder, SUPx2, snorkeling equipment, diver report upon check out, check in and out services | | | |
| VIP Pack (Payable at the base) | Yes | per booking | 600,00 € |
| Season: 2024. early check in 14:30h, final cleaning, bed linen, 2x gas bottles, coffee machine, basic package for kitchen and toilets, set of towels (2pc/person-1 small, 1 big), WiFi 150GB, ice maker, outboard engine 5HP, 5l fuel for outboarder, SUPx2, snorkeling equipment, diver report upon check out, check in and out services | | | |
| Base expenses: fuel charges (Payable at the base) | Yes | per booking | 10,00 € |
| Season: 2025. 5L for outboard engine | | | |
| Early Check in (Payable at the base) | Yes | per booking | 180,00 € |
| Season: 2025. 14:30h | | | |
| Early Check in (Payable at the base) | Yes | per booking | 280,00 € |
| Season: 2025. 12:30h | | | |
| Extra cleaning (Payable at the base) | Yes | per booking | 150,00 € |
| Season: 2025. | | | |
| Extra cleaning- change of crew (Payable at the base) | Yes | per booking | 200,00 € |
| Season: 2025. includes bedlinen | | | |
| Hostess (Payable at the base) | Yes | per day | 180,00 € |
| Season: 2025. food not included | | | |
| Pet on board (Payable at the base) | Yes | per booking | 200,00 € |
| Season: 2025. | | | |
| Skipper (Payable at the base) | Yes | per day | 220,00 € |
| Season: 2025. (food not included) | | | |
| Skipper change (Payable at the base) | Yes | per booking | 70,00 € |
| Season: 2025. new diver report | | | |
| Sleep over before check in (Payable now) | Yes | per booking | 100,00 € |
| Season: 2025. on request, for short charters only | | | |

VIP comfort package (Payable at the base)

Yes

per booking

750,00 €

Season: 2025. early check in 12:30h, final cleaning, bed linen, 2x gas bottles, coffee machine, basic package for kitchen and toilets, set of towels (2pc/person-1 small, 1 big), WiFi 200GB, ice maker, outboard engine 5HP, 5l fuel for outboarder, SUPx2, snorkeling equipment, diver report upon check out, check in and out services

VIP Pack (Payable at the base)

Yes

per booking

600,00 €

Season: 2025. early check in 14:30h, final cleaning, bed linen, 2x gas bottles, coffee machine, basic package for kitchen and toilets, set of towels (2pc/person-1 small, 1 big), WiFi 150GB, ice maker, outboard engine 5HP, 5l fuel for outboarder, SUPx2, snorkeling equipment, diver report upon check out, check in and out services

**WEBSITE**www.plujeme.cz**E-MAIL**info@plujeme.cz**PHONE**

+420 720 755 085

**MOBILE**

+420 777 170 276

**PLUJEME RÁDI S.R.O.**

Dlouhá 730/35, 11000 Praha 1 – Staré Město, Czech Republic

ADDITIONAL EXTRAS

| EXTRA | OBLIGATORY | PAYMENT TYPE | PRICE |
|--|------------|--------------|-----------------|
| Additional gas bottle (Payable at the base) Season: 2024. Payable at the base | Yes | per piece | 50,00 € |
| Airstream Towable (Payable at the base) Season: 2024. Jobe Airstream Towable 4P + 4 safety jacket - Payable at the base | Yes | per week | 150,00 € |
| Extra bedlinen (Payable at the base) Season: 2024. Payable at the base | Yes | per set | 15,00 € |
| Grill/Barbecue/Plancha (Payable at the base) Season: 2024. Payable at the base | Yes | per week | 100,00 € |
| Kayak (Payable at the base) Season: 2024. Aqua Marina, 1 pax, +150 EUR deposit, limited availability, please order in advance - Payable at the base | Yes | per week | 100,00 € |
| Kayak 1 (Payable at the base) Season: 2024. Aqua Marina, 2+1 pax, +150 EUR deposit, limited availability, please order in advance - Payable at the base | Yes | per week | 150,00 € |
| Railing net (Safety net) (Payable at the base) Season: 2024. Payable at the base | Yes | per week | 200,00 € |
| Scooter (Payable at the base) Season: 2024. Payable at the base | Yes | per week | 70,00 € |
| Self inflating life vest (Payable at the base) Season: 2024. (on request) - Payable at the base | Yes | per piece | 20,00 € |
| Snorkeling equipment (Payable at the base) Season: 2024. mask, fins and snorkel, 2 sets - Payable at the base | Yes | per set | 10,00 € |
| Stand up paddle (SUP) (Payable at the base) Season: 2024. Payable at the base | Yes | per week | 70,00 € |
| Towels (Payable at the base) Season: 2024. Payable at the base | Yes | per set | 10,00 € |

| | | | |
|--|-----|-----------|-----------------|
| Underwater scooter (Payable at the base) Season: 2024. Payable at the base | Yes | per week | 150,00 € |
| Additional gas bottle (Payable at the base) Season: 2025. Payable at the base | Yes | per piece | 50,00 € |
| Airstream Towable (Payable at the base) Season: 2025. Jobe Airstream Towable 4P + 4 safety jacket - Payable at the base | Yes | per week | 150,00 € |
| Extra bedlinen (Payable at the base) Season: 2025. Payable at the base | Yes | per set | 15,00 € |
| Grill/Barbecue/Plancha (Payable at the base) Season: 2025. Payable at the base | Yes | per week | 100,00 € |
| Kayak (Payable at the base) Season: 2025. Aqua Marina, 1 pax, +150 EUR deposit, limited availability, please order in advance - Payable at the base | Yes | per week | 100,00 € |
| Kayak 1 (Payable at the base) Season: 2025. Aqua Marina, 2+1 pax, +150 EUR deposit, limited availability, please order in advance - Payable at the base | Yes | per week | 150,00 € |
| Railing net (Safety net) (Payable at the base) Season: 2025. Payable at the base | Yes | per week | 200,00 € |
| Scooter (Payable at the base) Season: 2025. Payable at the base | Yes | per week | 70,00 € |
| Self inflating life vest (Payable at the base) Season: 2025. (on request)- Payable at the base | Yes | per piece | 20,00 € |
| Snorkeling equipment (Payable at the base) Season: 2025. mask, fins and snorkel, 2 sets - Payable at the base | Yes | per set | 10,00 € |
| Stand up paddle (SUP) (Payable at the base) Season: 2025. Payable at the base | Yes | per week | 70,00 € |
| Towels (Payable at the base) Season: 2025. Payable at the base | Yes | per set | 10,00 € |

PRICE AND AVAILABILITY

| | | | |
|--|--|--|--|
| 21.09. - 28.09.2024 NOT AVAILABLE | 28.09. - 05.10.2024 NOT AVAILABLE | 05.10. - 13.10.2024 NOT AVAILABLE | 18.10. - 21.10.2024 NOT AVAILABLE |
| 26.10. - 02.11.2024 1.375 € 2.750 € | 02.11. - 09.11.2024 1.375 € 2.750 € | 10.11. - 14.03.2025 NOT AVAILABLE | 15.03. - 22.03.2025 1.452 € 2.420 € |
| 22.03. - 29.03.2025 1.452 € 2.420 € | 29.03. - 05.04.2025 1.452 € 2.420 € | 05.04. - 12.04.2025 1.452 € 2.420 € | 12.04. - 19.04.2025 1.485 € 2.475 € |
| 19.04. - 26.04.2025 1.716 € 2.860 € | 26.04. - 03.05.2025 1.782 € 2.970 € | | |



WEBSITE
www.plujeme.cz



E-MAIL
info@plujeme.cz



PHONE
+420 720 755 085



MOBILE
+420 777 170 276



PLUJEME RÁDI S.R.O.
Dlouhá 730/35, 11000 Praha 1 – Staré Město, Czech Republic

PRICE AND AVAILABILITY

| | | | |
|---|---|---|---|
| 03.05. - 10.05.2025 1.848 € 3.080 € | 10.05. - 17.05.2025 2.508 € 4.180 € | 17.05. - 24.05.2025 2.706 € 4.510 € | 24.05. - 31.05.2025 3.234 € 5.390 € |
| 31.05. - 07.06.2025 3.564 € 5.940 € | 07.06. - 14.06.2025 4.389 € 6.270 € | 14.06. - 21.06.2025 4.928 € 7.040 € | 21.06. - 28.06.2025 5.005 € 7.150 € |
| 28.06. - 05.07.2025 5.159 € 7.370 € | 05.07. - 12.07.2025 5.236 € 7.480 € | 12.07. - 19.07.2025 5.236 € 7.480 € | 19.07. - 26.07.2025 5.313 € 7.590 € |
| 26.07. - 02.08.2025 5.313 € 7.590 € | 02.08. - 09.08.2025 5.313 € 7.590 € | 09.08. - 16.08.2025 5.159 € 7.370 € | 16.08. - 23.08.2025 5.005 € 7.150 € |
| 23.08. - 30.08.2025 4.697 € 6.710 € | 30.08. - 06.09.2025 4.389 € 6.270 € | 06.09. - 13.09.2025 5.049 € 5.940 € | 13.09. - 20.09.2025 4.301 € 5.060 € |
| 20.09. - 27.09.2025 2.640 € 3.520 € | 27.09. - 04.10.2025 2.145 € 2.860 € | 04.10. - 11.10.2025 2.063 € 2.750 € | 11.10. - 18.10.2025 2.063 € 2.750 € |
| 18.10. - 25.10.2025 2.063 € 2.750 € | 25.10. - 01.11.2025 2.063 € 2.750 € | 01.11. - 08.11.2025 2.063 € 2.750 € | 08.11. - 15.11.2025 2.750 € |
| 15.11. - 22.11.2025 2.750 € | 22.11. - 29.11.2025 2.750 € | 29.11. - 06.12.2025 2.750 € | 06.12. - 13.12.2025 2.750 € |
| 13.12. - 20.12.2025 2.750 € | 20.12. - 27.12.2025 2.750 € | | |



WEBSITE
www.plujeme.cz



E-MAIL
info@plujeme.cz



PHONE
+420 720 755 085



MOBILE
+420 777 170 276



PLUJEME RÁDI S.R.O.
Dlouhá 730/35, 11000 Praha 1 – Staré Město, Czech Republic