

BAVARIA CRUISER 46

Diana (2015)

Sailing yacht Bavaria Cruiser 46 Diana, built in 2015 is anchored in the Marina Punat, Krk, Kvarner, Croatia. It has 4 cabins, can accommodate 8 + 1 people and has 3 toilets. Bed linen and kitchen equipment are included in the price.

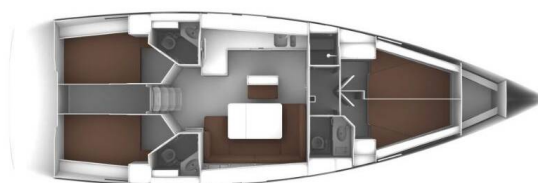

YACHT SPECIFICATIONS

Yacht Base

Marina Punat, Krk, Croatia

Yacht ID

383

Brands

Bavaria

Yacht name

Diana

Production year

2015

Length

47 ft

Cabins

4

Berths

8 + 1

Max Persons

10

WC

3

Engine

0 x 55 HP

Fuel tank

210 l



WEBSITE

www.plujeme.cz



PHONE

+420 720 755 085



MOBILE

+420 777 170 276



E-MAIL

info@plujeme.cz



PLUJEME RÁDI S.R.O.

Dlouhá 730/35, 11000 Praha 1 – Staré Město, Czech Republic

STANDARD YACHT EQUIPMENT

| | |
|-----------------|---|
| Comfort | Bed linen, Bedlinen and towels, Blankets, Pillows, Shower towels |
| Deck | Bathing platform, Bimini top, Bosun's chair (Safe seat) (boatswain's chair), Cockpit/stern, outside shower, Dinghy, Electric anchor windlass, Fenders, Gangway, Main anchor, Mooring ropes , Spare anchor (Reserve, Auxiliary anchor), Sprayhood, Swimming ladder, Water hose, Winch handles |
| Entertainment | Radio |
| Galley | Gas cookers, Hot water, Kitchen utensils (Galley equipment, cutlery), NESPRESSO coffee machine, Refrigerator, Sink, Stove |
| Navigation | Autopilot, Binoculars, Bow thruster, Compass, GPS chart plotter, Hand bearing compass, Harbour guides, List of lights, Nautical charts, Navigation set, Speedometer (Speed log), Wind instrument/Anemometer |
| Safety | Distress flare box, Emergency tiller, Fire extinguisher , First aid kit , Flashlight, Horseshoe lifebuoy, Life belts (Safety harness), Life jackets, Lifelines, Liferaft , VHF radio |
| Yacht electrics | Bilge pump - Electric, Heating, Inverter, Shore connection 220 V |



WEBSITE

www.plujeme.cz



E-MAIL

info@plujeme.cz



PHONE

+420 720 755 085



MOBILE

+420 777 170 276



PLUJEME RÁDI S.R.O.

Dlouhá 730/35, 11000 Praha 1 – Staré Město, Czech Republic

SERVICES

| SELECTED SERVICES | OBLIGATORY | PAYMENT TYPE | PRICE |
|--|------------|----------------|-----------------|
| Transit log (Payable at the base) Season: 2025. | Yes | per booking | 275,00 € |
| Deposit insurance (Payable at the base) Season: 2025. non-refundable + € 500 deposit (refundable) | No | per booking | 250,00 € |
| Early Check in (Payable at the base) Season: 2025. from 13.00 In agreement with the charter base. | No | per booking | 200,00 € |
| Late return to base (Payable at the base) Season: 2025. next day until 9.00h In agreement with the charter base | No | per booking | 200,00 € |
| Pet on board (Payable at the base) Season: 2025. | No | per booking | 200,00 € |
| Skipper (Payable at the base) Season: 2025. | No | per day + food | 225,00 € |

**WEBSITE**www.plujeme.cz**E-MAIL**info@plujeme.cz**PHONE**

+420 720 755 085

**MOBILE**

+420 777 170 276

**PLUJEME RÁDI S.R.O.**

Dlouhá 730/35, 11000 Praha 1 – Staré Město, Czech Republic

ADDITIONAL EXTRAS

| EXTRA | OBLIGATORY | PAYMENT TYPE | PRICE |
|--|------------|--------------|-----------------|
| Extra bedlinen (Payable at the base) Season: 2025. Payable at the base | No | per set | 6,00 € |
| Extra towels (Payable at the base) Season: 2025. Payable at the base | No | per set | 6,00 € |
| Outboard engine (Payable at the base) Season: 2025. Payable at the base | No | per week | 100,00 € |
| Railing net (Safety net) (Payable at the base) Season: 2025. with installation, 50 EUR without installation per booking - Payable at the base | No | per booking | 150,00 € |
| Stand up paddle (SUP) (Payable at the base) Season: 2025. Payable at the base | No | per week | 130,00 € |
| Wakeboard (Payable at the base) Season: 2025. including lines - Payable at the base | No | per week | 75,00 € |
| Wi-Fi Internet (Payable at the base) Season: 2025. 50GB/week, free in Marina Punat - Payable at the base | No | per week | 25,00 € |



WEBSITE

www.plujeme.cz



E-MAIL

info@plujeme.cz



PHONE

+420 720 755 085



MOBILE

+420 777 170 276



PLUJEME RÁDI S.R.O.

Dlouhá 730/35, 11000 Praha 1 – Staré Město, Czech Republic

PRICE AND AVAILABILITY

| | | | |
|--|--|--|--|
| 05.04. - 12.04.2025 1.929 € 2.250 € | 12.04. - 19.04.2025 1.929 € 2.250 € | 19.04. - 26.04.2025 1.929 € 2.250 € | 26.04. - 03.05.2025 2.529 € 2.950 € |
| 03.05. - 10.05.2025 2.529 € 2.950 € | 10.05. - 17.05.2025 2.529 € 2.950 € | 22.05. - 25.05.2025 NOT AVAILABLE | 31.05. - 07.06.2025 3.249 € 3.790 € |
| 13.06. - 22.06.2025 NOT AVAILABLE | 28.06. - 05.07.2025 3.644 € 4.250 € | 05.07. - 12.07.2025 3.644 € 4.250 € | 12.07. - 19.07.2025 3.644 € 4.250 € |
| 19.07. - 26.07.2025 3.644 € 4.250 € | 26.07. - 02.08.2025 3.644 € 4.250 € | 02.08. - 09.08.2025 3.644 € 4.250 € | 09.08. - 16.08.2025 3.644 € 4.250 € |
| 16.08. - 23.08.2025 3.644 € 4.250 € | 23.08. - 30.08.2025 3.249 € 3.790 € | 30.08. - 06.09.2025 3.249 € 3.790 € | 06.09. - 13.09.2025 3.249 € 3.790 € |
| 13.09. - 20.09.2025 3.249 € 3.790 € | 20.09. - 27.09.2025 2.529 € 2.950 € | 27.09. - 04.10.2025 NOT AVAILABLE | |



WEBSITE
www.plujeme.cz



E-MAIL
info@plujeme.cz



PHONE
+420 720 755 085



MOBILE
+420 777 170 276



PLUJEME RÁDI S.R.O.
Dlouhá 730/35, 11000 Praha 1 – Staré Město, Czech Republic

PRICE AND AVAILABILITY

04.10. - 11.10.2025

1.929 € 2.250 €

11.10. - 18.10.2025

1.929 € 2.250 €

18.10. - 31.03.2026

NOT AVAILABLE



WEBSITE

www.plujeme.cz



E-MAIL

info@plujeme.cz



PHONE

+420 720 755 085



MOBILE

+420 777 170 276



PLUJEME RÁDI S.R.O.

Dlouhá 730/35, 11000 Praha 1 – Staré Město, Czech Republic