

DUFOUR 390

Elena (2022)

Sailing yacht Dufour 390 Elena, built in 2022 is anchored in the Marina Tehnomont Veruda, Pula, Istra, Croatia. It has 3 cabins, can accommodate 6 + 2 people and has 3 toilets. Bed linen and kitchen equipment are included in the price.

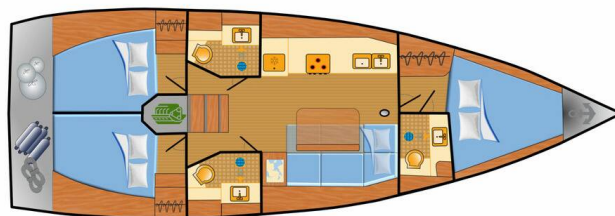

YACHT SPECIFICATIONS

Yacht Base

Marina Tehnomont Veruda, Pula, Croatia

Yacht ID

3790

Brands

Dufour

Yacht name

Elena

Production year

2022

Length

39 ft

Cabins

3

Berths

6 + 2

Max Persons

8

WC

3

Engine

1 x 50 HP

Fuel tank

200 l



WEBSITE

www.plujeme.cz



PHONE

+420 720 755 085



MOBILE

+420 777 170 276



E-MAIL

info@plujeme.cz



PLUJEME RÁDI S.R.O.

Dlouhá 730/35, 11000 Praha 1 – Staré Město, Czech Republic

STANDARD YACHT EQUIPMENT

Additional	Flag
Comfort	Cockpit cushions
Deck	Anchor light, Bathing platform, Bimini top, Boat hook, Bosun's chair (Safe seat) (boatswain's chair), Cockpit grill, Cockpit table, Cockpit/stern, outside shower, Deck brush, Electric anchor windlass, Fenders, Gangway, Impeller, Main anchor, Mooring ropes , Sailor's knife, Spare anchor (Reserve, Auxiliary anchor), Sprayhood, Swimming ladder, Teak cockpit
Entertainment	Mask and snorkel, Radio, TV, Wi-Fi Internet
Galley	Hot water, Ice box, Kitchen utensils (Galley equipment, cutlery), Oven, Sink, Stove, Wine glasses
Interior	Barometer, Clock, Lowerable salon table, Safe, Yacht keys
Navigation	AIS, Autopilot, Binoculars, Bow thruster, Compass, Composite steering wheels, CRO flag, Depthsounder, GPS chart plotter - cockpit, Nautical charts, Navigation/position Lights, Triangles, Windex
Safety	Distress signals, Emergency tiller, Fire extinguisher , First aid kit , Flashlight, Fog horn, Guard rail, Life belts (Safety harness), Life buoy + Flashing light, Lifelines, Liferaft , VHF radio , Wire (shroud) cutter
Sails	Electric winch, Gennaker-device, Halyard winches, Lazy jacks
Yacht electrics	220V socket, Bilge pump - Electric, Converter 220V/12V, Heating, Inverter, Shore connection 220 V, Shore power cable, Solar panels



WEBSITE

www.plujeme.cz



PHONE

+420 720 755 085



MOBILE

+420 777 170 276



E-MAIL

info@plujeme.cz



PLUJEME RÁDI S.R.O.

Dlouhá 730/35, 11000 Praha 1 – Staré Město, Czech Republic

SERVICES

SELECTED SERVICES	OBLIGATORY	PAYMENT TYPE	PRICE
Basic package for accommodation (Payable at the base) Season: 2025. Cleaning, made Bed linen, Permit, WiFi, Cooking gas, Rinsing set, Dinghy	Yes	per booking	250,00 €
Early Check in (Payable at the base) Season: 2025. On request; from 13:00; Payable in cash at the base	No	per booking	150,00 €
Hostess (Payable at the base) Season: 2025. + own cabin	No	per day + food	150,00 €
Pet on board (Payable at the base) Season: 2025. ONLY ON REQUEST!; Payable in cash at the base	No	per booking	140,00 €
Skipper (Payable at the base) Season: 2025. On request; Free food, own cabin; Payable in cash at the base	No	per day	200,00 €
Transfer (Payable at the base) Season: 2025. upon request, Please ask for the prices for the transfer, by Taxi-Bus; Payable in cash at the base	No	per booking	0,00 €



WEBSITE
www.plujeme.cz



E-MAIL
info@plujeme.cz



PHONE
+420 720 755 085



PLUJEME RÁDI S.R.O.
Dlouhá 730/35, 11000 Praha 1 – Staré Město, Czech Republic



MOBILE
+420 777 170 276

ADDITIONAL EXTRAS

EXTRA	OBLIGATORY	PAYMENT TYPE	PRICE
Gennaker (Payable at the base) Season: 2025. On request; 50% second week; Payable in cash at the base - Payable at the base	No	per week	200,00 €
Outboard engine (Payable at the base) Season: 2025. 50% second week; Payable in cash at the base - Payable at the base	No	per week	100,00 €
Stand up paddle (SUP) (Payable at the base) Season: 2025. 50% second week; Payable in cash at the base - Payable at the base	No	per week	100,00 €
Towels (Payable at the base) Season: 2025. 1x big one, 1x small one; Payable in cash at the base - Payable at the base	No	per set	10,00 €

**WEBSITE**www.plujeme.cz**E-MAIL**info@plujeme.cz**PHONE**

+420 720 755 085

**MOBILE**

+420 777 170 276

**PLUJEME RÁDI S.R.O.**

Dlouhá 730/35, 11000 Praha 1 – Staré Město, Czech Republic

PRICE AND AVAILABILITY

22.03. - 05.04.2025 NOT AVAILABLE	05.04. - 12.04.2025 1.320 € 1.650 €	12.04. - 26.04.2025 NOT AVAILABLE	26.04. - 03.05.2025 ON OPTION
03.05. - 10.05.2025 1.320 € 1.650 €	10.05. - 17.05.2025 1.520 € 1.900 €	17.05. - 24.05.2025 NOT AVAILABLE	24.05. - 07.06.2025 NOT AVAILABLE
07.06. - 14.06.2025 NOT AVAILABLE	14.06. - 21.06.2025 NOT AVAILABLE	21.06. - 28.06.2025 2.560 € 3.200 €	28.06. - 05.07.2025 2.960 € 3.700 €
05.07. - 12.07.2025 NOT AVAILABLE	12.07. - 19.07.2025 2.960 € 3.700 €	19.07. - 26.07.2025 NOT AVAILABLE	26.07. - 02.08.2025 2.960 € 3.700 €



WEBSITE

www.plujeme.cz



E-MAIL

info@plujeme.cz



PHONE

+420 720 755 085



MOBILE

+420 777 170 276



PLUJEME RÁDI S.R.O.

Dlouhá 730/35, 11000 Praha 1 – Staré Město, Czech Republic

PRICE AND AVAILABILITY

02.08. - 09.08.2025 NOT AVAILABLE	09.08. - 16.08.2025 2.960 € 3.700 €	16.08. - 23.08.2025 2.960 € 3.700 €	23.08. - 30.08.2025 2.960 € 3.700 €
30.08. - 13.09.2025 NOT AVAILABLE	13.09. - 20.09.2025 NOT AVAILABLE	20.09. - 27.09.2025 ON OPTION	27.09. - 04.10.2025 ON OPTION
04.10. - 11.10.2025 NOT AVAILABLE	11.10. - 18.10.2025 1.320 € 1.650 €	18.10. - 25.10.2025 1.320 € 1.650 €	25.10. - 01.11.2025 1.320 € 1.650 €
02.11. - 27.03.2026 NOT AVAILABLE			



WEBSITE

www.plujeme.cz



E-MAIL

info@plujeme.cz



PHONE

+420 720 755 085



MOBILE

+420 777 170 276



PLUJEME RÁDI S.R.O.

Dlouhá 730/35, 11000 Praha 1 – Staré Město, Czech Republic