

# BAVARIA CRUISER 46

Tac II (2017)

Sailing yacht **Bavaria Cruiser 46 Tac II**, built in **2017** is anchored in the **Marina Punat, Krk, Kvarner, Croatia**. It has **4 cabins**, can accommodate **8 + 1 people** and has **3 toilets**. Bed linen and kitchen equipment are included in the price.

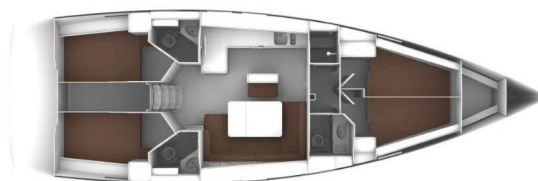

## YACHT SPECIFICATIONS

Yacht Base

**Marina Punat, Krk, Croatia**

Yacht ID

**3504**

Brands

**Bavaria**

Yacht name

**Tac II**

Production year

**2017**

Length

**47 ft**

Cabins

**4**

Berths

**8 + 1**

Max Persons

**9**

WC

**3**

Engine

**1 x 55 HP**

Fuel tank

**210 l**



**WEBSITE**

[www.plujeme.cz](http://www.plujeme.cz)



**PHONE**

+420 720 755 085



**MOBILE**

+420 777 170 276



**E-MAIL**

[info@plujeme.cz](mailto:info@plujeme.cz)



**PLUJEME RÁDI S.R.O.**

Dlouhá 730/35, 11000 Praha 1 – Staré Město, Czech Republic

## STANDARD YACHT EQUIPMENT

Comfort	<b>Cockpit cushions</b>
Deck	<b>Anchor line, Anchor swivel, Bimini top, Black ball, Black conus, Boat hook, Bosun's chair (Safe seat) (boatswain's chair), Canister for water, Cockpit full tent, Cockpit table with light, Cockpit/stern, outside shower, Dinghy, Dinghy (byboat) pump, Electric anchor windlass, Fenders, Gangway, Impeller, V-belt, oilfilter, Jerry cans for diesel, Main anchor, Mooring ropes , Plastic bucket, Repair box for dinghy, Round/globular fender, Spare anchor (Reserve, Auxiliary anchor), Spotlight / Headlights, Sprayhood, Teak cockpit, Water hose</b>
Entertainment	<b>Outdoor speakers, Radio</b>
Galley	<b>Gas bottles, Hot water, Kitchen utensils (Galley equipment, cutlery), Refrigerator</b>
Interior	<b>Barometer, Clock, Electric toilet</b>
Navigation	<b>Autopilot, Bow thruster, GPS chart plotter, GPS chart plotter - cockpit, Hand bearing compass, Harbour guides, Logge/Lot/Speed/Wind, Navigation (Nautical) charts and nautical guide , Navigation set, Parallel ruler, Radar reflector, Tridata, Windex</b>
Safety	<b>Distress signals, Fire extinguisher , First aid kit , Flashlight, Fog horn, Life belts (Safety harness), Life buoy + Flashing light, Life jackets, Set of tools , VHF radio</b>
Sails	<b>Gennaker-device</b>
Yacht electrics	<b>Air Conditioning, Battery charger , Heating, Shore connection 220 V, Solar panels, USB sockets</b>



**WEBSITE**

[www.plujeme.cz](http://www.plujeme.cz)



**PHONE**

+420 720 755 085



**MOBILE**

+420 777 170 276



**E-MAIL**

[info@plujeme.cz](mailto:info@plujeme.cz)



**PLUJEME RÁDI S.R.O.**

Dlouhá 730/35, 11000 Praha 1 – Staré Město, Czech Republic

## SERVICES

SELECTED SERVICES	OBLIGATORY	PAYMENT TYPE	PRICE
<b>Permit</b> (Payable at the base) <b>Season: 2025.</b>	Yes	per booking	<b>320,00 €</b>
<b>WI-FI Internet connection on boat</b> (Payable at the base) <b>Season: 2025.</b> 10 GB, included in price	Yes	per booking	<b>0,00 €</b>
<b>Comfort pack with insurance of deposit</b> (Payable at the base) <b>Season: 2025.</b> + 700 EUR deposit only in cash (The amount is refundable if there was no damage to the ship or is charged pro rata.); includes: outboard engine, WIFI 50 GB/week, insurance of deposit; every additional week 170 EUR	No	per booking	<b>385,00 €</b>
<b>Early boarding/check-in</b> (Payable at the base) <b>Season: 2025.</b> Check-in 1 pm, max 3 yachts	No	per booking	<b>175,00 €</b>
<b>Extra cleaning</b> (Payable at the base) <b>Season: 2025.</b>	No	per booking	<b>110,00 €</b>
<b>Hostess</b> (Payable at the base) <b>Season: 2025.</b> + own cabin; external service provider, direct billing	No	per day + food	<b>200,00 €</b>
<b>Skipper</b> (Payable at the base) <b>Season: 2025.</b> + own cabin; external service provider	No	per day + food	<b>200,00 €</b>

**WEBSITE**[www.plujeme.cz](http://www.plujeme.cz)**E-MAIL**[info@plujeme.cz](mailto:info@plujeme.cz)**PHONE**

+420 720 755 085

**MOBILE**

+420 777 170 276

**PLUJEME RÁDI S.R.O.**

Dlouhá 730/35, 11000 Praha 1 – Staré Město, Czech Republic

## ADDITIONAL EXTRAS

EXTRA	OBLIGATORY	PAYMENT TYPE	PRICE
<b>Extra bedlinen</b> (Payable at the base) <b>Season: 2025.</b> 1 set/ person is included in the charter price - Payable at the base	No	per set	<b>7,00 €</b>
<b>Gennaker</b> (Payable at the base) <b>Season: 2025.</b> with sock, + 600 EUR deposit - Payable at the base	No	per week	<b>350,00 €</b>
<b>Grill/Barbecue/Plancha</b> (Payable at the base) <b>Season: 2025.</b> Payable at the base	No	per week	<b>120,00 €</b>
<b>Kayak</b> (Payable at the base) <b>Season: 2025.</b> Payable at the base	No	per week	<b>100,00 €</b>
<b>Outboard engine</b> (Payable at the base) <b>Season: 2025.</b> included in price - Payable at the base	No	per week	<b>0,00 €</b>
<b>Railing net (Safety net)</b> (Payable at the base) <b>Season: 2025.</b> not available for all yachts - Payable at the base	No	per booking	<b>120,00 €</b>
<b>Stand up paddle (SUP)</b> (Payable at the base) <b>Season: 2025.</b> per week - Payable at the base	No	per week	<b>120,00 €</b>
<b>Towels</b> (Payable at the base) <b>Season: 2025.</b> Payable at the base	No	per set	<b>7,00 €</b>



**WEBSITE**  
www.plujeme.cz



**E-MAIL**  
info@plujeme.cz



**PHONE**  
+420 720 755 085



**PLUJEME RÁDI S.R.O.**  
Dlouhá 730/35, 11000 Praha 1 – Staré Město, Czech Republic



**MOBILE**  
+420 777 170 276

## PRICE AND AVAILABILITY

22.03. - 29.03.2025 1.115 € 1.430 €	29.03. - 05.04.2025 1.170 € 1.500 €	05.04. - 12.04.2025 1.170 € 1.500 €	12.04. - 19.04.2025 NOT AVAILABLE
19.04. - 26.04.2025 1.365 € 1.750 €	26.04. - 03.05.2025 NOT AVAILABLE	03.05. - 10.05.2025 NOT AVAILABLE	10.05. - 17.05.2025 NOT AVAILABLE
17.05. - 24.05.2025 NOT AVAILABLE	24.05. - 31.05.2025 NOT AVAILABLE	31.05. - 07.06.2025 NOT AVAILABLE	07.06. - 14.06.2025 ON OPTION
14.06. - 21.06.2025 NOT AVAILABLE	21.06. - 28.06.2025 3.143 € 4.030 €	28.06. - 05.07.2025 NOT AVAILABLE	05.07. - 12.07.2025 NOT AVAILABLE
12.07. - 19.07.2025 NOT AVAILABLE	19.07. - 26.07.2025 NOT AVAILABLE	26.07. - 02.08.2025 NOT AVAILABLE	02.08. - 09.08.2025 NOT AVAILABLE
09.08. - 16.08.2025 NOT AVAILABLE	16.08. - 23.08.2025 NOT AVAILABLE	23.08. - 30.08.2025 NOT AVAILABLE	30.08. - 06.09.2025 NOT AVAILABLE
06.09. - 13.09.2025 NOT AVAILABLE	13.09. - 20.09.2025 NOT AVAILABLE	20.09. - 27.09.2025 NOT AVAILABLE	27.09. - 04.10.2025 NOT AVAILABLE



WEBSITE

[www.plujeme.cz](http://www.plujeme.cz)



E-MAIL

[info@plujeme.cz](mailto:info@plujeme.cz)



PHONE

+420 720 755 085



MOBILE

+420 777 170 276



PLUJEME RÁDI S.R.O.

Dlouhá 730/35, 11000 Praha 1 – Staré Město, Czech Republic

## PRICE AND AVAILABILITY

04.10. - 11.10.2025 <b>1.459 €</b> 1.870 €	11.10. - 18.10.2025 <b>1.381 €</b> 1.770 €	18.10. - 25.10.2025 <b>1.264 €</b> 1.620 €	25.10. - 01.11.2025 <b>1.271 €</b> 1.630 €
01.11. - 08.11.2025 <b>1.271 €</b> 1.630 €	08.11. - 15.11.2025 <b>1.271 €</b> 1.630 €	15.11. - 22.11.2025 <b>1.271 €</b> 1.630 €	23.11. - 31.12.2025 NOT AVAILABLE



### WEBSITE

[www.plujeme.cz](http://www.plujeme.cz)



### E-MAIL

[info@plujeme.cz](mailto:info@plujeme.cz)



### PHONE

+420 720 755 085



### MOBILE

+420 777 170 276



### PLUJEME RÁDI S.R.O.

Dlouhá 730/35, 11000 Praha 1 – Staré Město, Czech Republic