

# HANSE 548

Mila Felice (2019)

Sailing yacht Hanse 548 Mila Felice, built in 2019 is anchored in the Trogir, Yachtclub Seget (Marina Baotić), Split region, Croatia. It has 4 + 1 cabins, can accommodate 8 + 2 + 1 people and has 4 + 1 toilets. Bed linen and kitchen equipment are included in the price.

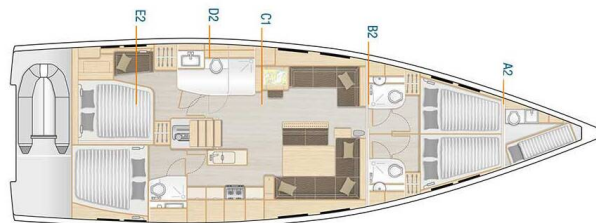

## YACHT SPECIFICATIONS

Yacht Base

**Trogir, Yachtclub Seget (Marina Baotić), Croatia**

Yacht ID

**3442**

Brands

**Hanse Yachts**

Yacht name

**Mila Felice**

Production year

**2019**

Length

**53 ft**

Cabins

**4 + 1**

Berths

**8 + 2 + 1**

WC

**4 + 1**

Engine

**1 x 110 HP**

Fuel tank

**520 l**



**WEBSITE**

[www.plujeme.cz](http://www.plujeme.cz)



**PHONE**

+420 720 755 085



**MOBILE**

+420 777 170 276



**E-MAIL**

[info@plujeme.cz](mailto:info@plujeme.cz)



**PLUJEME RÁDI S.R.O.**

Dlouhá 730/35, 11000 Praha 1 – Staré Město, Czech Republic

## STANDARD YACHT EQUIPMENT

Comfort	<b>Bed linen, Blankets, Cockpit cushions, Pillows, Towels</b>
Deck	<b>Anchor with chain, Bimini top, Cockpit table, Cockpit/stern, outside shower, Dinghy, Electric anchor windlass, Fenders, Gangway, Mooring ropes , Spare anchor (Reserve, Auxiliary anchor), Sprayhood</b>
Entertainment	<b>Indoor speakers, Outdoor speakers, Radio CD mp3 player + USB, TV, Wi-Fi Internet</b>
Galley	<b>Coffee machine, Kitchen utensils (Galley equipment, cutlery), Microwave, Refrigerator</b>
Interior	<b>Electric toilet</b>
Navigation	<b>Autopilot, Bow thruster, Compass, Divider, nautic chart, GPS chart plotter, Harbour guides, Nautical charts, Navigation set, Stern thruster, Wind instrument/Anemometer</b>
Safety	<b>Distress signals, Fire extinguisher , First aid kit , Horseshoe lifebuoy, Life belts (Safety harness), Life jackets, Liferaft , VHF radio</b>
Yacht electrics	<b>Air Conditioning, Battery charger , Generator, Heating, Inverter, Shore connection 220 V</b>



#### WEBSITE

[www.plujeme.cz](http://www.plujeme.cz)



#### E-MAIL

[info@plujeme.cz](mailto:info@plujeme.cz)



#### PHONE

+420 720 755 085



#### MOBILE

+420 777 170 276



#### PLUJEME RÁDI S.R.O.

Dlouhá 730/35, 11000 Praha 1 – Staré Město, Czech Republic

## SERVICES

SELECTED SERVICES	OBLIGATORY	PAYMENT TYPE	PRICE
<b>Comfort Pack</b> (Payable at the base) <b>Season: 2024.</b> payable in advance with reservation or upon check-in in cash or credit card; includes: VAT 25%, bed linen, towels, final cleaning, diver check upon check-out, Nespresso coffee machine, gas in the kitchen, small start up kit, 5l fuel for the outboard engine	Yes	per booking	<b>390,00 €</b>
<b>Marina ECO fee</b> (Payable at the base) <b>Season: 2024.</b> Electricity, water, recycling garbage disposal	Yes	per booking	<b>80,00 €</b>
<b>Cook</b> (Payable at the base) <b>Season: 2024.</b> payable to cook	Yes	per day + food	<b>180,00 €</b>
<b>Deposit insurance</b> (Payable at the base) <b>Season: 2024.</b> + 360€ refundable	Yes	per booking	<b>360,00 €</b>
<b>Early boarding/check-in</b> (Payable at the base) <b>Season: 2024.</b> at 13:00h	Yes	per booking	<b>200,00 €</b>
<b>Extra cleaning</b> (Payable at the base) <b>Season: 2024.</b>	Yes	per booking	<b>250,00 €</b>
<b>Hostess</b> (Payable at the base) <b>Season: 2024.</b> payable to hostess	Yes	per day + food	<b>170,00 €</b>
<b>One way</b> (Payable at the base) <b>Season: 2024.</b> Trogir - Dubrovnik; + mooring fee in Dubrovnik ACI Marina Komolac, check out mandatory Friday till 12:00 am	Yes	one-way	<b>1.000,00 €</b>
<b>Parking</b> (Payable at the base) <b>Season: 2024.</b> Marina Baotić; Can be ordered in advanced with booking, payable in our office	Yes	per week	<b>80,00 €</b>
<b>Permit for Montenegro</b> (Payable at the base) <b>Season: 2024.</b>	Yes	per booking	<b>300,00 €</b>
<b>Pet on board</b> (Payable at the base) <b>Season: 2024.</b> (small or medium dog up to 25 kg)	Yes	per pet	<b>70,00 €</b>
<b>Provisioning</b> (Payable at the base) <b>Season: 2024.</b> + invoice from the supermarket	Yes	per booking	<b>70,00 €</b>

<b>Sail refreshment</b> (Payable at the base) <b>Season: 2024.</b>	Yes	per booking	<b>350,00 €</b>
<b>Skipper</b> (Payable at the base) <b>Season: 2024.</b> payable to skipper	Yes	per day + food	<b>200,00 €</b>
<b>Transfer</b> (Payable at the base) <b>Season: 2024.</b> Taxi transfer Split airport - Marina Baotić or vice versa; up to 4 pax	Yes	one-way	<b>50,00 €</b>
<b>Transfer</b> (Payable at the base) <b>Season: 2024.</b> Taxi transfer Split airport - Marina Baotić or vice versa; up to 8 pax	Yes	one-way	<b>65,00 €</b>



**WEBSITE**  
www.plujeme.cz



**E-MAIL**  
info@plujeme.cz



**PHONE**  
+420 720 755 085



**PLUJEME RÁDI S.R.O.**  
Dlouhá 730/35, 11000 Praha 1 - Staré Město, Czech Republic



**MOBILE**  
+420 777 170 276

## ADDITIONAL EXTRAS

EXTRA	OBLIGATORY	PAYMENT TYPE	PRICE
<b>Beach towel</b> (Payable at the base) <b>Season: 2024.</b> Payable at the base	Yes	per piece	<b>6,00 €</b>
<b>Extra bedlinen</b> (Payable at the base) <b>Season: 2024.</b> Payable at the base	Yes	per person	<b>15,00 €</b>
<b>Gennaker</b> (Payable at the base) <b>Season: 2024.</b> + Security deposit 750 Euro - Payable at the base	Yes	per week	<b>300,00 €</b>
<b>Ice maker</b> (Payable at the base) <b>Season: 2024.</b> Payable at the base	Yes	per week	<b>130,00 €</b>
<b>Outboard engine 5 HP</b> (Payable at the base) <b>Season: 2024.</b> Payable at the base	Yes	per booking	<b>150,00 €</b>
<b>Railing net (Safety net)</b> (Payable at the base) <b>Season: 2024.</b> Payable at the base	Yes	per booking	<b>70,00 €</b>
<b>Self inflating life vest</b> (Payable at the base) <b>Season: 2024.</b> Payable at the base	Yes	per person	<b>15,00 €</b>
<b>Snorkeling equipment</b> (Payable at the base) <b>Season: 2024.</b> fin, mask, snorkel - Payable at the base	Yes	per set	<b>15,00 €</b>
<b>Stand up paddle (SUP)</b> (Payable at the base) <b>Season: 2024.</b> Payable at the base	Yes	per week	<b>150,00 €</b>



**WEBSITE**  
www.plujeme.cz



**E-MAIL**  
info@plujeme.cz



**PHONE**  
+420 720 755 085



**PLUJEME RÁDI S.R.O.**  
Dlouhá 730/35, 11000 Praha 1 – Staré Město, Czech Republic



**MOBILE**  
+420 777 170 276

## PRICE AND AVAILABILITY

21.09. - 28.09.2024 NOT AVAILABLE	28.09. - 12.10.2024 NOT AVAILABLE	12.10. - 19.10.2024 NOT AVAILABLE	19.10. - 26.10.2024 <b>2.970 €</b> 4.950 €
26.10. - 02.11.2024 NOT AVAILABLE	02.11. - 09.11.2024 <b>2.970 €</b> 4.950 €	09.11. - 16.11.2024 <b>2.970 €</b> 4.950 €	16.11. - 23.11.2024 <b>2.970 €</b> 4.950 €
23.11. - 30.11.2024 <b>2.970 €</b> 4.950 €	30.11. - 07.12.2024 <b>2.970 €</b> 4.950 €	07.12. - 14.12.2024 <b>2.970 €</b> 4.950 €	14.12. - 21.12.2024 <b>2.970 €</b> 4.950 €
21.12. - 28.12.2024 <b>2.970 €</b> 4.950 €			



### WEBSITE

[www.plujeme.cz](http://www.plujeme.cz)



### E-MAIL

[info@plujeme.cz](mailto:info@plujeme.cz)



### PHONE

+420 720 755 085



### MOBILE

+420 777 170 276



### PLUJEME RÁDI S.R.O.

Dlouhá 730/35, 11000 Praha 1 – Staré Město, Czech Republic