

BALI CATSPACE

Let's Go (2021)

Catamaran Bali Catspace Let's Go, built in 2021 is anchored in the Nassau, Palm Cay Marina, New Providence, Bahamas. It has **4 cabins**, can accommodate **8 people** and has **4 toilets**. Bed linen and kitchen equipment are included in the price.

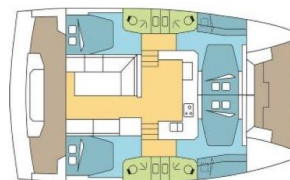

YACHT SPECIFICATIONS

Yacht Base

Nassau, Palm Cay Marina, Bahamas

Yacht ID

3157

Brands

Catana

Yacht name

Let's Go

Production year

2021

Length

40 ft

Cabins

4

Berths

8

Max Persons

10

WC

4

Engine

2 x 30 HP

Fuel tank

2200 l



WEBSITE

www.plujeme.cz



PHONE

+420 720 755 085



MOBILE

+420 777 170 276



E-MAIL

info@plujeme.cz



PLUJEME RÁDI S.R.O.

Dlouhá 730/35, 11000 Praha 1 – Staré Město, Czech Republic

STANDARD YACHT EQUIPMENT

Comfort	Mosquito nets
Deck	Bathing platform, Bilge pump - Mechanic, Bimini top, Cockpit/stern, outside shower, Electric anchor windlass, Grill/Barbecue/Plancha, Main anchor, Outboard engine, Spare anchor (Reserve, Auxiliary anchor), Swimming ladder
Entertainment	CD player, Indoor speakers, MP3 Jack-Ipod, Outdoor speakers, RIB
Galley	Freezer, Hot water, Oven, Refrigerator, Stove
Navigation	Autopilot, Binoculars, Compass, GPS chart plotter, Log, Speed, Depth- echo sounder, Nautical charts, Radar reflector
Safety	Black Water Tank, Distress flare box, Emergency tiller, Fire extinguisher , First aid kit , Flashlight, Fog horn, Life jackets, Liferaft , Set of tools , VHF radio
Sails	Lazy bag, Lazy jacks
Yacht electrics	Air Conditioning, Generator, Heating, Inverter, Shore connection 220 V, Shore power cable, Solar panels, Watermaker - desalinator, Wind generator



WEBSITE

www.plujeme.cz



E-MAIL

info@plujeme.cz



PHONE

+420 720 755 085



MOBILE

+420 777 170 276



PLUJEME RÁDI S.R.O.

Dlouhá 730/35, 11000 Praha 1 – Staré Město, Czech Republic

SERVICES

SELECTED SERVICES	OBLIGATORY	PAYMENT TYPE	PRICE
Bahamas foreign charter tax (Payable now) Season: 2026 Exotic.	Yes	per booking	0,00 €
Essentials pack (Payable now) Season: 2026 Exotic. INCLUDED: full reduction of security deposit (0 € at base)// starter pack – (1 gallon water or 4 bottles of 1.5L, 1 bottle of disinfectant, 1 small bottle of washing up liquid, 1 dish cloth, 1 sponge, garbage bags, 1 roll of paper towels, 1 box of matches, 1 roll of toilet paper in each head)// final cleaning // 1 set of bed sheets & towels, dinghy, outboard engine & initial supply of fuel, gas and water tanks// DYC assistance guarantee // 1st & last night in the marina /// NOT INCLUDED: refuelling, gas & water consumption at end of charter, taxes if any, handling fees, additional equipment deposit	Yes	per booking	885,00 €
Handling fees (Payable now) Season: 2026 Exotic.	Yes	per booking	35,00 €
Crew change (Payable now) Season: 2026 Exotic. Any crew change during the charter is subject to € 200.- additional cost. The charge includes administration cost, change of bed linen and towels and one night at DYC ponton (marina fee included only if the same base than start base). It doesn't include cleaning, nor new transit log where applicable.	No	per booking	200,00 €
Early boarding/check-in (Payable now) Season: 2026 Exotic. EB (boat only) - 14:00 h / 2 PM starting time of boat's delivery // limited number of early boardings on same departure day	No	per booking	450,00 €
Early boarding/check-in (Payable now) Season: 2026 Exotic. EB boat + extra fee skipper - 14:00 h / 2 PM starting time of boat's delivery // limited number of early boardings on same departure day	No	per booking	735,00 €
Early boarding/check-in (Payable now) Season: 2026 Exotic. EB + extra fee Skipper & Hostes - 14:00 h / 2 PM starting time of boat's delivery // limited number of early boardings on same departure day	No	per booking	960,00 €

Electric & Water consumption in the Marinas (Payable at the base) Season: 2026 Exotic. Electric & Water consumption based on 2 nights on our dock (base will confirm the amount to pay locally depending on nights spent on dock)	No	per booking	28,00 €
Extra set of linen (choose how many) (Payable now) Season: 2026 Exotic. Extra set of linen : 15 € 1 set of linen (2 sheets & 2 pillow case) - to be updated manually	No	per booking	15,00 €
Extra set of towels (choose how many) (Payable now) Season: 2026 Exotic. Extra set of towels: 10 € 1 set of towels (1 face & 1 bath towel) - to be updated manually	No	per booking	10,00 €
Final cleaning (Payable now) Season: 2026 Exotic. included in Essentials pack	No	per booking	335,00 €
Full board 1-4 pax (number of guests to update manually) (Payable now) Season: 2026 Exotic. only available if cook is booked on board as the cook will do the provisioning based on client's preference. Includes breakfast, lunch & dinner + the crew's food. Does not included alcoholic drinks	No	per guest/day	70,00 €
Full board 5-12 pax (number of guests to update manually) (Payable now) Season: 2026 Exotic. only available if cook is booked on board as the cook will do the provisioning based on client's preference. Includes breakfast, lunch & dinner + the crew's food. Does not included alcoholic drinks	No	per guest/day	65,00 €
Hostess (Payable now) Season: 2026 Exotic. + provisioning, a cabin or forepeak to sleep and access to a WC/Shower	No	per night	225,00 €
Regatta surcharge (Payable now) Season: 2026 Exotic. all the regattas apart of ASW (different regatta surcharge for ASW) // A special race deposit need to be doubled manually once the regatta surcharge is added.	No	per booking	0,00 €
Same day briefing (Payable now) Season: 2026 Exotic. Same day briefing starting between 5 & 5.30pm (departure following morning)	No	per booking	150,00 €
Skipper (Payable now) Season: 2026 Exotic. + provisioning, a cabin or forepeak to sleep and access to a WC/Shower	No	per night	285,00 €

Starter pack (Payable now)	No	per booking	50,00 €
Season: 2026 Exotic. included in Essentials pack (The pack includes: 1 gallon water (or 4 bottles of 1.5L), 1 bottle of disinfectant, 1 small bottle of washing up liquid, 1 dish cloth, 1 sponge, garbage bags, 1 roll of paper towels, 1 box of matches, 1 roll of toilet paper in each head)			
Transfer (Payable now)	No	one-way	100,00 €
Season: 2026 Exotic. OW- airport - marina -1-2 pax + 6€ each additional pax (up to 6 pax)			
Transfer (Payable now)	No	one-way	153,00 €
Season: 2026 Exotic. OW- airport/marina - includes grocery stop (1 hour max) 1-2 pax + 6€ each additional pax (up to 6 pax)			
Transfer (Payable now)	No	one-way	177,00 €
Season: 2026 Exotic. OW- 7-9 pax: airport - marina			
Transfer (Payable now)	No	round trip	200,00 €
Season: 2026 Exotic. RT - airport - marina - airport 1-2 pax + 12€ each additional pax (up to 6 pax)			
Transfer (Payable now)	No	one-way	230,00 €
Season: 2026 Exotic. OW - 7-9 pax: airport/marina- includes grocery stop (1 hour max)			
Transfer (Payable now)	No	one-way	236,00 €
Season: 2026 Exotic. OW- 10-12 pax: airport - marina			
Transfer (Payable now)	No	one-way	290,00 €
Season: 2026 Exotic. OW - 10-12 pax: airport/marina- includes grocery stop (1 hour max)			
Transfer (Payable now)	No	round trip	306,00 €
Season: 2026 Exotic. RT- airport/marina/airport - includes grocery stop (1 hour max) 1-2 pax + 12€ each additional pax (up to 6 pax)			
Transfer (Payable now)	No	round trip	355,00 €
Season: 2026 Exotic. RT - 7-9 pax: airport - marina - airport			
Transfer (Payable now)	No	round trip	460,00 €
Season: 2026 Exotic. RT- 7-9 pax: airport/marina/airport - includes grocery stop (1 hour max)			
Transfer (Payable now)	No	round trip	473,00 €
Season: 2026 Exotic. RT - 10-12 pax: airport - marina - airport			

Transfer (Payable now)

No

round trip

580,00 €

Season: 2026 Exotic. RT- 10-12 pax: airport/marina/airport - includes grocery stop (1 hour max)

WI-FI Internet connection on boat (Payable now)

No

per night

21,00 €

Season: 2026 Exotic. Unlimited data



WEBSITE

www.plujeme.cz



PHONE

+420 720 755 085



MOBILE

+420 777 170 276



E-MAIL

info@plujeme.cz



PLUJEME RÁDI S.R.O.

Dlouhá 730/35, 11000 Praha 1 – Staré Město, Czech Republic

ADDITIONAL EXTRAS

EXTRA	OBLIGATORY	PAYMENT TYPE	PRICE
Fishing equipment (Payable now) Season: 2026 Exotic. Additional deposit 100 EUR (subject to availability) - Payable now	No	per day	15,00 €
Kayak single (Payable now) Season: 2026 Exotic. price per day - Additional deposit 100 EUR - Payable now	No	per night	15,00 €
Kayak tandem (Payable now) Season: 2026 Exotic. price per day - Additional deposit 100 EUR - Payable now	No	per night	15,00 €
Outboard engine 8 & 9,8 HP (Payable now) Season: 2026 Exotic. Dinghy not suitable in any case for waterski or wakeboard. Additional security deposit of 500 € on outboard engines. - Payable now	No	per day	35,00 €
Railing net (Safety net) (Payable now) Season: 2026 Exotic. net is supplied but not installed - Payable now	No	per booking	250,00 €
Stand up paddle (SUP) (Payable now) Season: 2026 Exotic. Price per day - Additional deposit 100 EUR - Payable now	No	per night	15,00 €



WEBSITE
www.plujeme.cz



PHONE
+420 720 755 085



MOBILE
+420 777 170 276



E-MAIL
info@plujeme.cz



PLUJEME RÁDI S.R.O.
Dlouhá 730/35, 11000 Praha 1 – Staré Město, Czech Republic

PRICE AND AVAILABILITY

23.11. - 07.12.2024 NOT AVAILABLE	07.12. - 14.12.2024 NOT AVAILABLE	15.12. - 22.12.2024 NOT AVAILABLE	22.12. - 28.12.2024 NOT AVAILABLE
28.12. - 04.01.2025 NOT AVAILABLE	04.01. - 11.01.2025 NOT AVAILABLE	11.01. - 18.01.2025 NOT AVAILABLE	18.01. - 01.02.2025 NOT AVAILABLE
01.02. - 11.02.2025 NOT AVAILABLE	15.02. - 22.02.2025 6.027 € 8.610 €	22.02. - 01.03.2025 6.010 € 8.585 €	01.03. - 08.03.2025 6.010 € 8.585 €
08.03. - 15.03.2025 6.010 € 8.585 €	15.03. - 26.03.2025 NOT AVAILABLE	29.03. - 05.04.2025 9.000 €	05.04. - 12.04.2025 ON OPTION
12.04. - 19.04.2025 NOT AVAILABLE	19.04. - 26.04.2025 NOT AVAILABLE	26.04. - 04.05.2025 NOT AVAILABLE	10.05. - 17.05.2025 NOT AVAILABLE
17.05. - 24.05.2025 5.030 € 7.185 €	26.05. - 01.06.2025 NOT AVAILABLE	07.06. - 14.06.2025 5.058 € 7.225 €	14.06. - 21.06.2025 5.058 € 7.225 €
21.06. - 28.06.2025 5.075 € 7.250 €	28.06. - 05.07.2025 7.325 € 7.710 €		



WEBSITE

www.plujeme.cz



E-MAIL

info@plujeme.cz



PHONE

+420 720 755 085



MOBILE

+420 777 170 276



PLUJEME RÁDI S.R.O.

Dlouhá 730/35, 11000 Praha 1 – Staré Město, Czech Republic

PRICE AND AVAILABILITY

05.07. - 12.07.2025 7.458 € 7.850 €	12.07. - 19.07.2025 7.458 € 7.850 €	19.07. - 26.07.2025 6.712 € 7.065 €	26.07. - 02.08.2025 6.313 € 6.645 €
02.08. - 09.08.2025 5.391 € 5.675 €	09.08. - 16.08.2025 4.688 € 4.935 €	16.08. - 23.08.2025 4.688 € 4.935 €	23.08. - 06.09.2025 NOT AVAILABLE
06.09. - 13.09.2025 4.688 € 4.935 €	13.09. - 20.09.2025 4.688 € 4.935 €	20.09. - 27.09.2025 4.688 € 4.935 €	27.09. - 04.10.2025 4.935 € 5.195 €
04.10. - 11.10.2025 4.589 € 4.830 €	11.10. - 18.10.2025 5.163 € 5.435 €	18.10. - 25.10.2025 5.729 € 6.030 €	25.10. - 01.11.2025 6.166 € 6.490 €
01.11. - 08.11.2025 6.736 € 7.090 €	08.11. - 15.11.2025 6.736 € 7.090 €	15.11. - 22.11.2025 6.736 € 7.090 €	22.11. - 29.11.2025 7.073 € 7.445 €
29.11. - 06.12.2025 6.736 € 7.090 €	06.12. - 13.12.2025 5.600 € 5.895 €	13.12. - 20.12.2025 5.600 € 5.895 €	20.12. - 27.12.2025 9.871 € 10.390 €



WEBSITE

www.plujeme.cz



E-MAIL

info@plujeme.cz



PHONE

+420 720 755 085



MOBILE

+420 777 170 276



PLUJEME RÁDI S.R.O.

Dlouhá 730/35, 11000 Praha 1 – Staré Město, Czech Republic