

NAUTITECH 47 POWER

SEATTLE (2020)

Power catamaran Nautitech 47 Power SEATTLE, built in 2020 is anchored in the Trogir, Yachtclub Seget (Marina Baotić), Split region, Croatia. It has 4 + 2 cabins, can accommodate 8 + 2 + 2 people and has 4 toilets. Bed linen and kitchen equipment are included in the price.

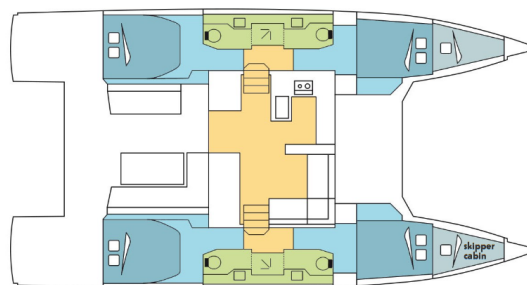

YACHT SPECIFICATIONS

Yacht Base

Trogir, Yachtclub Seget (Marina Baotić), Croatia

Yacht ID

3070

Brands

Bavaria

Yacht name

SEATTLE

Production year

2020

Length

47 ft

Cabins

4 + 2

Berths

8 + 2 + 2

Max Persons

12

WC

4

Engine

2 x 300 HP

Fuel tank

1000 l



WEBSITE

www.plujeme.cz



PHONE

+420 720 755 085



MOBILE

+420 777 170 276



E-MAIL

info@plujeme.cz



PLUJEME RÁDI S.R.O.

Dlouhá 730/35, 11000 Praha 1 – Staré Město, Czech Republic

STANDARD YACHT EQUIPMENT

Comfort	Cockpit cushions
Deck	Bimini top, Cockpit fridge, Cockpit table, Cockpit/stern, outside shower, Electric anchor windlass, Flybridge, Grill/Barbecue/Plancha, Swimming ladder
Entertainment	Radio, Underwater lights
Galley	Oven, Refrigerator, Stove
Interior	Convertible table in salon, Electric fans in cabins, Electric toilet
Navigation	Autopilot, GPS chart plotter
Safety	VHF radio
Yacht electrics	Air Conditioning, Generator, Inverter, USB sockets, Watermaker - desalinator



WEBSITE

www.plujeme.cz



E-MAIL

info@plujeme.cz



PHONE

+420 720 755 085



MOBILE

+420 777 170 276



PLUJEME RÁDI S.R.O.

Dlouhá 730/35, 11000 Praha 1 – Staré Město, Czech Republic

SERVICES

SELECTED SERVICES	OBLIGATORY	PAYMENT TYPE	PRICE
Final cleaning (Payable now) Season: 2025. included in Essentials pack	Yes	per booking	340,00 €
Handling fees (Payable now) Season: 2025.	Yes	per booking	20,00 €
Starter pack (Payable now) Season: 2025. included in Essentials pack (The pack includes: 1 gallon water (or 4 bottles of 1.5L), 1 bottle of disinfectant, 1 small bottle of washing up liquid, 1 dish cloth, 1 sponge, garbage bags, 1 roll of paper towels, 1 box of matches, 1 roll of toilet paper in each head)	Yes	per booking	30,00 €
Tourist tax (Payable at the base) Season: 2025. Payment by credit card only, no cash	Yes	per guest/day	1,33 €
Crew change (Payable now) Season: 2025. Any crew change during the charter is subject to € 200.- additional cost. The charge includes administration cost, change of bed linen and towels and one night at DYC ponton (marina fee included only if the same base than start base). It doesn't include cleaning, nor new transit log where applicable.	No	per booking	200,00 €
Early boarding/check-in (Payable now) Season: 2025. EB (boat only) - 13:00h, starting time of boat's delivery // limited number of early boardings on same departure day	No	per booking	360,00 €
Early boarding/check-in (Payable now) Season: 2025. EB + extra fee skipper - 13:00h, starting time of boat's delivery // limited number of early boardings on same departure day	No	per booking	460,00 €
Early boarding/check-in (Payable now) Season: 2025. EB + extra fee Skipper & Hostess - 13:00h, starting time of boat's delivery // limited number of early boardings on same departure day	No	per booking	550,00 €
Extra set of linen (choose how many) (Payable now) Season: 2025. Extra set of linen : 15 € 1 extra set of linen (2 sheets & 2 pillow case) - to be updated manually	No	per booking	15,00 €

Extra set of towels (choose how many) (Payable now)	No	per booking	10,00 €
Season: 2025. Extra set of towels: 10 € 1 extra set of towels (1 face & 1 bath towel) - to be updated manually			
Full board 1-4 pax (number of guests to update manually) (Payable now)	No	per guest/day	60,00 €
Season: 2025. only available if cook is booked on board as the cook will do the provisioning based on client's preference. Includes breakfast, lunch & dinner + the crew's food. Does not included alcoholic drinks			
Full board 5-12 pax (number of guests to update manually) (Payable now)	No	per guest/day	55,00 €
Season: 2025. only available if cook is booked on board as the cook will do the provisioning based on client's preference. Includes breakfast, lunch & dinner + the crew's food. Does not included alcoholic drinks			
Half board 1-4 pax (number of guests to update manually) (Payable now)	No	per guest/day	50,00 €
Season: 2025. only available if cook is booked on board as the cook will do the provisioning based on client's preference. Includes breakfast & lunch OR dinner + the crew's food. Does not included alcoholic drinks			
Half board 5-12 pax (number of guests to update manually) (Payable now)	No	per guest/day	45,00 €
Season: 2025. only available if cook is booked on board as the cook will do the provisioning based on client's preference. Includes breakfast & lunch OR dinner + the crew's food. Does not included alcoholic drinks			
Hostess/Cook (Payable now)	No	per night	180,00 €
Season: 2025. + provisioning, a cabin or forepeak to sleep and access to a WC/Shower			
Regatta surcharge (Payable now)	No	per booking	0,00 €
Season: 2025. A special race deposit need to be doubled manually once the regatta surcharge is added.			
Skipper (Payable now)	No	per night	250,00 €
Season: 2025. + provisioning, a cabin or forepeak to sleep and access to a WC/Shower			
Transfer (Payable now)	No	round trip	82,00 €
Season: 2025. RT - Split Airport / Base 1 - 4 pax			
Transfer (Payable now)	No	round trip	96,00 €
Season: 2025. RT - Split Airport / Base 5 - 8 pax			

WI-FI Internet connection on board (Payable now)
Season: 2025. limited - included in price

 **WEBSITE**
www.plujeme.cz
 **E-MAIL**
info@plujeme.cz

 **PHONE** No
+420 720 755 085

 **MOBILE** per week
+420 777 170 276 **32,00 €**

 **PLUJEME RÁDI S.R.O.**
Dlouhá 730/35, 11000 Praha 1 - Staré Město, Czech Republic

ADDITIONAL EXTRAS

EXTRA	OBLIGATORY	PAYMENT TYPE	PRICE
Kayak single (Payable now) Season: 2025. Price per day / Additional deposit 100 EUR - Payable now	No	per night	15,00 €
Outboard engine 8 & 9,8 HP (Payable now) Season: 2025. Subject to Availability ; 8/9hp. Dinghy not suitable in any case for waterski or wakeboard. Additional security deposit of 500 € - Payable now	No	per day	35,00 €
Stand up paddle (SUP) (Payable now) Season: 2025. Price per day / Additional deposit 100 EUR - Payable now	No	per night	15,00 €

**WEBSITE**www.plujeme.cz**E-MAIL**info@plujeme.cz**PHONE**

+420 720 755 085

**MOBILE**

+420 777 170 276

**PLUJEME RÁDI S.R.O.**

Dlouhá 730/35, 11000 Praha 1 – Staré Město, Czech Republic

PRICE AND AVAILABILITY

01.03. - 08.03.2025 1.830 € 2.140 €	08.03. - 15.03.2025 1.830 € 2.140 €	15.03. - 22.03.2025 1.830 € 2.140 €	22.03. - 29.03.2025 1.830 € 2.140 €
29.03. - 05.04.2025 1.830 € 2.140 €	05.04. - 12.04.2025 1.830 € 2.140 €	12.04. - 19.04.2025 1.830 € 2.140 €	19.04. - 26.04.2025 2.368 € 2.770 €
26.04. - 03.05.2025 3.382 € 3.560 €	03.05. - 10.05.2025 NOT AVAILABLE	10.05. - 17.05.2025 NOT AVAILABLE	17.05. - 24.05.2025 NOT AVAILABLE
24.05. - 31.05.2025 ON OPTION	31.05. - 07.06.2025 NOT AVAILABLE	07.06. - 14.06.2025 8.840 € 9.305 €	14.06. - 21.06.2025 9.880 € 10.400 €
21.06. - 28.06.2025 10.854 € 11.425 €	28.06. - 05.07.2025 NOT AVAILABLE	05.07. - 12.07.2025 NOT AVAILABLE	12.07. - 19.07.2025 14.160 € 14.905 €
19.07. - 26.07.2025 14.160 € 14.905 €	26.07. - 02.08.2025 14.160 € 14.905 €		



WEBSITE

www.plujeme.cz



E-MAIL

info@plujeme.cz



PHONE

+420 720 755 085



MOBILE

+420 777 170 276



PLUJEME RÁDI S.R.O.

Dlouhá 730/35, 11000 Praha 1 – Staré Město, Czech Republic

PRICE AND AVAILABILITY

02.08. - 09.08.2025 14.160 € 14.905 €	09.08. - 16.08.2025 14.160 € 14.905 €	16.08. - 23.08.2025 12.711 € 13.380 €	23.08. - 30.08.2025 NOT AVAILABLE
30.08. - 06.09.2025 9.671 € 10.180 €	06.09. - 13.09.2025 9.662 € 10.170 €	13.09. - 27.09.2025 NOT AVAILABLE	27.09. - 04.10.2025 NOT AVAILABLE
04.10. - 18.10.2025 NOT AVAILABLE	18.10. - 25.10.2025 2.309 € 2.430 €	25.10. - 01.11.2025 2.309 € 2.430 €	01.11. - 08.11.2025 2.309 € 2.430 €
08.11. - 15.11.2025 2.309 € 2.430 €	15.11. - 22.11.2025 2.309 € 2.430 €	22.11. - 29.11.2025 2.309 € 2.430 €	02.12. - 26.02.2026 NOT AVAILABLE



WEBSITE

www.plujeme.cz



E-MAIL

info@plujeme.cz



PHONE

+420 720 755 085



MOBILE

+420 777 170 276



PLUJEME RÁDI S.R.O.

Dlouhá 730/35, 11000 Praha 1 – Staré Město, Czech Republic