

HANSE 588

Amadea (2020)

Sailing yacht Hanse 588 Amadea, built in 2020 is anchored in the **Kos, Kos Marina, Dodecanese, Greece**. It has **3 + 1 cabins**, can accommodate **6 + 1 people** and has **3 + 1 toilets**. Bed linen and kitchen equipment are included in the price.

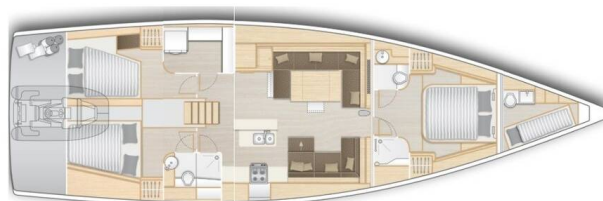

YACHT SPECIFICATIONS

Yacht Base

Kos, Kos Marina, Greece

Yacht ID

2733

Brands

Hanse Yachts

Yacht name

Amadea

Production year

2020

Length

56 ft

Cabins

3 + 1

Berths

6 + 1

WC

3 + 1

Engine

0 x 0 HP

Fuel tank

0 l



WEBSITE

www.plujeme.cz



PHONE

+420 720 755 085



MOBILE

+420 777 170 276



E-MAIL

info@plujeme.cz



PLUJEME RÁDI S.R.O.

Dlouhá 730/35, 11000 Praha 1 – Staré Město, Czech Republic

STANDARD YACHT EQUIPMENT

Comfort	Cockpit cushions
Deck	Bathing platform, Bimini top, Dinghy with outboard engine, Hydraulic gangway, Hydraulic lifting swimming platform, Sprayhood, Teak deck
Entertainment	Radio, Underwater lights
Interior	Electric fans in cabins, Electric toilet
Navigation	Autopilot, Bow thruster, GPS chart plotter
Sails	Electric winch, Self tacking jib
Yacht electrics	Generator, Solar panels, USB charger for mobile phone and laptop



WEBSITE

www.plujeme.cz



E-MAIL

info@plujeme.cz



PHONE

+420 720 755 085



MOBILE

+420 777 170 276



PLUJEME RÁDI S.R.O.

Dlouhá 730/35, 11000 Praha 1 – Staré Město, Czech Republic

SERVICES

SELECTED SERVICES	OBLIGATORY	PAYMENT TYPE	PRICE
Deposit insurance (Payable at the base) Season: 2024. + refundable 700 EUR, payable on spot in CASH	Yes	per booking	350,00 €
Skipper (Payable at the base) Season: 2024. -payable on spot in cash / plus skipper's own cabin and a WC to share. * Security deposit insurance is mandatory in skippered charters: 350 EUR plus refundable 700 EUR	Yes	per week + food	1.400,00 €
Standard Charter Pack (Payable at the base) Season: 2024. Welcome kit, final cleaning, bed sheets & towels (one set per person), first fill for outboard engine, spare bottle of gas	Yes	per booking	380,00 €
Deposit insurance (Payable at the base) Season: 2025. + refundable 700 EUR, payable on spot in CASH	Yes	per booking	350,00 €
Skipper (Payable at the base) Season: 2025. -payable on spot in cash / plus skipper's own cabin and a WC to share. * Security deposit insurance is mandatory in skippered charters: 350 EUR plus refundable 700 EUR	Yes	per week + food	1.400,00 €
Standard Charter Pack (Payable at the base) Season: 2025. Welcome kit, final cleaning, bed sheets & towels (one set per person), first fill for outboard engine, spare bottle of gas	Yes	per booking	380,00 €
Beach towel (Payable at the base) Season: 2024.	Yes	per booking	10,00 €
Cook (Payable at the base) Season: 2024. Crew provisioning to be provided by Charterer in arrangement with crew. If monetary compensation shall be agreed, then it shall be of no less than €15 per crew member per day. Charterer shall provide crew with sleeping cabin/berth and shower/toilet use to be designated to them onboard.	Yes	per day + food	190,00 €
Crew change (Payable at the base) Season: 2024. In case of mandatory formalities (contract termination) due to crew change, available only in our charter bases, includes paperwork & formalities, 1 day berthing fee, water tank top-up. Yacht cleaning & laundry not included	Yes	per booking	100,00 €

Family pack (Payable at the base) Season: 2024. Safety net, SUP, junior life jackets, normal foam type	Yes	per booking	350,00 €
Fast Track pack (Payable at the base) Season: 2024. Access to the yacht by 14:00h on embarkation day, only IF feasible	Yes	per booking	150,00 €
Hostess (Payable at the base) Season: 2024. Crew provisioning to be provided by Charterer in arrangement with crew. If monetary compensation shall be agreed, then it shall be of no less than €15 per crew member per day. Charterer shall provide crew with sleeping cabin/berth and shower/toilet use to be designated to them onboard.	Yes	per day + food	180,00 €
Internet pack (Payable at the base) Season: 2024. Wi-Fi router for Internet aboard (subject to GSM coverage up to 10GB/week)	Yes	per week	50,00 €
One way fee (Payable at the base) Season: 2024. Volos-Skiathos	Yes	per booking	300,00 €
One way fee (Payable at the base) Season: 2024. Preveza-Lefkas	Yes	per booking	300,00 €
One way fee (Payable at the base) Season: 2024. Athens-Lavrion	Yes	per booking	400,00 €
One way fee (Payable at the base) Season: 2024. in-between Dodecanese or Ionian or Cyclades	Yes	per booking	500,00 €
One way fee (Payable at the base) Season: 2024. Athens-Cyclades/Sporades	Yes	per booking	800,00 €
One way fee (Payable at the base) Season: 2024. Athens-Dodecanese	Yes	per booking	1.200,00 €
One way fee (Payable at the base) Season: 2024. Athens-Ionian	Yes	per booking	1.900,00 €
Overnight on board (Payable at the base) Season: 2024. Embarkation on yacht & overnight stay the day before charter starts, check-in by 13:00h on charter start day. Subject to last minute availability of yacht on previous day.	Yes	per booking	150,00 €
Pet on board (Payable at the base) Season: 2024. up to 7 kg	Yes	per booking	150,00 €

Stand up paddle (SUP) (Payable at the base) Season: 2024.	Yes	per week	100,00 €
Beach towel (Payable at the base) Season: 2025.	Yes	per booking	10,00 €
Cook (Payable at the base) Season: 2025. Crew provisioning to be provided by Charterer in arrangement with crew. If monetary compensation shall be agreed, then it shall be of no less than €15 per crew member per day. Charterer shall provide crew with sleeping cabin/berth and shower/toilet use to be designated to them onboard.	Yes	per day + food	190,00 €
Crew change (Payable at the base) Season: 2025. In case of mandatory formalities (contract termination) due to crew change, available only in our charter bases, includes paperwork & formalities, 1 day berthing fee, water tank top-up. Yacht cleaning & laundry not included	Yes	per booking	100,00 €
Family pack (Payable at the base) Season: 2025. Safety net, SUP, junior life jackets, normal foam type	Yes	per booking	350,00 €
Fast Track pack (Payable at the base) Season: 2025. Access to the yacht by 14:00h on embarkation day, only IF feasible	Yes	per booking	150,00 €
Hostess (Payable at the base) Season: 2025. Crew provisioning to be provided by Charterer in arrangement with crew. If monetary compensation shall be agreed, then it shall be of no less than €15 per crew member per day. Charterer shall provide crew with sleeping cabin/berth and shower/toilet use to be designated to them onboard.	Yes	per day + food	180,00 €
Internet pack (Payable at the base) Season: 2025. Wi-Fi router for Internet aboard (subject to GSM coverage up to 10GB/week)	Yes	per week	50,00 €
One way fee (Payable at the base) Season: 2025. Volos-Skiathos	Yes	per booking	300,00 €
One way fee (Payable at the base) Season: 2025. Preveza-Lefkas	Yes	per booking	300,00 €
One way fee (Payable at the base) Season: 2025. Athens-Lavrion	Yes	per booking	400,00 €

One way fee (Payable at the base) Season: 2025. in-between Dodecanese or Ionian or Cyclades	Yes	per booking	500,00 €
One way fee (Payable at the base) Season: 2025. Athens-Cyclades/Sporades	Yes	per booking	800,00 €
One way fee (Payable at the base) Season: 2025. Athens-Dodecanese	Yes	per booking	1.200,00 €
One way fee (Payable at the base) Season: 2025. Athens-Ionian	Yes	per booking	1.900,00 €
Overnight on board (Payable at the base) Season: 2025. Embarkation on yacht & overnight stay the day before charter starts, check-in by 13:00h on charter start day. Subject to last minute availability of yacht on previous day.	Yes	per booking	150,00 €
Pet on board (Payable at the base) Season: 2025. up to 7 kg	Yes	per booking	150,00 €
Provisioning (Payable at the base) Season: 2025. Food & beverage provisioning arranged in advance, using Charter Company Provision List template. Purchased supplies are delivered to yacht only after the yacht has been handed over / check-in complete	Yes	per booking	20,00 €
Stand up paddle (SUP) (Payable at the base) Season: 2025.	Yes	per week	100,00 €



WEBSITE
www.plujeme.cz



PHONE
+420 720 755 085



MOBILE
+420 777 170 276



E-MAIL
info@plujeme.cz



PLUJEME RÁDI S.R.O.
Dlouhá 730/35, 11000 Praha 1 – Staré Město, Czech Republic

ADDITIONAL EXTRAS

EXTRA	OBLIGATORY	PAYMENT TYPE	PRICE
Grill/Barbecue/Plancha (Payable at the base) Season: 2024. portable, 1 x gas bottle included - Payable at the base	Yes	per week	100,00 €
Grill/Barbecue/Plancha (Payable at the base) Season: 2025. portable, 1 x gas bottle included - Payable at the base	Yes	per week	100,00 €



WEBSITE

www.plujeme.cz



E-MAIL

info@plujeme.cz



PHONE

+420 720 755 085



MOBILE

+420 777 170 276



PLUJEME RÁDI S.R.O.

Dlouhá 730/35, 11000 Praha 1 – Staré Město, Czech Republic

PRICE AND AVAILABILITY

21.09. - 28.09.2024 5.693 € 10.350 €	28.09. - 05.10.2024 4.840 € 8.800 €	05.10. - 12.10.2024 ON OPTION	12.10. - 19.10.2024 5.720 € 8.800 €
19.10. - 26.10.2024 6.795 € 7.550 €	26.10. - 02.11.2024 6.795 € 7.550 €	02.11. - 09.11.2024 6.795 € 7.550 €	09.11. - 16.11.2024 7.550 €
16.11. - 23.11.2024 7.550 €	23.11. - 30.11.2024 7.550 €	30.11. - 07.12.2024 7.550 €	07.12. - 14.12.2024 7.550 €
14.12. - 21.12.2024 7.550 €	21.12. - 28.12.2024 7.550 €	02.01. - 22.03.2025 NOT AVAILABLE	22.03. - 29.03.2025 6.455 € 7.550 €
29.03. - 05.04.2025 6.455 € 7.550 €	05.04. - 12.04.2025 6.040 € 7.550 €	12.04. - 19.04.2025 6.040 € 7.550 €	19.04. - 26.04.2025 6.040 € 7.550 €
26.04. - 03.05.2025 7.040 € 8.800 €			



WEBSITE

www.plujeme.cz



E-MAIL

info@plujeme.cz



PHONE

+420 720 755 085



MOBILE

+420 777 170 276



PLUJEME RÁDI S.R.O.

Dlouhá 730/35, 11000 Praha 1 – Staré Město, Czech Republic

PRICE AND AVAILABILITY

03.05. - 10.05.2025 7.040 € 8.800 €	10.05. - 17.05.2025 7.040 € 8.800 €	17.05. - 24.05.2025 7.040 € 8.800 €	24.05. - 31.05.2025 8.280 € 10.350 €
31.05. - 07.06.2025 8.280 € 10.350 €	07.06. - 14.06.2025 8.280 € 10.350 €	14.06. - 21.06.2025 8.280 € 10.350 €	21.06. - 28.06.2025 9.640 € 12.050 €
28.06. - 05.07.2025 9.640 € 12.050 €	05.07. - 12.07.2025 9.640 € 12.050 €	12.07. - 19.07.2025 9.640 € 12.050 €	19.07. - 26.07.2025 9.640 € 12.050 €
26.07. - 02.08.2025 9.640 € 12.050 €	02.08. - 09.08.2025 11.120 € 13.900 €	09.08. - 16.08.2025 11.120 € 13.900 €	16.08. - 23.08.2025 11.120 € 13.900 €
23.08. - 30.08.2025 9.640 € 12.050 €	30.08. - 06.09.2025 10.303 € 12.050 €	06.09. - 13.09.2025 10.303 € 12.050 €	13.09. - 20.09.2025 8.849 € 10.350 €
20.09. - 27.09.2025 8.849 € 10.350 €	27.09. - 04.10.2025 7.480 € 8.800 €	04.10. - 11.10.2025 7.480 € 8.800 €	11.10. - 18.10.2025 7.480 € 8.800 €
18.10. - 25.10.2025 6.418 € 7.550 €	25.10. - 01.11.2025 6.418 € 7.550 €	01.11. - 08.11.2025 6.418 € 7.550 €	08.11. - 15.11.2025 6.418 € 7.550 €
15.11. - 22.11.2025 6.455 € 7.550 €	22.11. - 29.11.2025 6.455 € 7.550 €	29.11. - 06.12.2025 6.455 € 7.550 €	06.12. - 13.12.2025 6.795 € 7.550 €
13.12. - 20.12.2025 6.795 € 7.550 €	20.12. - 27.12.2025 6.795 € 7.550 €		



WEBSITE

www.plujeme.cz



E-MAIL

info@plujeme.cz



PHONE

+420 720 755 085



MOBILE

+420 777 170 276



PLUJEME RÁDI S.R.O.

Dlouhá 730/35, 11000 Praha 1 – Staré Město, Czech Republic