

LAGOON 40

Sailor Moon (2020)

Catamaran **Lagoon 40 Sailor Moon**, built in **2020** is anchored in the **ACI Marina Slano, Dubrovnik region, Croatia**. It has **4 + 2 cabins**, can accommodate **8 + 2 + 2 people** and has **4 toilets**. Bed linen and kitchen equipment are included in the price.

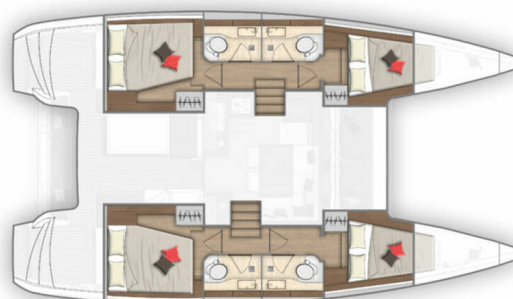

4 cabines 4 Salles de bain / 4 cabins 4 bathrooms

YACHT SPECIFICATIONS

Yacht Base

ACI Marina Slano, Croatia

Yacht ID

2730

Brands

Lagoon

Yacht name

Sailor Moon

Production year

2020

Length

39 ft

Cabins

4 + 2

Berths

8 + 2 + 2

WC

4

Engine

2 x 45 HP

Fuel tank

400 l



WEBSITE

www.plujeme.cz



PHONE

+420 720 755 085



MOBILE

+420 777 170 276



E-MAIL

info@plujeme.cz



PLUJEME RÁDI S.R.O.

Dlouhá 730/35, 11000 Praha 1 – Staré Město, Czech Republic

STANDARD YACHT EQUIPMENT

Comfort	Bed linen, Cockpit cushions, Towels
Deck	Bimini top, Cockpit table, Cockpit/stern, outside shower, Dinghy, Electric anchor windlass, Gangway, Outboard engine, Sprayhood, Teak cockpit
Entertainment	Mobile phone, Outdoor speakers, Radio CD player, USB, Bluetooth, Stand up paddle (SUP), TV
Galley	Hot water, Kitchen utensils (Galley equipment, cutlery), Oven, Refrigerator, Stove
Interior	Electric toilet
Navigation	Autopilot, Compass, GPS chart plotter, Navigation (Nautical) charts and nautical guide , Tridata
Safety	Black Water Tank, Liferaft , Safety equipment, VHF radio
Yacht electrics	Air Conditioning, Battery charger , Bilge pump - Electric, Generator, Shore connection 220 V



WEBSITE

www.plujeme.cz



PHONE

+420 720 755 085



MOBILE

+420 777 170 276



E-MAIL

info@plujeme.cz



PLUJEME RÁDI S.R.O.

Dlouhá 730/35, 11000 Praha 1 – Staré Město, Czech Republic

SERVICES

SELECTED SERVICES	OBLIGATORY	PAYMENT TYPE	PRICE
Comfort pack (Payable at the base) Season: 2024. includes final cleaning, liquid for dishes with sponge, bin bag, toilet paper, soap, table cloth, paper tissues, matches, shower gel and hair shampoo (1 set per cabin), fueled outboarder, surcharge for 2 weeks if no cleaning between the weeks is required: 200 €	Yes	per week	450,00 €
APA (Advance Provisioning Allowance) (Payable at the base) Season: 2024.	Yes	per week	5.000,00 €
Cook (Payable at the base) Season: 2024. payment directly to the chef. ***APA is obligatory if cook is hired.***	Yes	per day + food	220,00 €
Early Check in (Payable at the base) Season: 2024. VIP pack - Fast track (check in at 14:00h)	Yes	per booking	200,00 €
Hostess (Payable at the base) Season: 2024. ≤ 4 pax (preparation of breakfast and lunch)-payment directly to the hostess. ***APA is obligatory if hostess is hired.***	Yes	per day + food	160,00 €
Hostess (Payable at the base) Season: 2024. 5-8 pax (preparation of breakfast and lunch)-payment directly to the hostess. ***APA is obligatory if hostess is hired.***	Yes	per day + food	180,00 €
One way (Payable at the base) Season: 2024. to ACI Slano or to Marina Frapa - Rogoznica	Yes	one-way	650,00 €
Pet on board (Payable at the base) Season: 2024.	Yes	per booking	150,00 €
Provisioning (Payable at the base) Season: 2024. no extra delivery fee, payment in cash according to food bill	Yes	per booking	0,00 €
Skipper (Payable at the base) Season: 2024. payment directly to the skipper	Yes	per day + food	180,00 €
Transfer (Payable at the base) Season: 2024. price on request	Yes	one-way MOBILE	0,00 €

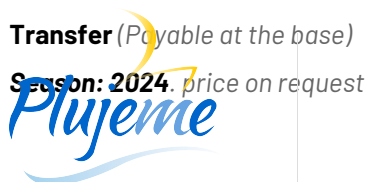

WEBSITE
www.plujeme.cz



E-MAIL
info@plujeme.cz



PHONE
+420 720 755 085



PLUJEME RÁDI S.R.O.
Dlouhá 730/35, 11000 Praha 1 – Staré Město, Czech Republic



one-way
MOBILE
+420 777 170 276

ADDITIONAL EXTRAS

EXTRA	OBLIGATORY	PAYMENT TYPE	PRICE
Beach towel (Payable at the base) Season: 2024. set of 8 - Payable at the base	Yes	per booking	40,00 €
Coffee machine (Payable at the base) Season: 2024. available upon request - Payable at the base	Yes	per booking	0,00 €
Kayak (Payable at the base) Season: 2024. Payable at the base	Yes	per week	200,00 €
Railing net (Safety net) (Payable at the base) Season: 2024. Payable at the base	Yes	per booking	150,00 €
Sailing dinghy: Tiwal 2 (Payable at the base) Season: 2024. Payable at the base	Yes	per week	300,00 €
Snorkeling equipment (Payable at the base) Season: 2024. per set - Payable at the base	Yes	per week	25,00 €



WEBSITE

www.plujeme.cz



E-MAIL

info@plujeme.cz



PHONE

+420 720 755 085



MOBILE

+420 777 170 276



PLUJEME RÁDI S.R.O.

Dlouhá 730/35, 11000 Praha 1 – Staré Město, Czech Republic

PRICE AND AVAILABILITY

21.09. - 28.09.2024 NOT AVAILABLE	28.09. - 05.10.2024 NOT AVAILABLE	05.10. - 12.10.2024 1.890 € 2.700 €	12.10. - 19.10.2024 NOT AVAILABLE
19.10. - 26.10.2024 2.025 € 2.700 €	26.10. - 02.11.2024 2.025 € 2.700 €	02.11. - 09.11.2024 2.160 € 2.700 €	09.11. - 16.11.2024 2.160 € 2.700 €
16.11. - 23.11.2024 2.160 € 2.700 €	23.11. - 30.11.2024 2.160 € 2.700 €	30.11. - 07.12.2024 2.160 € 2.700 €	07.12. - 14.12.2024 2.160 € 2.700 €
14.12. - 21.12.2024 2.160 € 2.700 €	21.12. - 28.12.2024 2.160 € 2.700 €		



WEBSITE

www.plujeme.cz



E-MAIL

info@plujeme.cz



PHONE

+420 720 755 085



MOBILE

+420 777 170 276



PLUJEME RÁDI S.R.O.

Dlouhá 730/35, 11000 Praha 1 – Staré Město, Czech Republic