

OCEANIS 51.1

Jupiter (2020)

Sailing yacht **Oceanis 51.1 Jupiter**, built in **2020** is anchored in the **Marina Šangulin, Biograd, Zadar region, Croatia**. It has **5 + 1 cabins**, can accommodate **10 + 1 + 1 people** and has **3 toilets**. Bed linen and kitchen equipment are included in the price.

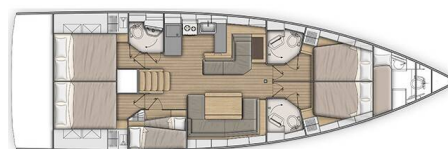

YACHT SPECIFICATIONS

Yacht Base

Marina Šangulin, Biograd, Croatia

Yacht ID

2469

Brands

Beneteau

Yacht name

Jupiter

Production year

2020

Length

52 ft

Cabins

5 + 1

Berths

10 + 1 + 1

Max Persons

12

WC

3

Engine

1 x 80 HP

Fuel tank

200 l



WEBSITE

www.plujeme.cz



PHONE

+420 720 755 085



MOBILE

+420 777 170 276



E-MAIL

info@plujeme.cz



PLUJEME RÁDI S.R.O.

Dlouhá 730/35, 11000 Praha 1 – Staré Město, Czech Republic

STANDARD YACHT EQUIPMENT

Comfort	Bed linen, Cockpit cushions, Mosquito nets, Pillows
Deck	Anchor Delta, Anchor Jambo, Bathing platform, Bilge pump - Mechanic, Bimini top, Boat hook, Cockpit grill, Cockpit table, Cockpit/stern, outside shower, Dinghy, Electric anchor windlass, Fenders, Gangway, Main anchor, Mooring ropes , Sprayhood, Teak cockpit, Teak seats in cockpit, Water hose, Winch handles
Entertainment	Fusion radio, Outdoor speakers
Galley	Electrical kettle, Gas bottles, Gas cookers, Hot water, Kitchen utensils (Galley equipment, cutlery), Moka pot, Oven, Refrigerator, Sink
Interior	Barometer, Bunk bed, Clock, Duvet cover, Electric fans in cabins, Electric toilet
Navigation	Autopilot, Binoculars, Bow thruster, Compass, Divider, nautic chart, GPS chart plotter - cockpit, Hand bearing compass, Navigation (Nautical) charts and nautical guide , Navigation set, Radar reflector, Tridata, Wind instrument/Anemometer
Safety	Black Water Tank, Distress flare box, Emergency tiller, Fire extinguisher , First aid kit , Flashlight, Fog horn, Life belts (Safety harness), Life buoy + Flashing light, Life jackets, Liferaft , Repair kit, Set of tools , VHF radio
Sails	Winch
Yacht electrics	220V socket, Air Conditioning, Battery charger , Bilge pump - Electric, Heating, Pump, Service batteries, Shore connection 220 V, Shore power cable



WEBSITE

www.plujeme.cz



PHONE

+420 720 755 085



MOBILE

+420 777 170 276



E-MAIL

info@plujeme.cz



PLUJEME RÁDI S.R.O.

Dlouhá 730/35, 11000 Praha 1 – Staré Město, Czech Republic

SERVICES

SELECTED SERVICES	OBLIGATORY	PAYMENT TYPE	PRICE
Charter package (Payable at the base) Season: 2025 - Angelina Yachtcharter. Charter package includes final cleaning, gas, check-in and out services, Wi-Fi 70GB/week, package for toilets (toilet paper and soap /per each toilet) and kitchen (1 kitchen paper towels, a sponge and a cleaning cloth, a small package of dish detergent, 1 waste bag, 2 kitchen towels, 2x 1l bottle of water), bed linen/bath towels (2 sets per cabin - do not include saloon and skipper cabin).	Yes	per booking	410,00 €
WiFi GRATIS ON BOAT (Payable now) Season: 2025 - Angelina Yachtcharter. GRATIS	Yes	per booking	0,00 €
Assisted Sailing (Payable at the base) Season: 2025 - Angelina Yachtcharter. Valovie - remote sailing assistance; Our skipper will help and assist you remotely during your charter, and provide you advices when it comes to berths, restaurant recommendations, weather forecasts etc.	No	per booking	270,00 €
Deposit insurance (Payable at the base) Season: 2025 - Angelina Yachtcharter. + refundable deposit 200,00 EUR	No	per booking	240,00 €
Early boarding/check-in (Payable at the base) Season: 2025 - Angelina Yachtcharter. boarding between 13:00 - 14:00h	No	per booking	250,00 €
Extra cleaning (Payable at the base) Season: 2025 - Angelina Yachtcharter. penalty fee for boat in dirty condition (garbage,dirty dishes,ect..)	No	per booking	120,00 €
Late check out (Payable at the base) Season: 2025 - Angelina Yachtcharter. Saturday till 10 AM, on request	No	per booking	350,00 €
Pet on board (Payable at the base) Season: 2025 - Angelina Yachtcharter. maximum 2 pets allowed	No	per booking	200,00 €



WEBSITE

www.plujeme.cz



PHONE

+420 720 755 085



MOBILE

+420 777 170 276



E-MAIL

info@plujeme.cz



PLUJEME RÁDI S.R.O.

Dlouhá 730/35, 11000 Praha 1 - Staré Město, Czech Republic

ADDITIONAL EXTRAS

EXTRA	OBLIGATORY	PAYMENT TYPE	PRICE
Beach towel (Payable at the base) Season: 2025 - Angelina Yachtcharter. Payable at the base	No	per piece	10,00 €
e-SUP (Payable at the base) Season: 2025 - Angelina Yachtcharter. SipaBoards - Allrounder; + additional deposit 1500 EUR, order in advance due to limited quantity of equipment - Payable at the base	No	per week	270,00 €
eFoil (Payable at the base) Season: 2025 - Angelina Yachtcharter. + 3000,00 EUR refundable deposit, order in advance due to limited quantity of equipment - Payable at the base	No	per week	1.600,00 €
Extra bedlinen (Payable at the base) Season: 2025 - Angelina Yachtcharter. Payable at the base	No	per set	10,00 €
Kayak (Payable at the base) Season: 2025 - Angelina Yachtcharter. *additional deposit 250 EUR, order in advance due to limited quantity of equipment - Payable at the base	No	per week	150,00 €
Outboard engine 2,3 HP (Payable at the base) Season: 2025 - Angelina Yachtcharter. Special promotion, free of charge - Payable at the base	No	per booking	0,00 €
Railing net (Safety net) (Payable at the base) Season: 2025 - Angelina Yachtcharter. Rental without mounting; order in advance due to limited quantity of equipment - Payable at the base	No	per booking	30,00 €
Railing net (Safety net) (Payable at the base) Season: 2025 - Angelina Yachtcharter. order in advance due to limited quantity of equipment - Payable at the base	No	per booking	130,00 €
Seabob (Payable at the base) Season: 2025 - Angelina Yachtcharter. additional deposit 1500 EUR, order in advance due to limited quantity of equipment - Payable at the base	No	per week	1.050,00 €
Stand up paddle (SUP) (Payable at the base) Season: 2025 - Angelina Yachtcharter. *additional deposit 250 EUR, order in advance due to limited quantity of equipment - Payable at the base	No	per week	100,00 €

Towels (Payable at the base)

No

per set

10,00 €

Season: 2025 - Angelina Yachtcharter. Payable at the base



WEBSITE

www.plujeme.cz



E-MAIL

info@plujeme.cz



PHONE

+420 720 755 085



MOBILE

+420 777 170 276



PLUJEME RÁDI S.R.O.

Dlouhá 730/35, 11000 Praha 1 – Staré Město, Czech Republic

PRICE AND AVAILABILITY

01.01. - 14.03.2025 NOT AVAILABLE	15.03. - 22.03.2025 2.419 € 3.024 €	22.03. - 29.03.2025 2.419 € 3.024 €	29.03. - 05.04.2025 2.419 € 3.024 €
05.04. - 12.04.2025 2.419 € 3.024 €	12.04. - 19.04.2025 2.419 € 3.024 €	19.04. - 26.04.2025 2.995 € 3.744 €	26.04. - 03.05.2025 NOT AVAILABLE
03.05. - 10.05.2025 3.241 € 4.051 €	10.05. - 17.05.2025 3.387 € 4.234 €	17.05. - 24.05.2025 3.748 € 4.685 €	24.05. - 31.05.2025 4.960 € 6.200 €
31.05. - 07.06.2025 5.328 € 6.660 €	07.06. - 14.06.2025 5.440 € 6.800 €	14.06. - 21.06.2025 6.014 € 7.517 €	21.06. - 28.06.2025 6.359 € 7.949 €
28.06. - 05.07.2025 6.712 € 8.390 €	05.07. - 12.07.2025 6.758 € 8.448 €	12.07. - 19.07.2025 6.758 € 8.448 €	19.07. - 26.07.2025 6.758 € 8.448 €
26.07. - 02.08.2025 6.797 € 8.496 €			



WEBSITE
www.plujeme.cz



E-MAIL
info@plujeme.cz



PHONE
+420 720 755 085



PLUJEME RÁDI S.R.O.
Dlouhá 730/35, 11000 Praha 1 – Staré Město, Czech Republic



MOBILE
+420 777 170 276

PRICE AND AVAILABILITY

02.08. - 09.08.2025 6.797 € 8.496 €	09.08. - 16.08.2025 6.528 € 8.160 €	16.08. - 23.08.2025 6.174 € 7.718 €	23.08. - 30.08.2025 5.998 € 7.498 €
30.08. - 06.09.2025 6.273 € 7.380 €	06.09. - 13.09.2025 6.120 € 7.200 €	13.09. - 20.09.2025 4.616 € 5.430 €	20.09. - 27.09.2025 3.723 € 4.380 €
27.09. - 04.10.2025 3.630 € 4.270 €	04.10. - 11.10.2025 2.699 € 3.175 €	11.10. - 18.10.2025 3.158 € 3.715 €	18.10. - 25.10.2025 2.913 € 3.427 €
25.10. - 01.11.2025 2.856 € 3.360 €	01.11. - 08.11.2025 2.688 € 3.360 €	10.11. - 13.03.2026 NOT AVAILABLE	



WEBSITE

www.plujeme.cz



E-MAIL

info@plujeme.cz



PHONE

+420 720 755 085



MOBILE

+420 777 170 276



PLUJEME RÁDI S.R.O.

Dlouhá 730/35, 11000 Praha 1 – Staré Město, Czech Republic